

DESIGN VEHICLE

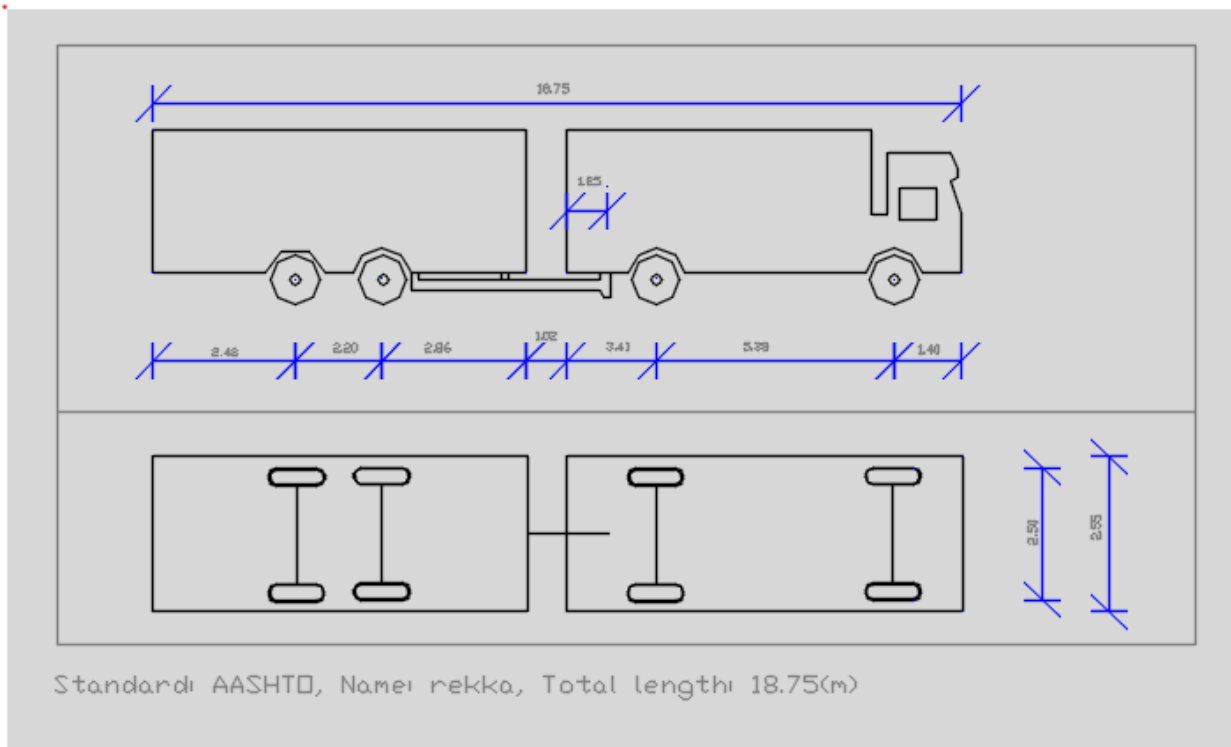

Dimensions of the vehicle used in the vehicle path survey.

The Vturn programme does not include a vehicle suited for transportation. A vehicle with similar dimensions has been used in the vehicle path survey, but it may deviate, to some extent, from the vehicle paths of the vehicle used.

ARRIVAL AT THE FINLAYSON AREA

The junction of Satakunnankatu Street and Kuninkaankatu Street

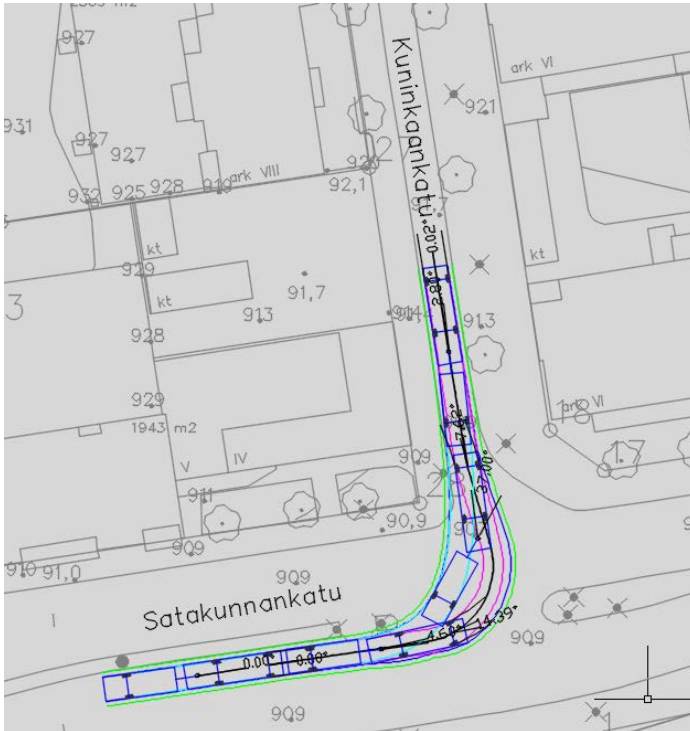

It is possible to turn from Satakunnankatu Street onto Kuninkaankatu Street when arriving from the west.

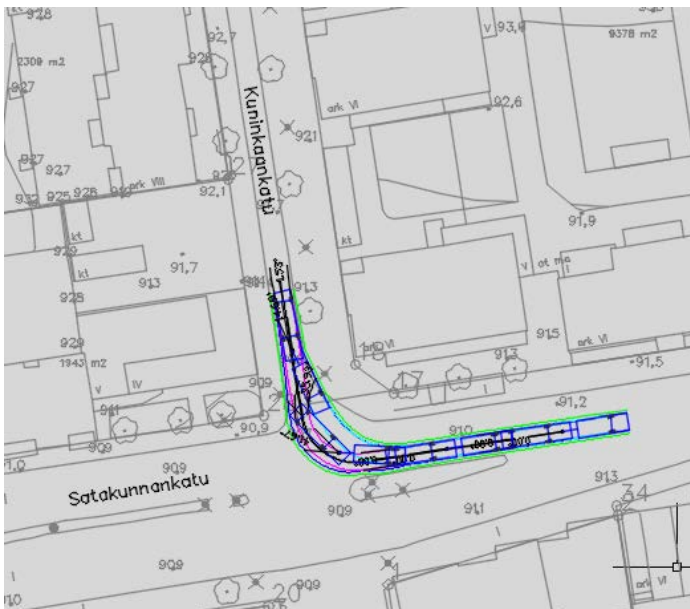

When arriving from the east, it is possible to turn from Satakunnankatu Street onto Kuninkaankatu Street only when both driving lanes are used.

Turning from Kuninkaankatu Street / Näsijärvenkatu Street onto Finlaysoninkatu Street

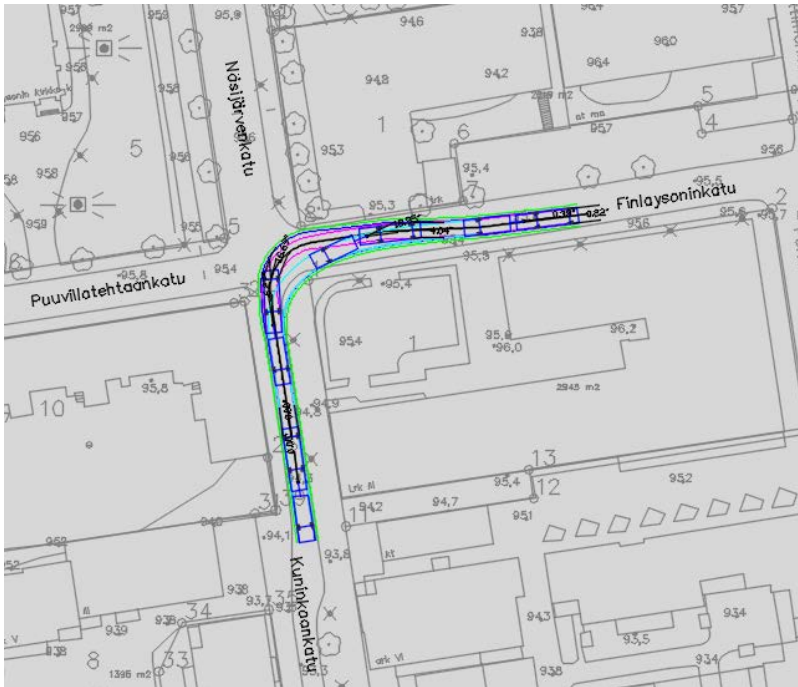

When arriving from the south, it is possible to turn from Kuninkaankatu Street onto Finlaysoninkatu Street only by using the pavement in the turning.

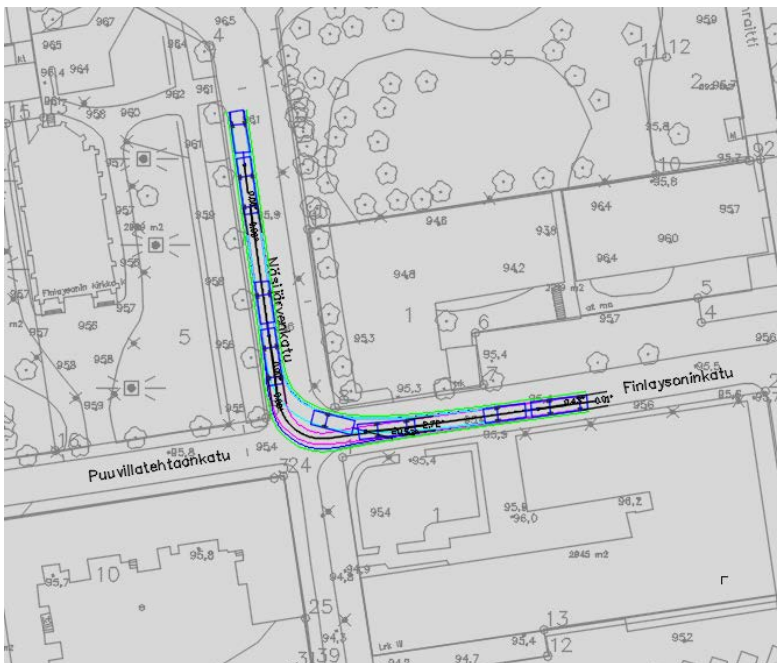

It is possible to turn from Kuninkaankatu Street (Näsijärvenkatu Street) onto Finlaysoninkatu Street when arriving from the north.

TURNING THE VEHICLE AROUND IN THE FINLAYSON AREA

There is most space for turning the vehicle around in the Finlayson area at the junction of Finlaysoninkatu Street and Polttimonkatu Street. The turn can be completed, for example, by driving along Finlaysoninkatu Street, then reversing onto Polttimonkatu Street, and turning left back onto Finlaysoninkatu Street.

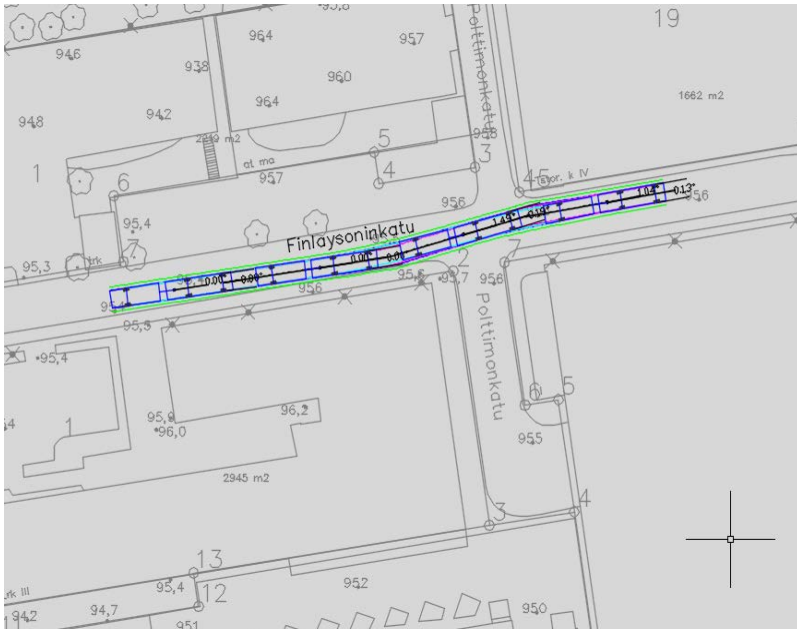

Driving to the area along Finlaysoninkatu Street.



Reversing from Finlaysoninkatu Street onto Polttimonkatu Street. Reversing is extremely problematic because the space is limited, there is plenty of other traffic at the junction, and the visibility is imperfect from the driver's point of view when reversing.



Turning from Polttimonkatu Street onto Finlaysoninkatu Street.

DEPARTURE FROM THE FINLAYSON AREA

Departure from the Finlayson area to Hämeenpuisto Esplanade via Näsijärvenkatu Street

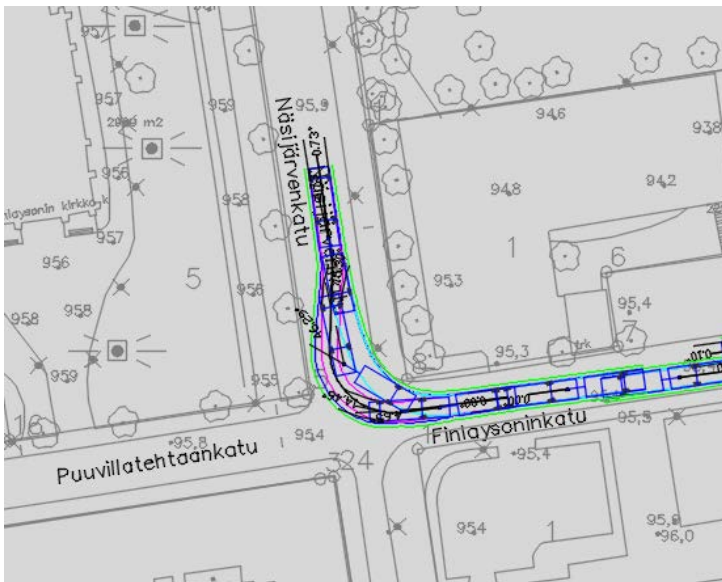

Turning from Finlaysoninkatu Street onto Kuninkaakatu Street (in the map Näsijärvenkatu Street) and onwards to Hämeenpuisto Esplanade. Turning is only possible if the oncoming lane is used.

Departure from the Finlayson area via Puuvillatehtaankatu Street

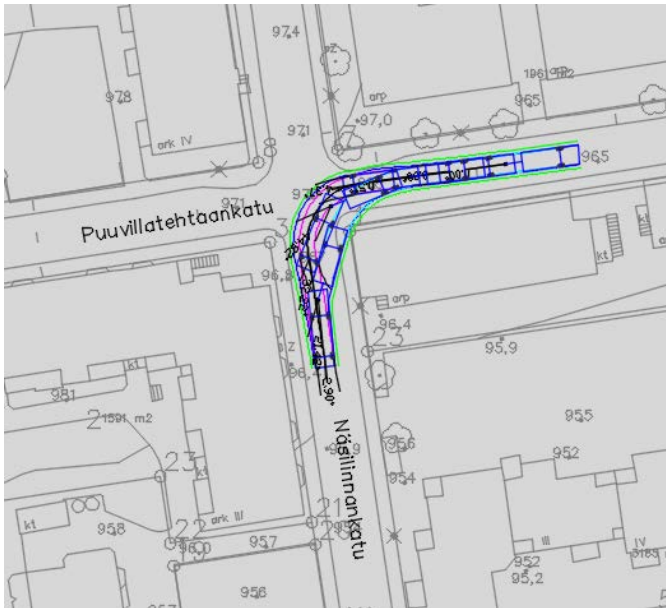

There is not enough space for the vehicle to turn from Puuvillatehtaankatu Street onto Näsilinnankatu Street (and onwards onto Satakunnankatu Street). Turning might be possible if the parking spaces are changed and the junction is modified.

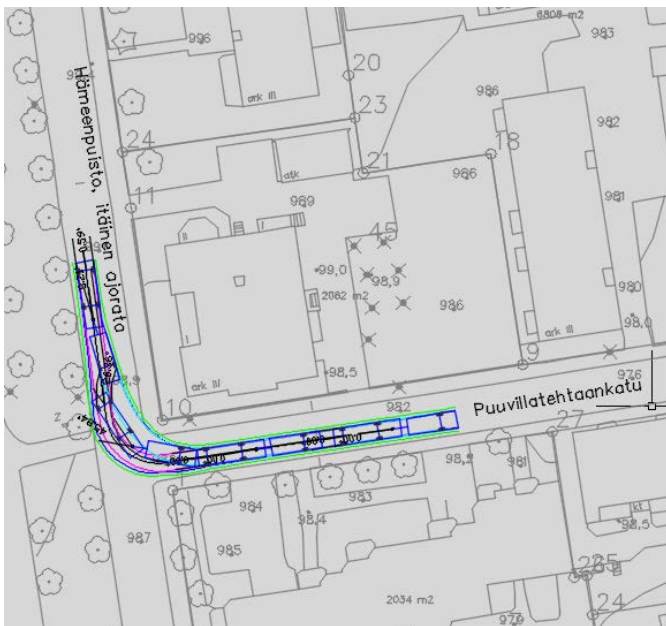

There is not enough space for the vehicle to turn from Puuvillatehtaankatu Street onto Hämeenpuisto Esplanade. Turning might be possible if the parking spaces are changed and the junction is modified.