



UX-7 Sensors

Installation & Configuration Guide



Hewlett Packard
Enterprise

Copyright Information

© Copyright 2025 Hewlett Packard Enterprise Development LP.

Open Source Code

This product includes code licensed under certain open source licenses which require source compliance. The corresponding source for these components is available upon request. This offer is valid to anyone in receipt of this information and shall expire three years following the date of the final distribution of this product version by Hewlett Packard Enterprise Company. To obtain such source code, please check if the code is available in the HPE Software Center at <https://myenterpriselicense.hpe.com/cwp-ui/software> but, if not, send a written request for specific software version and product for which you want the open source code. Along with the request, please send a check or money order in the amount of US \$10.00 to:

Hewlett Packard Enterprise Company
Attn: General Counsel
WW Corporate Headquarters
1701 E Mossy Oaks Rd, Spring, TX-77389
United States of America



Package Contents

The Power Adapter kit, available as accessory R3T90A, includes the following items:

- Power adapter
- 1x Type A plug (USA specific)
- 1x Type A plug (China specific)
- 1x Type C plug (Europlug)
- 1x Type C plug (Brazil specific)
- 1x Type C plug (Korea specific)
- 1x Type G plug (UK specific)
- 1x Type I plug (Australia/New Zealand specific)
- 1x Type I plug (Argentina specific)

This kit comes with the Type A plug pre-assembled, which can be used in North America, Central America, and Japan. Use the plug appropriate for your region.

More information about plugs is available at: <http://www.hpe.com/support/uxi-sensors>

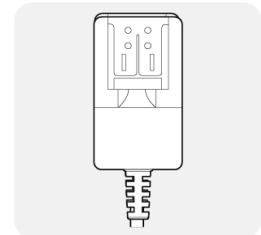

Figure 1 1x Power Adapter

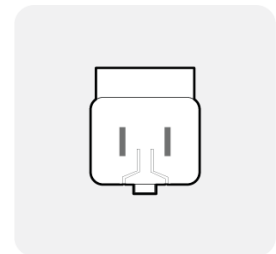
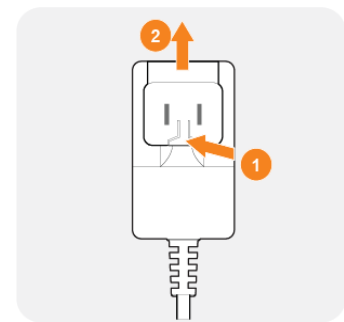
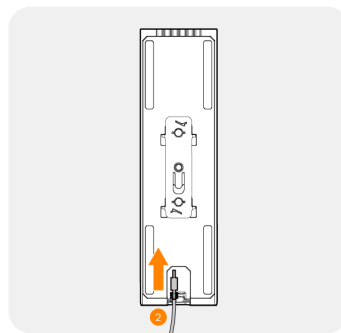
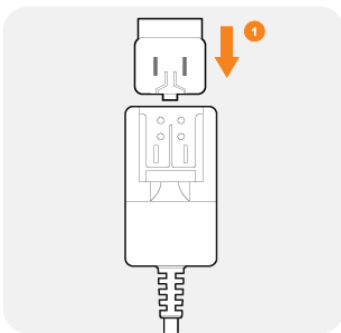

Figure 2 8x Plugs

Installing Your Power Adapter



To install the plug:

1. Slide the plug of choice onto the power adapter until it clicks into place.
2. Plug the DC power connector into the sensor.

To uninstall the plug:

1. Push down on the plug's latch.
2. Slide up and off.

For the purpose of identification needed for regulatory compliance certifications, this product has been assigned a unique regulatory model number (RMN). The regulatory model number can be found on the product nameplate label, along with all the required approval markings and information. When requesting compliance information for this product, always refer to this regulatory model number. The regulatory model number is not the marketing name or model number of the product.

- UX-7 RMN: ASIN0307
- UX-7C RMN: ASIN0308

Contents

Figure 3 1x sensor

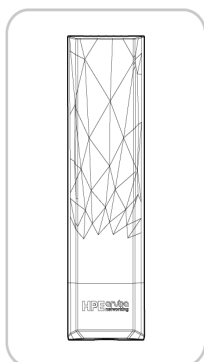

Figure 4 1x mounting bracket

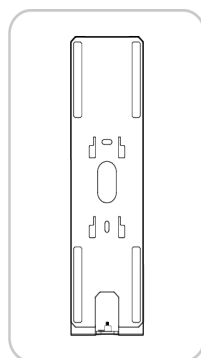

Figure 5 2x drywall anchors



Figure 6 2x 3mm screws

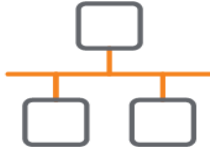
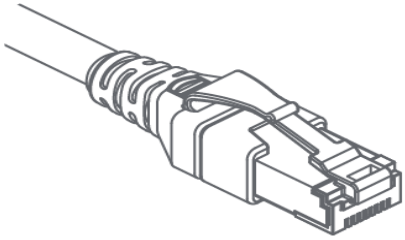

Figure 7 1x wrench



Connectivity & Status Light

Sensor Connectivity



This sensor requires an Ethernet connection. Ensure that the sensor can connect to the Internet via access on ports 80 and 443. For more information on how to install the sensor, please visit: <http://www.hpe.com/support/uxi-sensors>.

The sensor requires access to at least one wired or wireless network with Internet access and following URLs reachable:

Description	URL
Primary URL for all sensor communication with our backend systems	https://device-gateway.capenetworks.io

The sensor uses one of the following methods to get the correct time:

Description	URL
NTP server	0.pool.ntp.org/2.pool.ntp.org
Backup HTTP (Port 80) check	http://device-gateway.capenetworks.io



If these URLs on the ethernet network are only available through a proxy, you must use the HPE Aruba Networking User Experience Insight Install and Troubleshooting App to set the initial proxy configuration. For additional troubleshooting help and to apply configuration in the event of poor cellular data coverage, you can download and install the HPE Aruba Networking User Experience Insight Troubleshooting App. To access the app:
iOS: <https://apps.apple.com/us/app/aruba-uxi/id1482560935>
Android: https://play.google.com/store/apps/details?id=com.hpe.arubanetworking.uxi_onboarding&pcampaignid=web_share

Troubleshoot Sensor Status

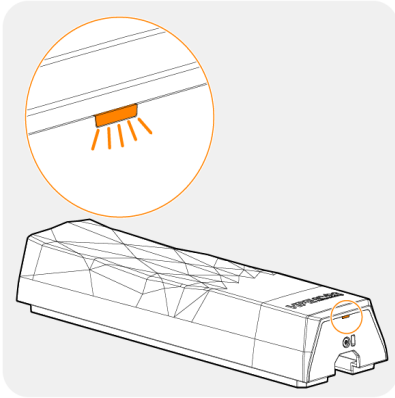

Status light will blink white when ready to configure. Take note if the status light displays one of the following colors:

- **Yellow:** Rebooting
- **Orange:** No connectivity
- **Red:** Sensor issues

If one of these colors persists for several minutes, please restart the setup process with the sensor plugged into an unrestricted Ethernet port. If the status light does not blink white within 10 minutes, please contact support.

Connecting Power

Figure 8 Power Over Ethernet (PoE)

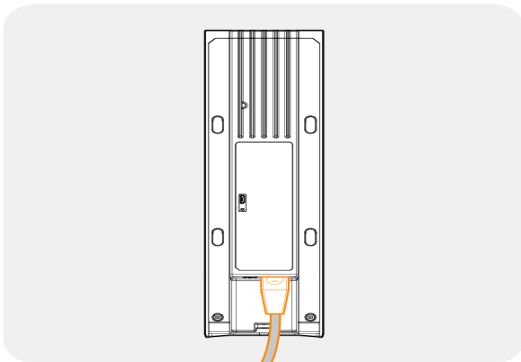
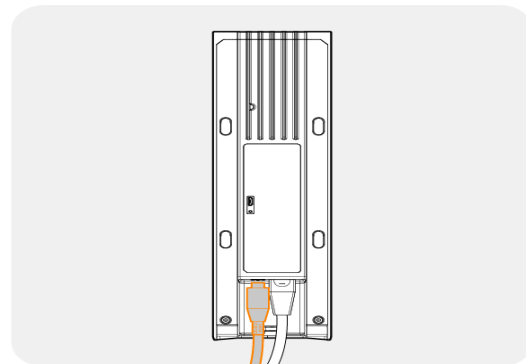

Figure 9 Ethernet + Optional Power Accessory (DC)

or



Installing Your Sensor

Mount With Bracket (Vertical)

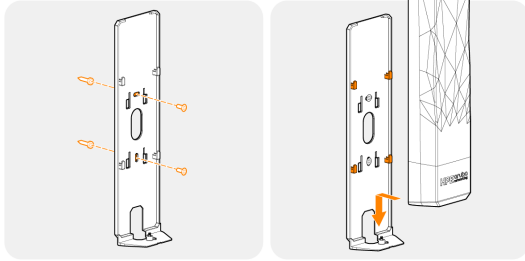

Use the provided screws and anchors to mount the bracket to a vertical surface that is clear from any obstructions. Once mounted, slide the sensor onto the bracket after connecting the Ethernet cable.

Listed below are the possible mounting options:

- Secure wall installation
- Secure junction box installation
- Ceiling and T-Bar installation (R3T84A mounting kit sold separately)
- Secure mount with Kensington Lock



Always use appropriate tools and protective gear when drilling or operating machinery. Avoid drilling into walls without first checking for electrical wiring.

Security Screw

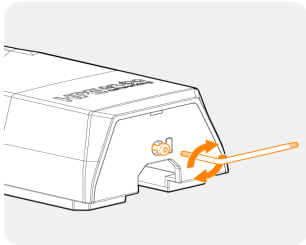

After securing the sensor to the mounting bracket, tighten the security screw with the provided wrench. Always use the sensor with the mounting bracket attached, even if freestanding on a desk.

Location Checklist

Install the sensor in a location that fulfills the following requirements:

- Positioned at a height similar to that of end-users' devices. This can be achieved by mounting it on a wall or pillar at a height of 4-5 feet (1.2-1.5 meters) or placing the sensor on a desk or table.
- Positioned more than 5 ft (1.5 m) away from the nearest Wi-Fi access point, if testing Wi-Fi connectivity
- Indoors, within a temperature range of 32-104°F (0-40°C)
- Away from direct sunlight
- Protected from contact with water
- Away from significant electrical currents
- Away from metallic surfaces
- Away from physical obstructions, including cabinets, server rooms, and underneath desks
- Safe from accidental damage caused by doors, moving furniture, equipment, and passers-by

Configuring Your Sensor

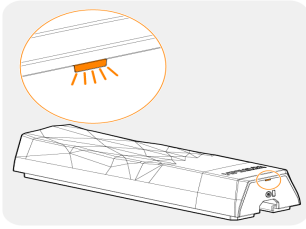

After the sensor has been installed and powered on, wait for the status light to begin blinking white.



Configure your sensor at: <http://www.hpe.com/support/uxi-sensors>.

If there is no connectivity, refer to the *configure your sensor with the mobile application* section at: <http://www.hpe.com/support/uxi-sensors>



Please be patient while your sensor connects. Depending on your network, the sensor software may take several minutes to boot and update.