

TO LAKE MACBRIDE

Directions: From I-80, take Coralville Exit #242 north onto 1st Avenue. Stay to the right at the roundabout and continue on 1st Avenue (becomes North Liberty Road) for 3.4 miles. Turn left on Dubuque Street to North Liberty, IA (1.6 miles). In North Liberty turn right on N. Front St. (F28). N. Front St. becomes Mehaffey Bridge Road; continue for 4.8 miles. Immediately after the causeway, turn left on Cottage Reserve Road and follow signs to the right to the boat ramp for 0.7 miles. From there follow the directions for parking.

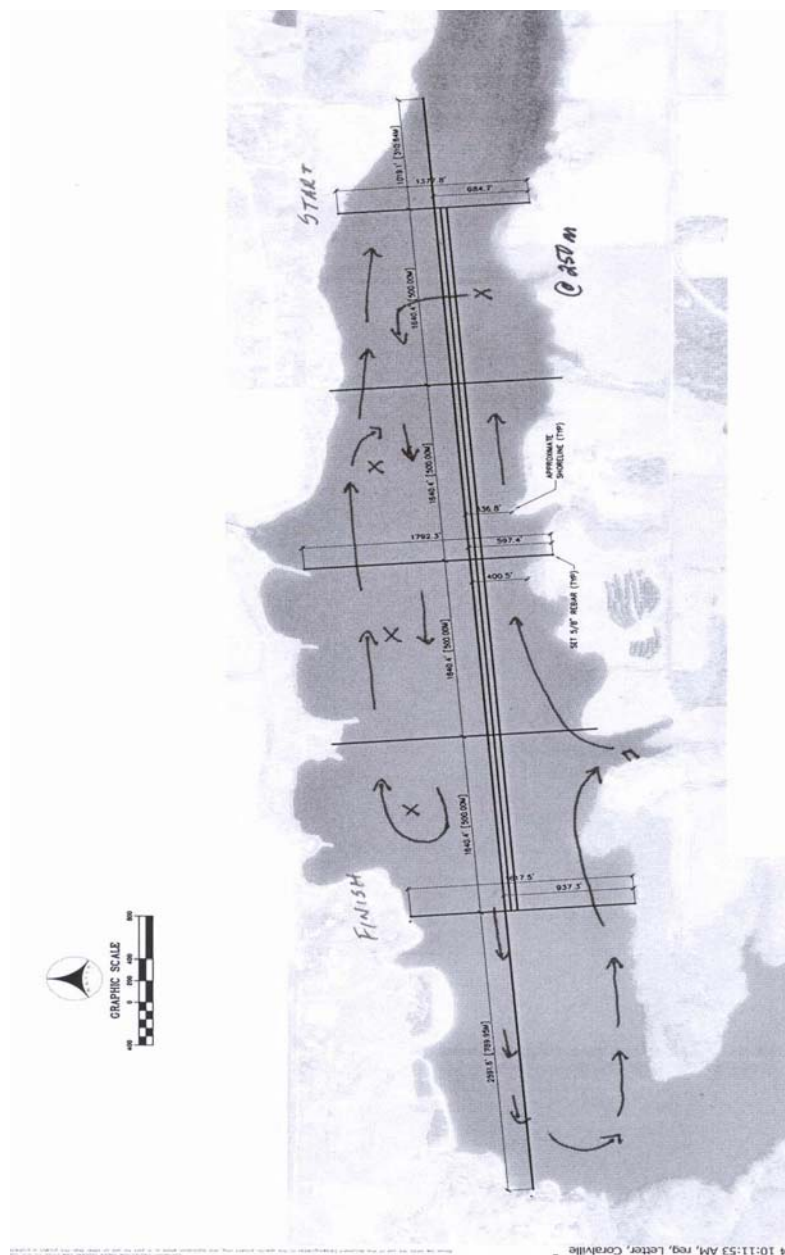

CHAMPIONSHIP COURSE



KEY POINTS

1. X indicates traffic buoys.
2. Depart from docks heading east towards starting line.
3. Get clearance to cross course from Course Marshall at the 250m mark.
4. Travel North around North buoy (orange) lines in a clockwise pattern.
5. Approach along North shore.
6. Cool down – past the finish line and to the docks.