

**This chapter is subject to the following plan changes:**

Proposed new text in Notified Plan Change 12 - underlined with green highlighting.

Proposed deleted text in Notified Plan Change 12 - ~~strikethrough with red highlighting~~.

Recommended amendments to Notified Plan Change 12:

- New text - underlined.
- Deleted Operative Plan text – ~~strikethrough~~.
- Deleted Notified Plan Change 12 text – ~~strikethrough~~.

Submission Points relating to recommended amendments.

# Appendix 7: Rototuna Town Centre

Figure 7-1: Rototuna Town Centre Concept Plan

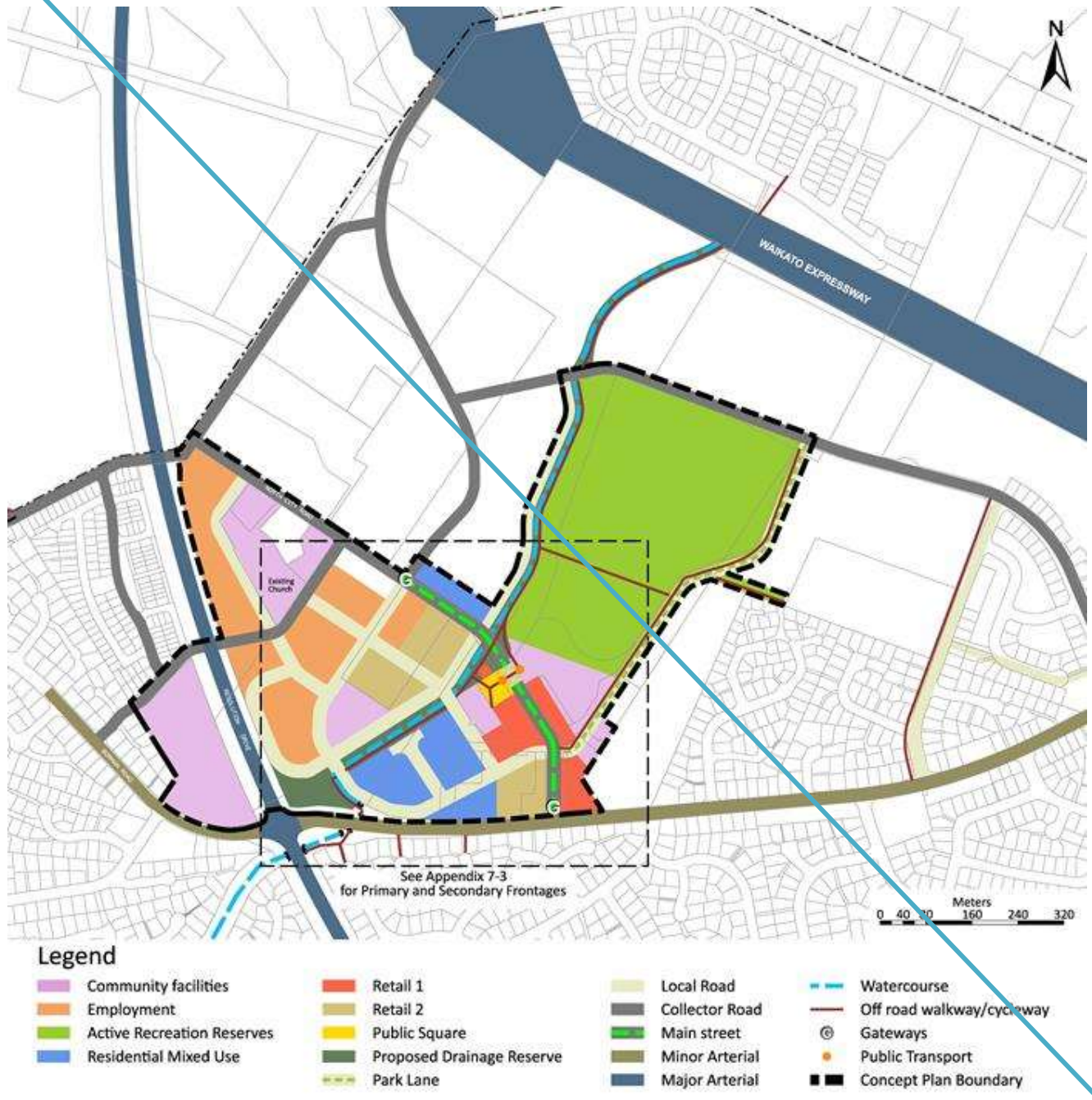

**Note:** This plan is diagrammatic only. Engineering considerations have not been confirmed for: road and drainage alignments, areas, topography, sports field layout.

Figure 7-1: Rototuna Town Centre Concept Plan

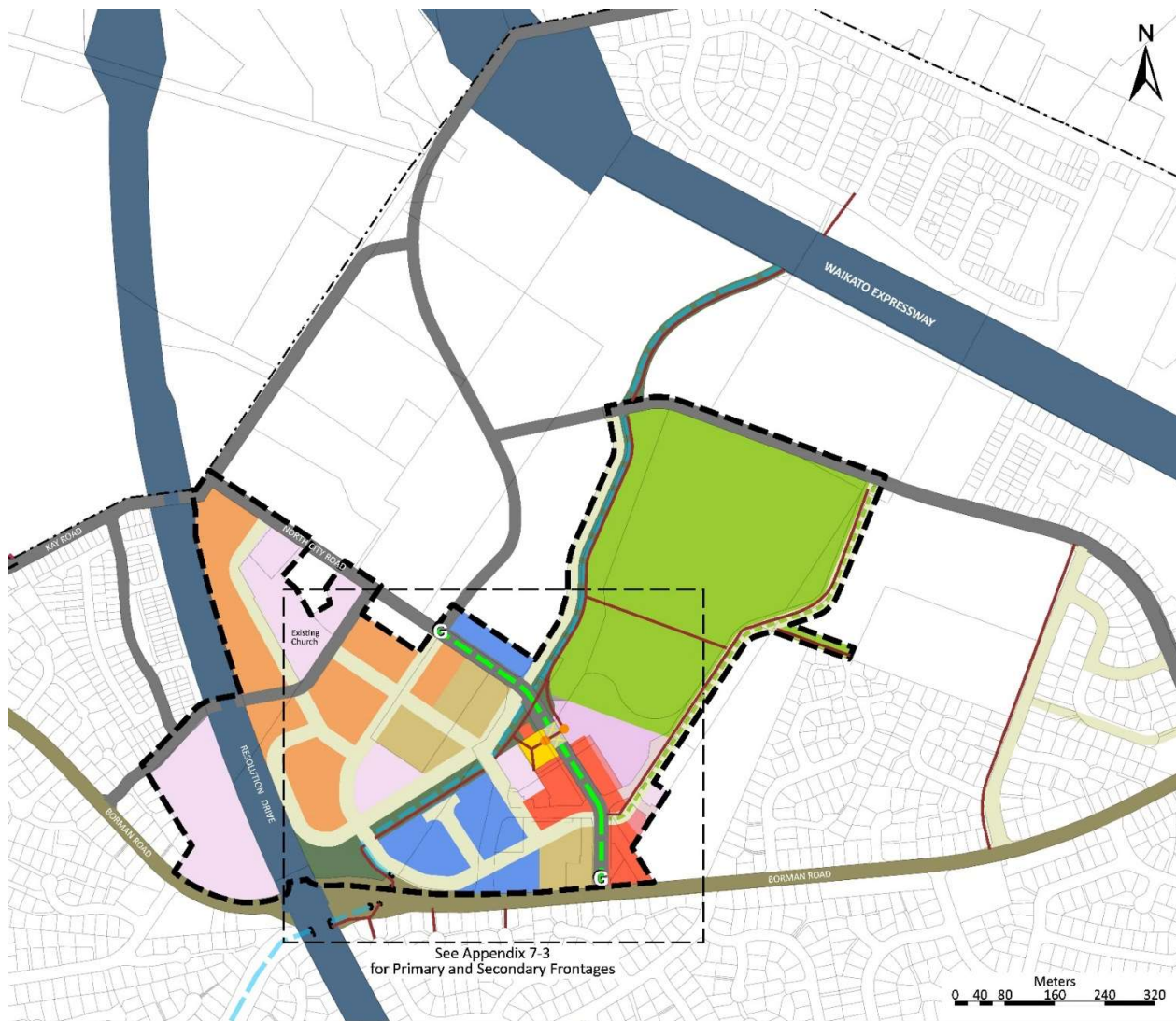

Legend

- |                            |                           |                |                           |
|----------------------------|---------------------------|----------------|---------------------------|
| Community facilities       | Retail 1                  | Local Road     | Watercourse               |
| Employment                 | Retail 2                  | Collector Road | Off road walkway/cycleway |
| Active Recreation Reserves | Public Square             | Main street    | Gateways                  |
| Residential Mixed Use      | Proposed Drainage Reserve | Minor Arterial | Public Transport          |
|                            | Park Lane                 | Major Arterial | Concept Plan Boundary     |

**Note:** This plan is diagrammatic only. Engineering considerations have not been confirmed for: road and drainage alignments, areas, topography, sports field layout.



Figure 7-2: Comprehensive Development Plan Development Areas – Rototuna Town Centre



Figure 7-3: Location of Primary and Secondary Frontages



Figure 7-4: Residential Mixed-Use – Location of Retail Frontages

