

**Appendix C – Records of Title**





**RECORD OF TITLE**  
**UNDER LAND TRANSFER ACT 2017**  
**FREEHOLD**  
**Search Copy**



  
R.W. Muir  
Registrar-General  
of Land

**Identifier** **SA73A/917**  
**Land Registration District** **South Auckland**  
**Date Issued** 02 July 2002

**Prior References**  
SA60A/627

---

**Estate** Fee Simple  
**Area** 1337 square metres more or less  
**Legal Description** Lot 3 Deposited Plan South Auckland  
91490 and Lot 1 Deposited Plan South  
Auckland 83094

**Registered Owners**  
Hamilton City Council

---

**Interests**  
Appurtenant hereto is a right of way created by Transfer H674552.2 - 15.8.1986 at 2.00 pm

PARCEL	FORMERLY	CT REF
LOT 1	PT LOT 1 DPS 78127	61A/563
LOT 2	PT LOT 2 DPS 40898	36A/271
LOT 3	PT LOT 3 DPS 40898	36A/272

NOTE: Separate areas for Lot 1 Hereon & Lot 1 DPS 75682 cannot be deduced. Total Area : 1637m²

LAND DISTRICT SOUTH AUCKLAND  
Survey 3k and District XIII KOMAKORAU  
SHEET No. 281

PLAN OF LOTS 1-3  
FOR CT DIAGRAM PURPOSES

TERRITORIAL AUTHORITY HAMILTON CITY  
Prepared by TERRALINK NEW ZEALAND LIMITED  
SCALE : Proportional DATE : 24 SEPT 1998

APPROVED FOR CT DIAGRAM PURPOSES ONLY  
15 9 1998  
Chief Surveyor  
APPROVED FOR CT DIAGRAM PURPOSES ONLY  
15 9 1998  
District Land Registrar  
DPS 83094

DEVIN SURVEYOR GENERAL, LAND INFORMATION, NEW ZEALAND.



**RECORD OF TITLE**  
**UNDER LAND TRANSFER ACT 2017**  
**FREEHOLD**  
**Search Copy**



  
R.W. Muir  
Registrar-General  
of Land

**Identifier** SA35A/348  
**Land Registration District** South Auckland  
**Date Issued** 13 December 1985

**Prior References**  
SA25A/1155

---

**Estate** Fee Simple  
**Area** 3.1399 hectares more or less  
**Legal Description** Part Lot 4 Deposited Plan South Auckland  
192

**Registered Owners**  
Waikato Racing Club Incorporated

---

**Interests**

Subject to a right of way over part marked B on DPS 26345 specified in Easement Certificate H239554.1  
The easements specified in Easement Certificate H239554.1 are subject to Section 351E (1) (a) Municipal Corporations Act 1954

## Hamilton City

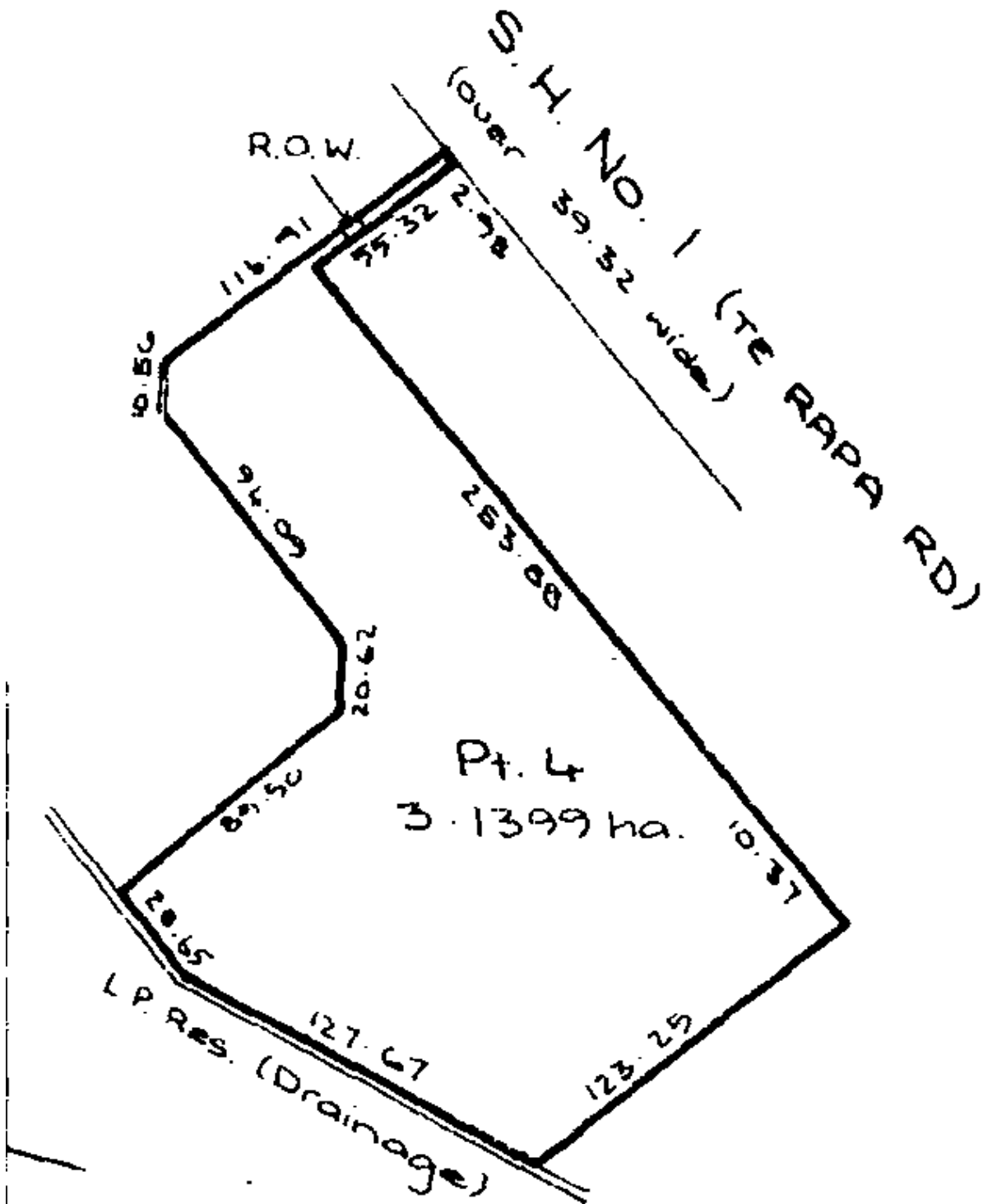



**RECORD OF TITLE**  
**UNDER LAND TRANSFER ACT 2017**  
**FREEHOLD**  
**Search Copy**



  
R.W. Muir  
Registrar-General  
of Land

**Identifier** **791578**  
**Land Registration District** **South Auckland**  
**Date Issued** 22 January 2018

**Prior References**

764194                      764195

---

**Estate** Fee Simple  
**Area** 46.8450 hectares more or less  
**Legal Description** Lot 1 Deposited Plan 513065  
**Registered Owners**  
Waikato Racing Club Incorporated

---

**Interests**

Subject to a drainage easement over part marked A on DP 513065 specified in Easement Certificate S433064 - 29.11.1968 at 12:20 pm

The easements specified in Easement Certificate S433064 are subject to Section 351E (1) (a) Municipal Corporations Act 1954

Subject to a right of way over part marked C, E and F on DP 513065 specified in Easement Certificate H239554.1 - 3.7.1979 at 10:41 am

The easements specified in Easement Certificate H239554.1 are subject to Section 351E (1) (a) Municipal Corporations Act 1954

Subject to a water easement (in gross) over marked B, C and D on DP 513065 in favour of Hamilton City Council created by Transfer 5109105.3 - Produced 15.11.2001 at 1:44 pm and entered 31.1.2002 at 9:38 am

