



# Technical Bulletin

Number: 190219-140-50-1

Date: 02-19-19

## Certified Snowblower Cable Assembly

---

This covers the following models (Read completely before performing service):

- |          |          |                |
|----------|----------|----------------|
| • 100435 | 060-3732 | 22" Snowblower |
| • 100566 | 060-3740 | 24" Snowblower |
| • 100567 | 060-3742 | 27" Snowblower |
| • 100568 | 060-3744 | 30" Snowblower |
- 

### SAFETY PRECAUTIONS

- To reduce the risk of injury, user must read and understand the operator's manual before using this product.
- DO NOT make any adjustments to snowblower without first stopping the engine, removing the engine key, and disconnecting the spark plug wire.
- Burns from hot parts — let the engine cool for 30 minutes before touching hot parts.
- Injury from moving parts — this machine may pick up and throw objects which can cause serious personal injury. Keep bystanders at a safe distance.
- To reduce the possibility of fire or explosion, be careful when working around gasoline. Keep cigarettes, sparks and flames away from all fuel-related parts.
- **DO NOT run the engine with the belt guard removed.**

1. NOTICE: Cables are disconnected from the control handles and found near to the belt guard cover the front of the gas tank.

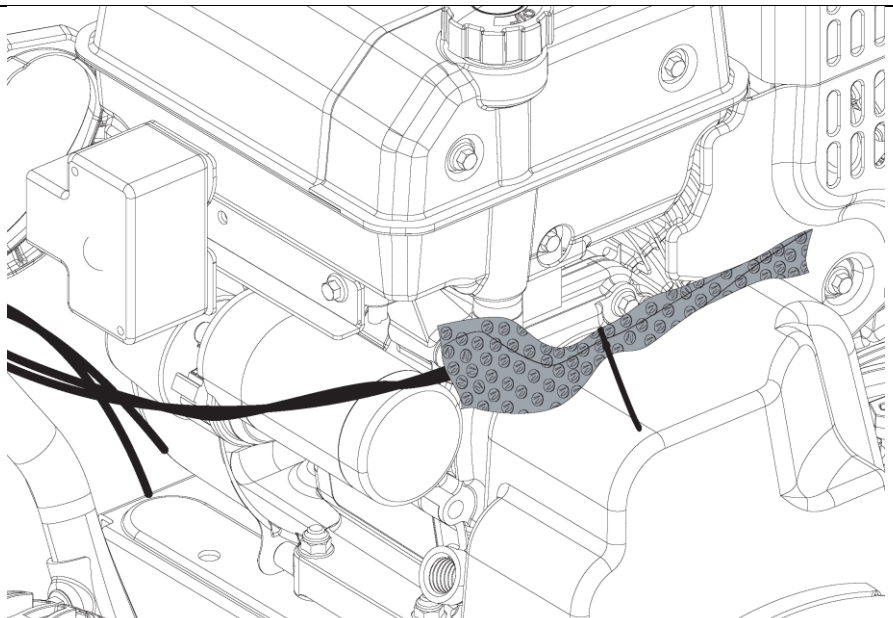

2. Remove bubble wrap and cable assembly ends will look as shown to the right.

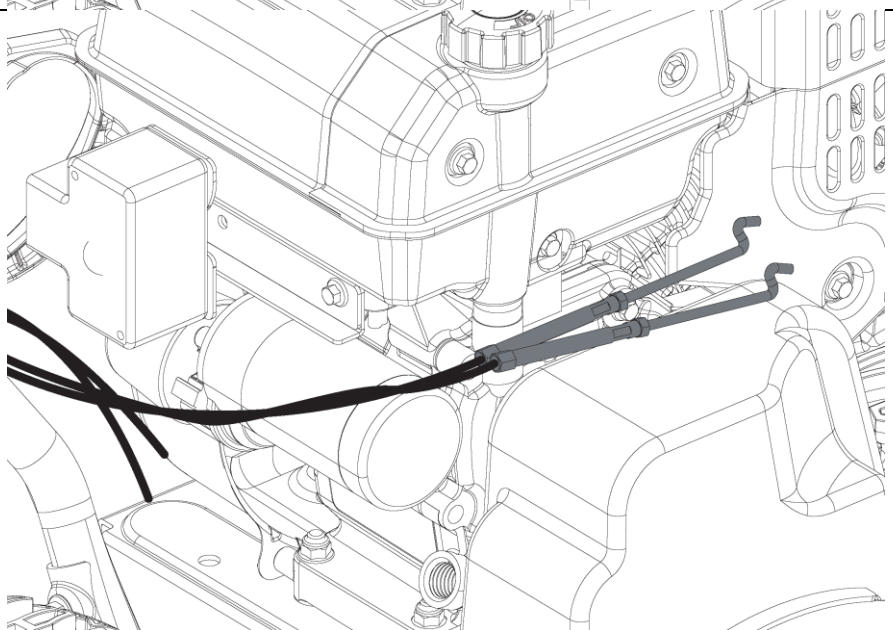

3. The control wires include part A and part B, these parts will separate for assembly in the next steps. Unscrew part A and B of the wire.

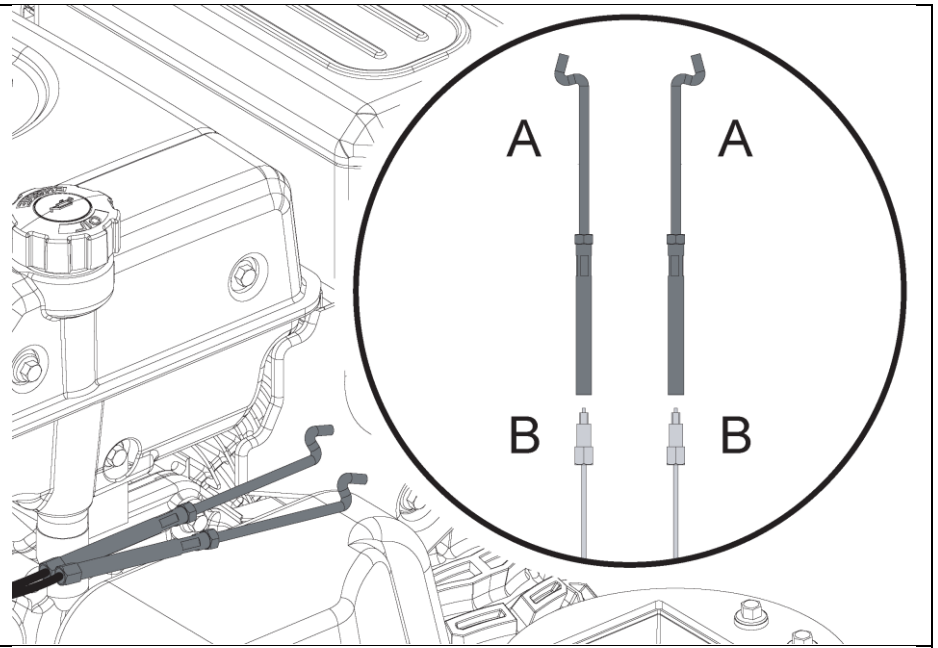

4. Place the drive control connector into the right handle as shown. This will be the cable that comes from the right side of the unit.

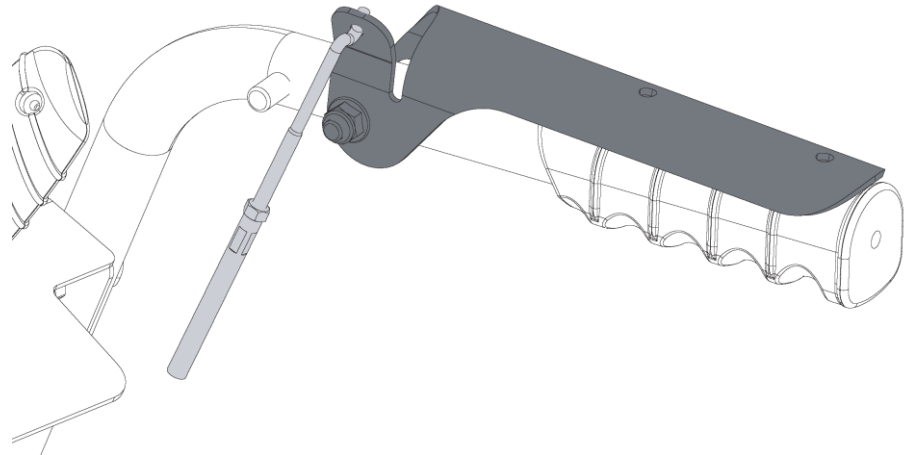

5. Lift control handle as shown.

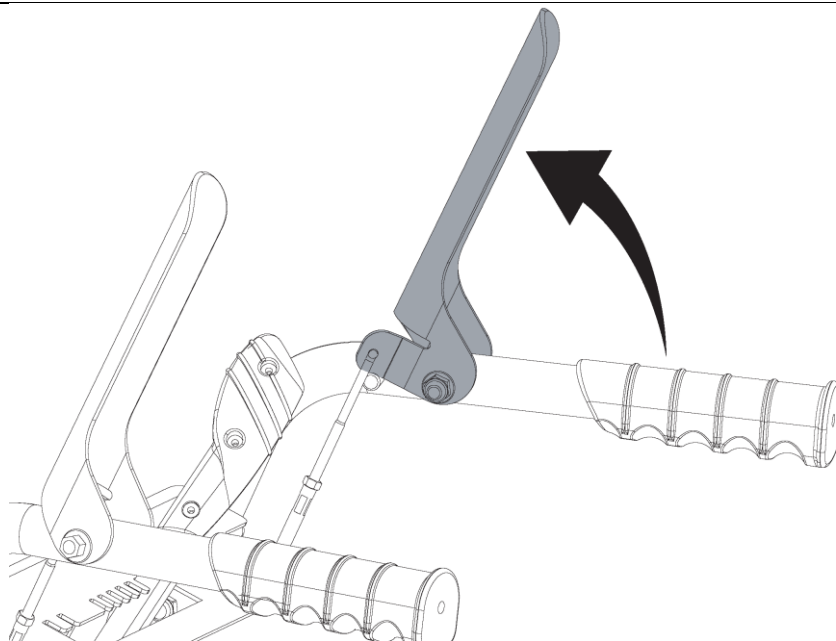

6. Screw part B to part A, tighten completely. See ADJUSTING SELF-DRIVE CONTROL HANDLE CABLE in your manual for correct adjustments.

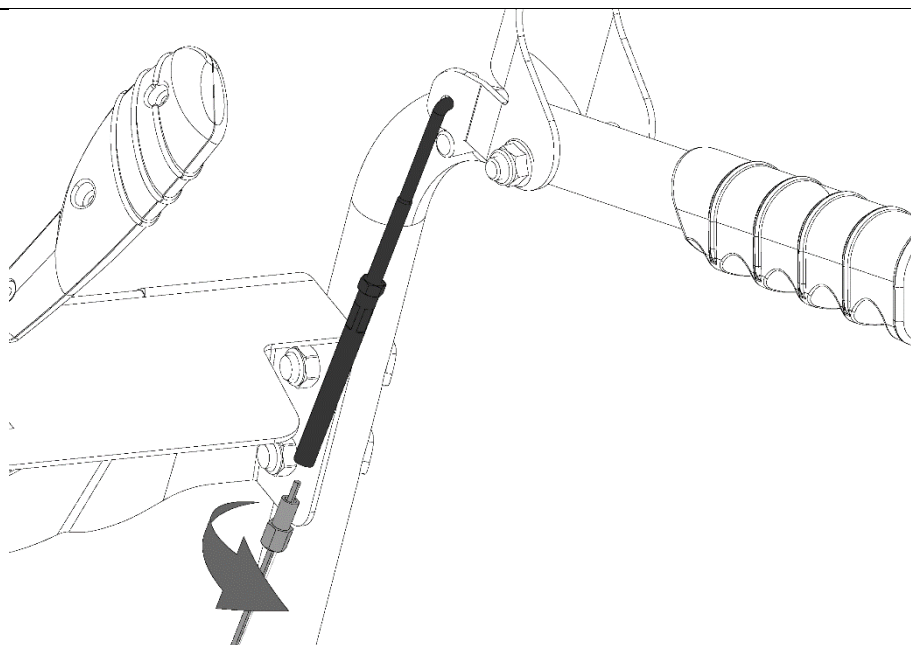

7. Repeat for the auger cable on the left side.

8. The cable will be located on the left side of the snowblower.

## ADJUSTING THE DRIVE CONTROL HANDLE CABLE

Make sure that the tension on the self-drive cable is adjusted so it has between 1/4-3/8" (6.4-9.5 mm) of movement. This movement can be acquired by measuring the distance the engagement paddle moves from its starting position and the point it becomes taut and starts to move the transmission adjustment lever. If the slack is greater than 5/8" (16 mm), please adjust. Proper tension is important because you will want your snowblower to move forward properly in heavy snowfalls.

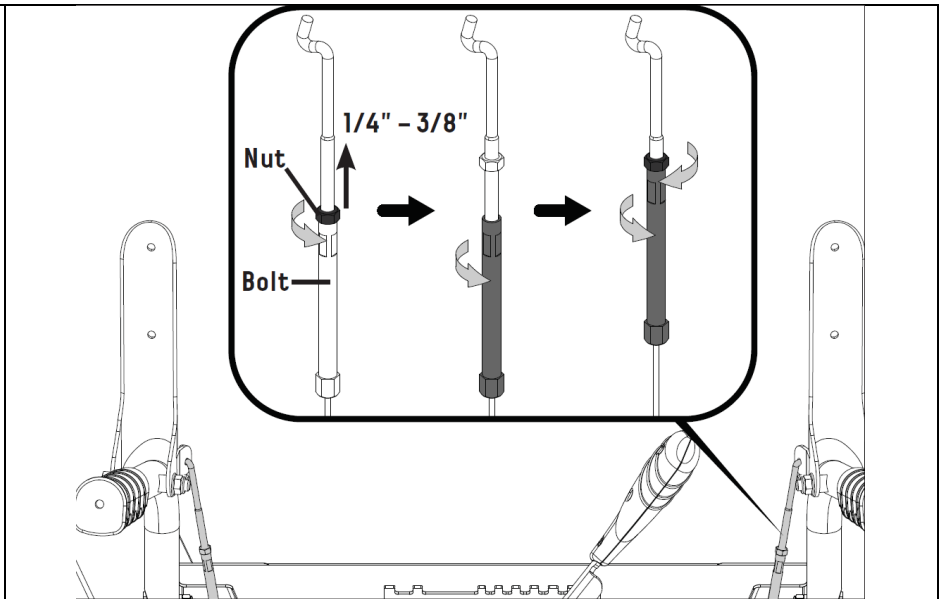

While operating the snowblower, if the drive control lever is too loose, tighten the nut counter-clockwise while at the same time rotating the bolt upward to reach the position of the nut.

## ADJUSTING THE AUGER CONTROL CABLE

Make sure that the tension on the auger control cable is adjusted so it has between 1/4-3/8" (6.4-9.5 mm) of movement. This movement can be acquired by measuring the distance the engagement paddle moves from its starting position and the point it becomes taut and starts to engage the auger. If the slack is greater than 5/8" (16 mm), please adjust. Proper tension is important because you will want your snowblower to maximize belt life in heavy snowfalls.

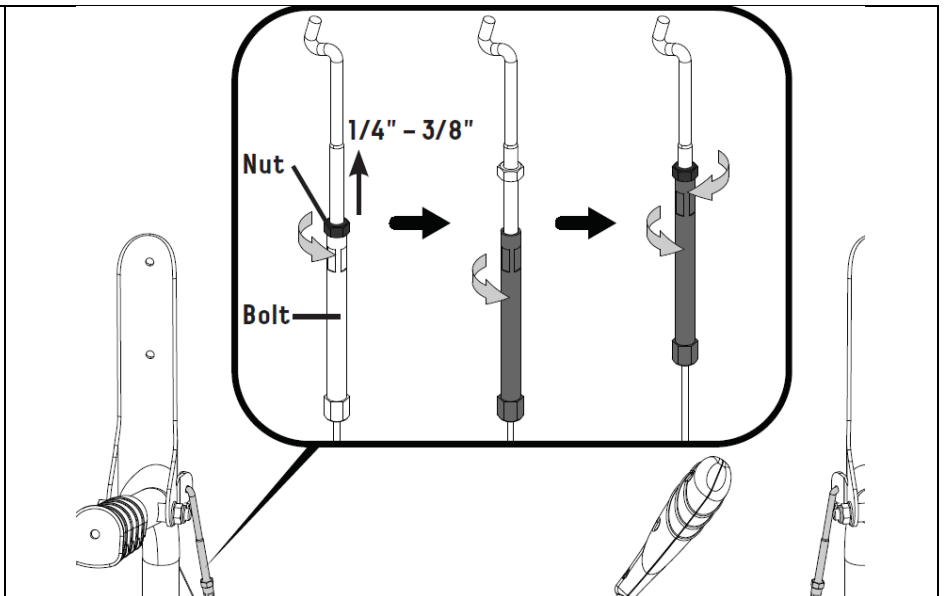

While operating the snowblower, if the auger control lever is too loose, tighten the nut counter-clockwise while at the same time rotating the bolt upward to reach the position of the nut.

If you have any questions regarding the previous procedure, please contact our technical department Monday-Friday from 8:30 AM-5:00 PM PST at 877-338-0999.

Champion Power Equipment, Inc.  
12039 Smith Ave.  
Santa Fe Springs, CA 90670  
Phone: 1-877-338-0999  
Email: [tech@championpowerequipment.com](mailto:tech@championpowerequipment.com)