

Mobility Kit Installation

This bulletin covers the following Champion Power Equipment models:

- C46535 3500 Watt Generator
- C46540 3500 Watt RV Generator
- C49055 4800 Watt Generator
- C41255 5500 Watt Generator

Note: Read instructions completely before performing service.

Parts Included

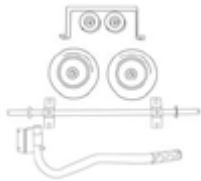

Wheel Kit

- Axle (1 piece)
- 8" Solid Wheel (2 pieces)
- Vibration Mounts (2 pieces)
- Handle Assembly (1 set)
- Support Leg (1 piece)



Bolt Kit

- Wheel Retaining Pins (2 pieces)
- Flat Washers (2 pieces)
- "O" Washers (2 pieces)
- Cap Screws and Nuts (6 sets)

Install the Wheel Kit

You will need the following tools to install the wheels:

- 12 mm wrench
- Socket wrench with a 12 mm socket
- Pliers

1. Before adding oil to the engine, tip the generator slowly so that the engine side is up.
2. Bolt the axle to the frame.
3. Slide a wheel onto the axle.
4. Place a washer on the end.
5. Install the cotter pin through the hole on the end of the axle.
6. Carefully bend the legs of the cotter pin back around the axle.
7. Repeat steps 3-6 to attach the second wheel.

Install the Support Leg

1. Attach the rubber vibration mount to the support leg with a cap screw (M8x20) and lock nut (M8).
2. Attach the support leg to the generator frame with cap screws (M8x30) and lock nuts (M8).
3. Tip the generator slowly so that it rests on the wheels and support leg.

Install the Handle

1. Line up the bottom hole on the handle with the bottom hole on the frame.
2. Place a plastic washer on the cap screw (M8x50) and thread through the frame and handle.
3. Place a plastic washer and lock nut (M8) on the end of the bolt and fasten securely. DO NOT over tighten the lock nut.

If you have any questions, please contact Champion Power Equipment:

Champion Power Equipment, Inc.
10006 Santa Fe Springs Rd.
Santa Fe Springs, CA 90670

Phone: 1-877-338-0999

Email: tech@championpowerequipment.com