



## 2024 HUME LAKE SUBDIVISION CABIN USER FORM HUME LAKE CHRISTIAN CAMPS

**NO ENTRY TO HUME LAKE WILL BE PERMITTED UNTIL THIS FORM HAS BEEN SIGNED AND IS ON FILE WITH THE HUME LAKE WELCOME CENTER. RENTERS MUST BRING A COPY WITH THEM.  
RENTER MUST SHOW ID UPON CHECK-IN AT SECURITY BOOTH (SUMMER ONLY).**

Lot #: \_\_\_\_\_  
Cabin Capacity \_\_\_\_\_  
Renting (Paying) \_\_\_\_\_ or Guest (Not Paying) \_\_\_\_\_ Registered for a Hume Event? \_\_\_\_\_  
Renters name: \_\_\_\_\_ Spouse: \_\_\_\_\_  
Address: \_\_\_\_\_ City \_\_\_\_\_ St \_\_\_\_\_ Zip \_\_\_\_\_  
Home Phone: (\_\_\_\_) \_\_\_\_\_ Cell Phone: (\_\_\_\_) \_\_\_\_\_  
Renter's Email: \_\_\_\_\_  
Rental Period: From: \_\_\_\_\_ to: \_\_\_\_\_ inclusive.  
Check-In Time: \_\_\_\_\_ Check-Out Time: \_\_\_\_\_  
Names of additional guests (including children) occupying the cabin during the rental period:

- |          |          |
|----------|----------|
| 1. _____ | 4. _____ |
| 2. _____ | 5. _____ |
| 3. _____ | 6. _____ |

### **RENTER/USER AGREEMENT:** (Initial each and sign below)

\_\_\_\_\_ I have received a copy (attached) of and hereby agree to abide by the Rules and Regulations and the Doctrinal Statement of Belief established by the Hume Lake Christian Camps Board of Directors.  
\_\_\_\_\_ Specifically, I agree NOT to bring pets, guns, bows and arrows, alcohol, drugs, off-road vehicles, or motorcycles onto the conference grounds (which includes the Hume Lake Subdivision). I understand that no exception can be considered or authorized.  
\_\_\_\_\_ I agree that the subject rental property will not be occupied at any time during my rental period, in excess of the authorized cabin occupant capacity (above).

Renter/Guest Signature: \_\_\_\_\_ Date: \_\_\_\_\_

### **LEASEHOLDER ACKNOWLEDGMENT:**

I believe I have properly and adequately advised the above renters/guests of the responsibilities required by Hume Lake Christian Camps during this rental period.

Leaseholder Signature: \_\_\_\_\_ Date: \_\_\_\_\_

Cell Phone: (\_\_\_\_) \_\_\_\_\_ Email: \_\_\_\_\_

**LEASEHOLDERS:** This completed agreement must be emailed ([info@humelake.org](mailto:info@humelake.org)) to the Welcome Center and on file prior to renter/guest arrival.

**Reminder:** The Welcome Center no longer handles keys for rentals.



## HUME LAKE CHRISTIAN CAMPS GUEST RULES AND REGULATIONS

Welcome to Hume Lake! We are glad you came to visit us. Hume Lake Christian Camps is a camping ministry dedicated to sharing the Gospel of Jesus Christ with every person that comes in contact with this global ministry.

We ask that all leaseholders, guests, and renters help us create a distraction-free environment for everyone by following Hume Lake Rules and Regulations while on the Hume Lake property, including the Hume Lake Subdivision. **For a copy of the complete version of all the Rules and Regulations, please go to the Welcome Center.**

**EMERGENCIES:** In the event of a fire or life-threatening medical emergency, please dial **911**. The **Hume Lake Health Center** is not available to Subdivision Leaseholders, Guests, or Renters.

**NO ALCOHOL OR DRUGS:** Alcohol and chemicals associated with substance abuse are not allowed. Alcoholic beverages, marijuana (or any cannabis products), and nicotine are not permitted on HLCC property or the Subdivision. Illegal substances such as heroin, cocaine, or methamphetamine are not allowed as well. Please, no smoking or vaping.

**MODESTY:** Please wear modest and suitable clothing while at HLCC. Immodest shorts, two-piece bathing suits or Speedos, spaghetti straps, and bare midriffs are not acceptable. We ask that Leaseholders and Guests dress in a way consistent with their biological sex at birth.

**PETS:** Guests, renters, and relatives of leaseholders are not allowed to have pets at HLCC or in the HLCC subdivision. Only Leaseholders may bring pets to Hume. Pets Must be on leashes at all times when out of doors. HLCC reserves the right to assess a fine of \$500 per incident for all guests, renters, or relatives of leaseholders visiting the Subdivision who bring pets to Hume. The fee will be billed to the leaseholder. Registered ADA animals are allowed and must have some type of designation visible and must remain on a leash.

**SPEED LIMIT:** The speed limit at Hume Lake is 15 MPH or less. Please observe this at all times.

**OFF-ROAD VEHICLES:** Guests and Renters may not drive off-road vehicles on HLCC property or in the Subdivision unless they are with a leaseholder. Only leaseholders, their immediate families, and Hume Lake full-time staff may drive off-road vehicles on the property. All drivers must be licensed, 16 or older, and obey Hume rules. No off-road riding is allowed on Hume Lake property. Use the roads at your own risk.

**PROTECTION AND PRIVACY:** Please refrain from capturing and posting stills or videos of campers not related to you to respect campers' privacy.

**CAMP LEADERSHIP:** Please respect all staff requests regarding camp operations and the Rules and Regulations. The HLCC staff's primary responsibility is to facilitate the camping ministry, and the ministry's needs take precedence on the HLCC property.

**SEXUAL ACTIVITY:** We require that all Leaseholders and Guests refrain from unbiblical sexual activity. Unbiblical sexual activity includes unmarried sexual behavior, extra-marital sexual behavior, same-sex sexual behavior, or same-sex romantic expressions. Pornography or any media with explicit sexual content is prohibited on HLCC property. We believe the Bible teaches that sexual union is reserved for marriage, which is the covenant union of love between one man and one woman. We encourage sexual relations among married couples and want marriages to thrive.

**YOUTH MEETINGS:** Youth meetings are for HLCC registered campers only.

**CAMP AND DORM ACCESS:** Walking in or around camper housing areas is not permitted. Meadow Ranch, Wagon Train, and Wildwood are closed camps, and guests are not allowed in these camps.

**QUIET HOURS AND CAMPER CURFEW:** Out of respect for others, please keep noise down before 8:00 AM and after 10:00 PM. There is an 11:00 PM curfew for the HLCC camping programs. Leaseholders and Guests should not be near any HLCC camp areas after 11:00 pm.

**HLCC FACILITIES:** All non-public camp buildings and facilities are off-limits to leaseholders, subdivision guests, and renters unless specific permission has been granted by Hume Lake staff. Please see the Welcome Center for details.

**FIRES:** Open fires, including fire pits, and barbecue pits, are prohibited unless authorized annually by a permit from the Forest Service and subject to any HLCC restrictions in effect. Propane barbeques and firepits are generally allowed unless there are restrictions in effect.

**FIREARMS:** Guests and Renters are not allowed to bring firearms, airguns, bow and arrows, or any dangerous weapons on HLCC property or the Subdivision. For more details, please ask the Welcome Center for a copy of the complete Firearm Policy.

**FIREWORKS:** Fireworks are not permitted in the National Park, National Forest, or HLCC property and the Subdivision.

**CHILDREN:** Children 12 and under are not permitted to be unattended on the grounds. Parents are legally responsible for their minor dependent's actions while at HLCC and the Subdivision.

**WATER CONSERVATION:** There is a limited supply of water at Hume Lake. Please help us conserve water by taking short showers and not washing cars or watering landscape while you are here. Please let the leaseholder know if you see any water leaks. During drought conditions, we may require additional restrictions on water usage.

**GARBAGE:** Garbage can be taken to the garbage facility just past the Wagon Train Pavilion from 8:00 am - 3:00 pm. No building materials, mattresses, used furniture, appliances, needles, or trimmings may be left there. Please take all building materials and furniture down the hill.

**GENERAL UNCHRISTIAN OR DISTRACTING CONDUCT:** These Rules and Regulations are not intended to be comprehensive. There may be other behaviors that prove to be unbiblical or distractions to the mission of HLCC (ex. fighting, hazing, profanity, gambling, abusive language, etc.) Leaseholders and Guests in the Subdivision should be mindful of the atmosphere HLCC is trying to create on its property.

# OUR MISSION STATEMENT

We desire that each person coming into contact with this global ministry will:

*Accept Jesus Christ as their personal Savior*

*Grow in their faith and Christian character development*

*Establish the priorities of prayer, Bible study, and Christian fellowship while associating with a local church*

*Devote their lives in service to our Lord Jesus at home and abroad*

We will continue to emphasize ministries to youth.

## HUME LAKE CHRISTIAN CAMPS DOCTRINAL STATEMENT OF BELIEF

1. We believe in the Scripture of the Old and New Testament as verbally inspired by God, inerrant in the original writings, and that they are of supreme and final authority in faith and life.
2. We believe in one God, eternally existing in three persons: Father, Son and Holy Spirit.
3. We believe that Jesus Christ was begotten by the Holy Spirit, and born of the Virgin Mary and is true God and true man.
4. We believe that man was created in the image of God; that he sinned, and thereby incurred, not only physical death, but also Spiritual death which is separation from God; and that all human beings are born with a sinful nature, and in the case of those who reach moral responsibility become sinners in thought, word, and deed.
5. We believe that the Lord Jesus Christ died for our sins according to the Scriptures, as a representative and substitutionary sacrifice; and that all that believe in Him are justified on the grounds of His shed blood.
6. We believe in the resurrection of the crucified body of our Lord, in His Ascension to Heaven, in His present life there for us, as High Priest and Advocate.
7. We believe in "that blessed hope." the personal, premillennial, and imminent return of our Lord and Savior, Jesus Christ.
8. We believe that all who receive by faith the Lord Jesus Christ are born again of the Holy Spirit and thereby become children of God.
9. We believe in the bodily resurrection of the just and the unjust, the everlasting blessedness of the saved, and the everlasting, conscious punishment of the lost.
10. We believe in the great commission which Our Lord has given to His Church to evangelize the world, and that this evangelization is the great mission of the Church.

# THINGS TO DO WHILE AT HUME LAKE

**SUNDAY CHURCH:** Sunday morning worship service begins at 10:30 am in the Ponderosa Chapel. Children's church and the nursery are available during this time, with limited capacity.

**HUME LAKE SUMMER TEACHING SERIES:** You are invited to hear gifted speakers teach God's word weekly at the Hume Teaching Series. Meetings are held in the Memorial Chapel Sunday through Thursday at 7:00 pm.

**PONDEROSA OPENER:** There is a public performance of the Ponderosa Opener on Sunday. Tickets are sold in the Welcome Center.

**DAY CAMP:** This program is open to children entering 1<sup>st</sup> through 6<sup>th</sup> grades. Morning and evening sessions are held during the summer season only. Please see the Welcome Center for hours and costs.

**HUME LAKE RETAIL:** During your stay with us, we encourage you to do some shopping at the Hume Lake General Store, Hume Supply Co., and the Hume Lake Clothing Co.

**CONCESSIONS:** Don't miss out on relaxing and eating great food at the Snack Shop, Ponderosa Pizza and Pizzookie (AKA the "Triple P"), and the Hume Coffee Co.

**WATERFRONT:** Boats, paddleboards, bikes, and other recreational equipment are available to rent at the Boat House. A list of summer hours and rates is available at the Welcome Center.

**MEADOW RANCH POND AND ARK:** Use of the Pond, which includes the Blob and Noah's Nightmare, is reserved for registered campers and guests in HLCC lodging. To find out more information, please visit the Welcome Center.

**WELCOME CENTER:** If you have questions or want to find out more about what is available to leaseholders, guests, and renters, please go to the Welcome Center for more information. The Welcome Center has more details about Ponderosa Opener Tickets, Pool tickets, Day Camp, Waterfront rentals, MR Pond, Daily activities, Hume Teaching Series Schedule, and much more.

**ACTIVITIES:** Please go to the Activities Center for more information or to sign up for activities such as High Ropes Course, 4x4 Tours, Paintball, Mountain Bike Tours, and Hume Tours.

We hope you have a fantastic stay at Hume Lake Christian Camps that includes making new memories, resting, relaxing, and growing closer to Christ while you are here. We ask while you are here to pray for God to do life-changing work in the lives of everyone that comes in contact with the ministry of Hume Lake Christian Camps.

-  Leased Lot W/ Cabin
-  Leased Lot Unimproved
-  HLC Lot W/ Cabin
-  HLC Lot Unimproved



# WELCOME TO *Hume Lake* SUBDIVISION

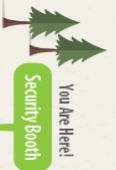
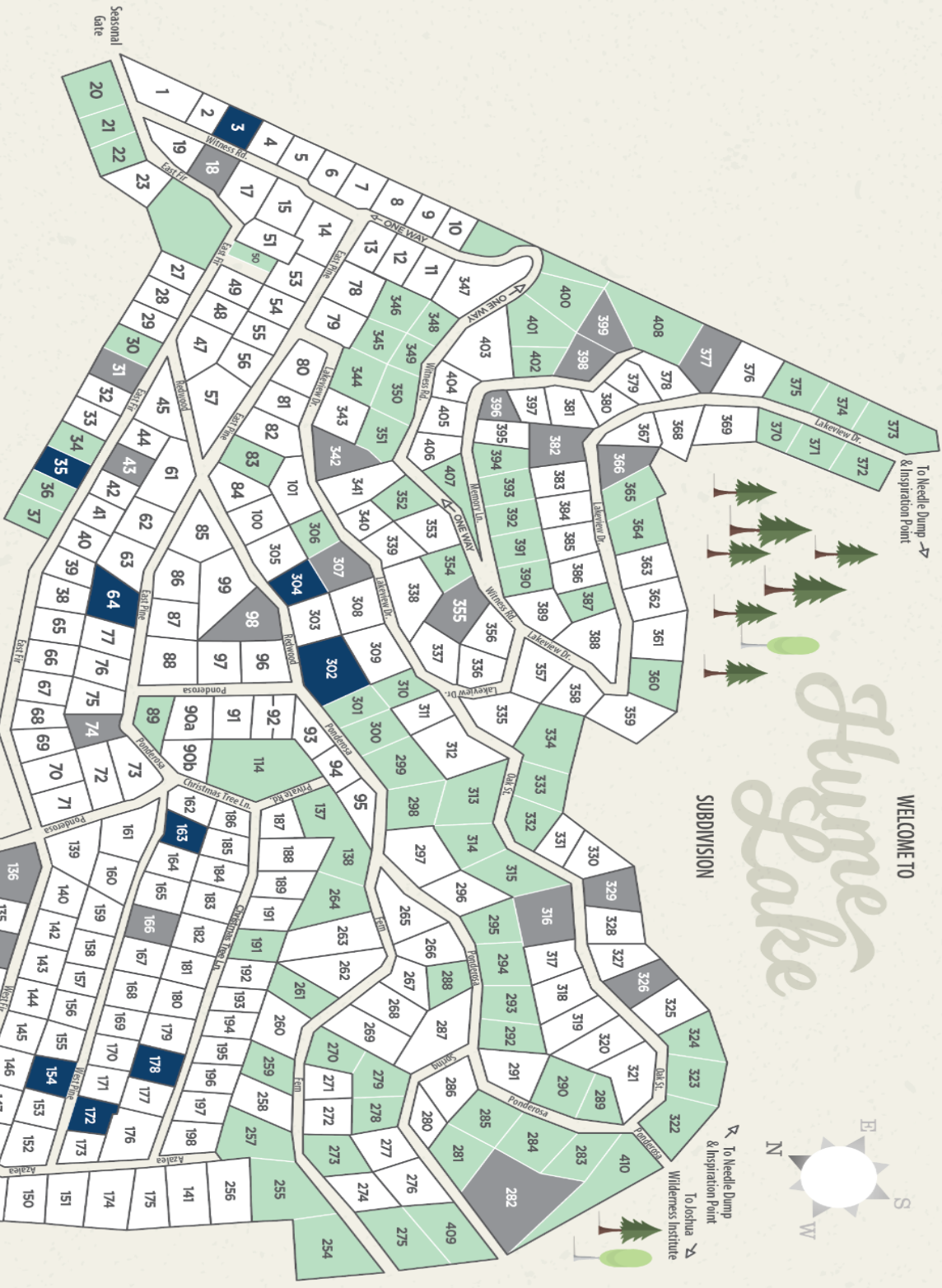

Meadow Ranch Pond

Long Meadow Rd

Staff Circle

Long Meadow Rd

To Wagon Train Camp