

# Aerial Map



map center: 41° 13' 0.04, 87° 52' 59.27

scale: 9451

**31-32N-12E**  
**Kankakee County**  
**Illinois**



4/21/2014

Maps Provided By:



© AgriData, Inc. 2014 www.AgriDataInc.com

# ANTENO

# T.32N.-R.12



WILL COUNTY

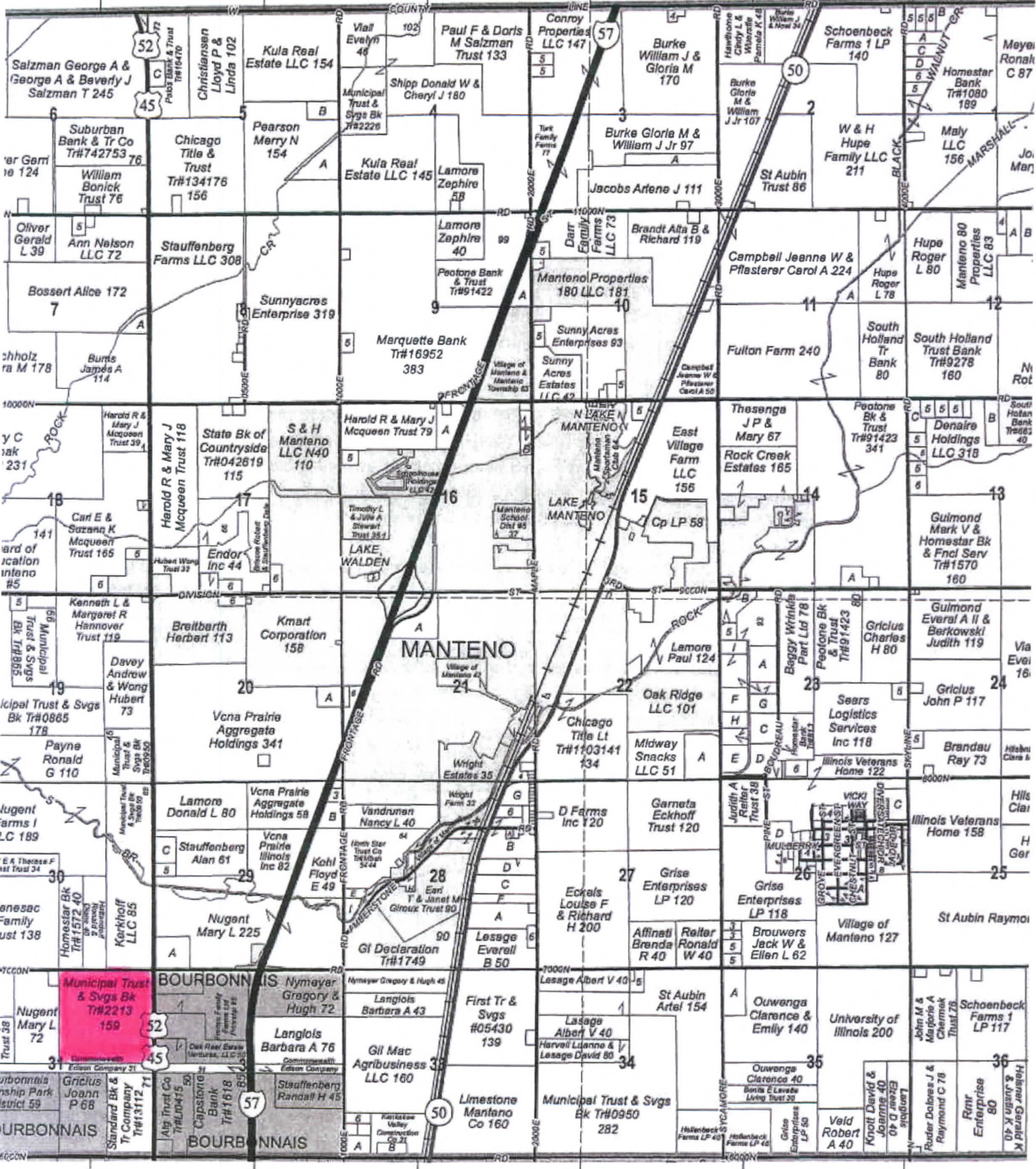

0000E      1000E      2000E      3000E      4000E

# Soil Map

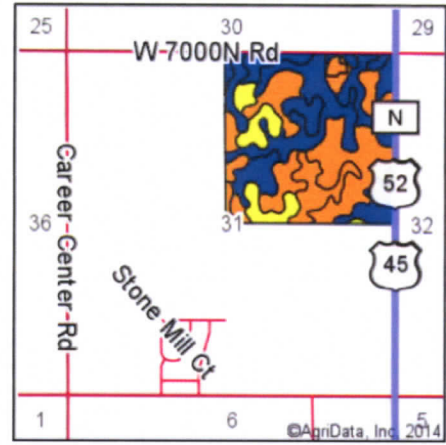
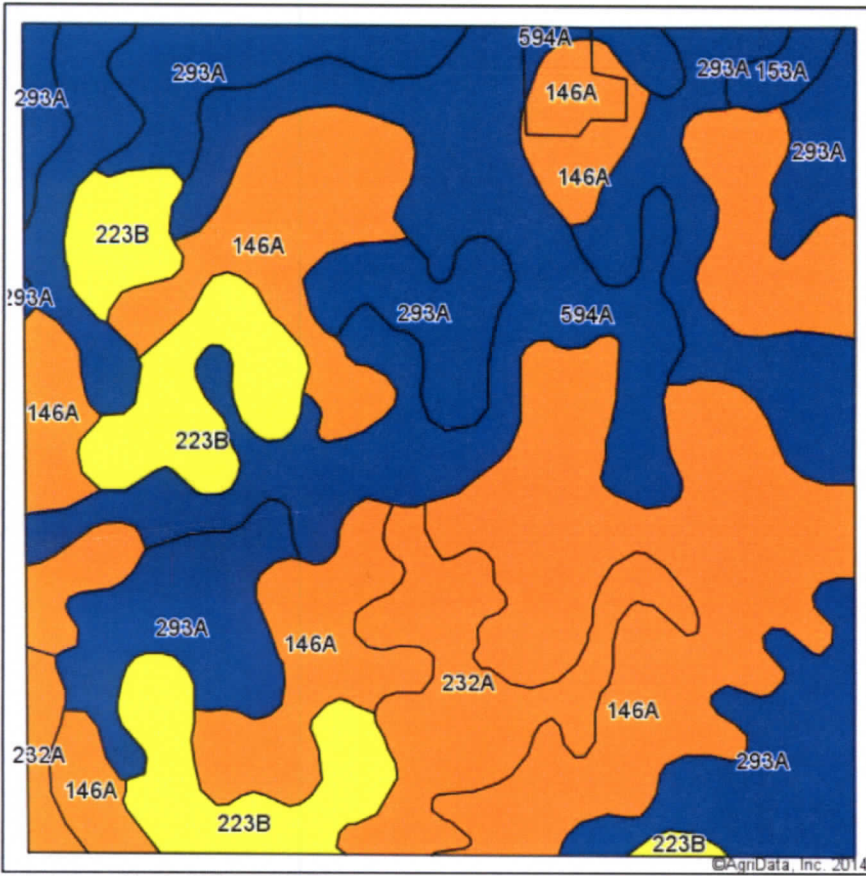

State: Illinois  
 County: Kankakee  
 Location: 31-32N-12E  
 Township: Manteno  
 Acres: 158.88  
 Date: 4/21/2014



Maps Provided By:  
  
 CUSTOMIZED ONLINE MAPPING  
 © AgriData, Inc. 2014 www.AgriDataInc.com

Soils data provided by USDA and NRCS.

Area Symbol: IL091, Soil Area Version: 9

Code	Soil Description	Acres	Percent of field	Ill. State Productivity Index Legend	Subsoil rooting <sup>a</sup>	Corn Bu/A	Soybeans Bu/A	Wheat Bu/A	Oats Bu/A <sup>b</sup>	Sorghum <sup>c</sup> Bu/A	Alfalfa <sup>d</sup> hay, T/A	Grass-legume <sup>e</sup> hay, T/A	Crop productivity index for optimum management
146A	Elliott silt loam, 0 to 2 percent slopes	59.21	37.3%		FAV	168	55	68	87	0	0.00	5.02	125
293A	Andres silt loam, 0 to 2 percent slopes	39.40	24.8%		FAV	184	59	71	97	0	0.00	5.39	135
594A	Reddick clay loam, 0 to 2 percent slopes	31.03	19.5%		FAV	177	56	66	89	0	0.00	5.14	130
**223B	Varna silt loam, 2 to 4 percent slopes	15.97	10.1%		FAV	**156	**50	**63	**78	0	**4.84	0.00	**115
232A	Ashkum silty clay loam, 0 to 2 percent slopes	11.99	7.5%		FAV	170	56	65	85	0	0.00	5.14	127
153A	Pella silty clay loam, 0 to 2 percent slopes	1.28	0.8%		FAV	183	60	70	92	0	0.00	5.27	136
<b>Weighted Average</b>						<b>172.8</b>	<b>55.8</b>	<b>67.6</b>	<b>88.9</b>	<b>*</b>	<b>0.49</b>	<b>4.64</b>	<b>127.7</b>

Area Symbol: IL091, Soil Area Version: 9

**Table: Optimum Crop Productivity Ratings for Illinois Soil by K.R. Olson and J.M. Lang, Office of Research, ACES, University of Illinois at Champaign-Urbana.** Version: 1/2/2012 Amended Table S2 B811 (Updated 1/10/2012)

Crop yields and productivity indices for optimum management (B811) are maintained at the following NRES web site: <http://soilproductivity.nres.illinois.edu/>

\*\* Indexes adjusted for slope and erosion according to Bulletin 811 Table S3

<sup>a</sup> UNF = unfavorable; FAV = favorable

<sup>b</sup> Soils in the southern region were not rated for oats and are shown with a zero "0".

<sup>c</sup> Soils in the northern region or in both regions were not rated for grain sorghum and are shown with a zero "0".

<sup>d</sup> Soils in the poorly drained group were not rated for alfalfa and are shown with a zero "0".

<sup>e</sup> Soils in the well drained group were not rated for grass-legume and are shown with a zero "0".

Field borders provided by Farm Service Agency as of 5/21/2008. Aerial photography provided by Aerial Photography Field Office.