

# Aerial Map



© AgriData, Inc. 2014

map center: 41° 14' 53.74, 87° 51' 2.51  
scale: 3208

21-32N-12E  
Kankakee County  
Illinois



4/21/2014

Maps Provided By:  
 **surety**<sup>®</sup>  
CUSTOMIZED ONLINE MAPPING  
© AgriData, Inc. 2014 www.AgriDataInc.com



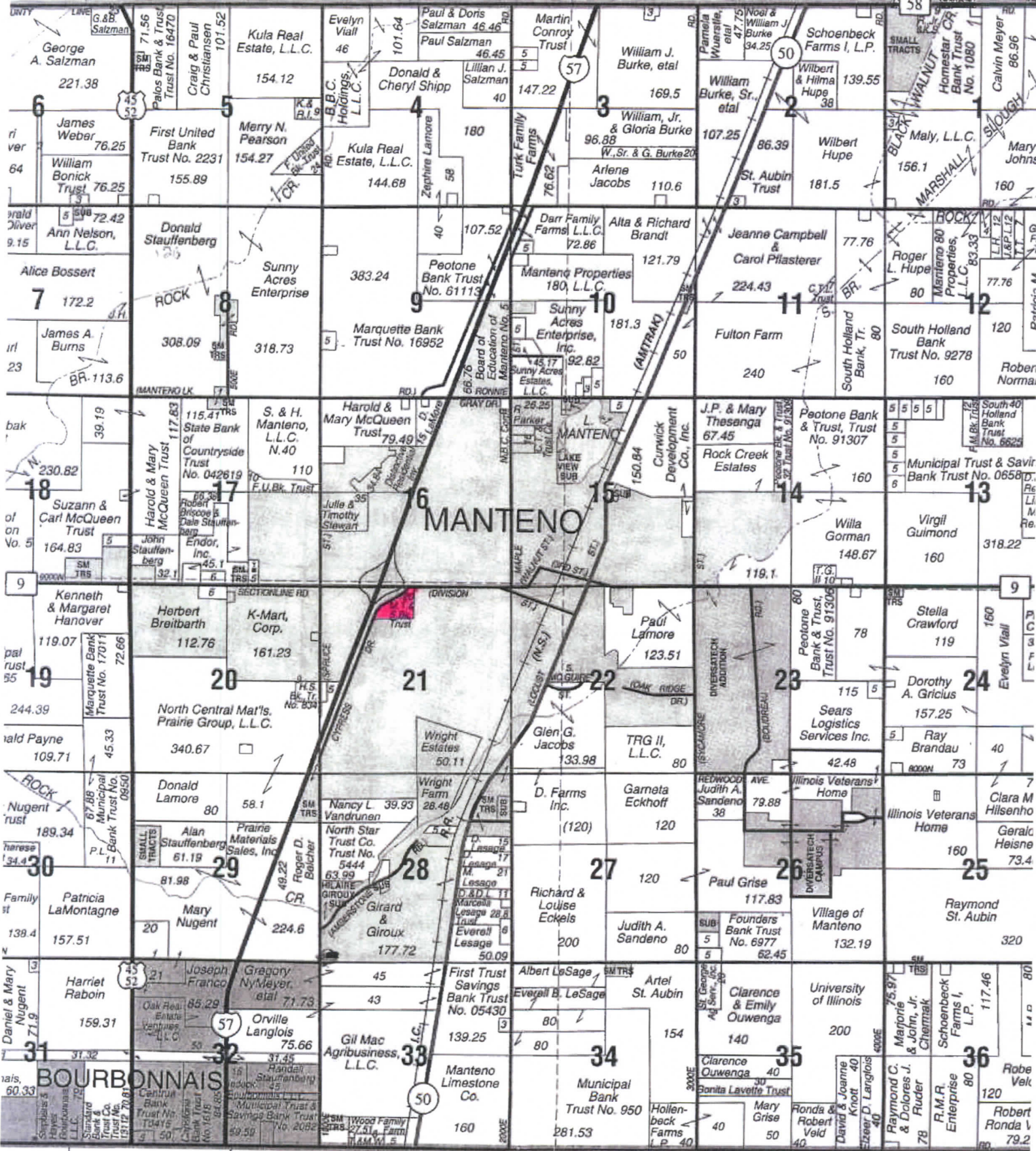



# Soil Map

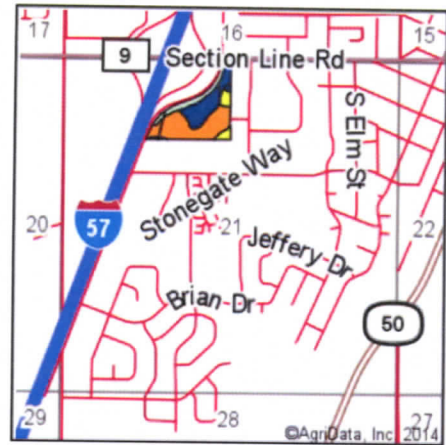
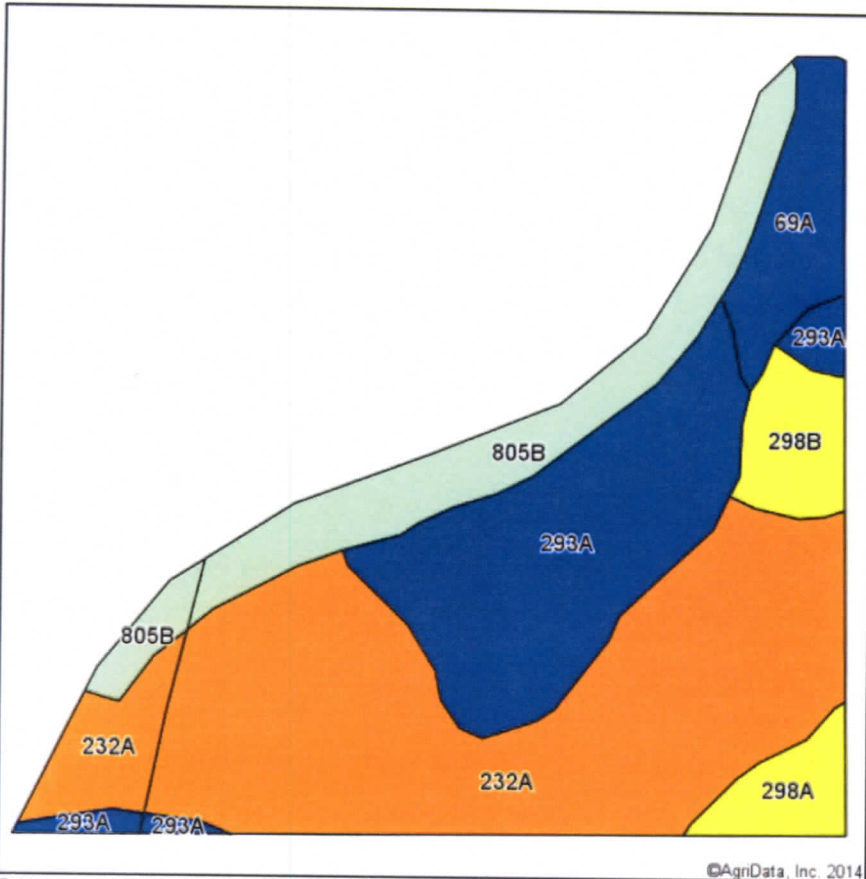

State: Illinois  
 County: Kankakee  
 Location: 21-32N-12E  
 Township: Manteno  
 Acres: 20.84  
 Date: 4/21/2014



Maps Provided By:  
  
 CUSTOMIZED ONLINE MAPPING  
 © AgriData, Inc. 2014 www.AgriDataInc.com

Soils data provided by USDA and NRCS.

Area Symbol: IL091, Soil Area Version: 9

Code	Soil Description	Acres	Percent of field	Il. State Productivity Index Legend	Subsoil rooting <sup>a</sup>	Corn Bu/A	Soybeans Bu/A	Wheat Bu/A	Oats Bu/A	Sorghum <sup>c</sup> Bu/A	Alfalfa <sup>d</sup> hay, T/A	Grass-legume <sup>e</sup> hay, T/A	Crop productivity index for optimum management
232A	Ashkum silty clay loam, 0 to 2 percent slopes	9.85	47.3%		FAV	170	56	65	85	0	0.00	5.14	127
293A	Andres silt loam, 0 to 2 percent slopes	5.04	24.2%		FAV	184	59	71	97	0	0.00	5.39	135
805B	Orthents, clayey, undulating	2.88	13.8%		CROP YIELD DATA NOT AVAILABLE								
69A	Milford silty clay loam, 0 to 2 percent slopes	1.40	6.7%		FAV	171	57	68	88	0	0.00	5.52	128
**298B	Beecher silt loam, 2 to 4 percent slopes	0.94	4.5%		FAV	**150	**50	**60	**78	0	0.00	**4.59	**113
298A	Beecher silt loam, 0 to 2 percent slopes	0.73	3.5%		FAV	152	51	61	79	0	0.00	4.64	114
<b>Weighted Average</b>						<b>148.3</b>	<b>48.5</b>	<b>57.2</b>	<b>75.7</b>	<b>-0.1</b>	<b>-0.14</b>	<b>4.34</b>	<b>110.2</b>

Area Symbol: IL091, Soil Area Version: 9

**Table: Optimum Crop Productivity Ratings for Illinois Soil by K.R. Olson and J.M. Lang, Office of Research, ACES, University of Illinois at Champaign-Urbana.** Version: 1/2/2012 Amended Table S2 B811 (Updated 1/10/2012)

Crop yields and productivity indices for optimum management (B811) are maintained at the following NRES web site: <http://soilproductivity.nres.illinois.edu/>

\*\* Indexes adjusted for slope and erosion according to Bulletin 811 Table S3

<sup>a</sup> UNF = unfavorable; FAV = favorable

<sup>b</sup> Soils in the southern region were not rated for oats and are shown with a zero "0".

<sup>c</sup> Soils in the northern region or in both regions were not rated for grain sorghum and are shown with a zero "0".

<sup>d</sup> Soils in the poorly drained group were not rated for alfalfa and are shown with a zero "0".

<sup>e</sup> Soils in the well drained group were not rated for grass-legume and are shown with a zero "0".

Field borders provided by Farm Service Agency as of 5/21/2008. Aerial photography provided by Aerial Photography Field Office.