

# SR210A-210/3.05-DW

**SR210A-210/3.05-DW**

**Max.load capacity at wrist 210kg, Max.reach 3050mm**

- Advantages

**High Performance and Precision:** Advanced drive technologies coupled with precision manufacturing processes guarantee high accuracy and stability when executing a variety of intricate tasks.

**Unique Dive Design:** A specifically designed dive structure allows for extended reach into narrow and deep cavities, enhancing accessibility and operational efficiency in complex workstations.

**Ease of Programming and Integration:** Equipped with a user-friendly programming interface and a comprehensive suite of software tools, the process of programming and debugging the robot becomes more straightforward and expedient.

**Stability and Durability:** Utilizing high-quality materials and components, and subjected to rigorous testing, ensures long-term operational stability, minimizing downtime and maintenance expenses.

- Application

## Handling, Assembly, Loading and Unloading, Casting ,etc.

- Installation

## Floor



## SPECIFICATIONS

Axes	Motion range	Maximum speed	Moment	Inertia	Payload	210kg
J1	±180°	90°/s	-	-	Repeatability	±0.06mm
J2	+40°, - 155°	80°/s	-	-	Max.reach	3050mm
J3	+170°, - 70°	85°/s	-	-	Body Weight	1500kg
J4	±360°	160°/s	1274N·m	120kg·m²	Protection (wrist)	IP67
J5	±125°	120°/s	1274N·m	120kg·m²	Input Power	8kW
J6	±360°	220°/s	686N·m	70kg·m²	Pre-installed Singal Cables	32cores, 0.2mm² per conductor

## WORKING RANGE

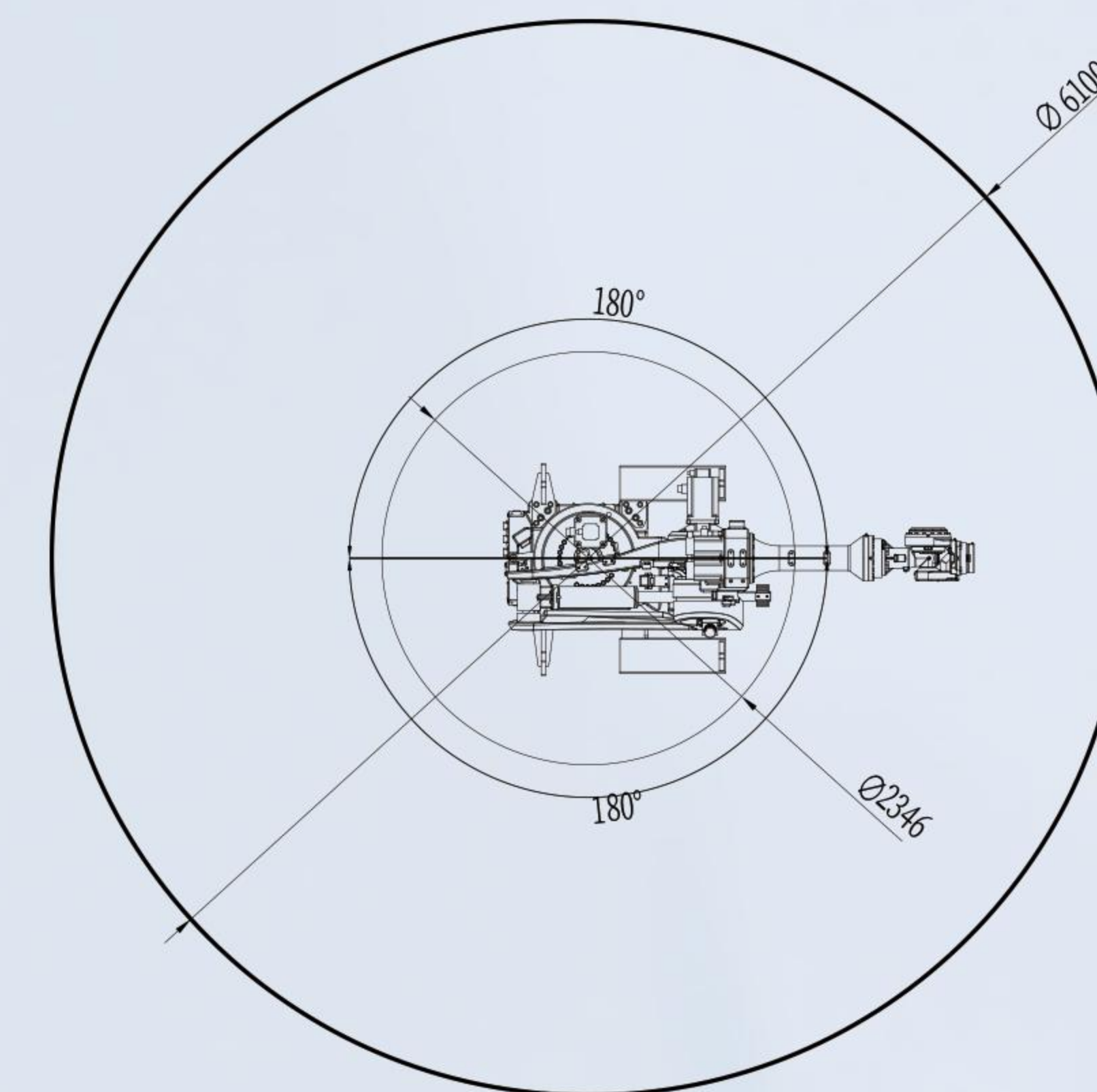
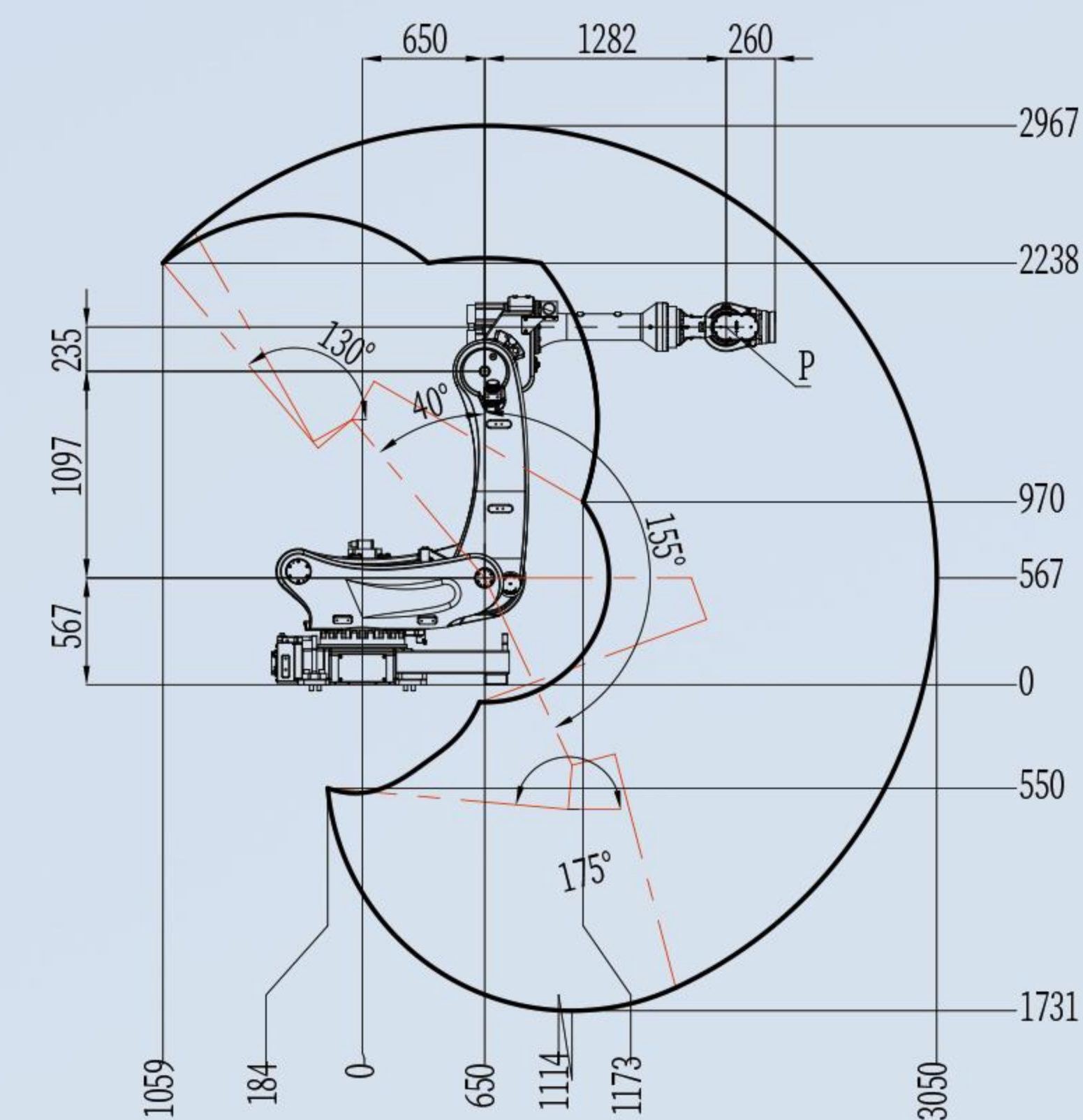

## BASE MOUNTING SIZE

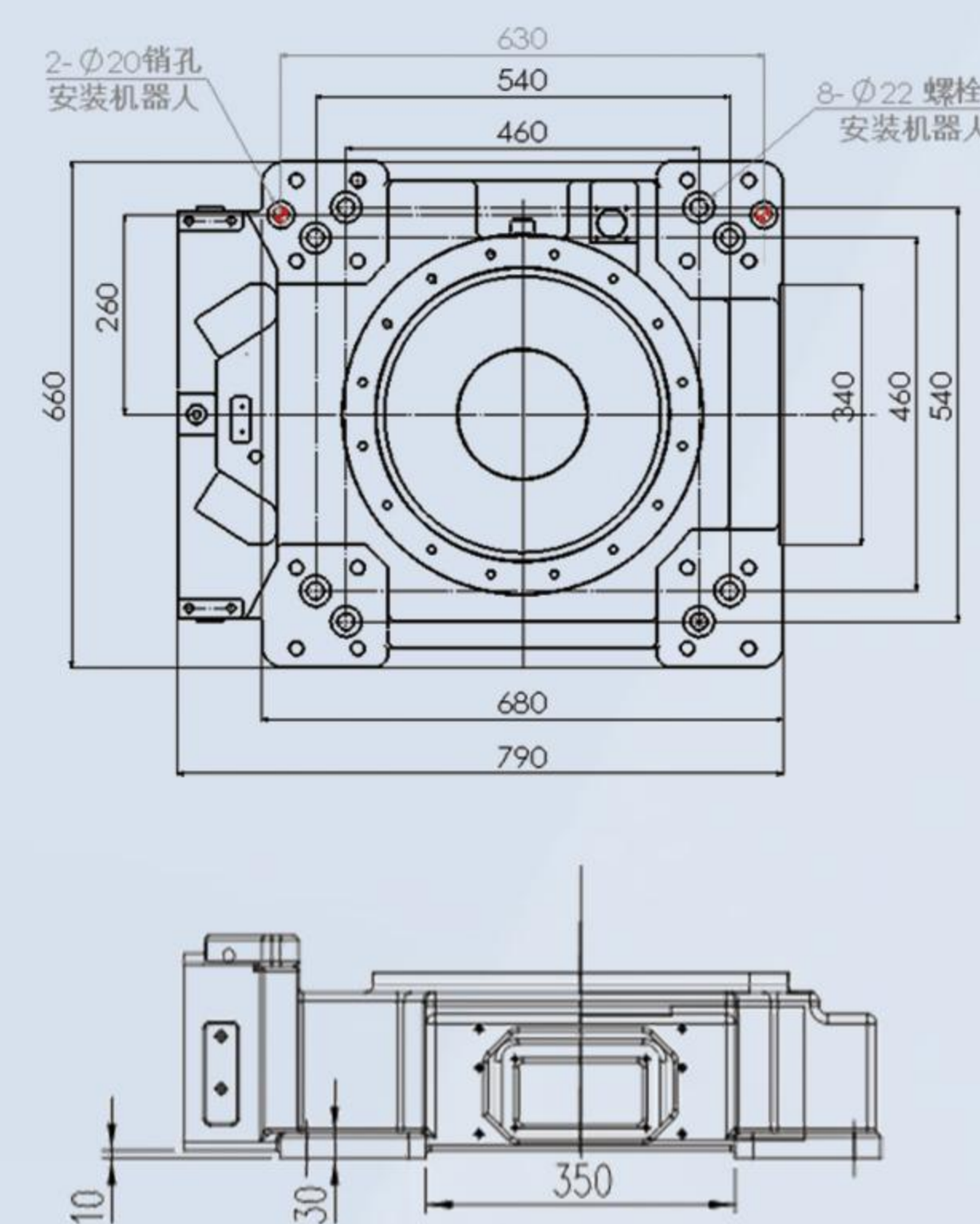

## END FLANGE MOUNTING SIZE

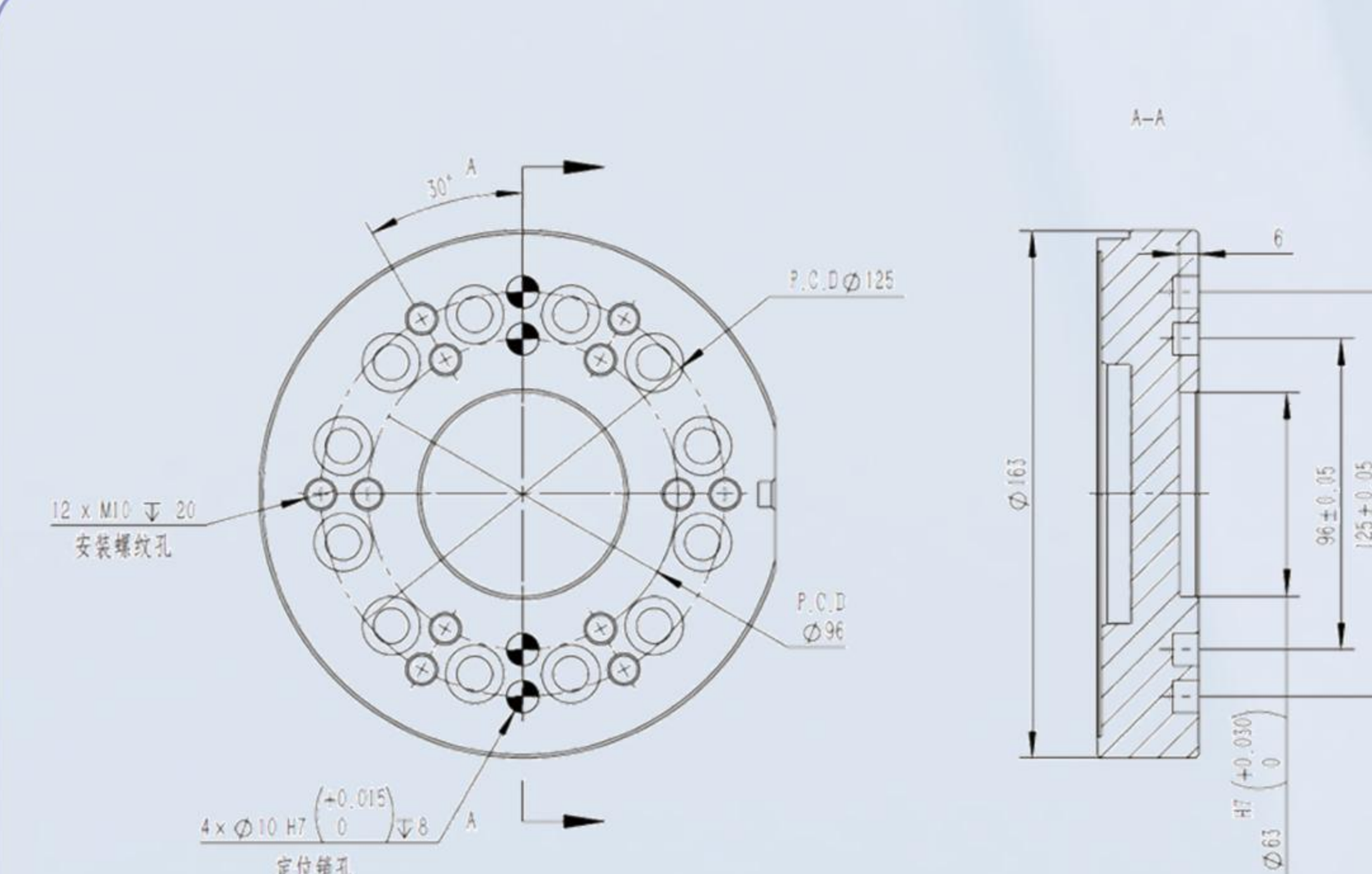

**SIASUN ROBOT & AUTOMATION CO., LTD.**

Add:NO.33 Quanyun Road,Hunnan District,Shenyang,P.R.China.  
Tel-China:+86 400 800 8666  
E-mail:market@siasun.com  
VER: SX023007-V1.0