



Wasser erleben

# HANSAFIT

INSTALLATION AND MAINTENANCE GUIDE





## Contents

<b>CZ</b> Obsah	<b>FI</b> Sisällysluettelo	<b>IT</b> Indice	<b>PT</b> Conteúdo
<b>DE</b> Inhaltsübersicht	<b>FR</b> Sommaire	<b>NL</b> Inhoud	<b>RU</b> Содержание
<b>DK</b> Indholdsfortegnelse	<b>GR</b> Περιεχόμενα	<b>NO</b> Innhold	<b>SE</b> Innehållsförteckning
<b>ES</b> Contenidos	<b>HU</b> Tartalom	<b>PL</b> Spis treści	<b>SK</b> Obsah



Technical data.....	13
Installation .....	15
Operation .....	25
Maintenance .....	28-32



Technical data.....	14
Installation .....	15-19, 24
Operation .....	26
Maintenance .....	28-32



Technical data.....	14
Installation .....	15, 20-26
Operation .....	27
Maintenance .....	28-32

## 6514 0101

EN 1111

100 - 1000 kPa

0.27 l/s (300 kPa)

160 kPa (0.2 l/s)

0.21 l/s (300 kPa) Eco

max. +80°C

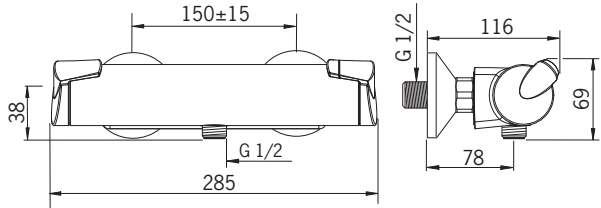



## 6513 2101

EN 1111

I (ISO 3822)

100 - 1000 kPa

0.33 l/s (300 kPa), 250 kPa (0.3 l/s) 

0.23 l/s (300 kPa), 230 kPa (0.2 l/s) 

0.16 l/s (300 kPa) Eco 

max. +80°C

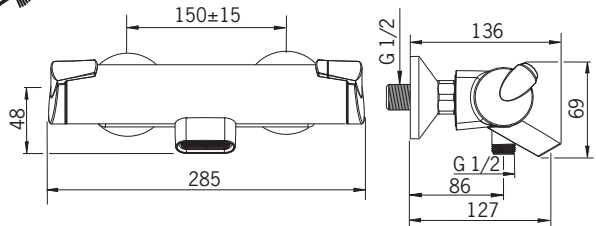

## 6518 0130

EN 1111

I (ISO 3822)

100 - 1000 kPa

0.30 l/s (300 kPa), 300 kPa (0.3 l/s)

0.23 l/s (300 kPa), 230 kPa (0.2 l/s)

0.16 l/s (300 kPa) Eco 

max. +80°C

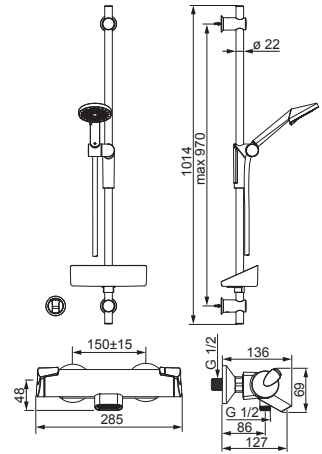

## 6517 0110

EN 1111

I (ISO 3822)

100 - 1000 kPa

0.27 l/s (300 kPa)

160 kPa (0.2 l/s)

0.21 l/s (300 kPa) Eco

max. +80°C

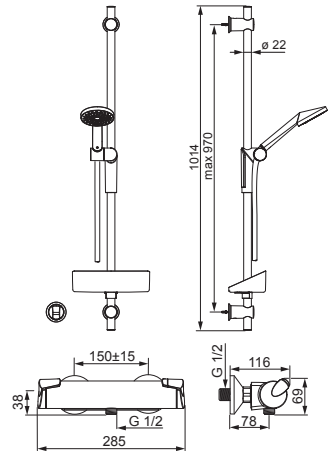

## 6515 9101

EN 1111

I (ISO 3822)

100 - 1000 kPa

0.27 l/s (300 kPa), 160 kPa (0.2 l/s)

0.21 l/s (300 kPa) Eco

max. +80°C

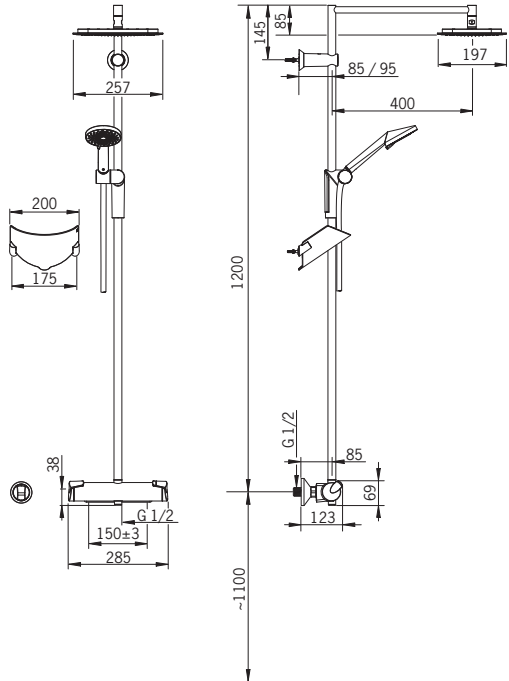

## 6516 2101

EN 1111

I (ISO 3822)

100 - 1000 kPa

0.33 l/s (300 kPa), 250 kPa (0.3 l/s)

0.2 l/s (300 kPa), 300 kPa (0.2 l/s)

0.14 l/s (300 kPa) Eco

max. +80°C

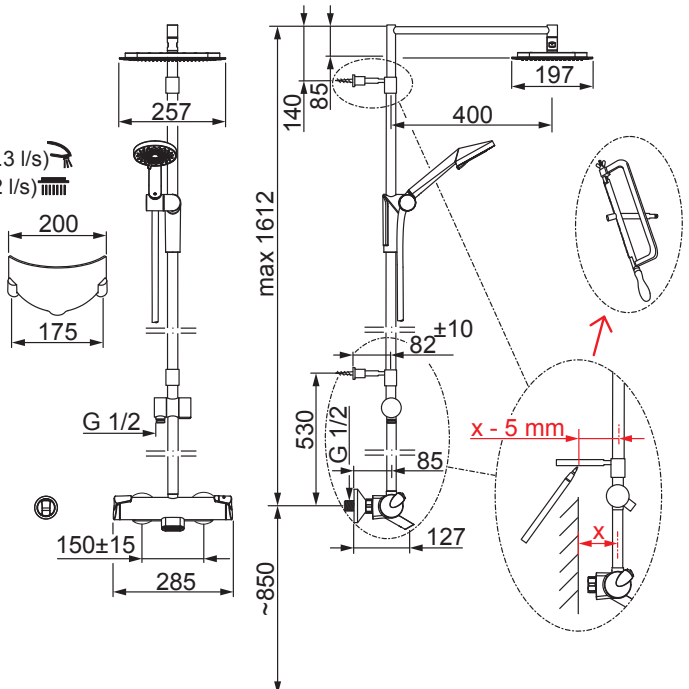

# Installation

**CZ** Montáž

**DE** Montage

**DK** Installation

**ES** Montaje

**FI** Asennus

**FR** Installation

**GR** Συναρμολόγηση

**HU** Szerelés

**IT** Montaggio

**NL** Installatie

**NO** Montering

**PL** Instalacja

**PT** Instruções

**RU** Установка

**SE** Installation

**SK** Inštalácia

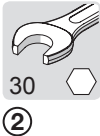
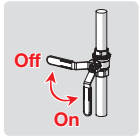

②

max.  
1600 kPa

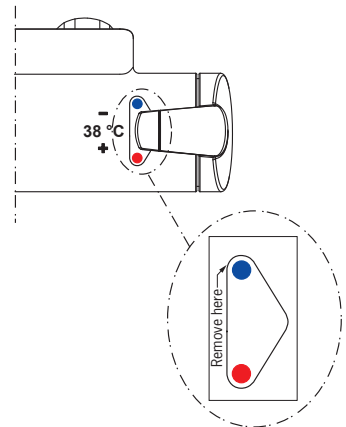
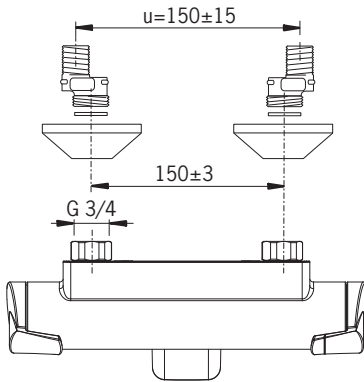
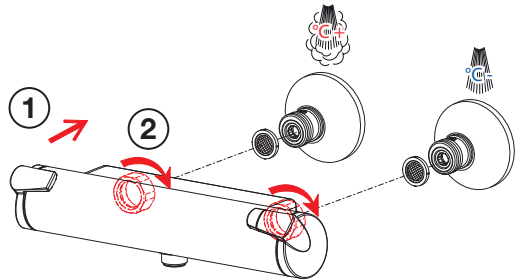

## Installation

**CZ** Montáž

**DE** Montage

**DK** Installation

**ES** Montaje

**FI** Asennus

**FR** Installation

**GR** Συναρμολόγηση

**HU** Szerelés

**IT** Montaggio

**NL** Installatie

**NO** Montering

**PL** Instalacja

**PT** Instruções

**RU** Установка

**SE** Installation

**SK** Inštalácia

**6515 9101**

**A**  x 1

**B**  x 1

**C**  x 4

**D**  x 4

**E**  x 5

**F**  x 1

**G**  x 1

**H**  x 1

 GREASE x 1

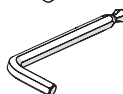
 x 1

**1**

MAX +65°C

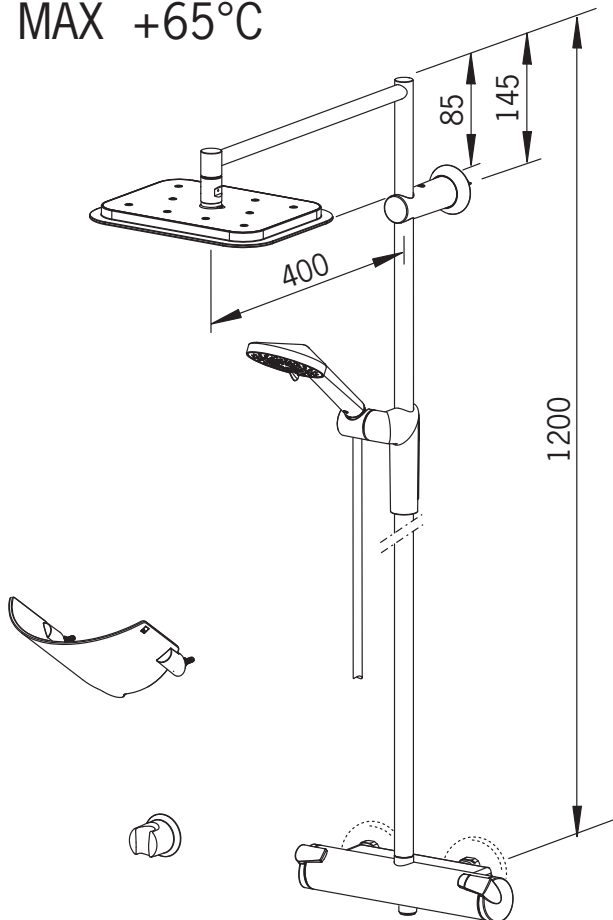



## Installation

**CZ** Montáž

**DE** Montage

**DK** Installation

**ES** Montaje

**FI** Asennus

**FR** Installation

**GR** Συναρμολόγηση

**HU** Szerelés

**IT** Montaggio

**NL** Installatie

**NO** Montering

**PL** Instalacja

**PT** Instruções

**RU** Установка

**SE** Installation

**SK** Inštalácia

2

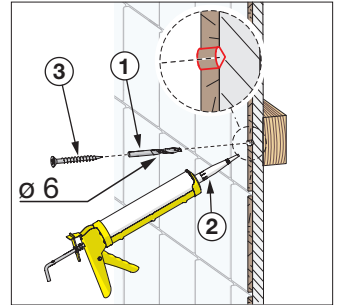
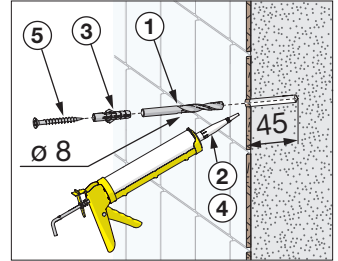
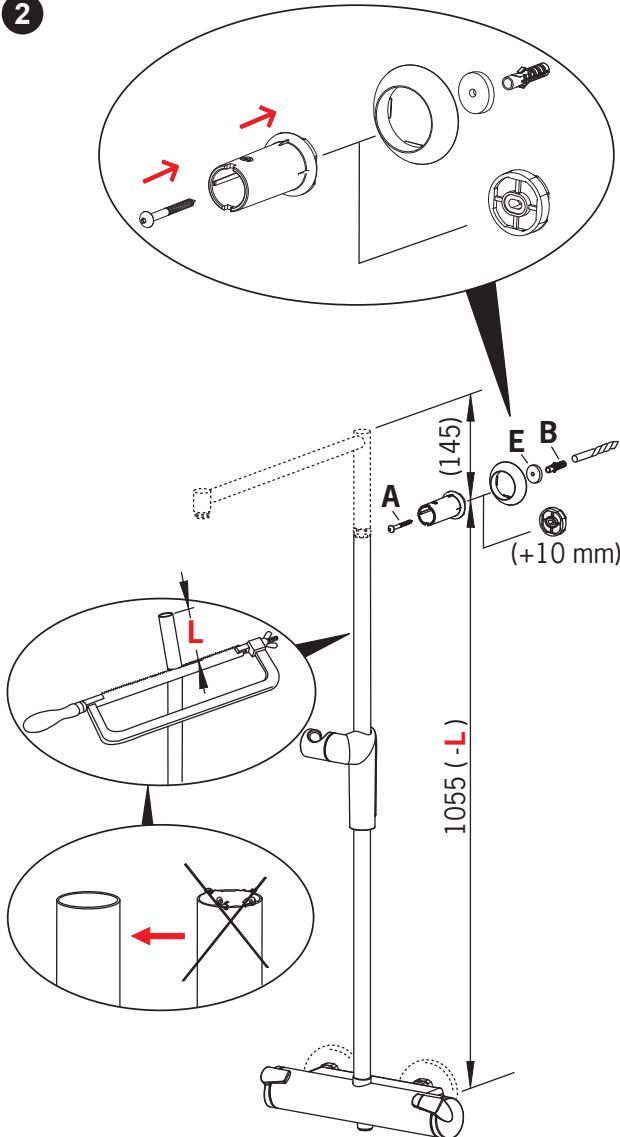

## Installation

**CZ** Montáž

**DE** Montage

**DK** Installation

**ES** Montaje

**FI** Asennus

**FR** Installation

**GR** Συναρμολόγηση

**HU** Szerelés

**IT** Montaggio

**NL** Installatie

**NO** Montering

**PL** Instalacja

**PT** Instruções

**RU** Установка

**SE** Installation

**SK** Inštalácia

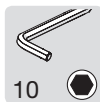

④

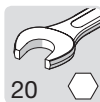

⑤



⑨

③

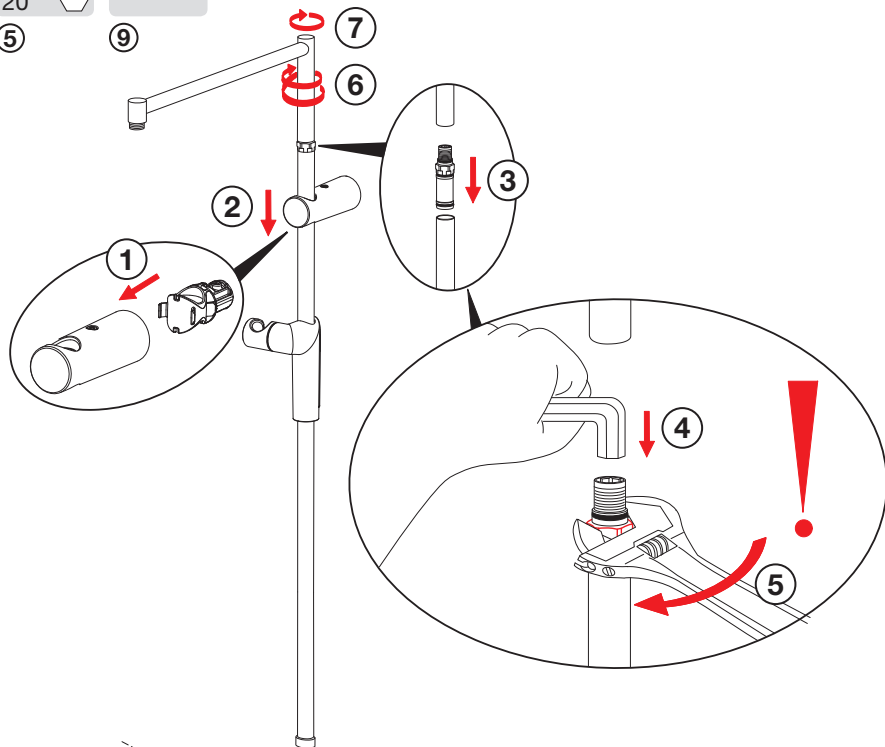

④

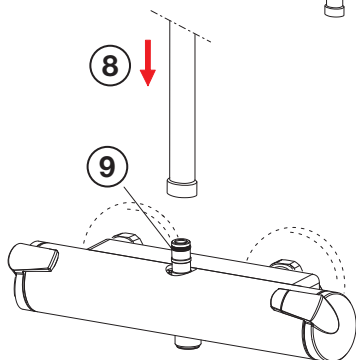

# Installation

**CZ** Montáž  
**DE** Montage  
**DK** Installation  
**ES** Montaje

**FI** Asennus  
**FR** Installation  
**GR** Συναρμολόγηση  
**HU** Szerelés

**IT** Montaggio  
**NL** Installatie  
**NO** Montering  
**PL** Instalacja

**PT** Instruções  
**RU** Установка  
**SE** Installation  
**SK** Inštalácia

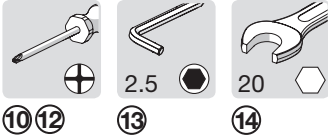

**5**

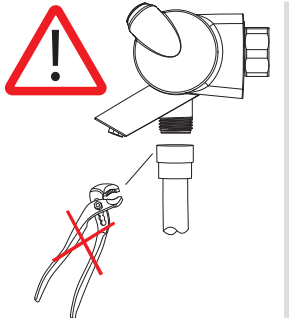
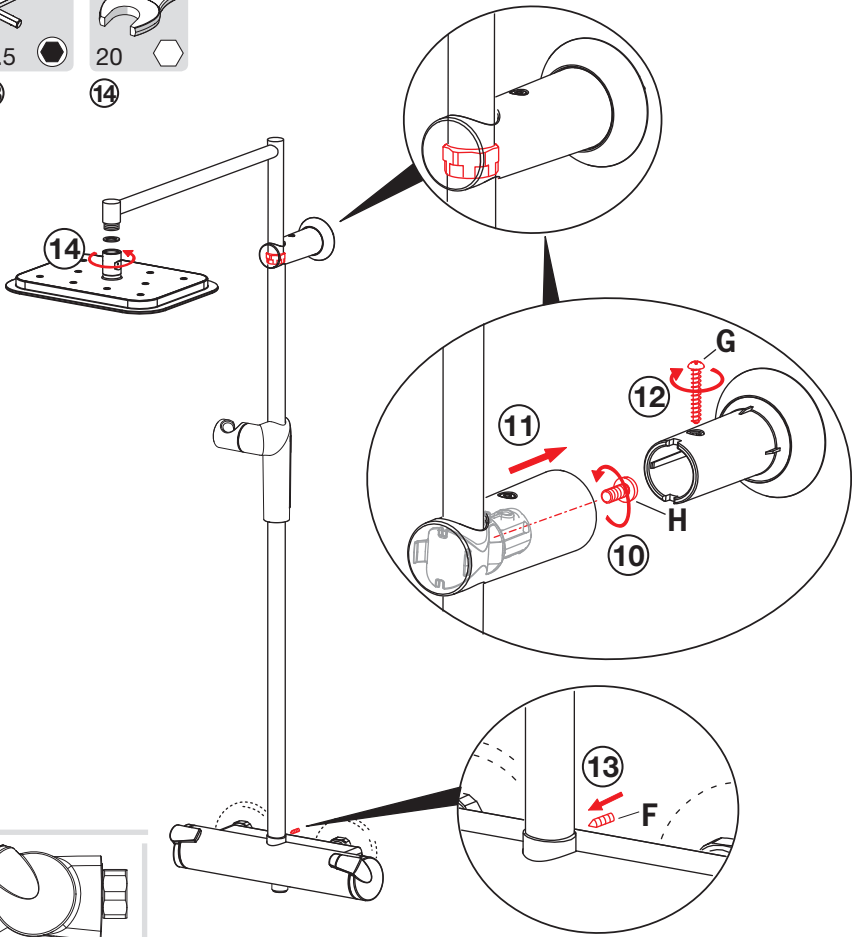

## Installation

**CZ** Montáž

**DE** Montage

**DK** Installation

**ES** Montaje

**FI** Asennus

**FR** Installation

**GR** Συναρμολόγηση

**HU** Szerelés

**IT** Montaggio

**NL** Installatie

**NO** Montering

**PL** Instalacja

**PT** Instruções

**RU** Установка

**SE** Installation

**SK** Inštalácia

**6516 2101**

**A**  x 2

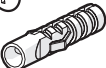
**B**  x 2

**C**  x 4

**D**  x 4

**E**  x 6

**F**  x 2

 GREASE x 1

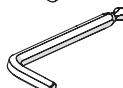
 x 1

**1** MAX +65°C

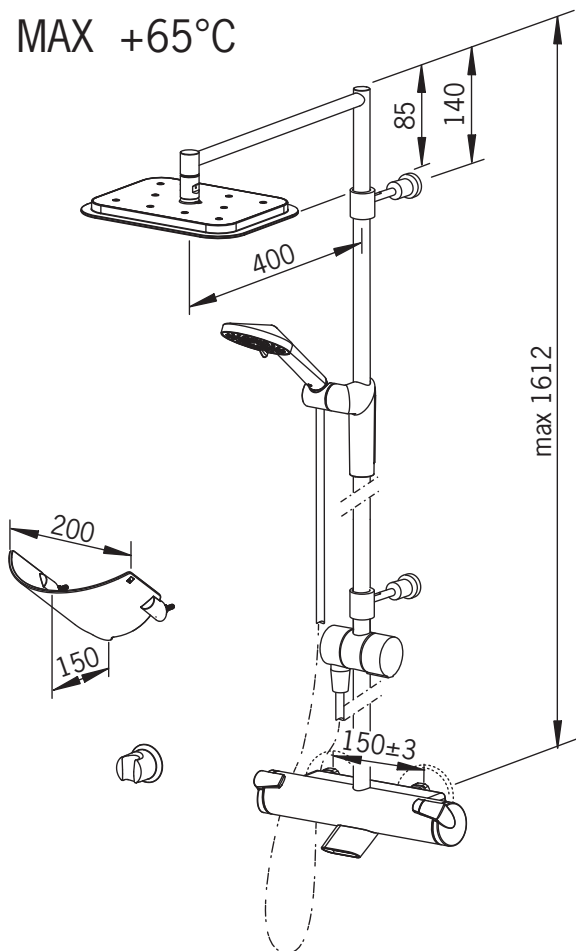

# Installation

**CZ** Montáž  
**DE** Montage  
**DK** Installation  
**ES** Montaje

**FI** Asennus  
**FR** Installation  
**GR** Συναρμολόγηση  
**HU** Szerelés

**IT** Montaggio  
**NL** Installatie  
**NO** Montering  
**PL** Instalacja

**PT** Instruções  
**RU** Установка  
**SE** Installation  
**SK** Inštalácia



2  
 2

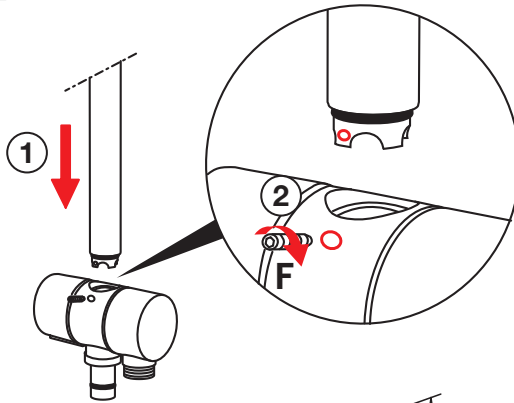

3

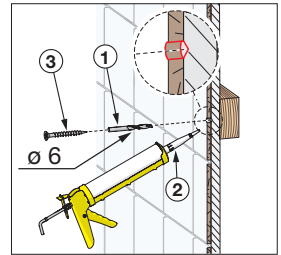
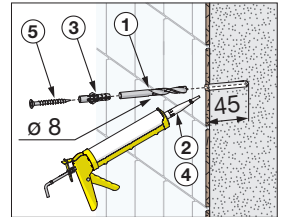
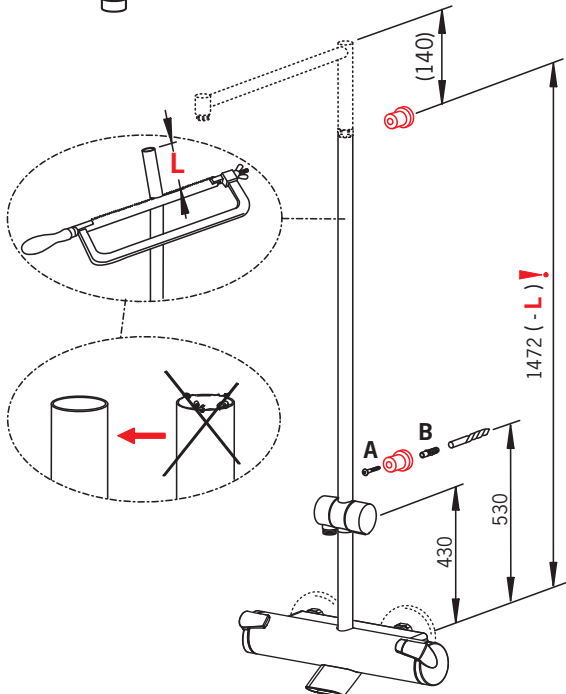

## Installation

**CZ** Montáž

**DE** Montage

**DK** Installation

**ES** Montaje

**FI** Asennus

**FR** Installation

**GR** Συναρμολόγηση

**HU** Szerelés

**IT** Montaggio

**NL** Installatie

**NO** Montering

**PL** Instalacja

**PT** Instruções

**RU** Установка

**SE** Installation

**SK** Inštalácia

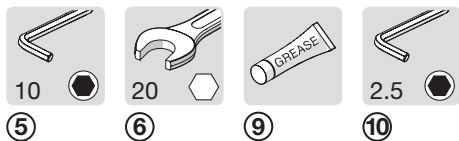

4

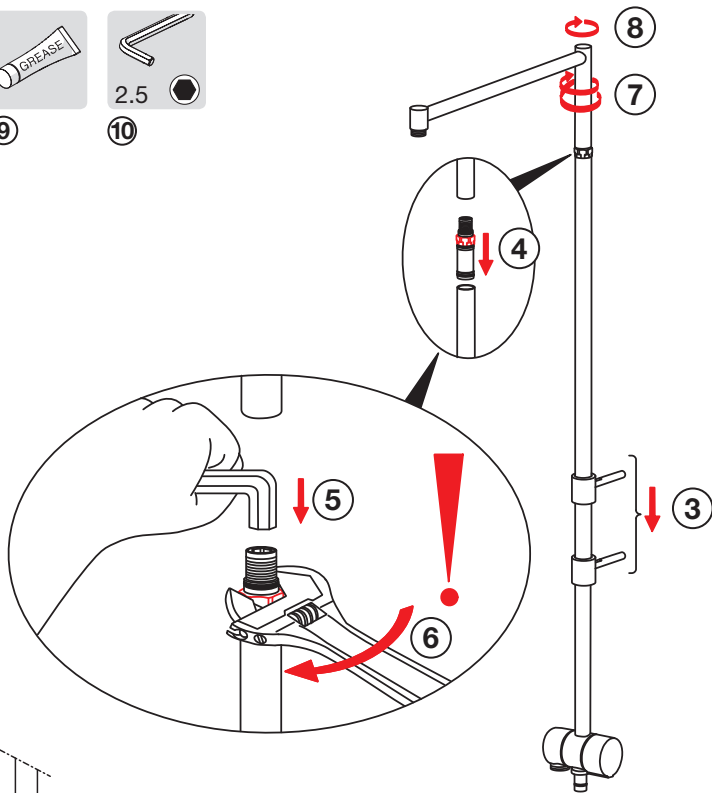

5

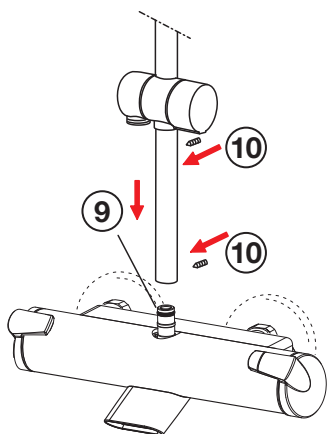

## Installation

**CZ** Montáž

**DE** Montage

**DK** Installation

**ES** Montaje

**FI** Asennus

**FR** Installation

**GR** Συναρμολόγηση

**HU** Szerelés

**IT** Montaggio

**NL** Installatie

**NO** Montering

**PL** Instalacja

**PT** Instruções

**RU** Установка

**SE** Installation

**SK** Inštalácia



13



14

6

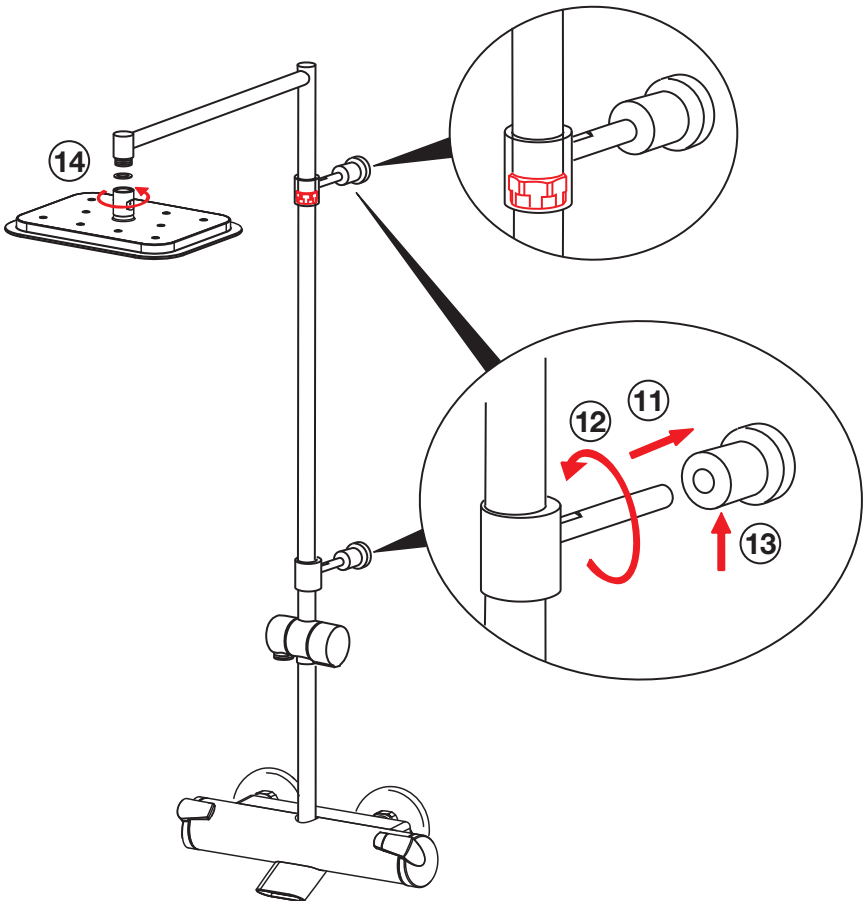

**Installation**

**CZ** Montáž  
**DE** Montage  
**DK** Installation  
**ES** Montaje

**FI** Asennus  
**FR** Installation  
**GR** Συναρμολόγηση  
**HU** Szerelés

**IT** Montaggio  
**NL** Installatie  
**NO** Montering  
**PL** Instalacja

**PT** Instruções  
**RU** Установка  
**SE** Installation  
**SK** Inštalácia



①

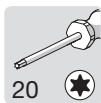
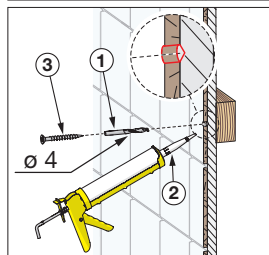
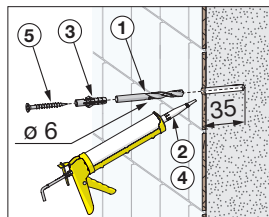
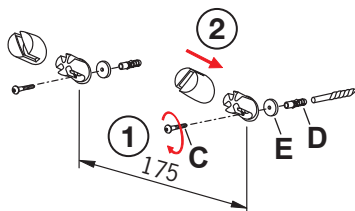
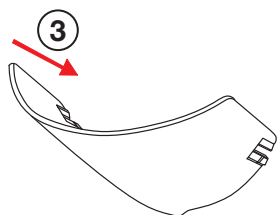

①

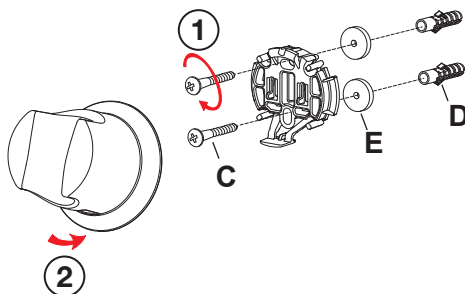
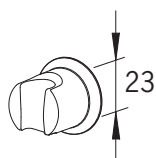



## Operation

**CZ** Funkce  
**DE** Funktion  
**DK** Betjening  
**ES** Servicio

**FI** Toiminta  
**FR** Utilisation  
**GR** Λειτουργία  
**HU** Üzemeltetés

**IT** Funzionamento  
**NL** Bediening  
**NO** Funksjon  
**PL** Działanie

**PT** Funcionamento  
**RU** Принцип действия  
**SE** Funktion  
**SK** Prevádzka

### 6513 2101

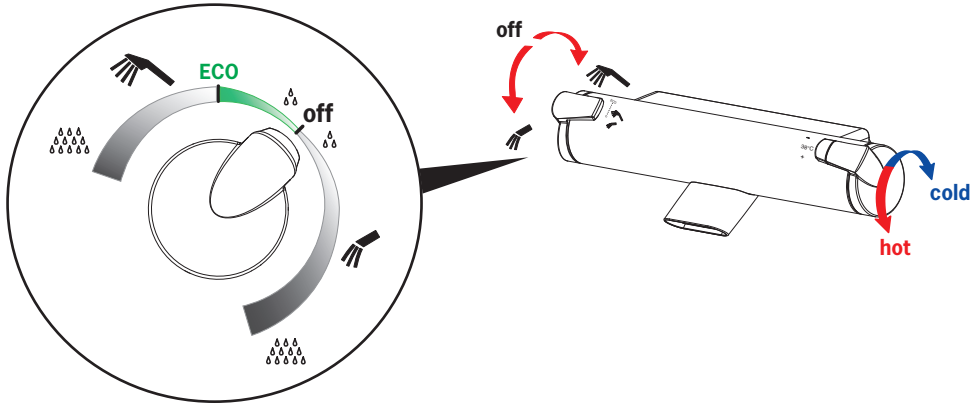

### 6514 0101

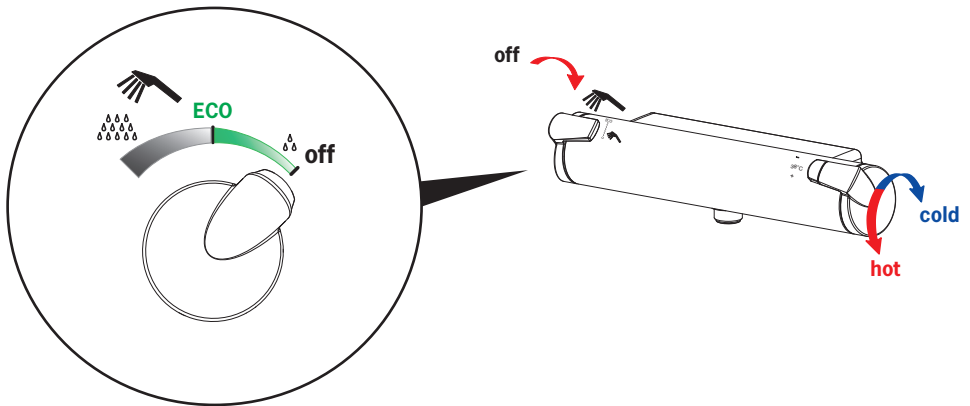

## Operation

**CZ** Funkce  
**DE** Funktion  
**DK** Betjening  
**ES** Servicio

**FI** Toiminta  
**FR** Utilisation  
**GR** Λειτουργία  
**HU** Üzemeltetés

**IT** Funzionamento  
**NL** Bediening  
**NO** Funksjon  
**PL** Działanie

**PT** Funcionamento  
**RU** Принцип действия  
**SE** Funktion  
**SK** Prevádzka

**6515 9101**

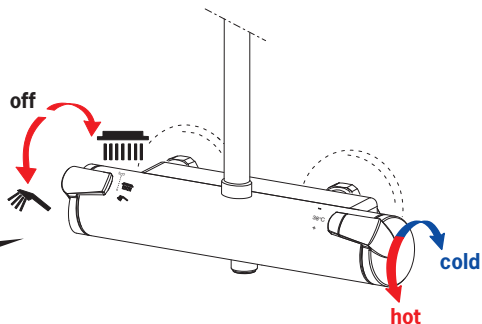
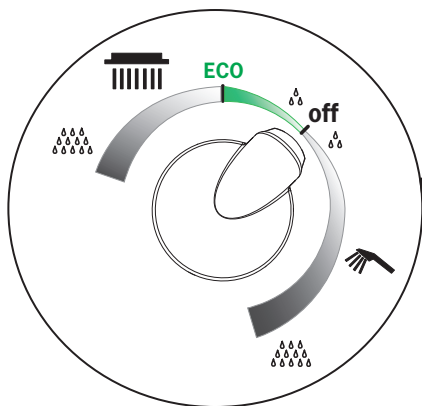

## Operation

**CZ** Funkce  
**DE** Funktion  
**DK** Betjening  
**ES** Servicio

**FI** Toiminta  
**FR** Utilisation  
**GR** Λειτουργία  
**HU** Üzemeltetés

**IT** Funzionamento  
**NL** Bediening  
**NO** Funksjon  
**PL** Działanie

**PT** Funcionamento  
**RU** Принцип действия  
**SE** Funktion  
**SK** Prevádzka

**6516 2101**

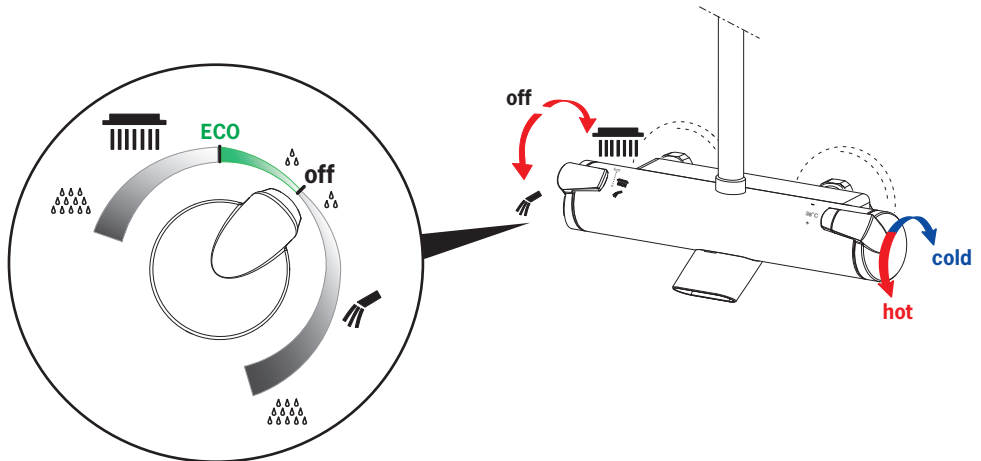
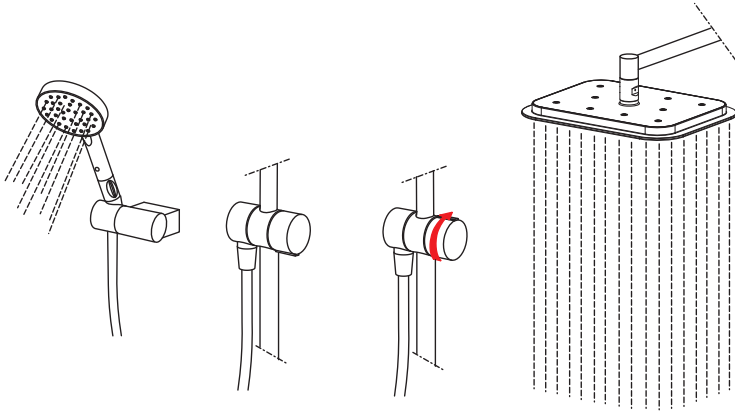

## SERVICE 1: Temperature adjustment

<b>CZ</b> Regulátor teploty	<b>IT</b> Regolazione della temperatura sul luogo del montaggio
<b>DE</b> Temperatureinstellung	<b>NL</b> Temperatuursinstelling
<b>DK</b> Justering af temperaturen på installationsstedet	<b>NO</b> Justering av temperaturen ved sperreknappens
<b>ES</b> Ajuste de la temperatura en el lugar de montaje	<b>PL</b> Regulacja temperatury
<b>FI</b> Lämpötilan säätö tarvittaessa	<b>PT</b> Ajuste da temperatura
<b>FR</b> Limitation de la température	<b>RU</b> Регулировка температуры
<b>GR</b> Ρύθμιση θερμοκρασίας	<b>SE</b> Justering av blandningstemperatur
<b>HU</b> Hőmérséklet beállítás	<b>SK</b> Nastavenie teploty

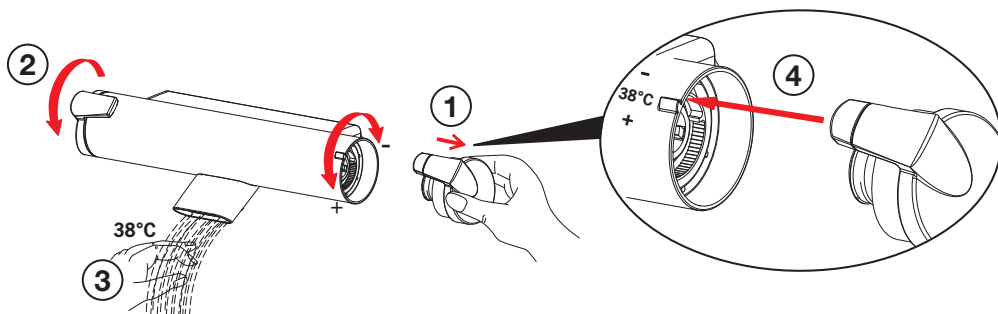

## Cleaning/changing the litter filters

<b>CZ</b> Čištění/Výměna filtrů	<b>IT</b> Pulizia/sostituzione dei filtri
<b>DE</b> Reinigung/Wechsel der Filter	<b>NL</b> Reinigen/veranderen van de filters
<b>DK</b> Rensning/udskiftning af filtre	<b>NO</b> Rensing/bytting av filter
<b>ES</b> Limpieza/cambio de los filtros	<b>PL</b> Czyszczenie/wymiana filtra
<b>FI</b> Roskasiivilöiden puhdistaminen/vaihtaminen	<b>PT</b> Limpar/substituir os filtros de resíduos
<b>FR</b> Nettoyage/changement des filtres	<b>RU</b> Очистка и замена уплотнительных фильтров
<b>GR</b> Καθαρισμός/αλλαγή φίλτρων απορριμμάτων	<b>SE</b> Rengöring/byte av smutsfilter
<b>HU</b> A szűrő tisztítása/cseréje	<b>SK</b> Čistenie/výměna odpadových filtrov

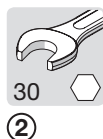
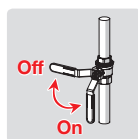

①

②

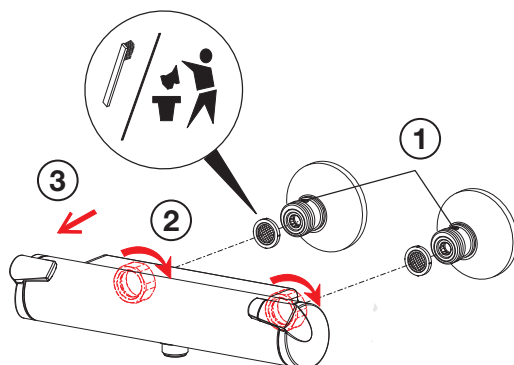

## To change the cartridge

**CZ** Výměna kartuše

**DE** Auswechseln der Patrone

**DK** Udsiftingning af reguleringskassette (unit)

**ES** Montaje del cartucho

**FI** Säätöosan vaihto

**FR** Montage et démontage de la cartouche

**GR** Αντικατάσταση του στοιχείου

**HU** A patron cseréje

**IT** Montaggio della cartuccia

**NL** Vervangen van het keramische binnenwerk

**NO** Skifting av kassett

**PL** Wymiana modułu sterującego

**PT** Substituição do cartucho

**RU** Замена регулировочного блока

**SE** Byte av kassett

**SK** Výměna kartuše

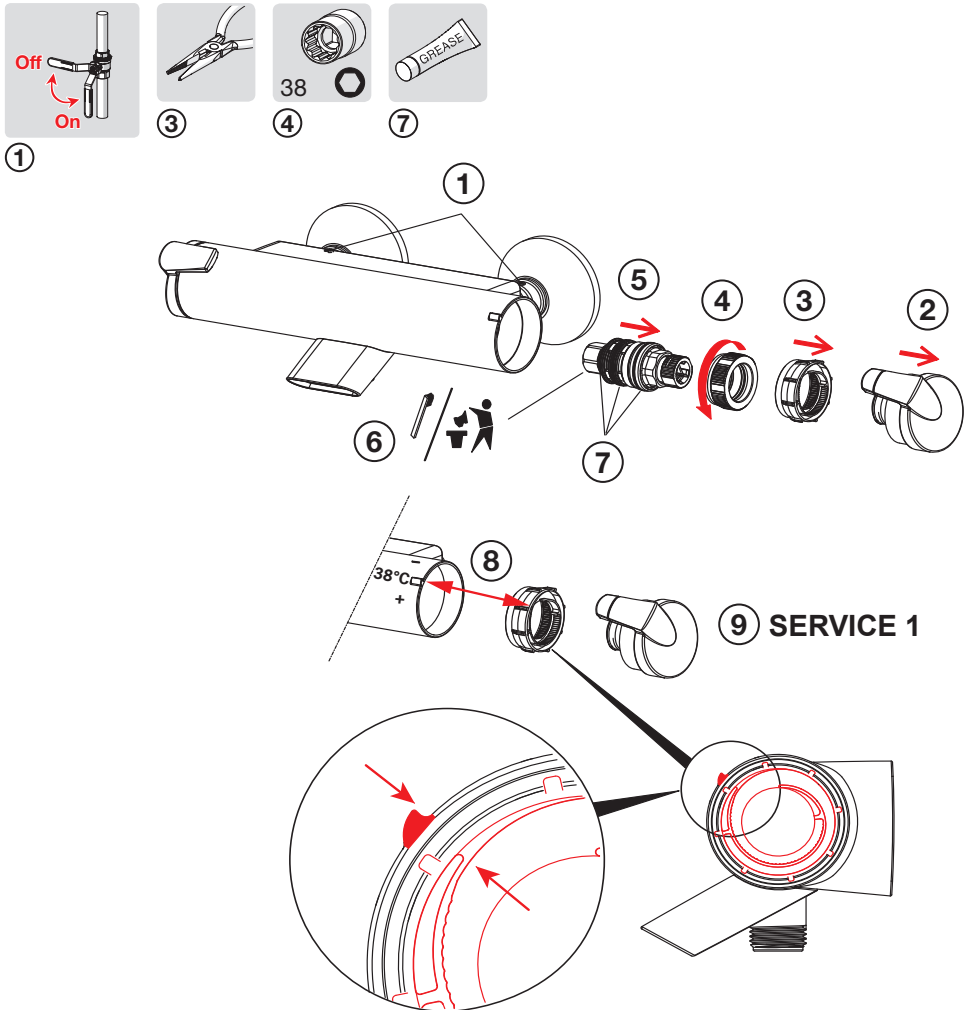

## Changing the operating valve

**CZ** Výměna pracovního ventilu

**DE** Auswechseln der keramischen Oberteile

**DK** Udskiftning af topstykke

**ES** Recambio del cartucho del monoblock

**FI** Käyttöventtiilin vaihto

**FR** Changement de la tête ceramique eau chaude ou eau froide du grand bec

**GR** Αλλαγή της βαλβίδας λειτουργίας

**HU** A működtető szelep cseréje

**IT** Sostituzione dei vitoni in ceramica

**NL** Vervangen van de werkingsklep

**NO** Bytting av overdel

**PL** Wymiana zaworu regulacyjnego

**PT** Substituir a válvula de comando

**RU** Замена узла управления потоком воды

**SE** Byte av kranöverdel

**SK** Výměna prevádzkového ventilu

6514 0101

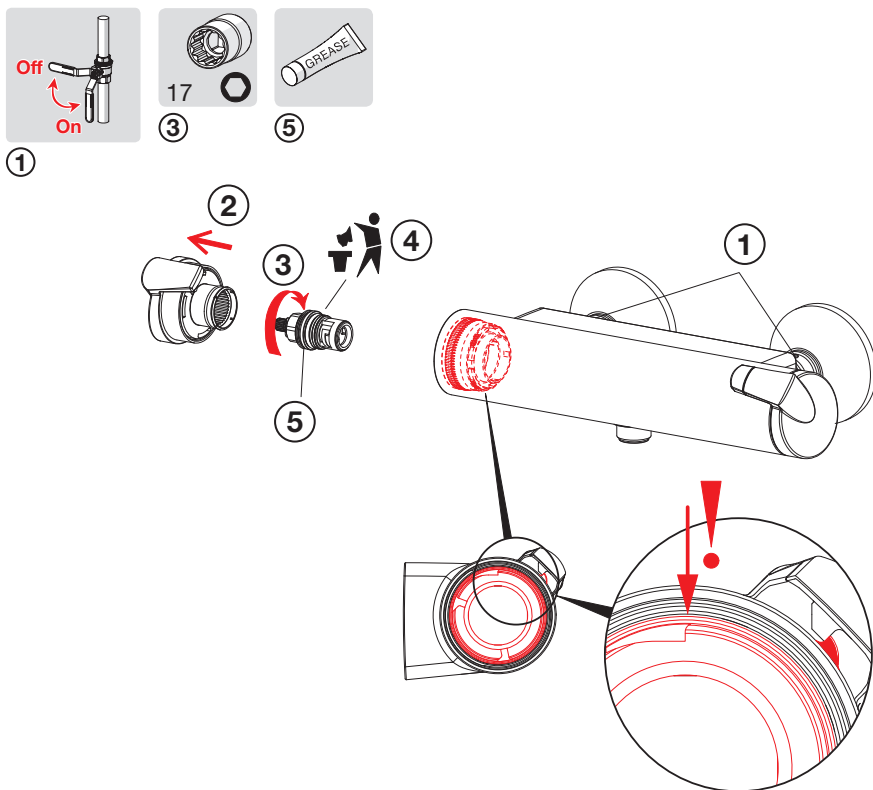

## Changing the diverter

**CZ** Výměna přepínače

**DE** Wartung des Umstellers

**DK** Udskiftning af omskifter

**ES** Cambiar la inversor

**FI** Vaihtimen vaihto

**FR** Changement de l'inverseur

**GR** Αλλαγή εκτροπέα

**HU** A zuhanyváltó cseréje

**IT** Sostituzione della deviatore

**NL** Omsteller vervangen

**NO** Bytting av omkaster

**PL** Wymiana przełącznika

**PT** Substituir o desviador

**RU** Замена переключателя

**SE** Byte av omkastare

**SK** Výměna prepínača

### 6513 2101

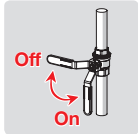

①



③ ⑤



④



⑥

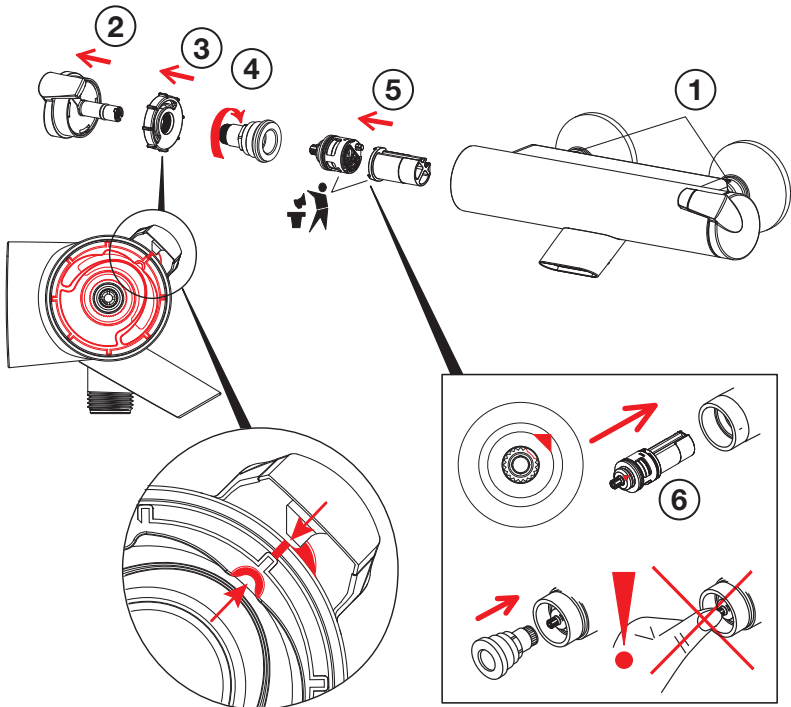

## Cleaning the faucet

**CZ** Čištění baterie

**DE** Reinigung der Armatur

**DK** Rengøring af armaturet

**ES** Limpieza de la grifería

**FI** Puhdistus

**FR** Nettoyage du robinet

**GR** Καθαρισμός του βρύση

**HU** Takarítás a csapot

**IT** Pulizia della rubinetteria

**NL** Reinigen van de kraan

**NO** Rengjøring av kranen

**PL** Czyszczenie baterii

**PT** Limpeza da torneira

**RU** Чистка смесителя

**SE** Rengöring av blandarna

**SK** Čistenie vodovodnej batérie

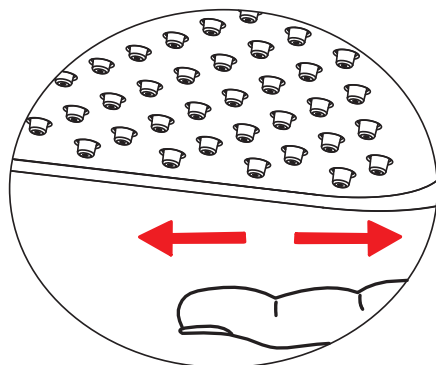
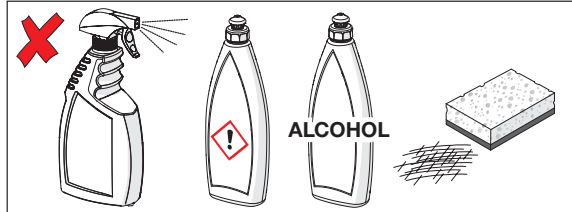



## Spare parts

<b>CZ</b> Náhradní díly	<b>FI</b> Varaosat	<b>NL</b> Reserve-onderdelen	<b>RU</b> Запасные части
<b>DE</b> Ersatzteile	<b>FR</b> Pièces détachées	<b>NO</b> Reservedeler	<b>SE</b> Reservdelar
<b>DK</b> Reservedele	<b>HU</b> Alkatrészek	<b>PL</b> Części zamienne	<b>SK</b> Náhradné diely
<b>ES</b> Piezas de recambio	<b>IT</b> Pezzi di ricambio	<b>PT</b> Peças de reposição	

### 6514 0101

- 1 59 914 110
- 2 59 914 111
- 3 59 911 076
- 4 59 914 112
- 5 59 914 113
- 6 59 914 114

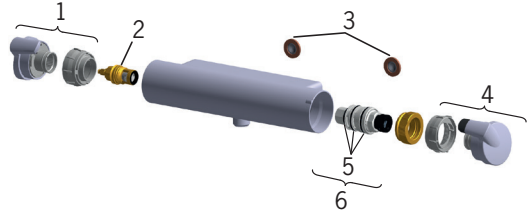

### 6513 2101

- 1 59 914 115
- 2 59 914 116
- 3 59 911 076
- 4 59 914 112
- 5 59 914 113
- 6 59 914 114
- 7 59 914 117

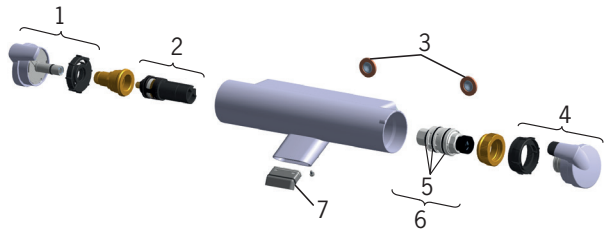

## Spare parts

<b>CZ</b> Náhradní díly	<b>FI</b> Varaosat	<b>NL</b> Reserve-onderdelen	<b>RU</b> Запасные части
<b>DE</b> Ersatzteile	<b>FR</b> Pièces détachées	<b>NO</b> Reservdeler	<b>SE</b> Reservdelar
<b>DK</b> Reservdele	<b>HU</b> Alkatrészek	<b>PL</b> Części zamienne	<b>SK</b> Náhradné diely
<b>ES</b> Piezas de recambio	<b>IT</b> Pezzi di ricambio	<b>PT</b> Peças de reposição	

### 6515 9101

- 1 59 914 115
- 2 59 914 116
- 3 59 911 076
- 4 59 914 113
- 5 59 914 112
- 6 59 914 113
- 7 59 914 147



## Spare parts

<b>CZ</b> Náhradní díly	<b>FI</b> Varaosat	<b>NL</b> Reserve-onderdelen	<b>RU</b> Запасные части
<b>DE</b> Ersatzteile	<b>FR</b> Pièces détachées	<b>NO</b> Reservedeler	<b>SE</b> Reservdelar
<b>DK</b> Reservedele	<b>HU</b> Alkatrészek	<b>PL</b> Części zamienne	<b>SK</b> Náhradné diely
<b>ES</b> Piezas de recambio	<b>IT</b> Pezzi di ricambio	<b>PT</b> Peças de reposição	

### 6516 2101

- 1 59 914 115
- 2 59 914 116
- 3 59 911 076
- 4 59 914 113
- 5 59 914 112
- 6 59 914 113
- 7 59 914 117
- 8 59 914 249











Oras Group is a powerful European provider of sanitary fittings: the market leader in the Nordics and a leading company in Continental Europe. The company's mission is to make the use of water easy and sustainable and its vision is to become the European leader of advanced sanitary fittings. Oras Group has two strong brands, Oras and Hansa.

The head office of the Group is located in Rauma, Finland, and the Group has four manufacturing sites: Burglengenfeld (Germany), Kralovice (Czech Republic), Olesno (Poland) and Rauma (Finland). Oras Group employs approximately 1400 people in twenty countries. Oras Group is owned by Oras Invest, a family company and an industrial owner.

HANSA Armaturen GmbH  
P. O. BOX 81 02 40  
D-70519 Stuttgart

Sigmaringer Strasse 107  
D-70567 Stuttgart  
Tel.: +49 711 16 14 0  
Fax: +49 711 16 14 368  
info@hansa.de

[www.hansa.com](http://www.hansa.com)



a member of  orasgroup