



Wasser erleben

HANSAMICRA

INSTALLATION AND MAINTENANCE GUIDE



Contents

CZ Obsah	FI Sisällysluettelo	IT Indice	PT Conteúdo
DE Inhaltsübersicht	FR Sommaire	NL Inhoud	RU Содержание
DK Indholdsfortegnelse	GR Περιεχόμενα	NO Innhold	SE Innehållsförteckning
ES Contenidos	HU Tartalom	PL Spis treści	SK Obsah



Technical data	4
Installation	6
Operation.....	7
Maintenance.....	8-13
Spare parts.....	14-15

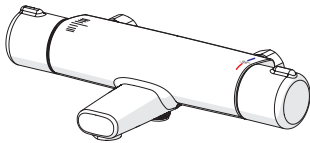

Technical data	5
Installation	6
Operation.....	7
Maintenance.....	8-13
Spare parts.....	14

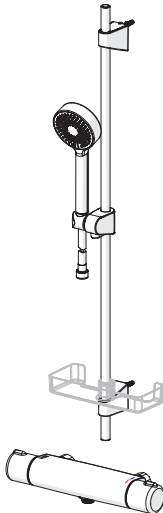

Technical data	5
Installation	6
Operation.....	7
Maintenance.....	8-13
Spare parts.....	14

5815 0071

EN 1111
100 - 1000 kPa
0.27 l/s (300 kPa)
165 kPa (0.2 l/s)
0.19 l/s (Eco-flow at 300 kPa)
max. +80°C

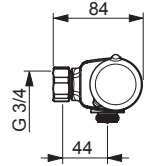
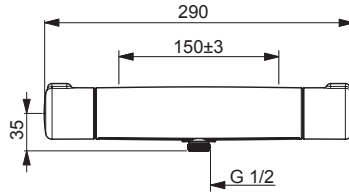

5815 0171

EN 1111
100 - 1000 kPa
0.27 l/s (300 kPa)
165 kPa (0.2 l/s)
0.19 l/s (Eco-flow at 300 kPa)
max. +80°C

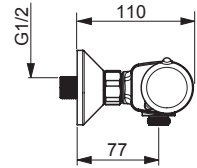
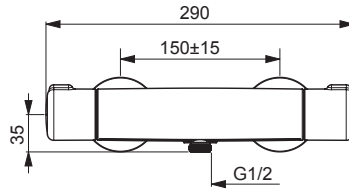

5815 2171

EN 1111
100 - 1000 kPa
0.27 l/s (300 kPa)
165 kPa (0.2 l/s)
0.19 l/s (Eco-flow at 300 kPa)
max. +80°C

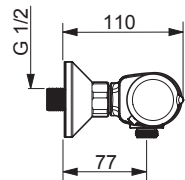
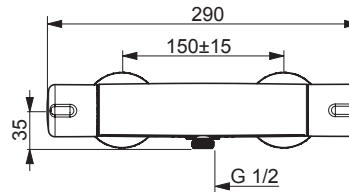

5816 2071

EN 1111

100 - 1000 kPa

0.33 l/s (300 kPa)

300 kPa (0.3 l/s)

0.16 l/s (Eco-flow at 300 kPa)

max. +80°C

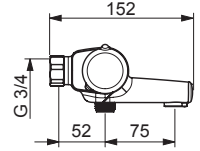
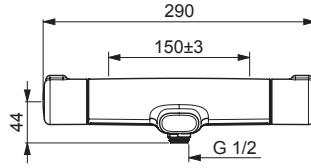

5816 2171

EN 1111

100 - 1000 kPa

0.33 l/s (300 kPa)

300 kPa (0.3 l/s)

230 kPa (0.2 l/s)

0.16 l/s (Eco-flow at 300 kPa)

max. +80°C

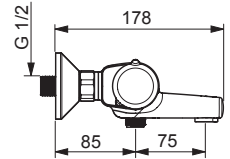
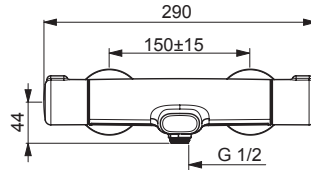

4815 0171 (5815 0171 + 4467 0133)

EN 1111

100 - 1000 kPa

0.28 l/s (300 kPa)

0.2 l/s (Eco-flow at 300 kPa)

160 kPa (0.2 l/s)

max. +80°C

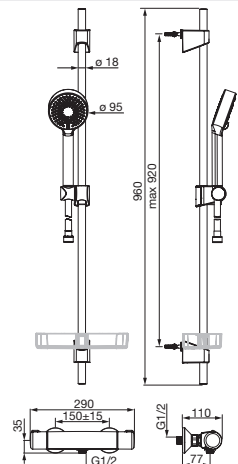

Installation

CZ Montáž

DE Montage

DK Installation

ES Montaje

FI Asennus

FR Installation

GR Συναρμολόγηση

HU Szerelés

IT Montaggio

NL Installatie

NO Montering

PL Instalacja

PT Instruções

RU Установка

SE Installation

SK Inštalácia

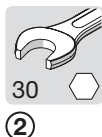
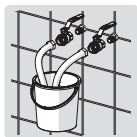
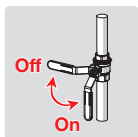

max.
1600 kPa

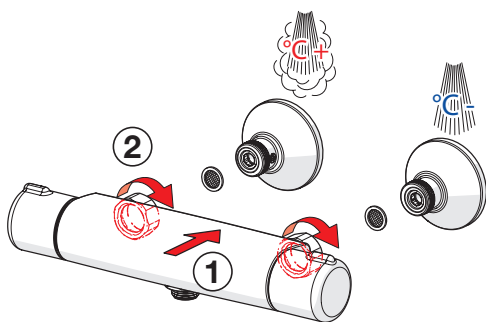

5815 2171

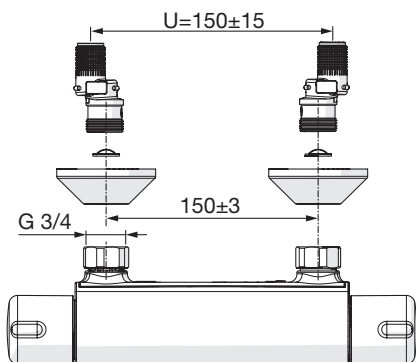
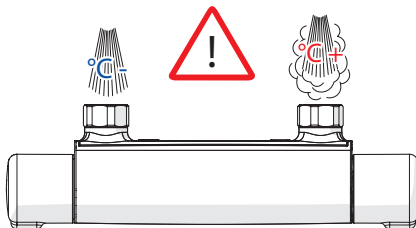

Operation

CZ Funkce
DE Funktion
DK Betjening
ES Servicio

FI Toiminta
FR Utilisation
GR Λειτουργία
HU Üzemeltetés

IT Funzionamento
NL Bediening
NO Funksjon
PL Działanie

PT Funcionamento
RU Принцип действия
SE Funktion
SK Prevádzka

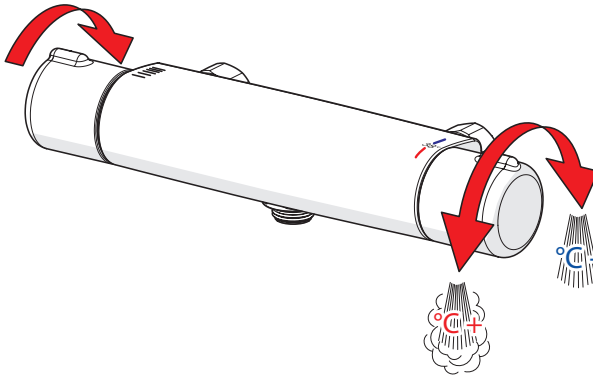
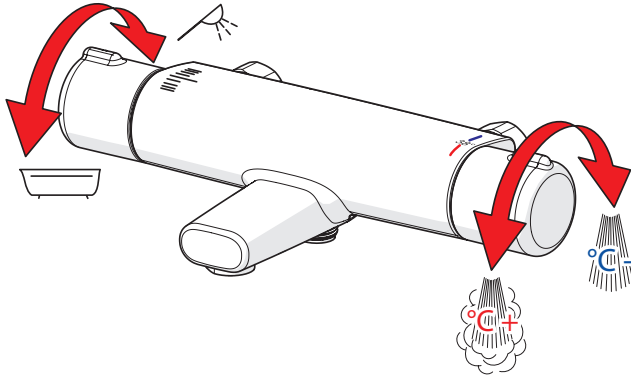

SERVICE 1: Temperature adjustment

CZ Regulátor teploty

DE Temperatureinstellung

DK Justering af temperaturen på
installationsstedet

ES Ajuste de la temperatura en el lugar de montaje

FI Lämpötilan säätö tarvittaessa

FR Limitation de la température

GR Ρύθμιση θερμοκρασίας

HU Hőmérséklet beállítás

IT Regolazione della temperatura sul luogo del
montaggio

NL Temperatuursinstelling

NO Justering av temperaturen ved sperreknappens

PL Regulacja temperatury

PT Ajuste da temperatura

RU Регулировка температуры

SE Justering av blandningstemperatur

SK Nastavenie teploty

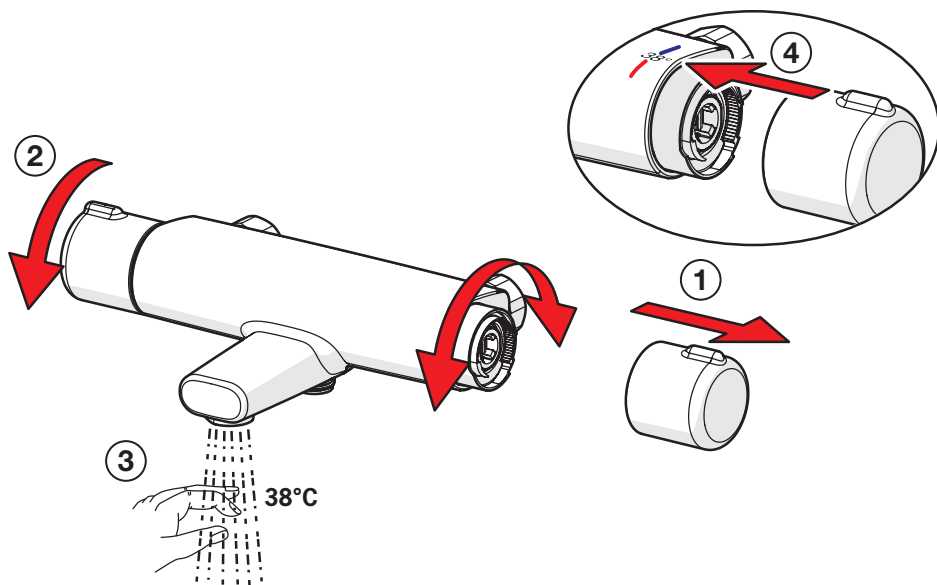

Cleaning/changing the litter filters

CZ Čištění/Výměna filtrů

DE Reinigung/Wechsel der Filter

DK Rensning/udskiftning af filtre

ES Limpieza/cambio de los filtros

FI Roskasiivilöiden puhdistaminen/vaihtaminen

FR Nettoyage/changement des filtres

GR Καθαρισμός/αλλαγή φίλτρων απορριμμάτων

HU A szűrő tisztítása/cseréje

IT Pulizia/sostituzione dei filtri

NL Reinigen/veranderen van de filters

NO Rensning/bytting av filter

PL Czyszczenie/wymiana filtra

PT Limpar/substituir os filtros de resíduos

RU Очистка и замена уплотнительных фильтро

SE Rengöring/byte av smutsfilter

SK Čistenie/výmena odpadových filtrov

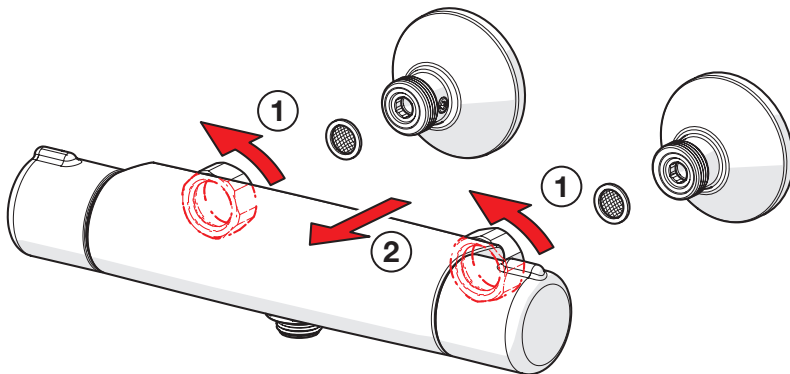
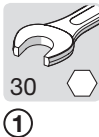
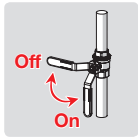

To change the cartridge

CZ Výměna kartuše

DE Auswechseln der Patrone

DK Udskiftning af reguleringskassette (unit)

ES Montaje del cartucho

FI Säätöosan vaihto

FR Montage et démontage de la cartouche

GR Αντικατάσταση του στοιχείου

HU A patron cseréje

IT Montaggio della cartuccia

NL Vervangen van het keramische binnenwerk

NO Skifting av kassett

PL Wymiana modułu sterującego

PT Substituição do cartucho

RU Замена регулировочного блока

SE Byte av kassett

SK Výměna kartuše

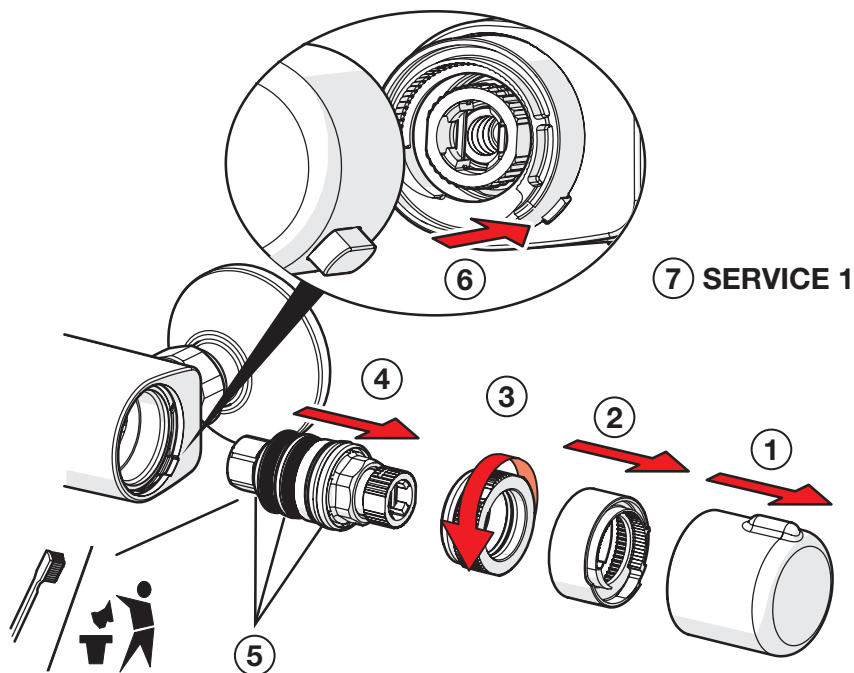
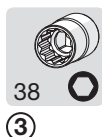
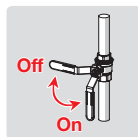

Changing the operating valve

CZ Výměna pracovního ventilu
DE Auswechseln der keramischen Oberteile
DK Udskiftning af topstykker
ES Recambio del cartucho del monoblock
FI Käyttöventtiilin vaihto
FR Changement de la tête ceramique eau chaude ou eau froide du grand bec
GR Αλλαγή της βαλβίδας λειτουργίας
HU A működtető szelep cseréje

IT Sostituzione dei vitoni in ceramica
NL Vervangen van de werkingsklep
NO Bytting av overdel
PL Wymiana zaworu regulacyjnego
PT Substituir a válvula de comando
RU Замена узла управления потоком воды
SE Byte av kranöverdel
SK Výmena prevádzkového ventilu

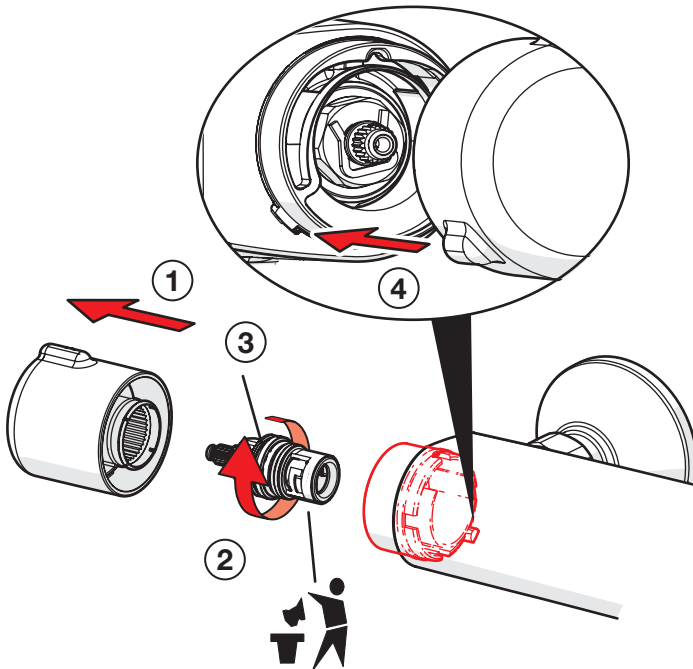
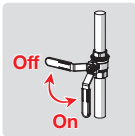

Changing the diverter

CZ Výměna přepínače

DE Wartung des Umstellers

DK Udskiftning af omskifter

ES Cambiar la inversor

FI Vaihtimen vaihto

FR Changement de l'inverseur

GR Αλλαγή εκτροπέα

HU A zuhanyváltó cseréje

IT Sostituzione della deviatore

NL Omsteller vervangen

NO Bytting av omkaster

PL Wymiana przełącznika

PT Substituir o desviador

RU Замена переключателя

SE Byte av omkastare

SK Výměna prepínača

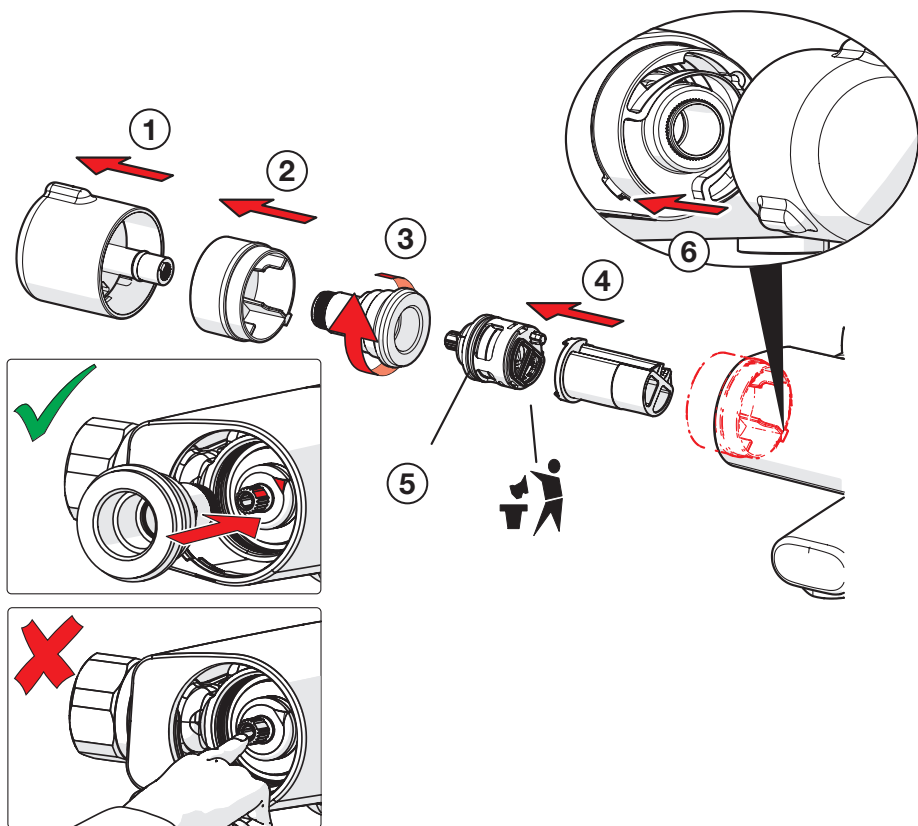
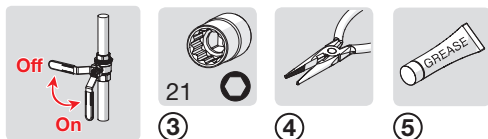

Cleaning the faucet

CZ Čištění baterie

DE Reinigung der Armatur

DK Rengøring af armaturet

ES Limpieza de la grifería

FI Puhdistus

FR Nettoyage du robinet

GR Καθαρισμός του βρύση

HU Takarítás a csapot

IT Pulizia della rubinetteria

NL Reinigen van de kraan

NO Rengjøring av kranen

PL Czystczenie baterii

PT Limpeza da torneira

RU Чистка смесителя

SE Rengöring av blandarna

SK Čistenie vodovodnej batérie

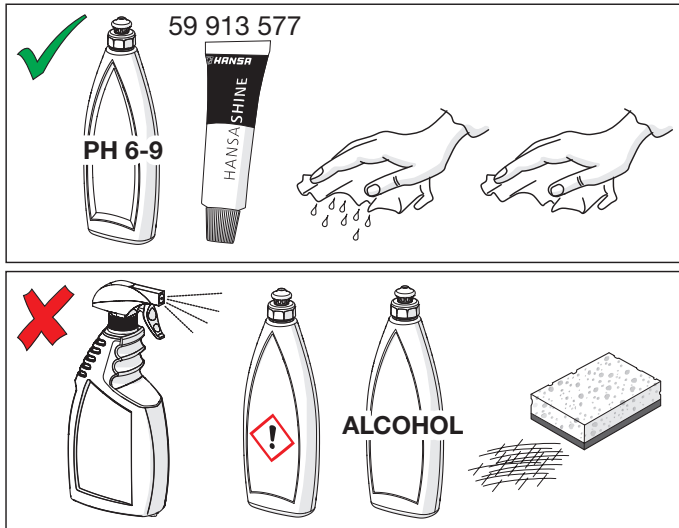

Cleaning/changing the aerator

CZ Čištění/Výměna perlátoru

DE Reinigung/Wechseln des Luftsprudlers

DK Rensning/Udsiftning af perlator

ES Limpieza/Cambiar el aireador

FI Poresuuttimen puhdistaminen/vaihtaminen

FR Nettoyage/Changement de l'aérateur

GR Καθαρισμός/αλλαγή αεριστήρα

HU Az aerátor tisztítása/cseréje

IT Pulizia/Sostituzione dell'aeratore

NL Reinigen/veranderen van de perlator

NO Rensing/Bytting av strålesamler

PL Czystczenie/Wymiana perlatora

PT Limpar/substituir o arejador

RU Очистка и замена аэратора

SE Rengöring/Byte av strålsamlare

SK Čistenie/Výměna perlátora

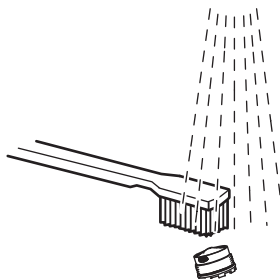

Spare parts

CZ Náhradní díly	FI Varaosat	NL Reserve-onderdelen	RU Запасные части
DE Ersatzteile	FR Pièces détachées	NO Reservedeler	SE Reservdelar
DK Reservedele	HU Alkatrészek	PL Części zamienne	SK Náhradné diely
ES Piezas de recambio	IT Pezzi di ricambio	PT Peças de reposição	

5815 0071, 5815 0171

- 1 59 914 395
- 2 59 914 111
- 3 59 911 076
- 4 59 914 396
- 5 59 914 113
- 6 59 914 114

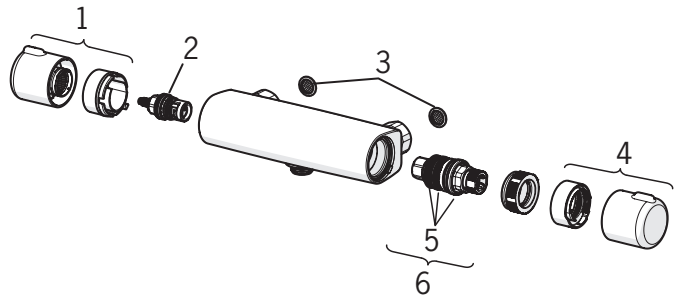

5816 2071, 5816 2171

- 1 59 914 397
- 2 59 914 116
- 3 59 911 076
- 4 59 914 396
- 5 59 914 113
- 6 59 914 114
- 7 59 911 829

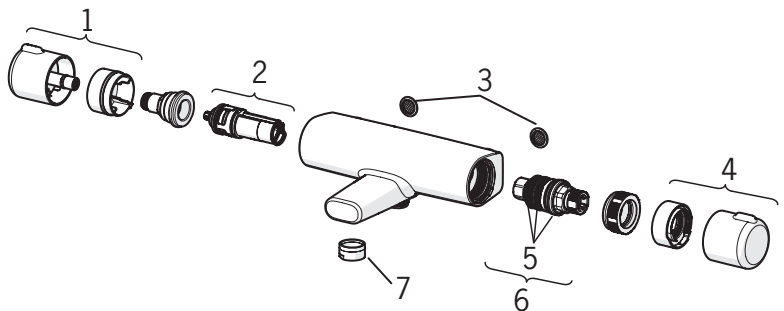

Spare parts

CZ Náhradní díly	FI Varaosat	NL Reserve-onderdelen	RU Запасные части
DE Ersatzteile	FR Pièces détachées	NO Reservedeler	SE Reservdelar
DK Reservedele	HU Alkatrészek	PL Części zamienne	SK Náhradné diely
ES Piezas de recambio	IT Pezzi di ricambio	PT Peças de reposição	

5815 2171

- 1 59 914 396
- 2 59 914 111
- 3 59 911 076
- 4 59 914 395
- 5 59 914 113
- 6 59 914 114

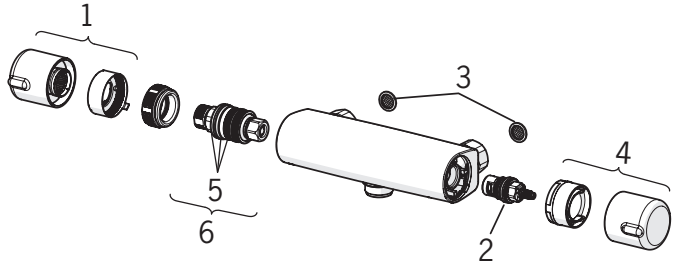

Oras Group is a powerful European provider of sanitary fittings: the market leader in the Nordics and a leading company in Continental Europe. The company's mission is to make the use of water easy and sustainable and its vision is to become the European leader of advanced sanitary fittings. Oras Group has two strong brands, Oras and Hansa.

The head office of the Group is located in Rauma, Finland, and the Group has four manufacturing sites: Burglengenfeld (Germany), Kralovice (Czech Republic), Olesno (Poland) and Rauma (Finland). Oras Group employs approximately 1400 people in twenty countries. Oras Group is owned by Oras Invest, a family company and an industrial owner.

HANSA Armaturen GmbH
P. O. BOX 81 02 40
D-70519 Stuttgart

Sigmaringer Strasse 107
D-70567 Stuttgart
Tel.: +49 711 16 14 0
Fax: +49 711 16 14 368
info@hansa.de

www.hansa.com



a member of orasgroup