

# 智能吸塵潔地寶 | PV8300

Floor Master

ZH-HK 說明書

EN Instruction Manual

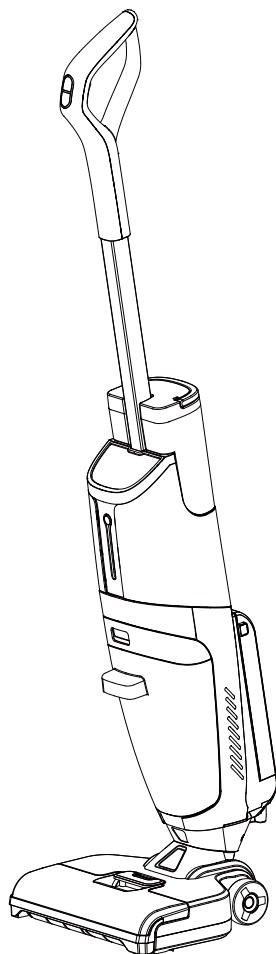

**Primada**<sup>®</sup>  
*Living*

<b>ZH-HK</b>	<b>說明書</b> .....	<b>2</b>
<b>EN</b>	<b>Instruction Manual</b> .....	<b>21</b>

---

感謝您選購寶康達產品 — 智能吸塵潔地寶！  
希望您使用愉快，我們相信這款全新的智能吸塵潔地寶將為您帶來更好的生活體驗。

使用中如果遇到任何問題，請聯絡我們的售後服務中心，將有專業人員為您解答問題。

如欲了解更多產品資訊請登入：[www.primada.com.hk](http://www.primada.com.hk)  
本資料產品以實物為準，原廠保留產品更新的權利，如有變動，恕不另行通知。

感謝您的選擇!

## 目錄



---

1. 安全注意事項 . . . . .	2
2. 產品組成 . . . . .	5
2.1 包裝隨附物件 . . . . .	5
2.2 技術參數 . . . . .	6
2.3 組件名稱 . . . . .	7
3. 產品組裝及拆卸 . . . . .	9
4. 產品使用說明 . . . . .	12
4.1 主機充電及自動清潔說明 . . . . .	12
4.2 污水箱清潔說明 . . . . .	13
4.3 主機屏幕圖標說明 . . . . .	14
4.4 功能鍵說明 . . . . .	15
5. 手機軟件使用 . . . . .	16
6. 疑難排解 . . . . .	20

# 1. 安全注意事項

使用電器產品前請仔細閱讀此說明書的所有內容。  
請保管好此說明書。

使用電器產品時，請保持一貫的警惕性，遵循以下事項：

 危險	必須禁止的危險行為或操作
 警告	必須遵守的行為或操作
 注意	如果操作錯誤有可能造成人身、物品及財產的損傷

主機及配件相關安全注意事項

## 注意

- 切勿濕手觸碰，否則有可能導致觸電。
- 請勿將本產品置於易掉落地方，如桌椅房間高台上。
- 本產品是精密電子設備，應避免長時間在日光下暴晒。
- 請勿在潮濕環境使用本產品，如浴室。
- 請勿將本產品靠近煙頭，打火機及其他明火。
- 請在充電結束後對本產品進行清潔。清潔維護設備前請確保產品沒有接通電源。
- 長時間不使用本產品時，請取下電池。
- 使用前請仔細檢查電源適配器是否已和插座連接好，否則將導致機器受損。
- 使用本產品前，請移除地面上所有易損物品，如玻璃杯、燈具以及有可能纏住邊刷和吸風通道的物品，如電線、窗簾。
- 垃圾盒已滿時請先清空垃圾再使用機器。
- 請勿用機器清潔建築垃圾。
- 本產品使用溫度範圍為0攝氏度到40攝氏度，請勿在高溫或低溫環境下使用。
- 本產品在報廢前請將電池從機器上拆下，拆除電池時請確保本產品沒有接通電源，請將廢棄電池安全環保回收

## 警告

- 切勿自行拆卸修理或改裝機器否則將會損壞產品並發生危險。
- 請勿在有可能起火或爆炸的環境中使用本產品。
- 本產品只能使用原裝電源適配器否則可能導致產品受損起火。
- 禁止站立或坐在本產品上否則可能造成產品損壞或發生跌倒。
- 電源插頭的金屬部分周圍附著灰塵時，務必用乾布擦拭乾淨。
- 電源適配器使用100-240V交流電壓，請將插頭正確插入插座避免孩童觸碰。
- 禁止對主機及電子器件水洗浸泡，否則將造成短路損壞。
- 請勿損傷加工電源線，切勿將重物壓在電源線上，對電源線加熱或拉扯彎折電源線。
- 產品在運轉清掃中，請注意家中幼童長輩安全，避免造成絆倒發生危險，請勿用手觸摸車輪及邊刷以免絞入造成受傷，（幼童請特別注意）
- 本產品為戶內家用產品，請勿在戶外使用。
- 禁止用金屬及導電物質接觸電池接點，否則造成短路。

## 充電電池相關安全注意事項

### ⊘ 危險

01. 務必使用專用的電池適配器，否則將導致漏液發熱或破裂。
02. 切勿使電池短路或拆卸電池，否則將導致漏液發熱或破裂。
03. 切勿與項鍊髮夾等金屬物品一起運送或保存，否則將導致短路而造成漏液發熱或破裂。
04. 切勿將電池投入火中或對電池加熱，否則將導致漏液發熱或破裂。

### ⓘ 注意

01. 進行充電時若發現異常過熱請立即停止使用，否則將導致漏液發熱或破裂。
02. 為延長電池使用壽命，長時間不使用時請將電池拔出，放置於陰涼乾燥環境，否則導致漏液發熱或破裂。
03. 切勿浸入水中或接觸到液體，否則將漏液發熱或破裂。
04. 發生異常（如變色或變形）時請務必停止使用，否則將導致漏液發熱或破裂。
05. 進行回收再利用或廢棄處理時務必使用膠帶等將電極部分絕緣。
06. 如果電池漏液，請用乾抹布擦乾淨，及時回收，或者廢棄。
07. 將回收的電池集中放置在社區、酒店賓館、學校、大型商場、超市等設置的電池回收箱或有害垃圾桶，由專業回收機構收集。廢棄產品電池，必須遵循當地法律法規移除並廢棄產品電池

### ⚠ 警告

01. 電池漏液接觸到皮膚或衣服務必立即使用清水沖洗，若不及時處理，會出現皮膚發炎等症狀。
02. 切勿在其他設備上使用本產品的充電電池，本電池僅適用於智能洗地機。
03. 發現電池外盒變形膨脹電解液流出時，禁止進行充電或繼續使用，以免發生危險。
04. 切勿對電池施以強烈撞擊或投擲電池，否則將導致漏液發熱或破裂。
05. 禁止對電池組進行拆解，否則將導致電池組破裂電解液流出造成火災及爆炸等危險。

### 如何拆卸電池

可用拇指和食指緊著圖中箭頭所指的電池上方兩側凸出的按鈕，稍用力往上提起，取下電池。

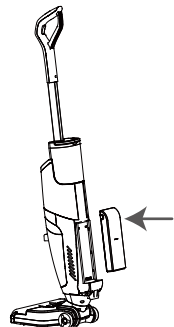

**i 注意**

1. 只能按照本說明書中指示的方式使用本產品。
2. 如果您將設備交給其他用戶，請務必將設備手冊與設備一起交出。
3. 在使用設備之前，請檢查電源電壓是否與設備銘牌上標明的電壓相符。
4. 請不要用吸塵器吸洗滌劑、煤油、玻璃渣、針、水濕灰塵、污水、火柴等物品。
5. 請不要用吸塵器吸玩具、紙團等較大物體，否則會引起吸塵器堵塞、電機燒壞等故障。
6. 請不要讓吸塵器靠近火源及其他高溫場所。
7. 使用吸塵器時，請注意要裝好濾網組件和地刷的滾刷。
8. 使用吸塵器時，請注意不要使吸入口阻塞或滾刷堵轉，否則可能引起電機故障。
9. 請不要將水或者其他液體傾倒或濺入機器中，以免引起短路燒壞機器。
10. 在使用新電池或者長期存放後第一次使用的電池，請將電池充滿電。長時間存放不使用本機時，請保證至少每三個月充電一次。
11. 當您的吸塵器充滿電、需要清潔或維修時，請及時拔下充電器插頭，請勿拉扯電源線。
12. 可用乾布擦拭吸塵器作清潔，不要用汽油、香蕉水等易使殼體龜裂或褪色的清潔劑。
13. 請勿讓兒童使用、玩耍本機。
14. 當整機充滿電無法工作時，必須到指定的售後服務中心進行檢測維修，請勿私自拆裝機器。
15. 廢棄電池包應安全的回收處理，請勿隨意丟棄。
16. 如果電源軟線有損壞，為了避免危險，必須去生產者或進口者的售後服務中心讓合資格的專業人員更換。
17. 若忽視安全指示，本公司恕不負責損壞責任。

## 2. 產品組成

### 2.1 包裝隨附物件

#### 隨機物件

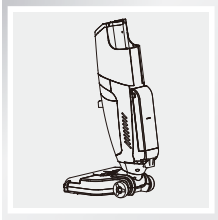

主機



手柄配件



淨水箱

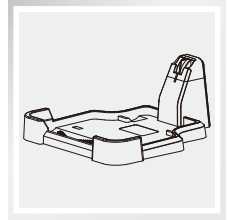

充電座

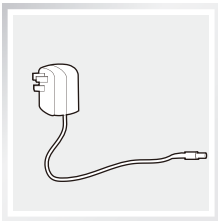

電源適配器

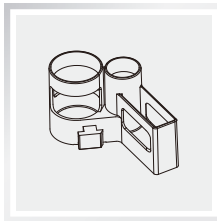

配件收納盒

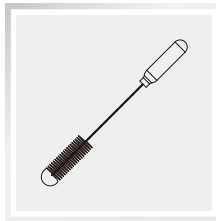

清潔工具

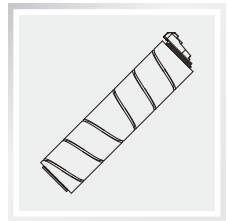

滾刷

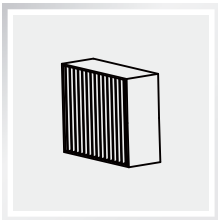

高效濾網/海綿



產品保用證



說明書

## 2.2 技術參數

產品型號	PV8300
額定電壓	DC 25.2V
額定功率	200W
工作電壓	100–240V
頻率	50–60Hz
電池容量	3800mAh
適配器參數	29.5V = 1A
工作時長（常規模式）	≥45分鐘
工作時長（最大吸力模式）	≥15分鐘
充電時長	4 小時
污水箱容量	700ml
淨水箱容量	900ml
吸力(pa)	17000pa
產品重量	5.2kg
產品尺寸	330(W) x 350(D) x 1190(H) mm

\* 因產品持續改善，原廠保留產品更新的權利，如有變動，恕不另行通知。



## 2.3 組件名稱

### 主機組件

開關按鍵  
(長按開機/短按關機)  
UV殺菌/吸力調節

(工作時)出水開關按鍵 或  
(放置充電座時)自動清潔按鍵

手柄組件

淨水箱

顯示屏

語音開關

電池

污水箱

機身組件

滾刷蓋

拖頭組件

滾刷

電源適配器

充電座

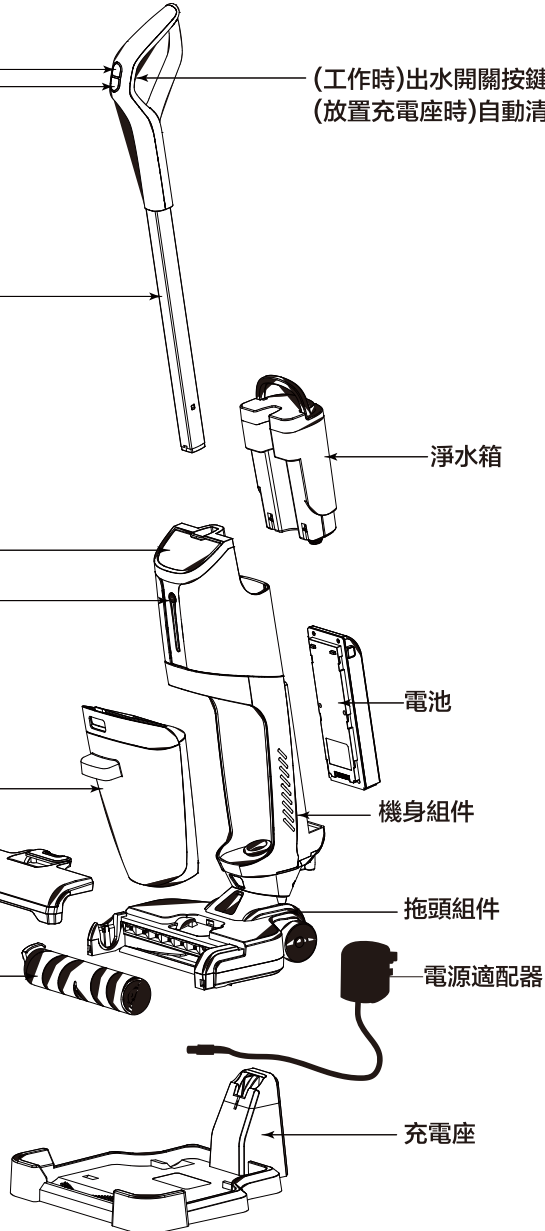

拖頭組件

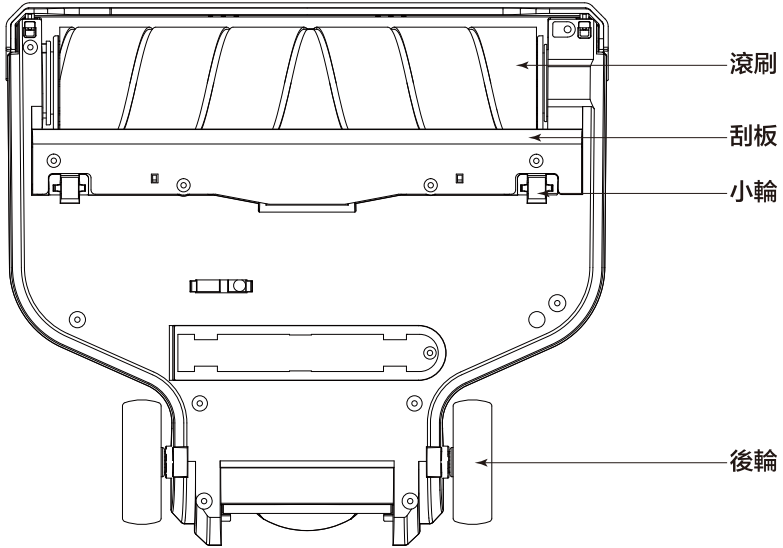

### 3. 產品組裝

#### 機身與手柄組件的組裝

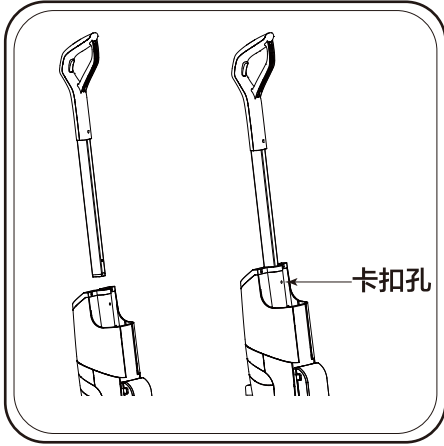

將手柄組件如左圖所示方向插入機身對應頂部位置。內設有卡扣定位，插入後聽到“咔”一聲即完成組裝。

當手柄要拆卸時，使用直徑小於4.5mm較硬的小柱狀物（比如小螺絲刀、小鐵線、小圓木條等）對準機身的卡扣孔插入，直到頂到最底部時，用手將要拆卸的手柄組件緩慢拉出。

#### 安裝污水箱組件

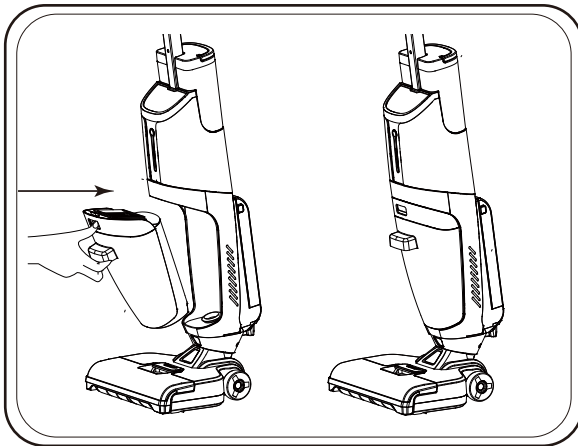

把污水桶組件按圖所示方向插入機身對應位置，污水桶組件設有卡扣定位，插入後聽到“咔”一聲後即完成組裝。

## 安裝淨水箱組件

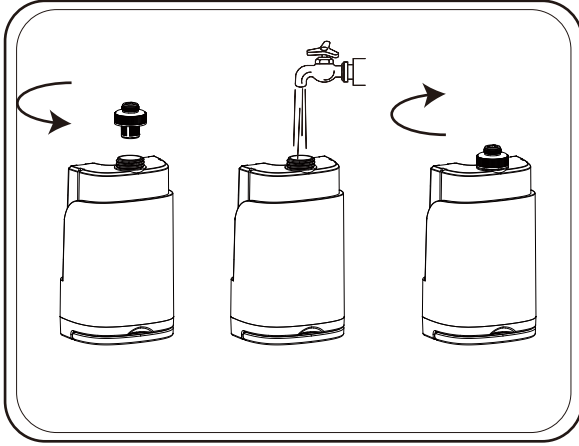

1. 將逆時針旋轉打開淨水箱底部的蓋子，加入適量清水，然後順時針旋轉擰緊蓋子。

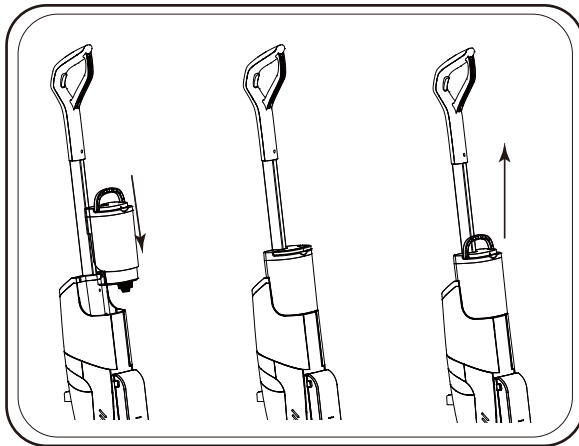

2. 如左圖所示方向，插入到機身對應位置。內設有卡扣定位，在插入後聽到“咔”一聲，即完成組裝。

若需要取下淨水箱時，拉起淨水箱的提手稍用力往上提起，即可取下淨水箱。

### 安裝滾刷

把滾刷組件按左圖所示方向插入拖頭組件對應位置，拖頭組件設有卡扣定位，插入後聽到“咔”一聲後即完成組裝。

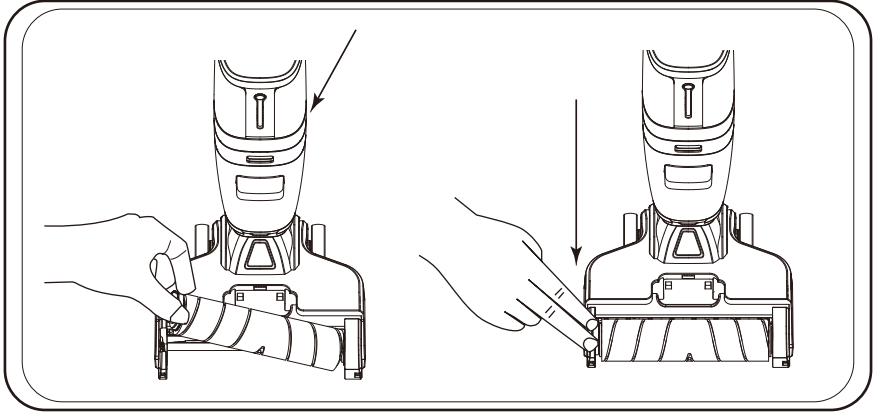

### 安裝滾刷蓋

把滾刷蓋按左圖所示方向插入地刷組件兩邊底部對應的扣孔處，然後將滾刷蓋往內側方向按下，直到聽到“咔”的一聲後，即完成組裝。

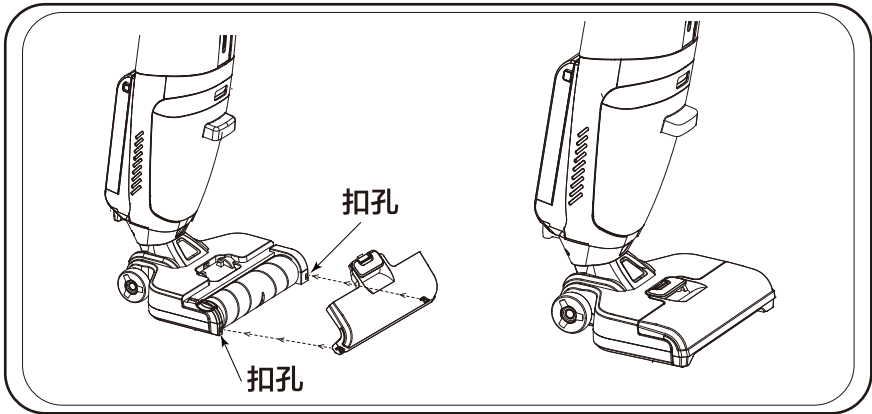

## 4. 產品使用說明

### 4.1 主機充電及自動清潔說明

**(i) 注意**

【自動清潔功能】必須在充電狀態下才能選擇。

把電源適配器按下圖示方向插入插板。

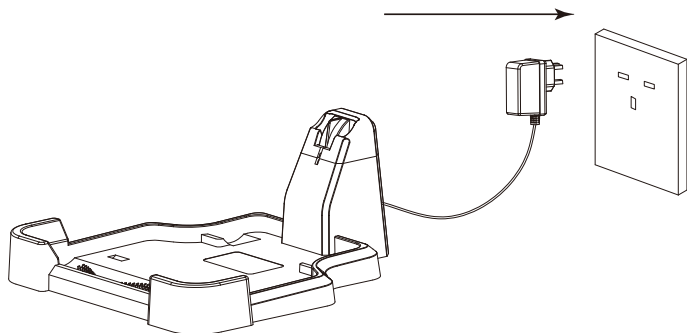

把電源適配器按下圖示方向插入插板。

把整機按圖所示放入充電座，此時機身的顯示板充電提示燈會閃爍，機器進入充電狀態。當提示燈熄滅時，屏幕顯示為100，表示充電完成。

清潔完成後，將使用後的機器放入充電座上，確保淨水器的水量足夠，按下自動清潔功能鍵，設備會進入自動清潔模式。80秒鐘會完成清洗和甩乾，然後自動停止。完成充電後，關閉電源開關，拔出電源充電器。

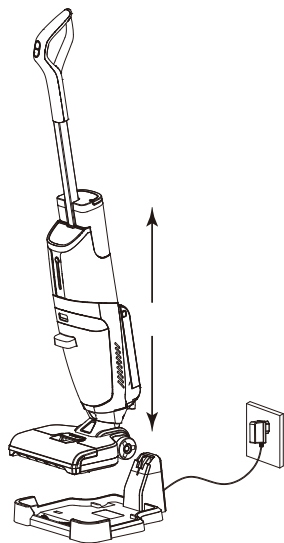

## 4.2 污水箱清潔說明

**i** 注意

如下圖所示，在污水桶上方的設有一個扣手部位（左視圖中箭頭所指的位置），用手指按下扣手部位內的按鈕，順勢往外取出污水桶。

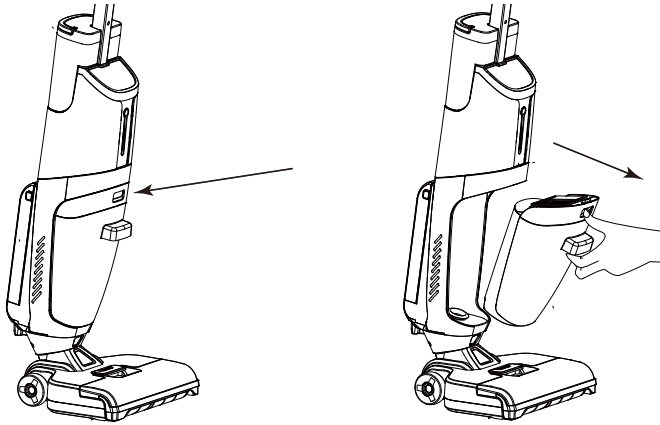

將取下的污水箱立放於平地上，用手扶住污水箱桶身，另外一隻手握著污水桶上方的桶蓋，用力緩慢地向上拔出。

**i** 注意：不可過於用力向上拔出，避免污水濺到身上！

將污水箱內部的過濾架慢慢取出，把過濾架裡面的固體狀垃圾清理掉。然後，把污水桶裡的污水倒掉；最後，把桶蓋、過濾架及污水桶清洗乾淨，按順序將過濾架、桶蓋一一裝回到污水桶上，再裝回機身對應的位置上即可。

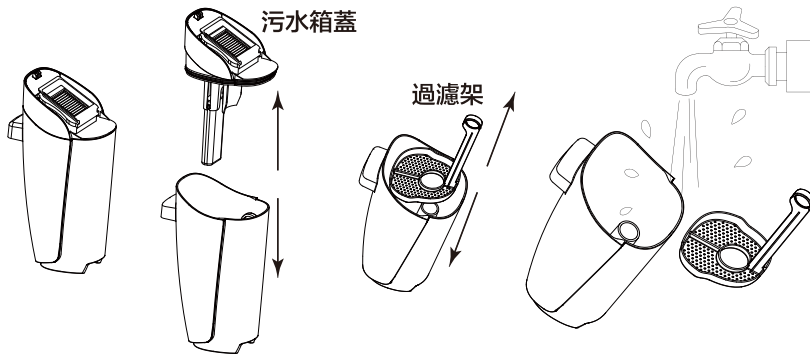

### 4.3 主機屏幕圖標說明

**注意**



圖示	功能說明	功能介紹
	充電提示燈	充電時，會根據充電情況而顯示其充電狀態，充電完畢會熄滅。
	清潔程度顯示燈環	啟動時，藍燈默認開始工作。當地面髒污時，根據地面情況，紅色燈會亮起不同數量的燈環，亮起越多，髒污越嚴重。機器將自動增大風機吸力。
	電池電量顯示	電量從【1】到【100】顯示，【1】代表機器沒電，【100】為滿電狀態。常亮，代表工作中。閃爍，代表充電中。
	出水開關按鍵/ 自動清潔功能按鍵	完成自動清掃模式時，圖標閃爍，提醒進行自動清潔。 將機器放置在底座時，當機器電量大於30%時，按下機器【自清潔按鍵】，圖標亮起，表示機器進入自動清潔模式（自動清潔總用時80秒），圖標常亮。
	滾刷纏繞	當未安裝滾刷/滾刷有卡住或者有纏繞物時，會有語音提示，提示標示燈會亮起。
	水箱缺水	當水箱缺水時，顯示屏界面閃爍【水箱缺水】圖標，並有語音提示【水箱缺水】；當重新裝滿水，重新開始自動清掃時，顯示屏界面圖標將會熄滅。
	污水箱滿	當污水箱水量到達警戒線時，【污水箱滿】圖標亮起。機器會暫停運作，伴隨語音提示【請清理污水箱】。當清理污水箱後會重新開始自動清掃，圖標將會熄滅。
	標準模式	預設自動清潔模式開啟，圖標會亮起。
	MAX 強勁模式	開啟MAX吸力模式，圖標會亮起。此模式會關閉自動出水功能。
AUTO	自動清掃模式	當與Wi-Fi連接期間，標誌會閃爍。當連接成功，圖標會亮起。
	Wi-Fi 連接顯示	當吸塵機與Wi-Fi 於應用程式(APP)成功連接，圖標亮起。
	風機吸力大小	開啟自動清掃時，機器會自動識別地面的髒污情況而智能調節風機的吸力，亮起的格子越多代表風機吸力越大。自動清掃模式下，短按UV 殺菌/MAX按鍵，可進入MAX吸力模式，進度條為全亮狀態；MAX吸力模式下，短按UV 殺菌/MAX按鍵，將進入自動清掃模式，吸力大小智能調節。



## 4.4 功能鍵說明

### 注意

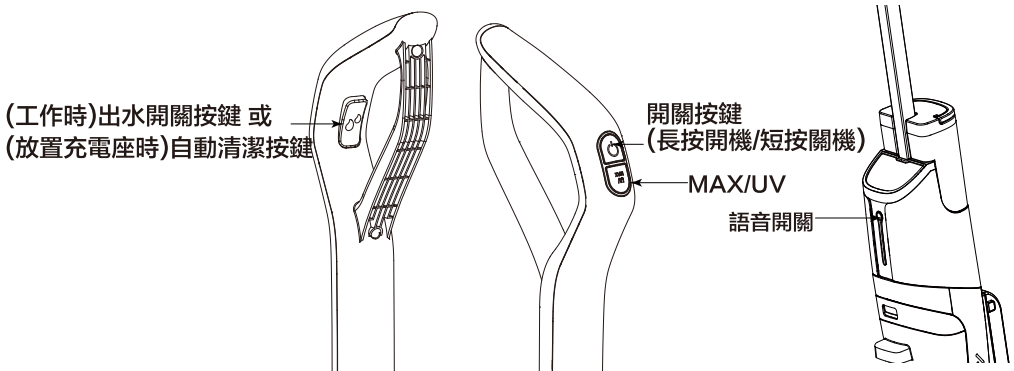

- 當長按【開關按鍵】時，機器會啟動。開始自動清掃模式【AUTO】；當再次短按【開關按鍵】時，機器會停止工作。
- 當短按【MAX/UV】鍵，進入【MAX 強勁模式】；再次短按【MAX/UV】鍵，機器會退出【MAX 強勁模式】。
- 當長按【MAX/UV】鍵，預設的UV功能會關閉；當再次長按【MAX/UV】鍵，機器會開啟UV功能。
- 工作模式：  
在進行工作模式時，機器預設默認一直出水洗地，短按一下【出水開關按鍵】，機器將停止出水，並伴隨著語音提示【關閉出水】；再次短按一下【出水開關按鍵】，機器會開始出水，並伴隨著語音提示【開啟出水】。
- 自動清潔模式：  
機器放置在充電座（確保充電座已接通電源）時，機器電量大於30%，再短按一下機器的【出水開關按鍵】，機器會進入自動清潔模式，自動清潔滾刷，時間為80秒。
- 按一下【語音開關】，語音提示會開啟。當再按一下【語音開關】，語音提示會關閉。

## 5. 手機軟件使用

### 5.1 連接手機軟件裝置

#### 1 下載

掃描 [圖1] 二維碼下載安裝【iplushome】App或在各大應用程式Google Play 及 App Store下載安裝【iplushome】應用程式。



[圖1]

#### 2 登入/登錄

打開軟件應用程式 [圖2]，如果您有 i+home 帳號可以直接登錄[圖3]；若沒有，可以選擇郵箱註冊，註冊後即可登錄。



[圖2]



[圖3]

#### 3 添加設備

進入【iplushome】應用程式後，顯示 [圖 5] 所示頁面，點擊中間的【添加設備】或右上角的【+】。

可以選擇手動 [圖6至圖10] 或自動 [圖11至圖15] 添加設備。



[圖5]

## 4A 手動添加設備

選擇手動添加設備，點擊【小家電】，選擇清潔類別，再選擇【手持吸塵器（藍牙）】[圖6]。選擇可連接互聯網的Wi-Fi並輸入Wi-Fi密碼，點擊【下一步】[圖7]。

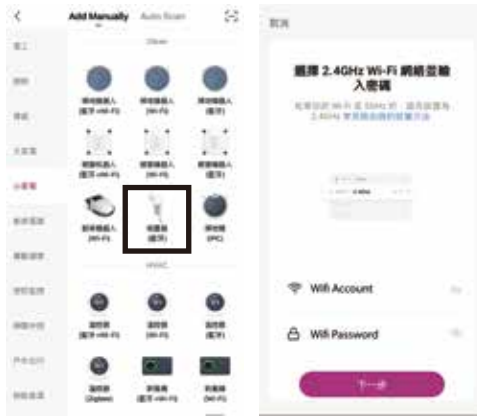

[圖6]

[圖7]

開啟洗地吸塵機，長按語音開關鍵 [圖8] 確保洗地吸塵機進入配對狀態，點擊【下一步】[圖9]。勾選【確認指示燈快閃】，顯示連接Wi-Fi的過程 [圖9]。顯示Wi-Fi連接及添加成功 [圖10]。



[圖8]

[圖9]

[圖10]

## 4B 自動添加設備

選擇自動發現設備，開啟洗地吸塵機，點擊【開始搜索】[圖11]。  
選擇可連接的互聯網Wi-Fi並輸入Wi-Fi密碼，再點擊【下一步】[圖12]。



[圖11]



[圖12]

顯示可用設備，點擊【下一步】[圖13]。等待洗地吸塵機連接Wi-Fi [圖14]。顯示Wi-Fi連接及添加成功 [圖15]。



[圖13]



[圖14]



[圖15]

## 5 進入設備

成功連接後，進入PV8300洗地吸塵機的使用介面。[圖16] 可以於使用PV8300時，使用應用程式內內置的按鍵自行更換其模式及了解狀態。



[圖16]

## 6. 疑難排解

### ⚠ 警告

為減少電擊的危險，在執行維護或故障排除檢查之前，請關閉電源開關並從電源插座上拔下插頭。

問題	原因	解決方法
未能出水	淨水箱可能已空	加入清水
	淨水箱可能未完全安裝到位	關閉電源/拆除並重新安裝水箱
吸力減弱/失去吸力	污水箱的容量已飽和/水量已達到警界線	清空污水箱，並確保在清潔時來回緩慢地進行清潔
	污水箱內的浮標升起，阻礙吸力	關閉電源，並重新啟動
滾刷不轉動	滾刷安裝不正確	關閉電源並拔下電源插頭，然後按照說明書上的教學更換滾刷
	直立機器，導致停止運作	傾斜機體，使機械繼續運作
	阻塞導致滾刷停止運作	關閉電源並拔下電源插頭，然後取下滾刷蓋子和滾刷，以清潔頭髮和刷子末端的堵塞物
機器無法開機	機器於安全設計下，需長按才能啟動	長按開關鍵直至機身開始運作
機器無法關機	機器於安全設計下，只需短按再稍後數秒	短按開關鍵直至機身停止運作
機器漏水	水箱蓋未正確安裝到位	取下水箱，然後重新蓋上蓋子，再按照說明書上的教學將水箱放到位

### ⓘ 注意

淨水箱內請勿添加清水或指定清潔劑以外的任何液體，以免造成機械堵塞及損壞。

---

Congratulations on the purchase of your Primada Floor Master! We hope it brings you many years of satisfaction.

Should you encounter situations that have not been properly addressed in this Instruction Manual, please contact our Customer Service Center where a technician can address your specific problem or question.

For more information, please visit the official website:  
[www.primada.com.hk](http://www.primada.com.hk)

The Company reserves the right to make technological and/or design changes to this product for continuous improvement.

Thank you for your choosing!

# Contents

---



1. Important safety Instructions . . . . .	21
2. Package Contents and Technical Specifications . . . . .	24
2.1 Package contents . . . . .	24
2.2 Technical Specifications . . . . .	25
2.3 Product Design . . . . .	26
3. Product assembly. . . . .	28
4. Operation and usage . . . . .	31
4.1 Charging and auto-cleaning instruction . . . . .	31
4.2 Instruction for cleaning sewage bucket . . . . .	32
4.3 Instruction of icons on display . . . . .	33
4.4 Instruction of each button . . . . .	34
5. APP Operation . . . . .	35
6. Troubleshooting . . . . .	39



# 1. Safety Instructions

**Please read the following safety instructions before using this product, and follow all routine safety precautions. Please read this manual carefully. Please keep this manual. Any operation inconsistent with this manual may cause damage to the product.**

When using an electrical appliance, basic precautions should be observed, including the following,

 <b>Danger</b>	Prohibition signs means try and prevent various activities in certain situations.
 <b>Warning</b>	Must follow these instructions, to prevent the possibility of causing death or serious injury.
 <b>Beware</b>	The possibility of causing injury or damage to property surrounding the goods.

## Safety precautions related to the machine engine and accessories

### Beware

01. Do not handle plug or appliance with wet hands.
02. Please do not put this product in the place where it is easy to fall.
03. This product is precision electronic equipment, which should avoid long time exposure to the sun.
04. Do not use this product under a humid environment, such as in the bathroom.
05. Keep away from heated surfaces.
06. Please clean the product after charging. Make sure that the product is unplugged before cleaning and maintaining the equipment.
07. Please take off the battery when not using for a long time.
08. Please check carefully whether the power adapter has been connected with the right socket before use, otherwise the machine will be unable to charge.
09. Before using this product, please make sure that all vulnerable items on the ground are removed, such as glasses, lamps, and items that may entangle the roller, such as wires and curtains.
10. Please empty the dust box before using it.
11. Do not use it to clean construction waste.
12. The temperature range from 0°C to 40°C. Do not use it in high or low temperature environment.
13. Before the product is scrapped, please remove the battery. Please make sure that the product is not connected to the power supply when removing the battery. Please recycle the waste battery in a safe and environmental way.

### Warning

01. Do not disassemble, repair or refit the machine by yourself, otherwise the product will be damaged and danger may occur.
02. Do not use this product under an environment where there is a possibility of fire or explosion.
03. This product can only be matched with the original power adapter.
04. Do not stand or sit on this product, otherwise the product may be damaged or you may fall.
05. When there is dust around the metal part of the power plug, do wipe it with dry cloth.
06. The power adapter uses 100-240V AC voltage. Please insert the plug into the socket correctly to avoid danger.
07. Do not immerse in water or liquid.
08. Do not pull or carry by cable, use cable as a handle, close door on cable, or pull cable around sharp edges or corners.
09. Please pay attention to the safety of the elders and children when the product is working and cleaning, so as to avoid the risk of tripping (little children in particular).
10. This product is for indoor use only. Please do not use it outdoors.
11. It is forbidden to touch the battery with metal or any conductive material, short circuit may occur.

## Safety precautions related to the battery

### Danger

01. Be sure to use the special battery adapter only.
02. Do not make the battery short circuit or remove the battery, otherwise leakage, heating or rupture may occur.
03. Do not store or deliver the battery with metal items such as necklaces and hairpins.
04. Do not put the battery under a heat surfaces.

### Beware

01. In case of abnormal overheating during charging, please stop using it immediately, otherwise leakage, heating or rupture may occur.
02. Please pull out the battery when it is not used for a long time and place it in a cool and dry environment in order to prolong the service life of the battery, otherwise leakage, heating or rupture may occur.
03. Do not immerse the battery in water or contact with liquid, otherwise leakage, heating or rupture may occur.
04. In case of abnormal situation (such as discoloration or deformation), please stop using, otherwise leakage, heating or rupture may occur.
05. When recycling or disposal the battery, be sure to insulate the electrode with tape.
06. If leakage happens, please clean the battery with a dry rag, recycle it in time, or discard it.
07. The recycled batteries should be placed in the battery recycling boxes or hazardous trash cans set up in communities, hotels, schools, large shopping malls, supermarkets, etc. and collected by professional recycling agencies. Waste product batteries must be removed and discarded in accordance with local laws and regulations.

### Warning

01. If the battery leakage touches the skin or clothing, be sure to wash it with clean water immediately. If it is ignored, skin inflammation and other problems may occur.
02. Do not use the rechargeable battery of this product on other devices. This battery is only suitable for PV8300.
03. It is forbidden to charge or continue to use the battery case when the battery case is deformed and the electrolyte flows out, so as to avoid danger.
04. Do not hit or throw the battery hard, otherwise leakage, heating or rupture may occur.
05. It is forbidden to disassemble the battery pack, otherwise the battery pack will break and the electrolyte will flow out, causing fire and explosion.

## How to take off the battery

Tightly squeeze the bump buttons on both sides above battery (as indicated by the arrow in figure) with thumb and index finger, gently pull upward to remove battery.

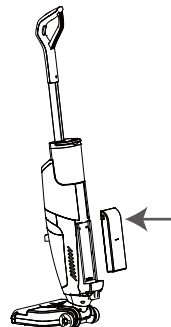

**i Beware**

1. Only use the appliance in the way indicated in this instruction manual.
2. Should you hand over the appliance to another user, make sure to hand over the instruction manual together with the appliance.
3. Check that your main voltage corresponds to that stated on the rating plate of the appliance before using the appliance.
4. DO NOT vacuum any solutions or flammable liquid (e.g., kerosene, alcohol).
5. DO NOT pick up hard or sharp objects such as glass, nails, screws, coins, etc.
6. Keep away from heated surfaces.
7. DO NOT use the vacuum cleaner without accessories, and make sure all components are placed before use.
8. DO NOT use it if airflow is restricted, if the air path or the floor nozzle become blocked, it may cause motor failure.
9. Liquid must not be directed towards equipment containing electrical components.
10. Fully charge the battery before first use or after long storage.
11. Do not pull or carry by cable, use cable as a handle, close door on cable, or pull cable around sharp edges or corners. Do not unplug by pulling on cable. To unplug, grasp the plug, not the cable.
12. Use a dry cloth to clean the machine. Liquids like gasoline, alcohol and lacquer thinner will cause crack or color fading and machine failure.
13. Children should be supervised to ensure that they do not play with the appliance.
14. When appliance does not work properly, ask a qualified maintenance center to perform service. Do not modify or attempt to repair the appliance or the battery pack by yourself.
15. Remove the battery before disposal. Dispose of or recycle the battery in accordance with local regulations.
16. DO NOT use with damaged cord or plug. If the appliance has been dropped, damaged, dropped into water, or is not working as it should, return it to the service centre.
17. The appliance must be used in accordance with the directions in this instruction manual. Primada cannot be held liable or responsible for any damages or injuries caused by improper use.

## 2. Package Contents and Technical Specifications

### 2.1 Packaging Content

#### Accessories

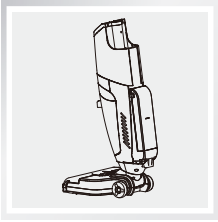

Main



Handle

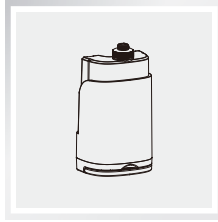

Water Bucket

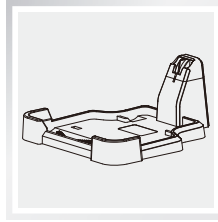

Storage Tray

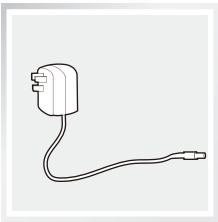

Battery Adapter

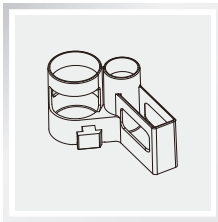

Accessories storage box

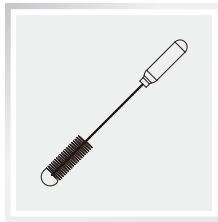

Cleaning Tool

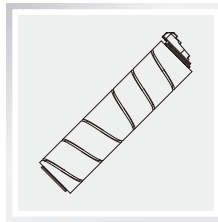

Roll Brush

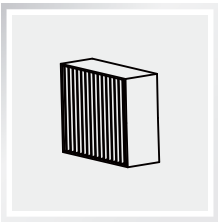

High-efficient Filter



Warranty card



Manual

## 2.2 Technical Specifications

<b>Model</b>	<b>PV8300</b>
<b>Voltage</b>	<b>DC 25.2V</b>
<b>Rated Power</b>	<b>200W</b>
<b>Charging Input</b>	<b>100-240V</b>
<b>Frequency</b>	<b>50-60Hz</b>
<b>Battery Capacity</b>	<b>3800mAh</b>
<b>Adapter Parameters</b>	<b>29.5V <math>\overline{=}</math>1A</b>
<b>Working Time ( Normal )</b>	<b><math>\geq</math>45 mins</b>
<b>Working Time ( Max )</b>	<b><math>\geq</math>15 mins</b>
<b>Charging Time</b>	<b>4 Hours</b>
<b>Sewage Bucket</b>	<b>700ml</b>
<b>Water Bucket</b>	<b>900ml</b>
<b>Suction Power</b>	<b>17000pa</b>
<b>Weight</b>	<b>5.2kg</b>
<b>Dimensions</b>	<b>330(W) x 350(D) x 1190(H) mm</b>

\* Package contents, technical and design specifications may be changed in the course of continuous product improvement.

### 2.3 Product Diagram

#### Main Components

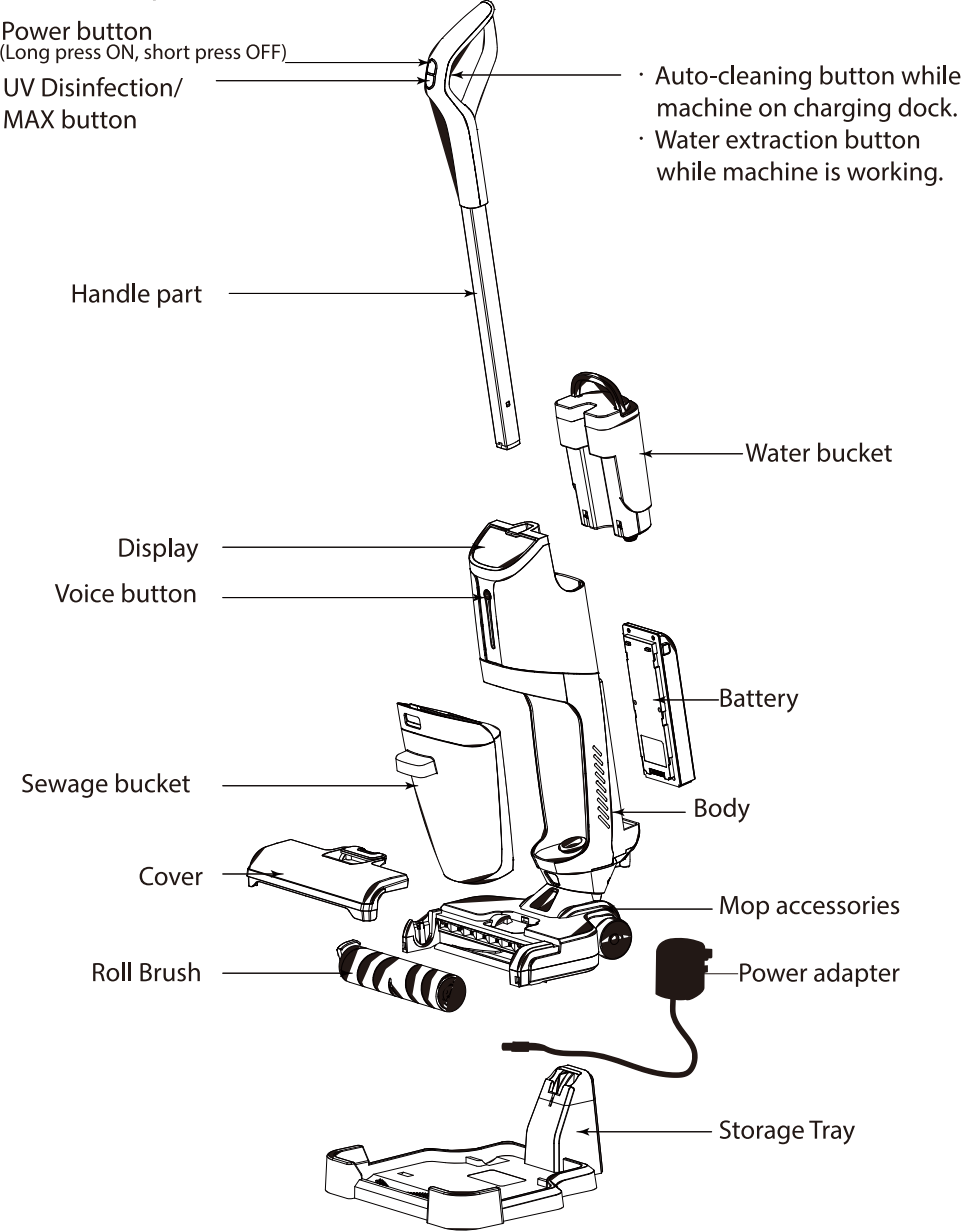

## Mop Components

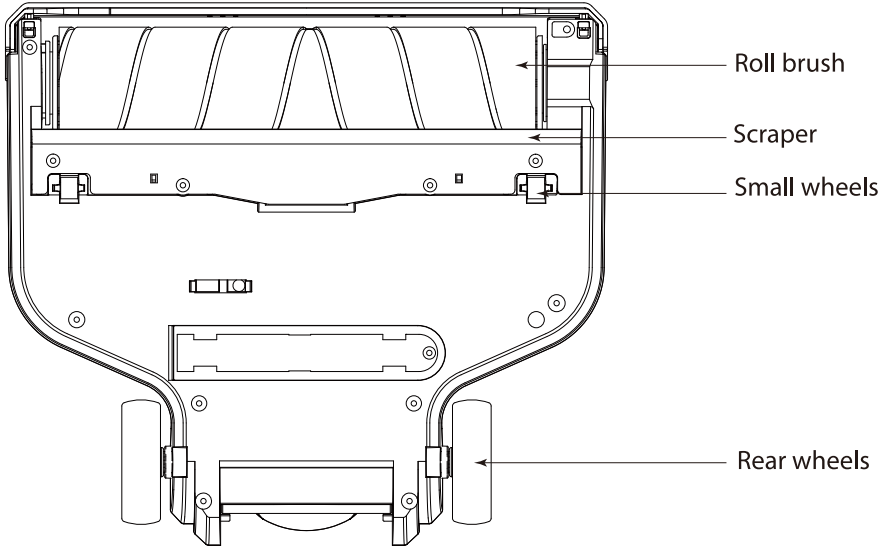

### 3. Product assembly and disassemble

#### Assemble body part and the handle part

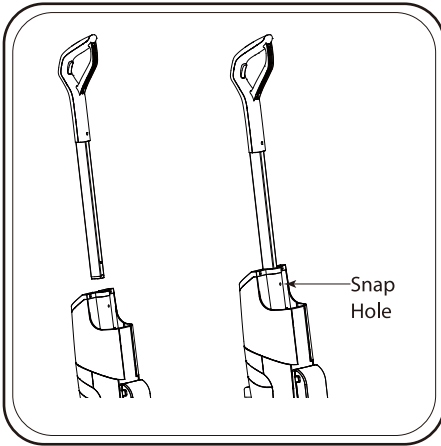

Insert handle into body of until your hear a "click" sound.

To disassemble the handle part, please insert a hard column, which <4.5 mm-diameter column (such as screwdriver, iron wire or wooden strip) into the snap hole on machine body until it reaches bottom, slowly pull out handle assembly.

#### Assemble sewage bucket

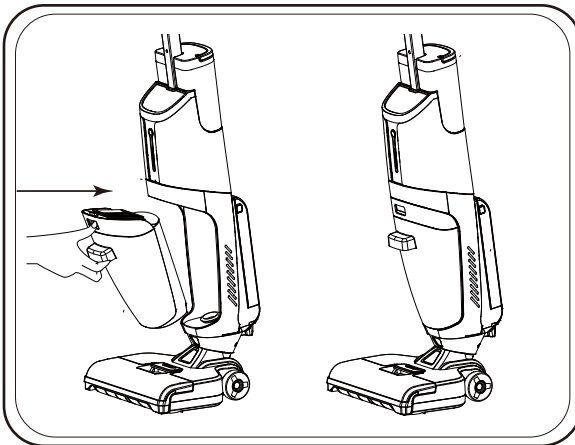

To release sewage bucket, press down on recessed button on the top of the dirty tank. Grab the front handle while pressing down on button and pull sewage bucket away from the unit.



## Filling the water bucket

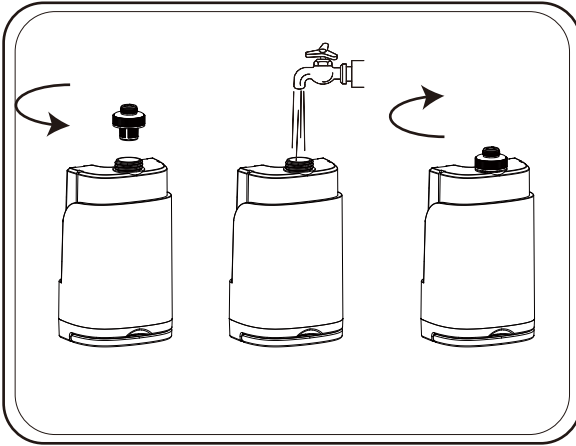

1. Lift the clean water tank straight up to remove from the machine. Unscrew the cap from the water bucket. Fill the bucket with tap water to water fill line. Screw the cap back onto the clean water tank.

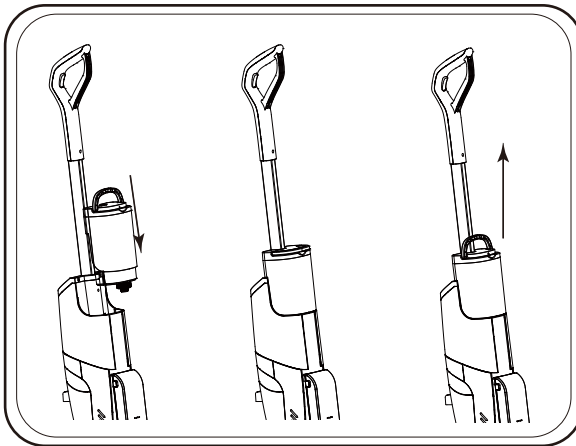

2. On the back of the machine, align clean water tank with the grooves and slide tank into place until you hear a click.

### Assembly the roller brush

Replace brush roll by inserting the brush roll end into the right side of the foot. Then lock the pull tab into place by pressing downward.

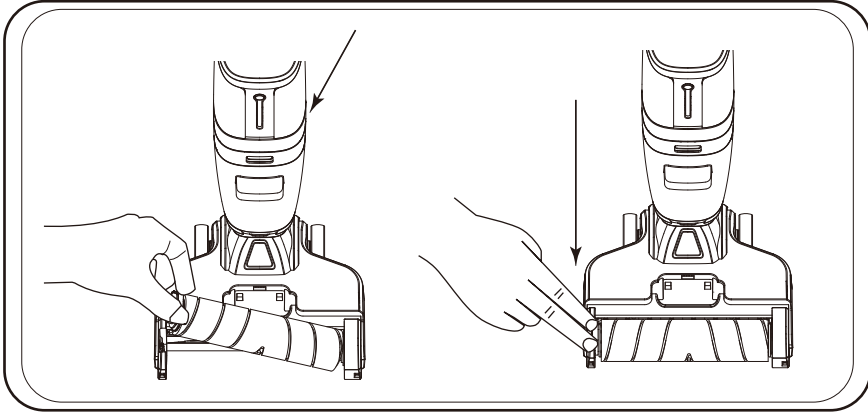

### Assembly the roll brush cover

Replace the brush roll window by first lining up the brush window tabs with the edges of the foot. Then press the window back into place until you hear a click.

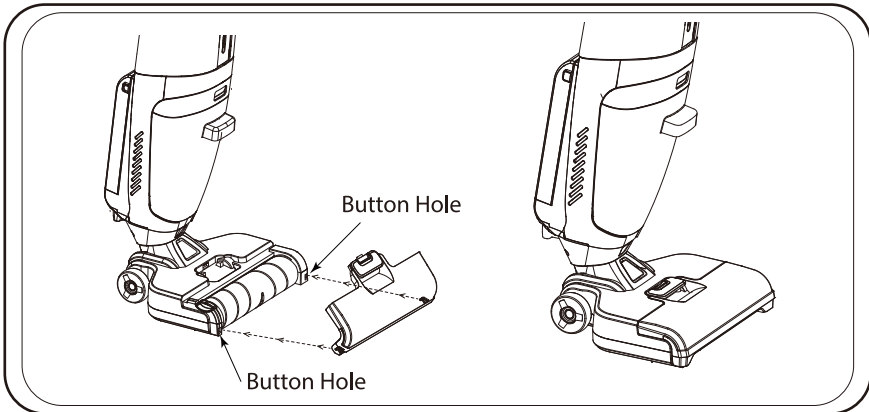

## 4. Operation and use

### 4.1 Charging and auto-cleaning instruction

**i** Beware

**【 Auto-cleaning 】** function only be selected under charging mode.◦  
Plug the adapter into the socket in the direction as shown in figure.

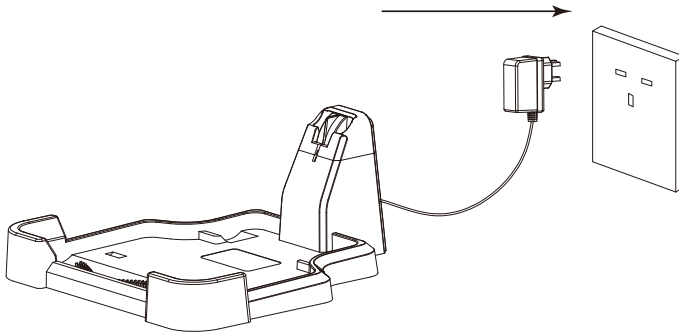

Place machine onto charging stand as shown in figure, battery level indicator light on display will flash, machine will start charging. When indicator light turn off means the charging procedure is done. It will shown 100% on display.  
After cleaning is done, place machine onto charging stand, assure sufficient water in clean water bucket, press Auto-cleaning Button to enter auto-cleaning mode, cleaning and spin drying will be completed within 80 s, and then machine will stop automatically. After charging is finished, turn off power switch and unplug adapter.

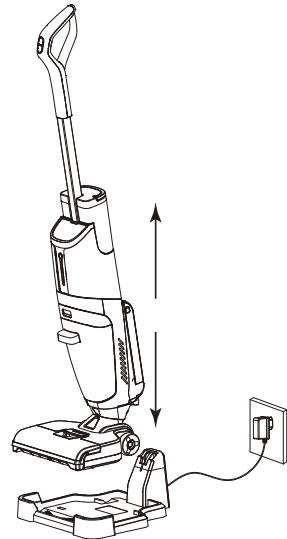

## 4.2 Instructions for Cleaning Sewage Bucket

**i Beware**

To release sewage bucket, press down on recessed button on the top of the dirty tank. Grab the front handle while pressing down on button and pull sewage bucket away from the unit.

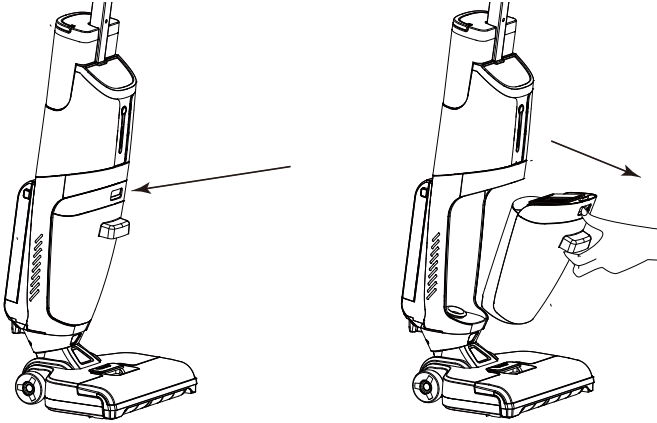

**i Beware**

Sewage water tank is full when the dirty water reaches the MAX fill line and/or the float shuts off the suction motor.



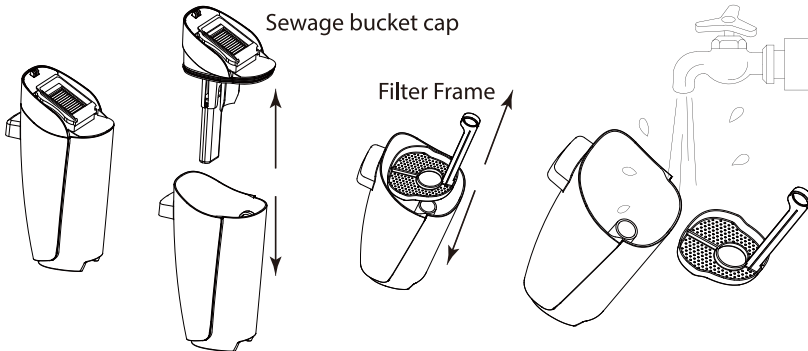





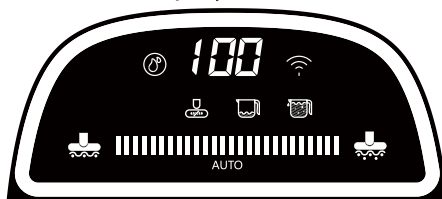

Grasp top of dirty water tank in recessed areas on each side of the filter and pull upward to remove the top of the tank. To empty, pour dirty water and debris out. Rinse the inside of the dirty water tank. Remove the filter from the dirty water tank top by pulling it up. Hand wash the vacuum filter and screen with warm water and mild detergent. Rinse the float located at the bottom of the dirty water tank's top.



## 4.3 Instruction of icons on display

 Beware



Icon	Function	Description
	Power display indicator light ring	Power display indicator light ring will on while charging. It will automatically turn off while is fully charged.
	Cleanliness Level	Blue light illuminates by default. Red lights will illuminate, while representing the floor condition. When more light on represent the dirtiest surface areas. Suction level will be raised automatically. It can represent the power status while charging.
	Battery Level	[ 1 ] indicate as no power, [ 100 ] indicate as fully charged. Illuminating indicates working, flashing indicates charging.
	Auto-cleaning button	After auto-cleaning is finished, the icon will flash to remind auto-cleaning. When machine is placed onto charging stand and its battery level is above 30%, press "Auto-cleaning Button", the icon will illuminate and machine will enter auto-cleaning mode (auto-cleaning takes 80 s).
	Roll Brush status	When roller brush is not assembled/ stuck/ entangled, voice hint will indicated. The icon will illuminate.
	Leakage of water	When water in clean water bucket is insufficient. The icon will flash, voice hint will indicated. After water is filled into bucket and auto-washing is restarted, the icon will off.
	Sewage Bucket full	When sewage reaches warning line, the icon will flash. Machine will stop, voice hint will indicated. After sewage bucket is emptied and auto-washing will restart, the icon will off.
	Normal mode	The icon illuminates under normal mode.
	MAX mode	The icon illuminates under MAX mode. The water extraction will stop automatically.
AUTO	Auto-cleaning	The icon illuminates while turn on the machine.
	Wi-Fi connection	When connecting to Wi-Fi, light will flash. When Wi-Fi connection successfully, light will on.
	Suction Level	Under the auto-cleaning mode, machine will automatically identify the cleanliness level of the floor and automatically adjust the suction level which will reflect on the illuminate bar. More lights on represent a higher suction level. By short pressing the UV/MAX button to change the suction mode. When under MAX mode, all the light will on on the suction level bar.

## 4.4 Intruction of each button

**i Beware**

- Auto-cleaning button while machine on charging dock.
- Water extraction button while machine is working.

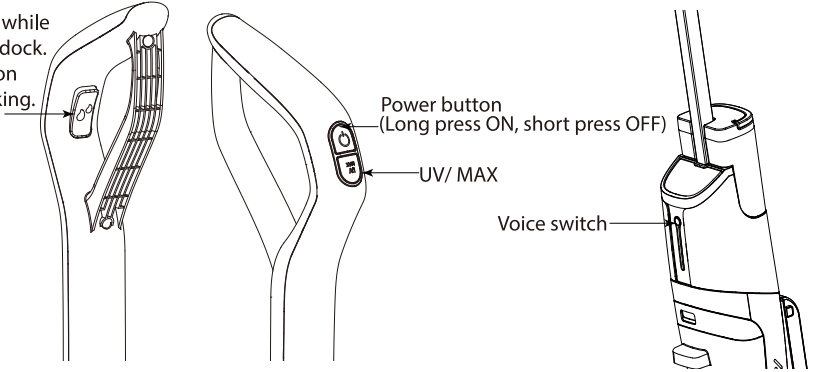

- Hold and press 【Switch】 button to turn on the PV8300 【Auto】 mode will on. Press shortly to turn off the machine.
- Short press 【MAX/UV】 button to turn on 【MAX】 mode. Press shortly to change to 【Auto】 mode.
- Hold and press 【MAX/UV】 button to turn off 【UV】 function as default. Hold and press 【MAX/UV】 button to turn on 【UV】 function.
- Working mode:  
the machine keeps outputs water by default. Short press the "self-cleaning button", the machine stops watering with voice prompt"turn off water output"; short press the 【 self-cleaning button】 again, the machine starts to output water with voice prompt "turn off water output".
- Auto Cleaning mode:  
When the machine is placed in the charging dock (make sure the charging dock is connected to the power), when the balance battery power is over 30%, short press the "self-cleaning button", it starts automatic cleaning mode, the mode takes 80 seconds.
- Press "Voice Switch" to disable voice prompt, press the switch again to disable the function.

## 5. APP Operation

### App connection with smartphone

#### 1 Download Apps

Scan QR code [Figure 1] to download and install 【iplushome】 App, or download and install from other APP Stores.



[ Figure 1 ]

#### 2 Login/ Sign up

Open App [Figure 2], directly login if you have an 【iplushome】 account. If not, you can select 【Register】 to sign up through email.

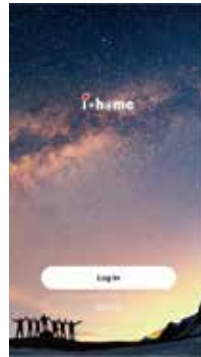

[ Figure 2 ]



[ Figure 3 ]

#### 3 Add Device

Enter App [ Figure 5], click 【 Add device 】 in the middle or the 【 + 】 on the upper right corner.

You can choose to add device manually [ Figure 6 to 10] or automatically [Figure 11 to Figure 15].



[ Figure 3 ]

## 4A Add Manually

Select **【 Add Manually 】**, click **【 Small Home Appliances 】**. Scrow down and find **【 Clean 】** categories, click **【 Vacuum Cleaner(BLE) 】**. [Figure 6] Select Wi-Fi Network and entry password, then click **【 Next 】**.

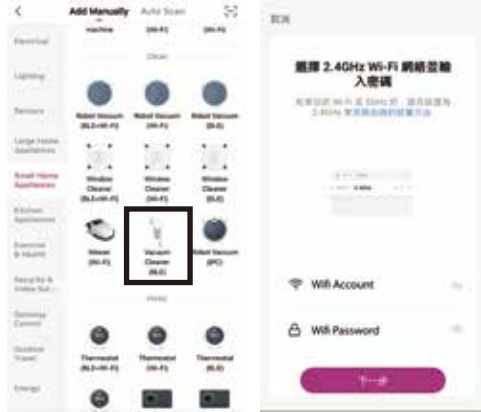

[ Figure 6 ]

[ Figure 7 ]

Turn on the PV8300, hold and press the Voice switch [Figure 8] to ensure is in pairing mode. Tick **【 Confirm the indicator is blinking rapidly. 】**, then click **【 Next 】** [Figure 9]. Wi-Fi connection and add device success [Figure 10].

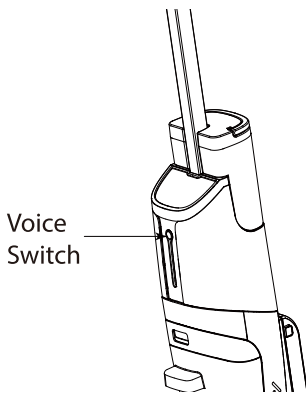

[ Figure 8 ]

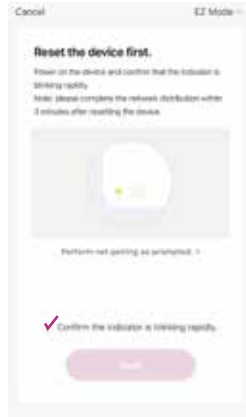

[ Figure 9 ]



[ Figure 10 ]



## 4B Auto Scan

Select **Auto Scan**, turn on the PV8300, hold and press the Voice switch [Figure 8] to ensure is in pairing mode. Click **Start scanning** [Figure 11]. Select Wi-Fi Network and entry password, then click **Next**.



[ Figure 11 ]



[ Figure 12 ]

Once it display available device, click **Next** [Figure 13]. Wait for connection between Wi-Fi and PV8300 [Figure 14]. Wi-Fi connection and device add successfully. [Figure 15]

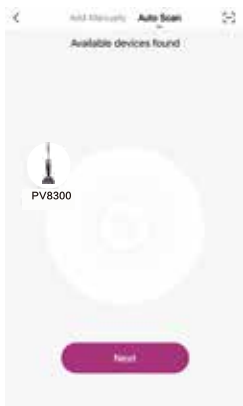

[ Figure 13 ]



[ Figure 14 ]

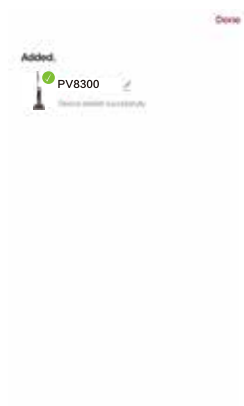

[ Figure 15 ]

## 5 Entry the device

After successful connection, enter PV8300 device, you may start to explore and change different function by using 【iplushome】 App.



[ Figure16 ]

## 6. Troubleshooting



### Warning

To reduce the risk of electric shock, turn power switch off and disconnect plug from electrical outlet before performing maintenance or troubleshooting checks.

Problem	Possible causes	Remedies
<b>Water extract function is not work</b>	Water bucket may be empty	Refill tank
	Clean water tank may not be seated completely	Turn power OFF / Remove and reseal tank
<b>Loss of suction power</b>	The buoy which inside the sewage bucket is rising, affecting the suction function.	Turn power OFF and restart PV8300
	Sewage bucket has picked up maximum amount of dirty water and has reached full line	Empty sewage tank
<b>Roll brush is not turning</b>	Brush roll is not installed properly	Turn Power OFF / Unplug machine and follow instructions on manual for replacing brush roll
	Machine is standing upright, PV8300 stop working	Tilt the machine to turn it on
	Obstruction has caused brush roll to stop	Turn Power OFF / Unplug machine and remove brush window and brush roll to remove obstruction
<b>Machine won't turn on</b>	Due to the safety condieration, need to hold and press until the machine is on.	Hold and press until the machine is on.
<b>Machine won't turn off</b>	Due to the safety condieration, press shortly.	Press shortly. The machine will turn off few second later.
<b>Machine is leaking</b>	Cap of clean water tank is not closed properly	Remove the clean water tank and re-apply the cap



### Beware

**DO NOT fill in any liquid, except water and specific cleaning solution. In order to avoid blockage and damage on this machine.**



總代理 Sole Agent:

昇鋒國際有限公司 Pro Logic International Limited

香港九龍紅磡鶴園東街4號恆藝珠寶大廈1樓106-107室

Unit 106-107, 1/F, Heng Nagai Jewelry Centrem 4 Hok Yeun Street East,  
Hung Hom, Kowloon, HK

Tel: (852) 2365 0655

分銷商 Distributor:

愛家名品有限公司 iPlusHome Limited

香港九龍紅磡鶴園東街4號恆藝珠寶大廈1樓106-107室

[www.iplushome.hk](http://www.iplushome.hk)



[www.primada.com.hk](http://www.primada.com.hk)

