

TRUSE DE SCULE DIN ALUMINIU  
159PCS

ZINCAT

13,3	1	32
Kg		

Material: CR-V

159  
PCS

CrV

1/4"

1/2"



53159



PIESE  
DISPONIBILE

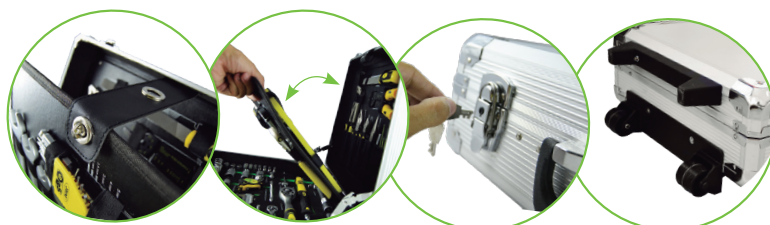

CONTAIN

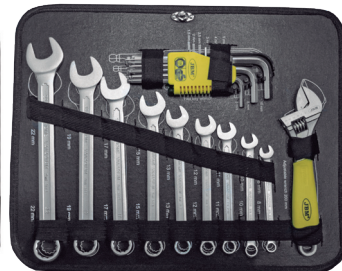
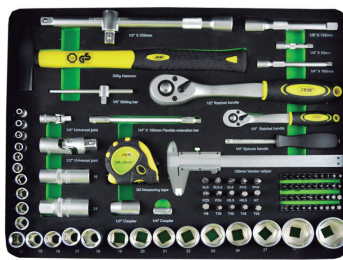

	1/2"	x14	14, 15, 16, 17, 18, 19, 20, 21, 22, 23, 24, 27, 30, 32mm
	1/4"	x10	4, 5, 6, 7, 8, 9, 10, 11, 12, 13mm
		x2	1/4" - 1/2"
	1/2"	x2	50, 100mm
	1/4"	x2	125, 250mm
	1/4"	x1	150mm
		x2	1/4" - 1/2"
	1/2"	x1	Übergangsstück 3/8"(H) x 1/2"M
		x2	1/4" - 1/2"
	1/4"	x1	250mm
	1/4"	x1	110mm
	1/2"	x2	16, 21mm
		x1	1/4"

		x9	8, 10, 11, 12, 13, 15, 17, 19, 22mm
		x9	1.5, 2, 2.5, 3, 4, 5, 6, 8, 10mm
		x1	100-250V
		x1	
	+	x2	PH1x80, PH2x100mm
	-	x4	SL3x75, SL4x100, SL6.5x125, SL8x150mm
	+	x1	PH00x50mm
	-	x1	SL2.5x50mm
		x1	250mm
		x1	200mm
		x1	160mm
		x1	7" (180mm)
		x1	180mm
		x1	220mm
		x1	160mm

		x1	
		x6	1,5mm
		x1	
		x1	300gr
		x1	3m
		x1	200mm
		x5	
		x1	18mm
		x10	
		x40	6.35mm
		x15	8mm