



Village of Saranac Lake - Planning Department

39 Main St.
Saranac Lake, NY 12983
Phone (518) 891-4150
www.saranaclakeny.gov

Instructions:

- A complete application must include a Site Plan with all information pertinent to the project (a site plan example is attached)
- Site Plan Review application fee - \$250.00
- SEQR - Short Environmental assessment form, part 1 (attached)
- WAF - Waterfront Assessment Form, section B (attached)
- Incomplete applications will not be placed on the Development Board agenda
- Dependent on the project scope, a public hearing may be required: <https://ecode360.com/31626259>
- Site Plan regulations can be found at: <https://ecode360.com/31626635>

SITE PLAN REVIEW APPLICATION

Project Address:		Tax Map #:	Zoning District
Property Owner Name:		Applicant Name (if different):	
Address:		Address:	
City:	State:	City:	State:
Phone:	Zip:	Phone:	Zip:
Email:		Email:	

Please provide a written description of the project with relevant details, i.e., days/hours of operation, proposed exterior changes.

Narrative

--

Property Owner Signature(required): _____ Date: _____

Applicant Signature(if different): _____ Date: _____

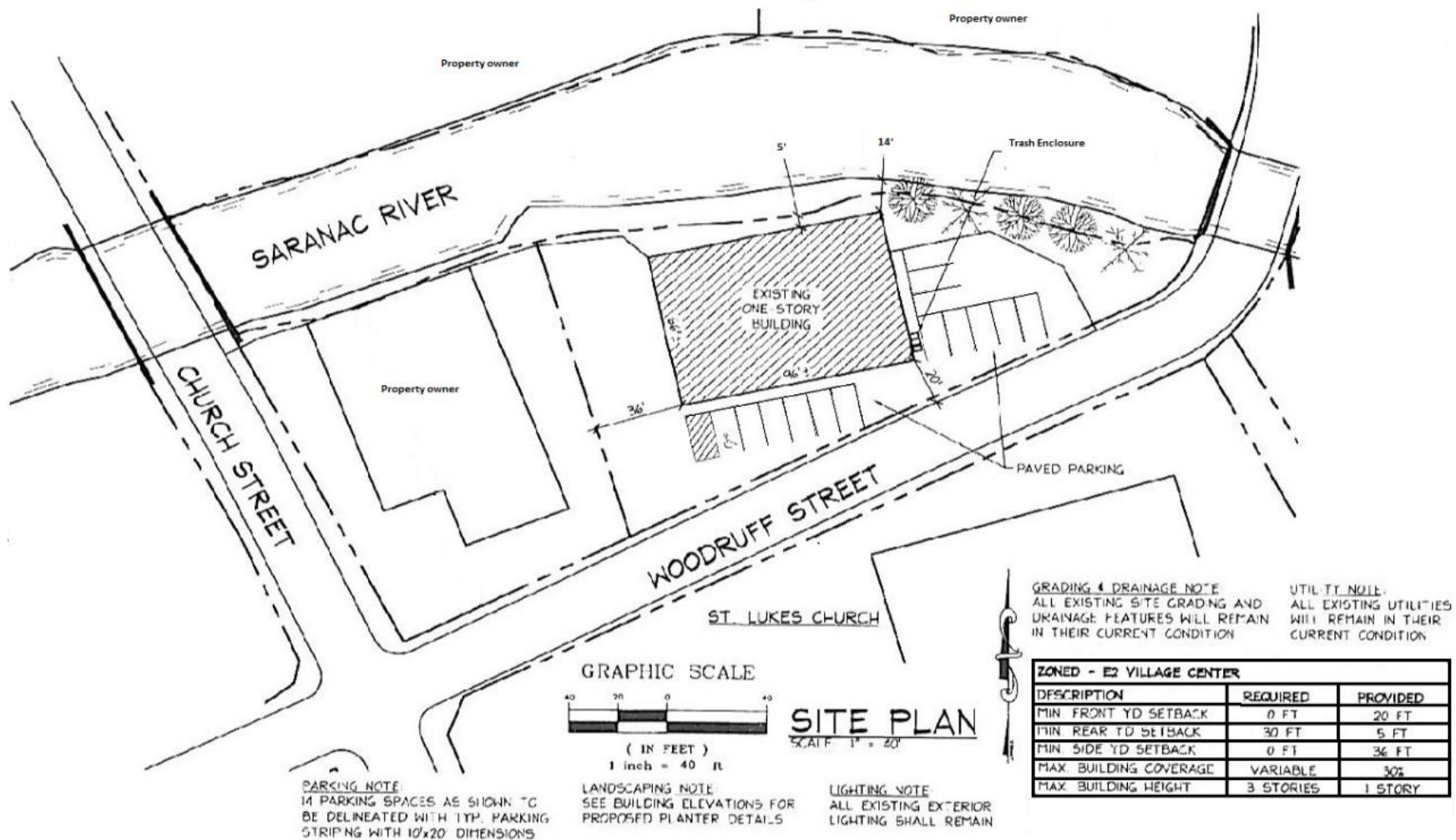

Site Plan Checklist: This sample plan is for reference only. Your plan may require additional information

Property boundaries with setbacks; plotted to scale

Adjoining property owner names

Wetlands, floodplain and drainage pattern

Stormwater control infrastructure

Locations, use, and height of existing and proposed structures

Floor plan with use for each area

Location, width and name of adjacent streets

Location, width, purpose of easements

Parking/loading areas with spaces delineated

Site ingress/egress indicated

Areas of impervious surface

Cardinal direction

Topographic contour lines, existing and proposed

Existing vegetative cover and proposed landscaping

Signage

Exterior lighting

Utility locations

Short Environmental Assessment Form

Part 1 - Project Information

Instructions for Completing

Part 1 - Project Information. The applicant or project sponsor is responsible for the completion of Part 1. Responses become part of the application for approval or funding, are subject to public review, and may be subject to further verification. Complete Part 1 based on information currently available. If additional research or investigation would be needed to fully respond to any item, please answer as thoroughly as possible based on current information.

Complete all items in Part 1. You may also provide any additional information which you believe will be needed by or useful to the lead agency; attach additional pages as necessary to supplement any item.

Part 1 - Project and Sponsor Information				
Name of Action or Project:				
Project Location (describe, and attach a location map):				
Brief Description of Proposed Action:				
Name of Applicant or Sponsor:		Telephone:		
		E-Mail:		
Address:				
City/PO:		State:	Zip Code:	
1. Does the proposed action only involve the legislative adoption of a plan, local law, ordinance, administrative rule, or regulation? If Yes, attach a narrative description of the intent of the proposed action and the environmental resources that may be affected in the municipality and proceed to Part 2. If no, continue to question 2.			NO	YES
2. Does the proposed action require a permit, approval or funding from any other governmental Agency? If Yes, list agency(s) name and permit or approval:			NO	YES
3.a. Total acreage of the site of the proposed action? _____ acres				
b. Total acreage to be physically disturbed? _____ acres				
c. Total acreage (project site and any contiguous properties) owned or controlled by the applicant or project sponsor? _____ acres				
4. Check all land uses that occur on, adjoining and near the proposed action.				
<input type="checkbox"/> Urban <input type="checkbox"/> Rural (non-agriculture) <input type="checkbox"/> Industrial <input type="checkbox"/> Commercial <input type="checkbox"/> Residential (suburban)				
<input type="checkbox"/> Forest <input type="checkbox"/> Agriculture <input type="checkbox"/> Aquatic <input type="checkbox"/> Other (specify): _____				
<input type="checkbox"/> Parkland				

<p>18. Does the proposed action include construction or other activities that result in the impoundment of water or other liquids (e.g. retention pond, waste lagoon, dam)?</p> <p>If Yes, explain purpose and size: _____</p> <p>_____</p> <p>_____</p>	<p>NO</p>	<p>YES</p>
<p>19. Has the site of the proposed action or an adjoining property been the location of an active or closed solid waste management facility?</p> <p>If Yes, describe: _____</p> <p>_____</p> <p>_____</p>	<p>NO</p>	<p>YES</p>
<p>20. Has the site of the proposed action or an adjoining property been the subject of remediation (ongoing or completed) for hazardous waste?</p> <p>If Yes, describe: _____</p> <p>_____</p> <p>_____</p>	<p>NO</p>	<p>YES</p>
<p>I AFFIRM THAT THE INFORMATION PROVIDED ABOVE IS TRUE AND ACCURATE TO THE BEST OF MY KNOWLEDGE</p> <p>Applicant/sponsor name: _____ Date: _____</p> <p>Signature: _____</p>		



Village of Saranac Lake

Community Development Department
 39 Main St.
 Saranac Lake, NY 12983
 Phone (518) 891-0490
 Fax (518) 891-5928
www.saranaclakeny.gov

VILLAGE OF SARANAC LAKE WATERFRONT ASSESSMENT FORM (WAF)

Section A. Instructions

Instructions: Applicants or, in the case of direct actions, Village agencies, shall complete this WAF for proposed actions which are subject to the LWRP consistency review law. This assessment is intended to supplement other information used by a Village agency in making a determination of consistency with the Village's Local Waterfront Revitalization Program.

Before answering the questions in Section C, the preparer of this form should review the policies and explanations of policy contained in the Local Waterfront Revitalization Program (LWRP), a copy of which is on file in the Village of Saranac Lake, 39 Main St., Second Floor, Saranac Lake, NY 12983 or online at www.saranaclakeny.gov. A proposed action should be evaluated as to its significant beneficial and adverse effects upon the waterfront area.

If any question in Section C on this form is answered "yes", then the proposed action may affect the achievement of the LWRP policy standards and conditions contained in the consistency review law. Thus, the actions should be analyzed in more detail and, if necessary, modified prior to making a determination that it is consistent to the maximum extent practicable with the LWRP policy standards and conditions. If an action cannot be certified as consistent with the LWRP policy standards and conditions, it shall not be undertaken.

SECTION B. Description of Site and Proposed Action

1. Name of applicant:	
2. Mailing address:	3. Telephone Number:
4. Location of action:	5. Tax Map # (s):
6. Size of site:	7. Present land use(s):
8. Present zoning classification:	9. Percentage of site which contains slopes of 15% or greater:
10. Type of action (check appropriate response) <input type="checkbox"/> Directly undertaken (e.g. capital construction, planning activity, agency regulation, land transaction) <input type="checkbox"/> Financial assistance (e.g. grant, loan, subsidy) <input type="checkbox"/> Permit, approval, license, certification <input type="checkbox"/> Agency undertaking action:	
11. Streams, lakes, ponds, or wetlands existing within or continuous to the project area? <input type="checkbox"/> No <input type="checkbox"/> Yes If yes, Waterbody Name: _____ Waterbody Size(in acres): _____	
12. Describe nature and extent of action:	
13. Describe any unique or unusual land forms on the project site (i.e. bluffs, ground depressions, other geological formations):	
14. Will the action be directly undertaken, require funding, or approval by a State or Federal Agency? <input type="checkbox"/> No <input type="checkbox"/> Yes If yes, which State or Federal Agency?	

SECTION C. Waterfront Assessment (To be completed by reviewing agency)

	YES	NO
1. Will the proposed action have a significant effect upon:		
(a) Commercial or recreational use of fish and wildlife resources	<input type="checkbox"/>	<input type="checkbox"/>
(b) Scenic quality of the waterfront environment?	<input type="checkbox"/>	<input type="checkbox"/>
(c) Development of future, or existing water dependent uses?	<input type="checkbox"/>	<input type="checkbox"/>
(d) Stability of the shoreline?	<input type="checkbox"/>	<input type="checkbox"/>
(e) Surface or groundwater quality?	<input type="checkbox"/>	<input type="checkbox"/>
(f) Existing or potential public recreation opportunities?	<input type="checkbox"/>	<input type="checkbox"/>
(g) Structures, sites or districts of historic, archeological or cultural significance to the Village, State or nation?	<input type="checkbox"/>	<input type="checkbox"/>
2. Will the proposed action involve or result in any of the following:		
(a) Physical alteration of land along the shoreline, land under water or coastal waters?	<input type="checkbox"/>	<input type="checkbox"/>
(b) Physical alteration of two (2) acres or more of land located elsewhere in the waterfront area?	<input type="checkbox"/>	<input type="checkbox"/>
(c) Expansion of existing public services or infrastructure in undeveloped or low density areas of the waterfront area?	<input type="checkbox"/>	<input type="checkbox"/>
(d) Energy facility not subject to Article VII or VIII of the Public Service Law?	<input type="checkbox"/>	<input type="checkbox"/>
(e) Mining, excavation, filling or dredging?	<input type="checkbox"/>	<input type="checkbox"/>
(f) Reduction of existing or potential public access to or along the shore?	<input type="checkbox"/>	<input type="checkbox"/>
(g) Sale or change in use of publicly-owned lands located on the shoreline or under water?	<input type="checkbox"/>	<input type="checkbox"/>
(h) Development within designated flood hazard area?	<input type="checkbox"/>	<input type="checkbox"/>
(i) Development on a natural feature that provides protection against flooding or erosion?	<input type="checkbox"/>	<input type="checkbox"/>
(j) Diminished surface or groundwater quality?	<input type="checkbox"/>	<input type="checkbox"/>
(k) Removal of ground cover from the site?	<input type="checkbox"/>	<input type="checkbox"/>
3. Project:		
(a) If a project is to be located adjacent to shore:		
(1) Will water-related recreation be provided?	<input type="checkbox"/>	<input type="checkbox"/>
(2) Will public access to the shoreline be provided?	<input type="checkbox"/>	<input type="checkbox"/>
(3) Does the project require a waterfront site?	<input type="checkbox"/>	<input type="checkbox"/>
(4) Will it supplant a recreational or maritime use?	<input type="checkbox"/>	<input type="checkbox"/>
(5) Do essential public services and facilities presently exist at or near the site?	<input type="checkbox"/>	<input type="checkbox"/>
(6) Is it located in a flood prone area	<input type="checkbox"/>	<input type="checkbox"/>
(7) Is it located in an area of high erosion	<input type="checkbox"/>	<input type="checkbox"/>
(b) If the project site is publicly owned:		
(1) Will the project protect, maintain and/or increase the level and types of public access to water-related recreation resources and facilities?	<input type="checkbox"/>	<input type="checkbox"/>
(2) If located in the foreshore, will access to those and adjacent lands be provided?	<input type="checkbox"/>	<input type="checkbox"/>
(3) Will it involve the siting and construction of major energy facilities?	<input type="checkbox"/>	<input type="checkbox"/>
(4) Will it involve the discharge of effluents from major steam electric generating and industrial facilities into a waterway	<input type="checkbox"/>	<input type="checkbox"/>
(c) Is the project site presently used by the community as an open space or recreation area?	<input type="checkbox"/>	<input type="checkbox"/>
(d) Does the present site offer or include scenic views or vistas known to be important to the community?	<input type="checkbox"/>	<input type="checkbox"/>
(e) Will the surface area of any waterways or wetland areas be increased or decreased by the proposal?	<input type="checkbox"/>	<input type="checkbox"/>
(f) Will the project involve any waste discharges?	<input type="checkbox"/>	<input type="checkbox"/>
(g) Does the project involve surface or subsurface liquid waste disposal?	<input type="checkbox"/>	<input type="checkbox"/>
(h) Does the project involve transport, storage, treatment or disposal of solid waste or hazardous material?	<input type="checkbox"/>	<input type="checkbox"/>
(i) Does the project involve shipment or storage of petroleum products?	<input type="checkbox"/>	<input type="checkbox"/>
(j) Does the project involve discharge of toxics, hazardous substances or other pollutants?	<input type="checkbox"/>	<input type="checkbox"/>
(k) Will the project affect any area designated as a freshwater wetland?	<input type="checkbox"/>	<input type="checkbox"/>
(l) Will the project alter drainage flow, patterns or surface water runoff on or from the site	<input type="checkbox"/>	<input type="checkbox"/>
(m) Will best management practices be utilized to control storm water runoff into waterways?	<input type="checkbox"/>	<input type="checkbox"/>
(n) Will the project cause emissions which exceed Federal or State air quality standards or generate significant amounts of nitrates or sulfates?	<input type="checkbox"/>	<input type="checkbox"/>

SECTION D. Remarks or Additional Information

For questions answered "Yes" in Section C, explain methods you will undertake to reduce adverse effects. Review the LWRP to see if the project is consistent with each policy. List policies the project is not consistent with and explain all mitigating actions. Add any additional sheets necessary to complete this form.

SECTION E. Preparer Information

Preparer's Name (Please print):

Title:

Organization Name:

Phone Number:

Signature:

Date:

SECTION F. Determination of LWRP Consistency (To be completed by the Planning Board)

The Village of Saranac Lake Planning Board finds that the above referenced project is:

- consistent with LWRP policy standards and conditions.
- not consistent with LWRP policy standards and conditions and shall not be undertaken.

Print Name of Planning Board Chair

Signature of Planning Board Chair

Date