

#43682

STATE OF TEXAS X
 X
COUNTY OF PARKER X

WHEREAS, on the 8th day of April, 1969, the application of more than twenty-five (25) electors of the proposed Town of Sanctuary, County of Parker, State of Texas, residing within the boundaries thereof, which boundaries are hereinafter described in detail, was duly signed, presented and filed with me, Bill Ward, County Judge of Parker County, Texas, praying that an election be ordered held in said Town of Sanctuary, Texas, within the boundaries described in said application by metes and bounds and attached thereto, for the purpose of determining whether said Town of Sanctuary, Texas, should be incorporated for municipal purposes to include the territory described in said application, said Town to be incorporated by the name of Sanctuary, Texas, under and by virtue of the Constitution and the laws of the State of Texas, under Articler 1134, et. seq., of Chapter 11, Title 28, V.A.C.S. of Texas of 1925; and

WHEREAS, on the 18th day of April, 1969, there was upon evidence heard and proof submitted, found, adjudged and determined by me, Bill Ward, County Judge of Parker County, Texas that said Town of Sanctuary, Texas, so proposed to be incorporated and the territory included within the boundaries thereof, was wholly within Parker County, Texas, and that the proposed Town of Sanctuary, Texas, was not incorporated for municipal purposes and no portion thereof was within a municipal corporation, and that said application was signed by more than twenty-five (25) residents and qualified voters and electors within the boundaries described in said application, and it was further found and adjudged that the territory embraced was suitable for Town purposes and contained more than

two-hundred (200) and less than ten-thousand (10,000) inhabitants, and that the said petitioners were entitled to have the proposition as prayed for in their said application submitted to a vote of the people as provided by Article 1136 of Chapter 11, Title 28, V.A.C. S., and thereupon on said day, I Bill Ward, County Judge of Parker County, Texas, ordered that an election be held on the 3rd day of May, 1969, in said proposed Town of Sanctuary, Texas and within the boundaries described in said application, for the purpose of determining whether the Town of Sanctuary, Texas, should be incorporated as prayed for; and

WHEREAS, thereafter notice of said election was duly posted in three (3) public places for at least ten (10) days prior to the holding of said election and upon my order a question of incorporation was submitted to the voters at such time and at such place in the following manner:

Qualified electors and residents within the area are given an opportunity to vote either on "incorporation" or "no incorporation".

WHEREAS, it further appearing that all prerequisites of the law were met under the election code of the State of Texas and under and by virtue of my order entered on the 18th day of April, 1969, calling said election.

WHEREAS, on this the 5TH day of May, 1969, returns of said election were duly made and filed with me, and thereafter duly opened and canvassed by me and said returns being so canvassed, it was found and determined that were cast at said election a total of 30 votes, of which number there were cast;

FOR INCORPORATION, 29 Votes

AGAINST INCORPORATION, 1 Votes

MAJORITY FOR INCORPORATION, 28 Votes

The said returns of said Election were in all respects in conformity with law, it was thereafter adjudged that a majority of qualified electors of the said Town of Sanctuary, Texas, voting at said election, voted in favor of incorporating the Town of Sanctuary, Texas, under the law of the State of Texas, for municipal purposes.

NOW, THEREFORE, I Bill Ward, County Judge of Parker County, Texas, by my virtue of the authority vested in me by law and in pursuance to Title 28, Chapter 11, Article 1139, of V.A.C.S. of the State of Texas, do hereby declare and make known to all persons that the Town of Sanctuary, Texas, is legally incorporated for Municipal purposes, under the name of Sanctuary, Texas, including all the inhabitants and territory within the boundaries described hereinafter and shall hence forther be entitled to exercise all of the rights, powers, immunities, privileges and franchises as conferred by Chapter 11, Title 28, V.A.C.S. of the State of Texas relating to towns and villages, and the Constitution and general laws of the State of Texas, to include and embrace the following described territory and lands, being the same as described in said application and in said order and notice of election, and plat attached thereto, and described by metes and bounds as follows:

BEGINNING at the Northwest corner of Shadow Lane Estates, as recorded in Volume 344, page 603, of the Deed Records of Parker County, Texas, said point being on the South side of State Highway 199 (Jacksboro Highway);

THENCE South along the Westerly boundary of Shadow Lane Estates to the South side of Dorothy Lane;

THENCE East along the South line of Dorothy Lane to a point where it intersects the West line of the J. Rash Survey, Abstract 1114, Parker County, Texas;

THENCE South with said West line to the Southwest corner of said J. Rash Survey;

THENCE East along the South boundary line to the Southeast corner of said J. Rash Survey;

THENCE North along the East boundary of the J. Rash Survey to a point where it intersects with the South line of State Highway 199 (Jacksboro Highway);

THENCE in a Northwesterly direction along the South line of State Highway 199 (Jacksboro Highway) to the point of beginning;

Said area is further defined on the attached plat marked Exhibit "A" and incorporated by reference as fully as though copied verbatim herein.

THIS ORDER is made and entered by me in the record of the Commissioners' Court of Parker County, Texas, this the 12 day of May, 1969, and the County Clerk is ordered to prepare and duly certify a true, full and complete copy of this order, together with a place of said Town of Sanctuary, Texas, and to record the same in the proper deed records of Parker County, Texas.

In witness whereof, my official hand this the 12 day of May, 1969.

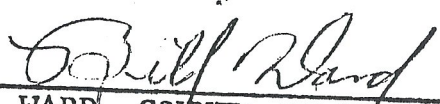
BILL WARD, COUNTY JUDGE
PARKER COUNTY, TEXAS

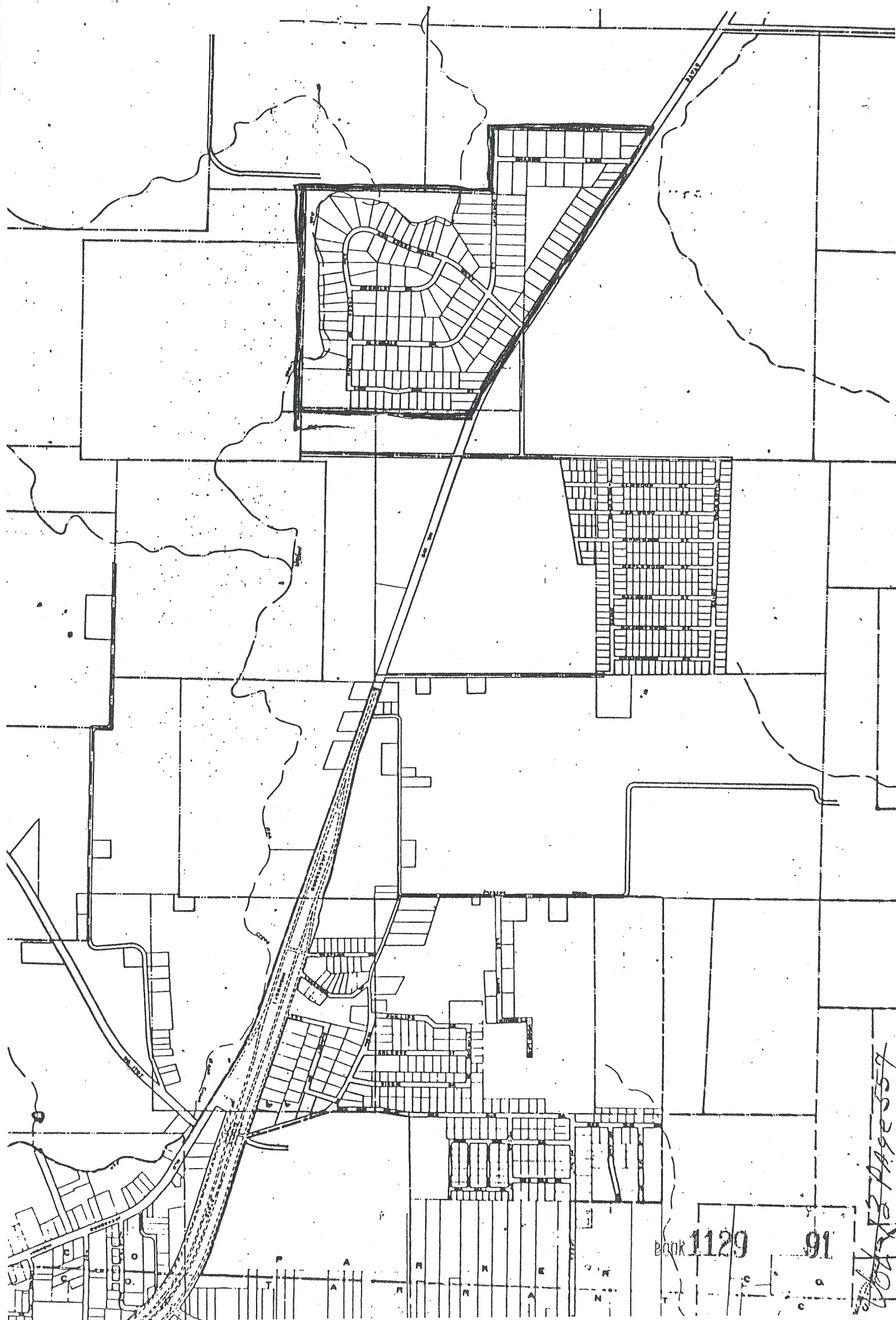

43682-04

RECEIVED AND FILED
FOR RECORD
At 2:30 o'clock P. M.

DEC 10 1981

CARRIE REED, Co. Clerk
PARKER COUNTY, TEXAS

By ew Deputy
w/c-

STATE OF TEXAS COUNTY OF PARKER
I hereby certify that this instrument was recorded
on the date and time and place above stated and
was duly recorded in the books and named records of said county
on by me.

RECORDED DEC 10 1981



Carrie Reed
County Clerk, Parker County, Tex

County Clerk, for Parker County, Texas, hereby
certify that the foregoing is true, correct and full
copy of the original as it appears in the office
of the County Clerk, at the County Clerk's office.
This is the original of the original.
Vol. 13
Page 533-557
By Carrie Reed
Deputy
County Clerk

Comm Court of Mts.

THE STATE OF TEXAS

X
X
X

COUNTY OF PARKER

PETITION FOR THE CALLING OF AN INCORPORATION
ELECTION FOR THE TOWN OF SANCTUARY, TEXAS

TO THE HONORABLE BILL WARD, COUNTY JUDGE:

We, the undersigned, do hereby petition this honorable Court to enter its order calling an election for the purpose of determining whether or not the qualified voters of the area hereinafter described desire to incorporate said town of Sanctuary, Texas, pursuant to the provisions of Chapter 11, Title 28 of Vernon's Annotated Civil Statutes of the State of Texas.

The area sought to be incorporated is described as follows:

BEGINNING at the Northwest corner of Shadow Lane Estates, as recorded in Volume 344, page 603, of the Deed Records of Parker County, Texas, said point being on the South side of State Highway 199 (Jacksboro Highway);
THENCE South along the Westerly boundary of Shadow Lane Estates to the South side of Dorothy Lane;
THENCE East along the South line of Dorothy Lane to a point where it intersects the West line of the J. Rash Survey, Abstract 1114, Parker County, Texas;
THENCE South with said West line to the Southwest corner of said J. Rash Survey;
THENCE East along the South boundary line to the Southeast corner of said J. Rash Survey;
THENCE North along the East boundary of the J. Rash Survey to a point where it intersects with the South line of State Highway 199 (Jacksboro Highway);
THENCE in a Northwesterly direction along the South line of State Highway 199 (Jacksboro Highway) to the point of beginning;

Said area is further defined on the attached plat marked Exhibit "A" and incorporated by reference as fully as though copied verbatim herein.

In support of this petition Applicants would show:

- A. The area sought to be incorporated contains more than 200 and less than 10,000 inhabitants.
- B. The area described is suitable for town purposes.

C. At least 20 qualified voters of the area have and do now make application for the calling of said election.

All of the undersigned are at least twenty-one (21) years of age, have resided within the area for at least six months and are qualified electors under the law.

WHEREFORE, PREMISES CONSIDERED, Petitioners pray that the honorable County Judge of Parker County, Texas, enter an order calling for an election to be held on _____, to determine the question of incorporation of the Town of Sanctuary, Parker County, Texas, and appointing a presiding officer to hold said election, all to be done in compliance with Chapter 11, Title 28 of Vernon's Annotated Civil Statutes of the State of Texas and the election laws of this State.

Respectfully submitted,

NAME	ADDRESS
<u>J. O. Brown</u>	<u>325 Ash Creek Dr. West</u>
<u>Mrs. J. O. (Bettye) Brown</u>	<u>325 Ash Creek Dr. West</u>
<u>Mr. J. M. Brooks</u>	<u>201 Ash Creek Dr. W.</u>
<u>Mrs. J. H. Gustafson</u>	<u>2108 Dorothy Lane</u>
<u>R. W. Bechler</u>	<u>100 Shadow Lane</u>
<u>W. C. Elder</u>	<u>116 Shadow Ln.</u>
<u>Genevieve Gilder</u>	<u>116 Shadow Lane</u>
<u>W. F. Marsh</u>	<u>200 Ash Creek Dr. W.</u>
<u>Mrs. W. F. Marsh</u>	<u>200 Ash Creek Dr. W.</u>

NAME

ADDRESS

<u>Mrs. Eliza H. Pigg</u>	<u>1909 Ash Creek</u>
<u>Mrs. J. M. Brooks</u>	<u>201 Ash Creek Dr.</u>
<u>Mrs. E. Moore</u>	<u>317 Ash Creek Drive</u>
<u>Mrs. C. R. Robinson</u>	<u>112 Live Oak</u>
<u>Mrs. J. E. Mc Duff</u>	<u>113 Live Oak</u>
<u>Billy O. Pigg Jr.</u>	<u>1909 Ash Creek Dr. S</u>
<u>Vance L. Stevens</u>	<u>301 Ash Creek Dr. W.</u>
<u>Inez Stevens</u>	<u>301 Ash Creek Dr. W.</u>
<u>Glenn T. Brown</u>	<u>304 Ash Creek Dr. W.</u>
<u>Mrs. Euradean Brown</u>	<u>304 Ash Creek Dr. W.</u>
<u>W. L. Rightmer</u>	<u>220 Ash Creek Dr. W.</u>
<u>Mrs. W. C. Rightmer</u>	<u>220 Ash Creek Dr. W.</u>
<u>Albert L. Majors</u>	<u>213 Ash Creek Dr. W.</u>
<u>Mrs. A. L. Majors</u>	<u>213 Ash Creek Dr. W.</u>
<u>(Lou) Majors</u>	<u>113 Shadow Lane</u>
<u>Livingston</u>	<u>128 Shadow Ln.</u>
<u>O. L. Smith</u>	<u>138 Shadow Lane</u>
<u>Mrs. O. L. Smith</u>	<u>2004 Dorothy Lane</u>
<u>Mrs. Donald S. Oglesby</u>	<u>100 Shadow Lane</u>
<u>Mrs. Alice Beck</u>	

NAME

ADDRESS

James E. Spencer

2004 Ash Creek

Mrs Dorothy R. Finckel

104 Shadow Lane

Arthur F. Finckel

128 Lind Park St.

Donald S. Oglesby

2004 Dorothy Lane

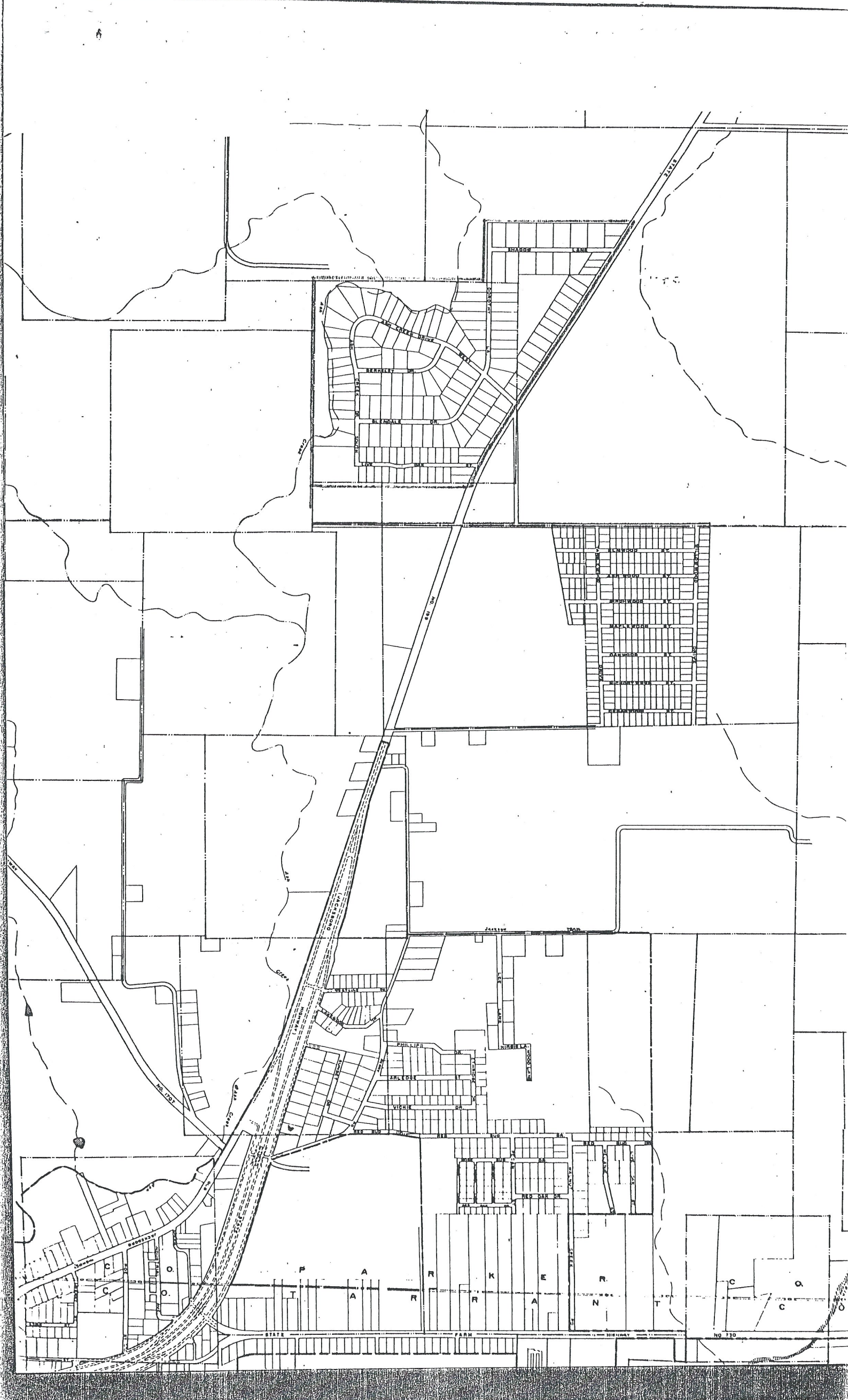

THE STATE OF TEXAS

COUNTY OF TARRANT

X
X
X

BEFORE ME, the undersigned, a Notary Public in and for said County, State of Texas, on this day personally appeared Irving Lee, Marie Pigg, Billy Pigg, Jean Baker and Robert R. Baker, to me well known, and who, after being by me duly sworn, depose and say that they are residents and or land owners of that area sought to be incorporated and to be known as Sanctuary, Texas; that they are well acquainted with the area and the people residing therein; that prior to presenting the petition for the calling of an incorporation election for the town of Sanctuary, Texas, they of their own personal knowledge knew there resided within the particular area to be incorporated over 200 people; that on the 19th day of April, 1969, a house to house canvassing of the area was made resulting in a total population count of 224 as evidenced by the information set out below:

AREA, STREET ADDRESS,
LOT NO., or NAME

NUMBER OF PEOPLE
RESIDING IN THE PREMISES

SHADOW LANE ESTATES

Shadow Lane

Beck	3
Kinchen	2
Wood	3
Heath	4
Lee	4
Gildon	4
C. Wood	4
Cook	3
Bradford	5
Smith	4
Summers	2

Facing Highway 199

Lot 2 Block 2	3
Ramsey	1
Gunter	6
Beauty Shop	2
Marchbanks	5
Lot 39 (Gift Shop)	2

AREA, STREET ADDRESS,
LOT NO., or NAME

NUMBER OF PEOPLE
RESIDING IN THE PREMISES

LIVE OAK PARK ADDITION

Live Oak Street

Morgan	4
Denton	4
Lot 32	3
Cox	4
Laird	3
Tinney	4
Snots	5
Hall	6
124 Live Oak St.	3
White	4
Mrs. Spurrier	1
Jack Spurrier	9
Wilson	2
Robinson	5
McDuff	4
109 Live Oak St.	2
108 Live Oak St.	4
Mosley	4
105 Live Oak St.	3
Bishop	3

ASH CREEK ESTATES

DOROTHY LANE

Oglesby	5
Gustafson	9

Glendale Street

Perkins	4
Birdwell	2
Love	5
Turner	3
Bass	3
Ralls	4
Branum	4

Ash Creek Drive West

Spencer	2
Crum	2
Brown, T. O.	4
Browning	4
Morgan	2
Moore	4
Brown	6
Stevens	4
Rightmer	4
Majors	3
Brooks	4
Marsh	4

Ash Creek Drive South

Pigg	6
Houston	2

Irving Lee
IRVING LEE

Marie Pigg
MARIE PIGG

Billy Pigg
BILLY PIGG

Jean Baker
JEAN BAKER

Robert R. Baker
ROBERT R. BAKER

SUBSCRIBED AND SWORN TO BEFORE ME, this the 21 day of
APRIL, A. D. 1969.

Billy C. Williams
Notary Public in and for Tarrant
County, Texas

PREPARED IN THE LAW OFFICE OF:
RATTIKIN & HONTS

812 HOUSTON STREET
FORT WORTH, TEXAS 76102

Please return to:

FILED

April 23 1969
BOBBY JOE TIPTON, CO. CLERK
PARKER COUNTY, TEXAS

By *C. Norman* Deputy