

SOUTH MAPLE STREET SEWER RELOCATION

VILLAGE OF NORTH FREEDOM SAUK COUNTY, WISCONSIN

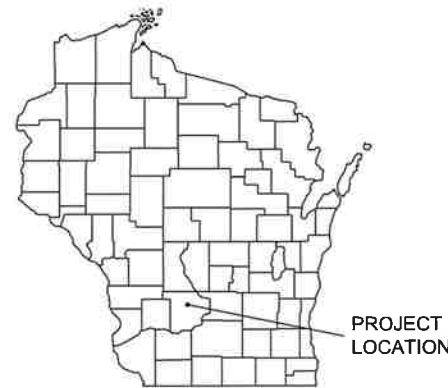

PROJECT LOCATION

SHEET INDEX

G - GENERAL SHEETS

G1	TITLE SHEET
G2	SIPHON MANHOLE DETAILS
G3	UTILITY AND PAVEMENT DETAILS
G4	ELECTRICAL REMOVAL DETAILS
G5	EROSION CONTROL AND GATE DETAILS
G6	TRAFFIC CONTROL DETAILS

P - PLAN SHEETS

P1	PLAN & PROFILE
P2	PLAN - ACCESS ROAD
P3	PLAN - EROSION CONTROL

LEGEND

	EXISTING WATER MAIN
	EXISTING WATER MAIN, VALVE & HYDRANT
	EXISTING WATER SERVICE & CURB STOP
	PROPOSED WATER MAIN, VALVE, & HYDRANT
	PROPOSED WATER SERVICE & CURB STOP
	EXISTING SANITARY SEWER & MANHOLE
	PROPOSED SANITARY SEWER & MANHOLE
	EXISTING FORCEMAIN
	EXISTING STORM SEWER & INLET
	PROPOSED STORM SEWER & INLET
	PROPOSED STORM SEWER & MANHOLE
	BURIED ELECTRIC
	BURIED GAS & VALVE
	BURIED CABLE TELEVISION
	BURIED TELEPHONE
	BURIED FIBER OPTICS
	OVERHEAD UTILITY
	RAILROAD TRACKS
	EXISTING CURB & GUTTER
	PROPOSED CURB & GUTTER
	EXISTING SIDEWALK
	PROPOSED SIDEWALK
	EXISTING CULVERT PIPE
	PROPOSED CULVERT PIPE
	FENCE LINE
	DRAINAGE ARROW
	SILT FENCE
	RIGHT-OF-WAY
	BASELINE
	PROPERTY LINE
	TREE LINE
	BENCHMARK
	IRON PIPE
	IRON ROD
	CONTROL POINT
	UTILITY POLE & GUY
	SOIL BORING
	LIGHT POLE
	PEDESTAL
	STREET SIGN
	MAILBOX
	FLAGPOLE
	TREE - DECIDUOUS
	TREE - CONIFEROUS
	TREE TO BE REMOVED

UTILITIES

GAS & ELECTRIC:	ALLIANT ENERGY JOSH LOBENSTEIN 520 COMMERCE AVE. BARABOO, WI 53913 PHONE: 608-356-0671 EMAIL: JOSHUALOBENSTEIN@ALLIANTENERGY.COM
SEWER & WATER:	VILLAGE OF NORTH FREEDOM 105 N MAPLE ST NORTH FREEDOM, WI 53951 608-522-4522 ATTN: GEORGE STAUBHAAR, DPW
CATV:	BRIGHTSPEED JUSTIN ZUICHES 521 4TH ST WAUSAU, WI 54403 PHONE: 715-847-1240 EMAIL: JUSTIN.ZUICHES@BRIGHTSPEED.COM
CATV:	SPECTRUM ANDY WIETECKA 2701 DANIELS STREET MADISON, WI 53718 PHONE: 608-288-6825 EMAIL: ANDY.WIETECKA@CHARTER.COM

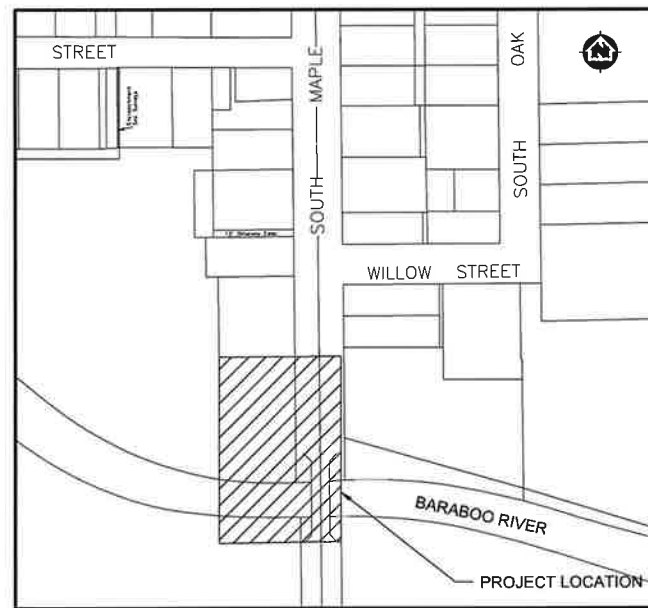

LOCATION MAP

NOT TO SCALE



DIGGERS HOTLINE
Dial 811 or (800) 242-8511
www.DiggersHotline.com

NOTE:
UTILITY LOCATIONS SHOWN ON PLANS ARE APPROXIMATE AND CONTRACTOR SHALL HAVE APPROPRIATE UTILITY MARK EXACT LOCATIONS PRIOR TO CONSTRUCTION.

PROJECT DATE:	DRAWN BY:	DRK	NO.	DATE	REVISION	BY
	DESIGNED BY:	CMM				
	CHECKED BY:	AZ				

PLOT DATE: 11/24/2025 10:37 AM, G:\00\0096\00096041\CADD\Construction Documents\00096041 Title Sheet.dwg

MSA ENGINEERING | ARCHITECTURE | SURVEYING
FUNDING | PLANNING | ENVIRONMENTAL
1230 South Boulevard, Baraboo WI 53913
(608) 356-2771 www.msa-ps.com
© MSA Professional Services, Inc.

SOUTH MAPLE STREET SEWER RELOCATION
VILLAGE OF NORTH FREEDOM
SAUK COUNTY, WISCONSIN

TITLE SHEET

PROJECT NO:
00096041
SHEET
G1

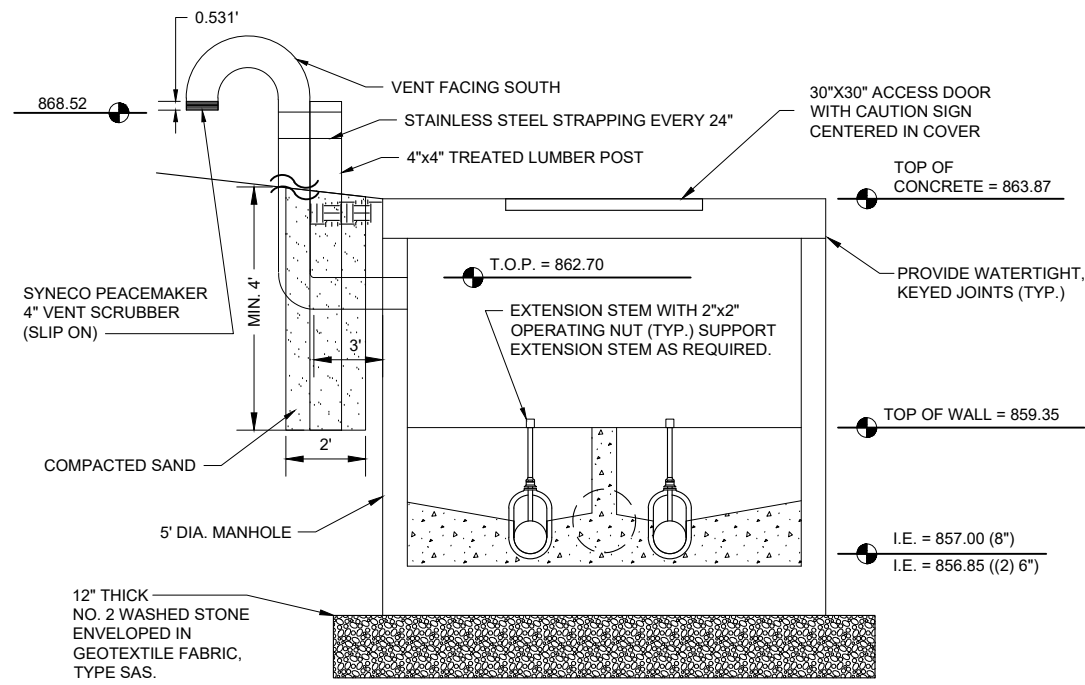

SIPHON INLET MH A - SECTION DETAIL
NOT TO SCALE

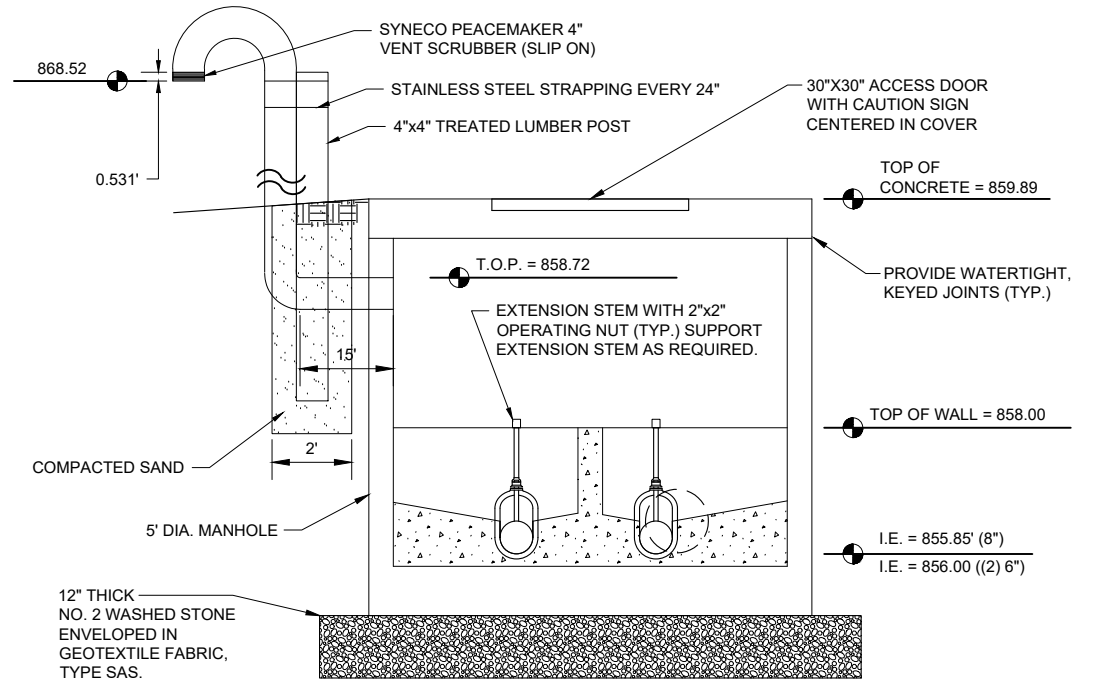

SIPHON OUTLET MH B - SECTION DETAIL
NOT TO SCALE

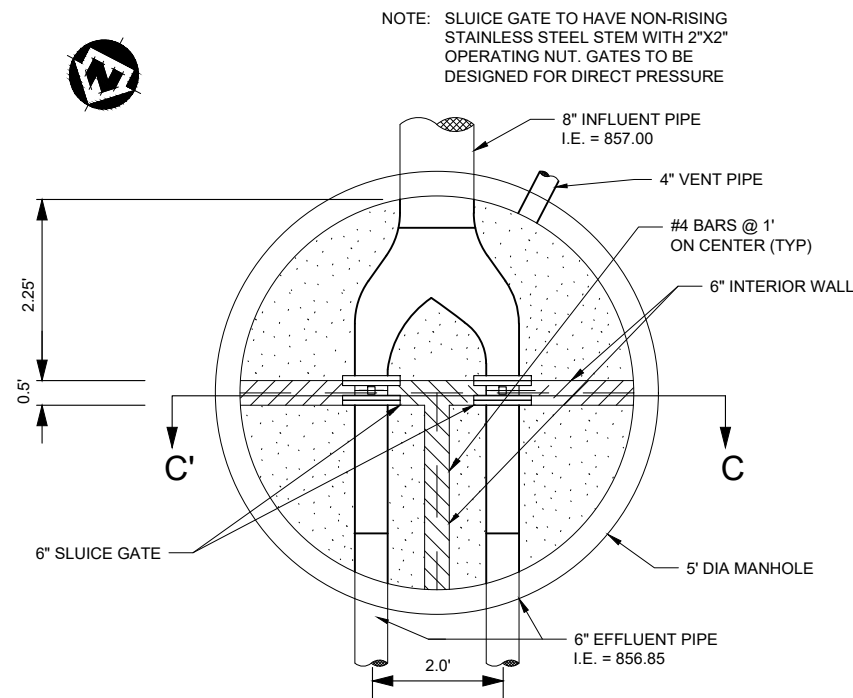

SIPHON INLET MH A - PLAN DETAIL
NOT TO SCALE

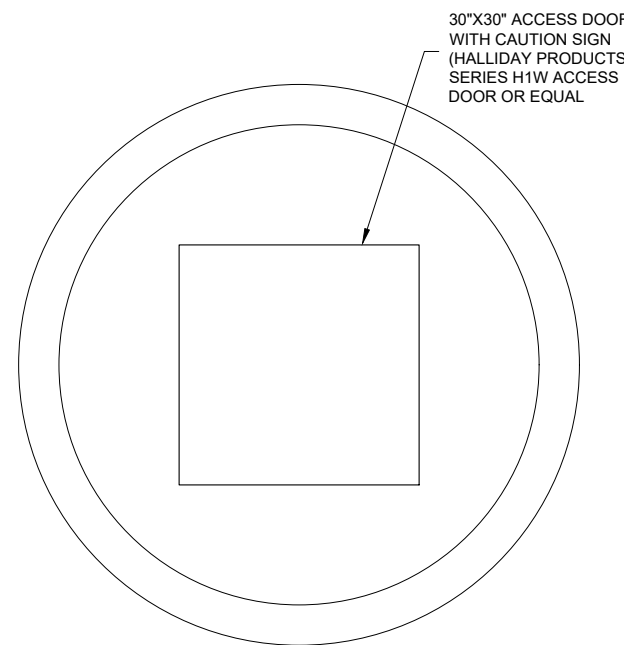

SIPHON MH COVER
NOT TO SCALE

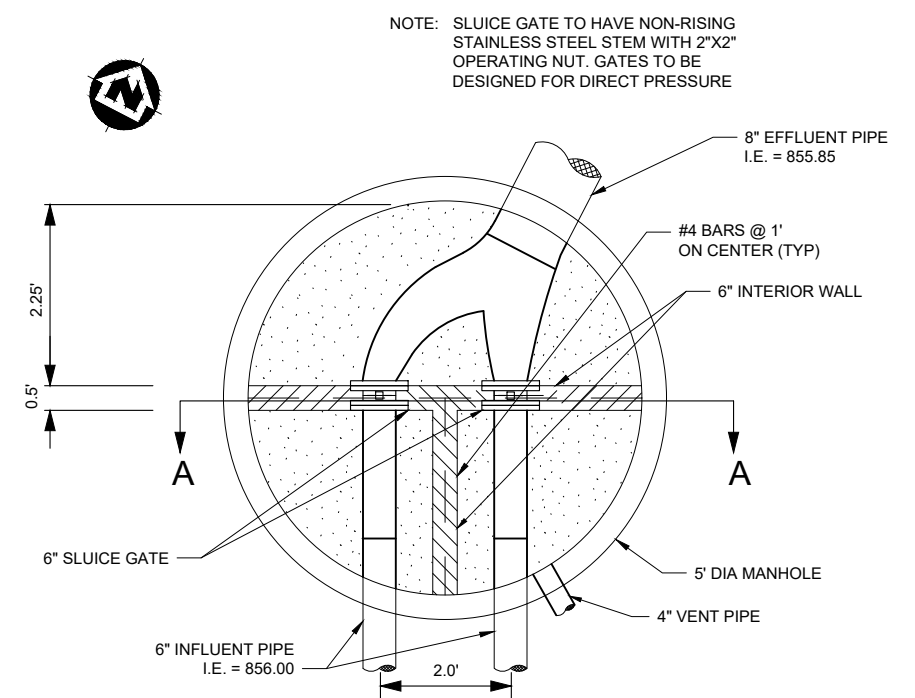

SIPHON OUTLET MH B - PLAN DETAIL
NOT TO SCALE

PROJECT DATE:	DRAWN BY:	NO.	DATE	REVISION	BY:
11/24/2025 10:37 AM, G:\0000096\00096041\CADD\Construction Documents\00096041 Details.dwg	DRK	-	-	-	-
	DESIGNED BY: CMM	-	-	-	-
	CHECKED BY: AZ	-	-	-	-



ENGINEERING | ARCHITECTURE | SURVEYING
FUNDING | PLANNING | ENVIRONMENTAL
1230 South Boulevard, Baraboo WI 53913
(608) 356-2771 www.msa-ps.com
© MSA Professional Services, Inc.

SOUTH MAPLE STREET SEWER RELOCATION
VILLAGE OF NORTH FREEDOM
SAUK COUNTY, WISCONSIN

SIPHON MANHOLE DETAILS

PROJECT NO.
00096041
SHEET
G2



REMOVE CONDUIT, PANEL,
AND WIRE TO 12" BELOW
GROUND SURFACE

PROJECT DATE:	DRAWN BY:	NO.	DATE	REVISION	BY:
	DRK	-	-		-
	CMM	-	-		-
	AZ	-	-		-

PLOT DATE: 11/24/2025 10:37 AM, G:\0000096\00096041\CADD\Construction Documents\00096041 Details.dwg

MSA
 ENGINEERING | ARCHITECTURE | SURVEYING
 FUNDING | PLANNING | ENVIRONMENTAL
 1230 South Boulevard, Baraboo WI 53913
 (608) 356-2771 www.msa-ps.com
© MSA Professional Services, Inc.

SOUTH MAPLE STREET SEWER RELOCATION
 VILLAGE OF NORTH FREEDOM
 SAUK COUNTY, WISCONSIN

ELECTRICAL REMOVAL DETAILS

PROJECT NO.
00096041
 SHEET
G4

**CONSTRUCTION SITE
EROSION CONTROL REQUIREMENTS**

- SECTION NR216.46 OF WISCONSIN STATE ADMINISTRATIVE CODE IDENTIFIES REQUIREMENTS FOR CONSTRUCTION SITE AND POST-CONSTRUCTION EROSION CONTROL. IT IS THE INTENT OF THESE PLANS TO SATISFY THESE REQUIREMENTS. THE METHODS AND STRUCTURES USED TO CONTROL EROSION SHALL BE THE RESPONSIBILITY OF THE CONTRACTOR. CONTRACTOR SHALL IMPLEMENT AN APPROPRIATE MEANS OF CONTROLLING EROSION DURING SITE OPERATION AND UNTIL THE VEGETATION IS RE-ESTABLISHED. ADJUSTMENTS TO THE CONTROL SYSTEM SHALL BE MADE AS REQUIRED.
- ALL WORK SHALL BE IN ACCORDANCE WITH THE LATEST EDITION OF THE WISCONSIN DNR'S CONSERVATION PRACTICE STANDARDS. THESE STANDARDS ARE PERIODICALLY UPDATED AND IT IS THE CONTRACTOR'S RESPONSIBILITY TO OBTAIN AND REFERENCE THE MOST RECENTLY RELEASED STANDARD.
- THIS INFORMATION IS ONLY ONE PART OF THE OVERALL EROSION CONTROL REQUIREMENTS. ADDITIONAL REQUIREMENTS MAY ALSO BE SHOWN ON THE CONTRACT DRAWINGS AND IN THE ACCOMPANYING SPECIFICATIONS.
- ADDITIONAL EROSION CONTROL MEASURES, AS REQUESTED IN WRITING BY THE STATE OR LOCAL INSPECTORS, OR THE OWNER'S ENGINEER, SHALL BE INSTALLED WITHIN 24 HOURS.
- THE AREA OF EROSION EXPOSED TO THE ELEMENTS BY GRUBBING, EXCAVATION, TRENCHING, BORROW AND FILL OPERATIONS AT ANY ONE TIME SHALL BE MINIMIZED TO THE MAXIMUM EXTENT PRACTICABLE. FOR ANY DISTURBED AREA THAT REMAINS INACTIVE FOR GREATER THAN 7 WORKING DAYS, OR WHERE GRADING WORK EXTENDS BEYOND THE PERMANENT SEEDING DEADLINES, THE SITE MUST BE TREATED WITH TEMPORARY STABILIZATION MEASURES SUCH AS SOIL TREATMENT, TEMPORARY SEEDING AND/OR MULCHING. ALL DISTURBED AREAS SHALL BE TREATED WITH PERMANENT STABILIZATION MEASURES WITHIN 3 WORKING DAYS OF FINAL GRADING.
- ALL EROSION CONTROL MEASURES AND STRUCTURES SERVING THE SITE MUST BE INSPECTED AT LEAST WEEKLY OR WITHIN 24 HOURS OF THE TIME 0.5 INCHES OF RAIN HAS OCCURRED. ALL NECESSARY REPAIR AND MAINTENANCE WILL BE DONE AT THIS INSPECTION TIME.
- ALL EROSION CONTROL DEVICES AND/OR STRUCTURES SHALL BE PROPERLY INSTALLED PRIOR TO CLEARING AND GRUBBING OPERATIONS WITHIN THEIR RESPECTIVE DRAINAGE AREAS. THESE SHALL BE PROPERLY MAINTAINED FOR MAXIMUM EFFECTIVENESS UNTIL VEGETATION IS RE-ESTABLISHED.
- ALL EROSION CONTROL DEVICES SHALL BE PROPERLY INSTALLED PRIOR TO ANY SOIL DISTURBANCE.
- ANY SLOPES STEEPER THAN 3H:1V SHALL BE STAKED WITH EROSION CONTROL FABRIC UNLESS INDICATED ON THE PLAN.
- ALL WASTE AND UNUSED BUILDING MATERIALS (INCLUDING GARBAGE, DEBRIS, CLEANING WASTES, WASTEWATER, TOXIC MATERIALS, OR HAZARDOUS MATERIALS) SHALL BE PROPERLY DISPOSED OF AND NOT ALLOWED TO BE CARRIED OFF-SITE BY RUNOFF OR WIND.
- WIND EROSION SHALL BE KEPT TO A MINIMUM DURING CONSTRUCTION. WATERING, MULCH, OR A TACKING AGENT MAY BE REQUIRED TO PROTECT NEARBY RESIDENCES AND WATER RESOURCES.
- CHANNELIZED RUNOFF ENTERING THE PROJECT SITE FROM ADJOINING LANDS SHALL BE DIVERTED THROUGH NATURALLY OR ARTIFICIALLY EROSION-RESISTANT CONVEYANCES. IF CHANNELIZED RUNOFF CANNOT BE DIVERTED, SITE BEST MANAGEMENT PRACTICES MUST ACCOUNT FOR THE ADDITIONAL FLOW RATES AND EROSION POTENTIAL THAT SUCH RUNOFF PRESENTS.
- THE CONTRACTOR SHALL TAKE ALL POSSIBLE PRECAUTIONS TO PREVENT SOILS FROM BEING TRACKED ONTO PUBLIC OR PRIVATE ROADWAYS. PAVED SURFACES ADJACENT TO CONSTRUCTION SITE VEHICLE ACCESS SHALL BE SWEEPED AND/OR SCRAPED (NOT FLUSHED) PERIODICALLY TO REMOVE SOIL, DIRT, AND/OR DUST.
- EROSION CONTROLS SHALL BE INSTALLED ON THE DOWNSTREAM SIDE OF TEMPORARY STOCKPILES. ANY SOIL STOCKPILE THAT REMAINS FOR MORE THAN 7 DAYS SHALL BE COVERED OR TREATED WITH STABILIZATION PRACTICES SUCH AS TEMPORARY OR PERMANENT SEEDING AND MULCHING. ALL STOCK PILES SHALL BE PLACED AT LEAST 75 FEET FROM STREAMS OR WETLANDS.
- ADDITIONAL EROSION CONTROL FOR UTILITY CONSTRUCTION (STORM SEWER, SANITARY SEWER, WATER MAIN, ETC.) SHALL INCLUDE THE FOLLOWING:
 - PLACE EXCAVATED TRENCH MATERIAL ON THE HIGH SIDE OF THE TRENCH.
 - BACKFILL, COMPACT, AND STABILIZE THE TRENCH IMMEDIATELY AFTER PIPE CONSTRUCTION.
 - DISCHARGE OF TRENCH WATER OR DEWATERING EFFLUENT MUST BE PROPERLY TREATED TO REMOVE SEDIMENT IN ACCORDANCE WITH THE WDNR CONSERVATION PRACTICE STANDARD 1061 - DEWATERING OR A SUBSEQUENT WDNR DEWATERING STANDARD PRIOR TO DISCHARGE INTO A STORM SEWER, DITCH, DRAINAGEWAY, OR WETLAND OR LAKE.
- ALL DRAINAGE CULVERTS, STORM DRAIN INLETS, MANHOLES, OR ANY OTHER EXISTING STRUCTURES THAT COULD BE DAMAGED BY SEDIMENTATION SHALL BE PROTECTED ACCORDING TO THE VARIOUS METHODS PROVIDED IN THE PRINTED CONSERVATION PRACTICE STANDARDS.
- ANY SOIL EROSION THAT OCCURS AFTER FINAL GRADING AND/OR STABILIZATION MUST BE REPAIRED AND THE STABILIZATION WORK REDONE.
- THE FIRST SIX WEEKS AFTER INITIAL STABILIZATION, ALL NEWLY SEEDED AND MULCHED AREAS SHALL WATERED WHENEVER 7 DAYS ELAPSE WITHOUT A RAIN EVENT.
- WHEN THE DISTURBED AREA HAS BEEN STABILIZED BY PERMANENT VEGETATION OR OTHER MEANS, TEMPORARY BMP'S SUCH AS SILT FENCES, STRAW BALES, AND SEDIMENT TRAPS SHALL BE REMOVED AND THESE AREAS STABILIZED.
- ALL TEMPORARY BEST MANAGEMENT PRACTICES SHALL BE MAINTAINED UNTIL THE SITE IS STABILIZED.
- ALL DISTURBED AREAS SHALL BE PERMANENTLY STABILIZED WITH SEED AND MULCH UNLESS OTHERWISE SPECIFIED. A MINIMUM OF FOUR INCHES OF TOPSOIL SHALL BE APPLIED TO ALL AREAS TO BE SEEDED OR SODDED.

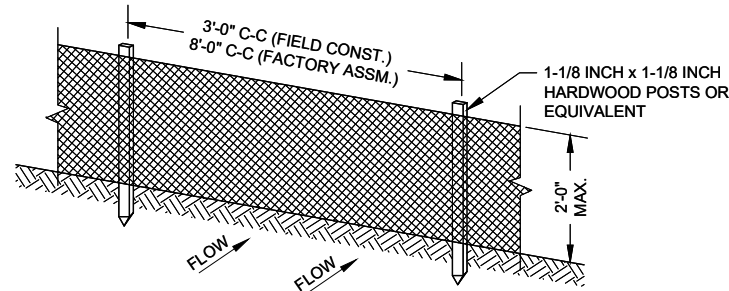
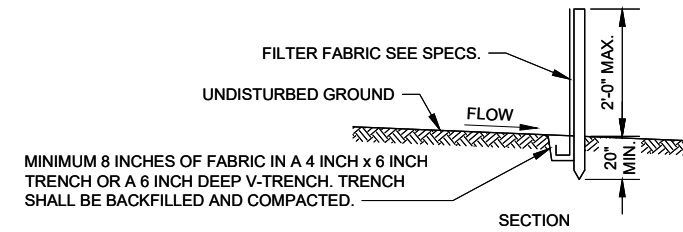

PERSPECTIVE VIEW

GENERAL NOTES:

- ENDS OF FENCE SHALL BE TURNED UPSLOPE 1 TO 2 FEET IN ELEVATION TO PREVENT FLANKING.
- STAPLE FABRIC WITH 1/2 INCH (MINIMUM) STAPLES TO THE UPSLOPE SIDE OF THE POSTS.
- WHEN TWO SECTIONS OF FILTER FABRIC ADJOIN EACH OTHER THEY SHALL BE OVERLAPPED BY SIX INCHES AND FOLDED.

TYPICAL SILT FENCE INSTALLATION AT SITE PERIMETER DETAIL
NO SCALE

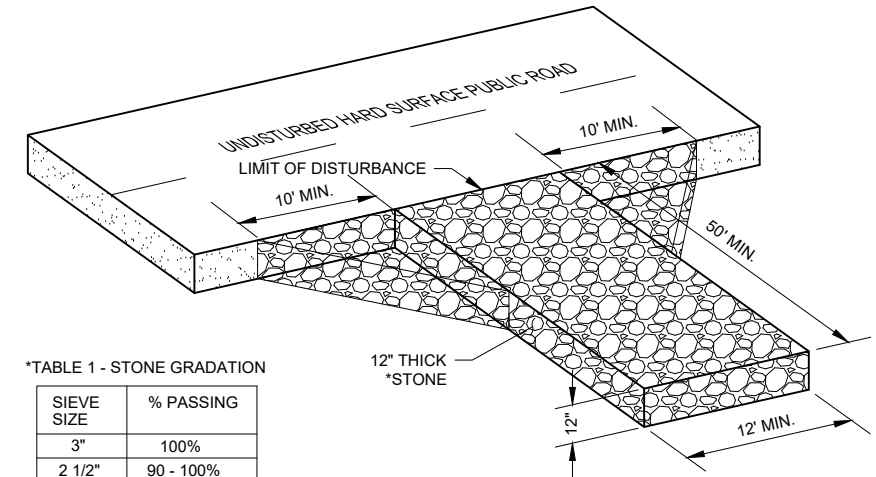

*TABLE 1 - STONE GRADATION

SIEVE SIZE	% PASSING
3"	100%
2 1/2"	90 - 100%
1 1/2"	25 - 60%
3/4"	0 - 20%
3/8"	0 - 5%

NOTES:

- TRACKING PAD WIDTH SHALL BE AT LEAST THE FULL WIDTH OF THE EGRESS POINT OR 12' WIDE MINIMUM.
- TRACKING PAD LENGTH SHALL BE 50' FOR CONSTRUCTION SITES, 30' FOR SINGLE FAMILY RESIDENTIAL, OR AS SPECIFIED IN THE CONTRACT DOCUMENTS. LENGTH OF TRACKING PAD MAY NEED TO BE INCREASED OR ADDITIONAL SEDIMENT CONTROL PRACTICES SHALL BE INSTALLED BY THE CONTRACTOR IF SEDIMENT TRACK-OUT OCCURS.
- GEOTEXTILE FABRIC TYPE R SHALL BE INSTALLED BETWEEN THE STONE AND SUBGRADE ON SITES WHERE HIGH GROUND WATER IS OBSERVED.
- CONTRACTOR SHALL CLEAN STREET/ROADWAY ADJACENT TO ALL CONSTRUCTION ACCESS POINTS AT THE END OF EACH WORKDAY OR MORE FREQUENTLY IF REQUESTED.

STONE TRACKING PAD

NO SCALE

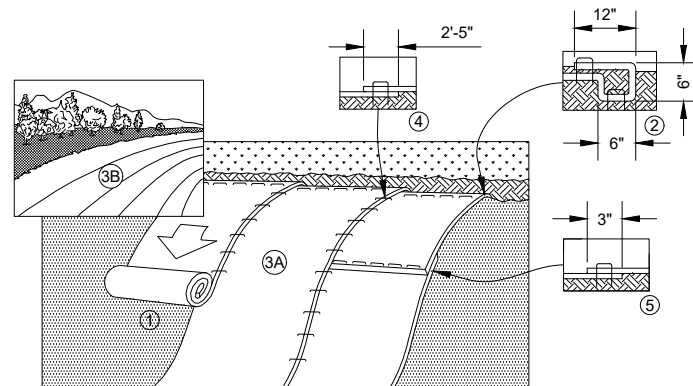

- PREPARE SOIL BEFORE INSTALLING BLANKETS, INCLUDING ANY NECESSARY APPLICATION OF LIME, FERTILIZER, AND SEED.
- BEGIN AT THE TOP OF THE SLOPE BY ANCHORING THE BLANKET IN A 6" (15 CM) DEEP X 6" (15 CM) WIDE TRENCH WITH APPROXIMATELY 12" (30cm) OF BLANKET EXTENDED BEYOND THE UP-SLOPE PORTION OF THE TRENCH. ANCHOR THE BLANKET WITH A ROW OF STAPLES/STAKES APPROXIMATELY 12" (30 CM) APART IN THE BOTTOM OF THE TRENCH. BACKFILL AND COMPACT THE TRENCH AFTER STAPLING. APPLY SEED TO COMPACTED SOIL AND FOLD REMAINING 12" (30 CM) PORTION OF BLANKET BACK OVER SEED AND COMPACTED SOIL. SECURE BLANKET OVER COMPACTED SOIL WITH A ROW OF STAPLES/STAKES SPACED APPROXIMATELY 12" (30 CM) APART ACROSS THE WIDTH OF THE BLANKET.
- ROLL THE BLANKETS (A) DOWN OR (B) HORIZONTALLY ACROSS THE SLOPE. BLANKETS WILL UNROLL WITH APPROPRIATE SIDE AGAINST THE SOIL SURFACE. ALL BLANKETS MUST BE SECURELY FASTENED TO SOIL SURFACE BY PLACING STAPLES/STAKES IN APPROPRIATE LOCATIONS AS SHOWN IN THE STAPLE PATTERN GUIDE.
- THE EDGES OF PARALLEL BLANKETS MUST BE STAPLED WITH APPROXIMATELY 2"-5" (5 CM-12.5 CM) OVERLAP DEPENDING ON BLANKET TYPE.
- CONSECUTIVE BLANKETS SPliced DOWN THE SLOPE MUST BE PLACED END OVER END (SHINGLE STYLE) WITH AN APPROXIMATE 3" (7.5 CM) OVERLAP. STAPLE THROUGH OVERLAPPED AREA, APPROXIMATELY 12" (30 CM) APART ACROSS ENTIRE BLANKET WIDTH.

NOTE:

*IN LOOSE SOIL CONDITIONS, THE USE OF STAPLE OR STAKE LENGTHS GREATER THAN 6" (15 CM) MAY BE NECESSARY TO PROPERLY SECURE THE BLANKETS.

EROSION CONTROL BLANKET DETAIL
NO SCALE

PROJECT DATE:	DRAWN BY:	NO.	DATE	REVISION	BY:
	DRK				
	CMM				
	AZ				

PLOT DATE: 11/24/2025 10:37 AM, G:\0000096\00096041\CADD\Construction Documents\00096041 Details.dwg



ENGINEERING | ARCHITECTURE | SURVEYING
FUNDING | PLANNING | ENVIRONMENTAL
1230 South Boulevard, Baraboo WI 53913
(608) 356-2771 www.msa-ps.com
© MSA Professional Services, Inc.

SOUTH MAPLE STREET SEWER RELOCATION
VILLAGE OF NORTH FREEDOM
SAUK COUNTY, WISCONSIN

EROSION CONTROL AND GATE DETAILS

PROJECT NO.
00096041
SHEET
G5



SDD 15C12-a Traffic Control for Lane Closure With Flagging Operation

LEGEND

- SIGN ON PORTABLE OR PERMANENT SUPPORT
- TEMPORARY PORTABLE RUMBLE STRIP ARRAY
- DIRECTION OF TRAFFIC
- WORK AREA
- FLAGGER, EQUIPPED WITH STOP/SLOW PADDLE FASTENED ON SUPPORT STAFF

GENERAL NOTES

DETAILS OF TRAFFIC CONTROL DEVICES AND INSTALLATION NOT SHOWN ON THIS DRAWING SHALL CONFORM TO THE PERTINENT REQUIREMENTS OF THE STANDARD SPECIFICATIONS, THE SPECIAL PROVISIONS, AND THE MANUAL ON UNIFORM TRAFFIC CONTROL DEVICES.

ALL SIGNS ARE 48" X 48" UNLESS OTHERWISE NOTED.

"WO" SIGNS ARE THE SAME AS "W" SIGNS EXCEPT THE BACKGROUND IS ORANGE.

THE EXACT NUMBER, LOCATION AND SPACING OF ALL SIGNS, DEVICES, AND LOCATION OF ALL FLAGGERS SHALL BE ADJUSTED TO FIT FIELD CONDITIONS AS APPROVED BY THE ENGINEER.

THE FIRST ADVANCE WARNING SIGN SHOULD TYPICALLY BE LOCATED IN ADVANCE OF THE ANTICIPATED TRAFFIC BACKUP OR QUEUE.

WHEN A SIDE ROAD OR RAMP INTERSECTS THE FACILITY ON WHICH THE WORK IS BEING PERFORMED, ADDITIONAL TRAFFIC CONTROLS SHALL BE PROVIDED AS SPECIFIED IN THE PLANS AND/OR THE SPECIAL PROVISIONS OR AS APPROVED BY THE ENGINEER.

FLAGGING

FLAGGERS SHALL BE IN SIGHT OF EACH OTHER OR IN DIRECT COMMUNICATION AT ALL TIMES. THEY SHALL BE EQUIPPED WITH STOP/SLOW PADDLES FASTENED ON SUPPORT STAFFS. WHEN THE FLAGGING OPERATION IS NOT IN EFFECT REMOVE TEMPORARY PORTABLE RUMBLE STRIPS PRIOR TO COVERING OR REMOVING ALL ADVANCE SIGNING.

- FOR MOVING WORK OPERATIONS, POST ADDITIONAL W20-7A FLAGGER SIGNS AT APPROXIMATELY 3,500' INTERVALS IN THE MOVING WORK OPERATION OR AS APPROVED BY THE ENGINEER.
- SIGN NOT REQUIRED IF FLAGGING OPERATION OCCURS WITHIN A SIGNED ROAD WORK ZONE AREA.

WHEN THE DISTANCE BETWEEN FLAGGERS EXCEEDS 2 MILES, A PILOT CAR IS REQUIRED. WHEN CURVES REDUCE SIGHT DISTANCE BELOW 400', A PILOT CAR IS REQUIRED.

TEMPORARY PORTABLE RUMBLE STRIPS

UTILIZE TEMPORARY PORTABLE RUMBLE STRIPS ON ALL FLAGGING OPERATIONS.

- EACH TEMPORARY PORTABLE RUMBLE STRIP ARRAY CONSISTS OF THREE RUMBLE STRIPS PLACED TRANSVERSE ACROSS THE LANE AT THE LOCATIONS SHOWN. WITHIN EACH ARRAY, SPACING BETWEEN RUMBLE STRIPS SHALL BE 15 FEET ON CENTER

ONLY USE TEMPORARY PORTABLE RUMBLE STRIPS FROM THE APPROVED PRODUCTS LIST.

INSTALL TEMPORARY RUMBLE STRIPS PER MANUFACTURER'S RECOMMENDATIONS.

PLACE ADVANCE SIGNING PRIOR TO INSTALLING TEMPORARY RUMBLE STRIPS.

DO NOT INSTALL TEMPORARY PORTABLE RUMBLE STRIPS ON GRAVEL, MILLED SURFACES, OR ASPHALT THAT HAS BEEN PAVED LESS THAN 12 HOURS.

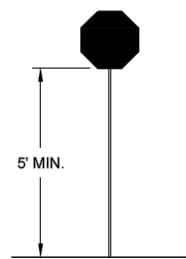

STOP/SLOW PADDLE ON SUPPORT STAFF

SIGN AND TEMPORARY RUMBLE STRIP ARRAY SPACING TABLE

SPEED LIMIT	SPACING "A"
25-30 MPH	200'
35-40 MPH	350'
45-55 MPH	500'



W03-4

USE OF W03-4 SIGN IS OPTIONAL. WHEN USED, THIS SIGN SHALL BE LOCATED BETWEEN THE W20-7A AND W20-4A SIGNS, USING SPACING "A".

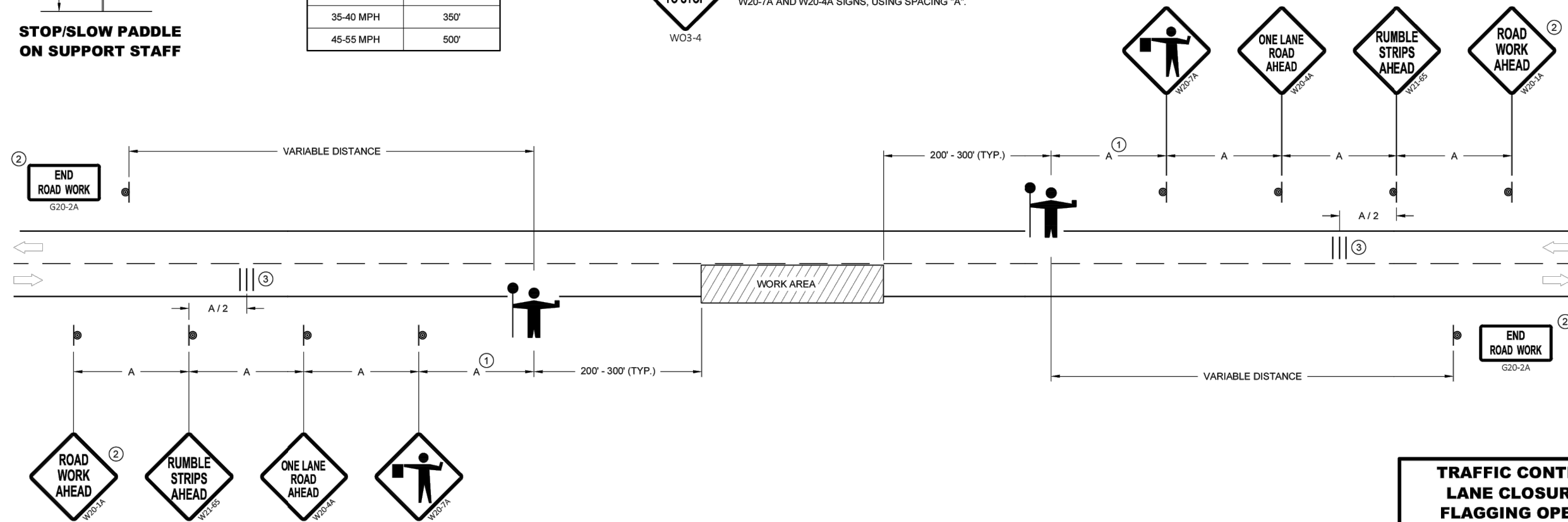

TRAFFIC CONTROL FOR LANE CLOSURE WITH FLAGGING OPERATION

STATE OF WISCONSIN
DEPARTMENT OF TRANSPORTATION

APPROVED
May 2022 /S/ Andrew Heidtke
DATE WORK ZONE ENGINEER

FHWA

6

6

SDD 15C12 - 09a

SDD 15C12 - 09a

PROJECT DATE:	DRAWN BY:	NO.	DATE	REVISION	BY:
	DRK				
	CMM				
	AZ				

MSA ENGINEERING | ARCHITECTURE | SURVEYING
FUNDING | PLANNING | ENVIRONMENTAL

www.msa-ps.com
© MSA Professional Services, Inc.

SOUTH MAPLE STREET SEWER RELOCATION
VILLAGE OF NORTH FREEDOM
SAUK COUNTY, WISCONSIN

TRAFFIC CONTROL DETAILS

PROJECT NO.
00096041
SHEET
G6

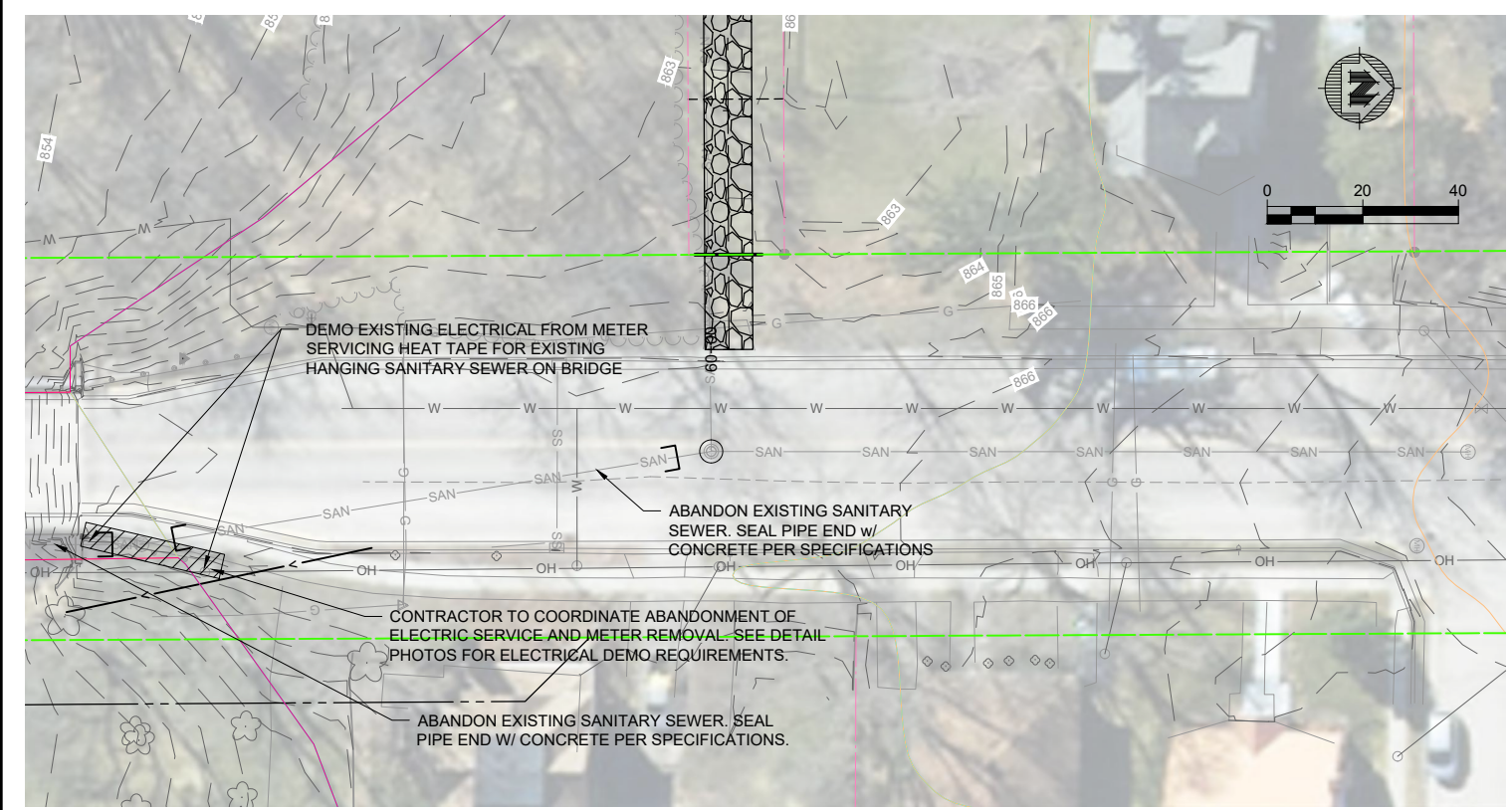
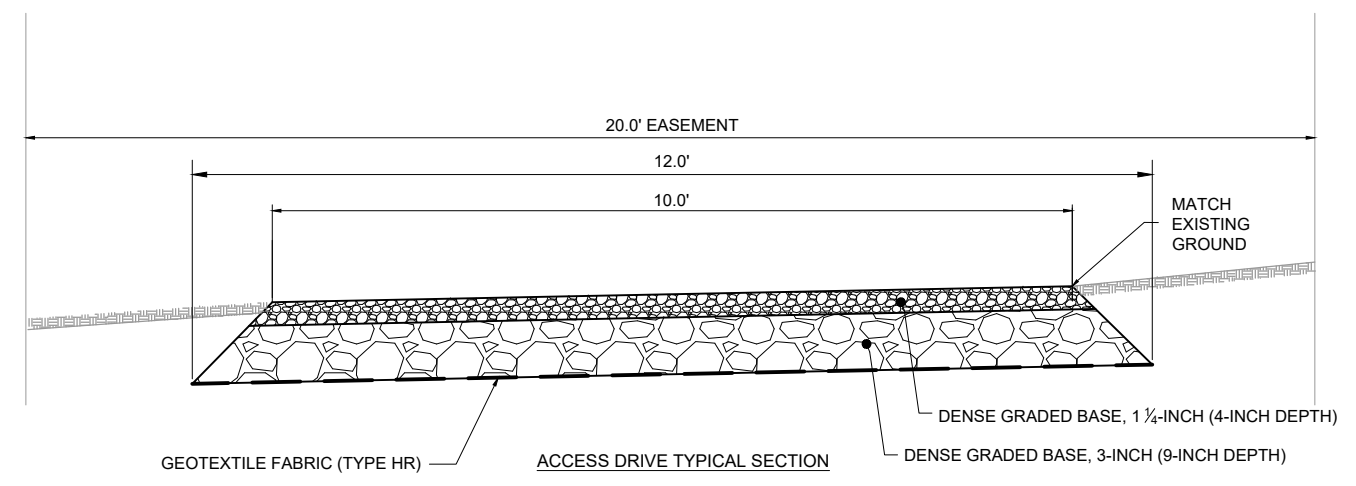
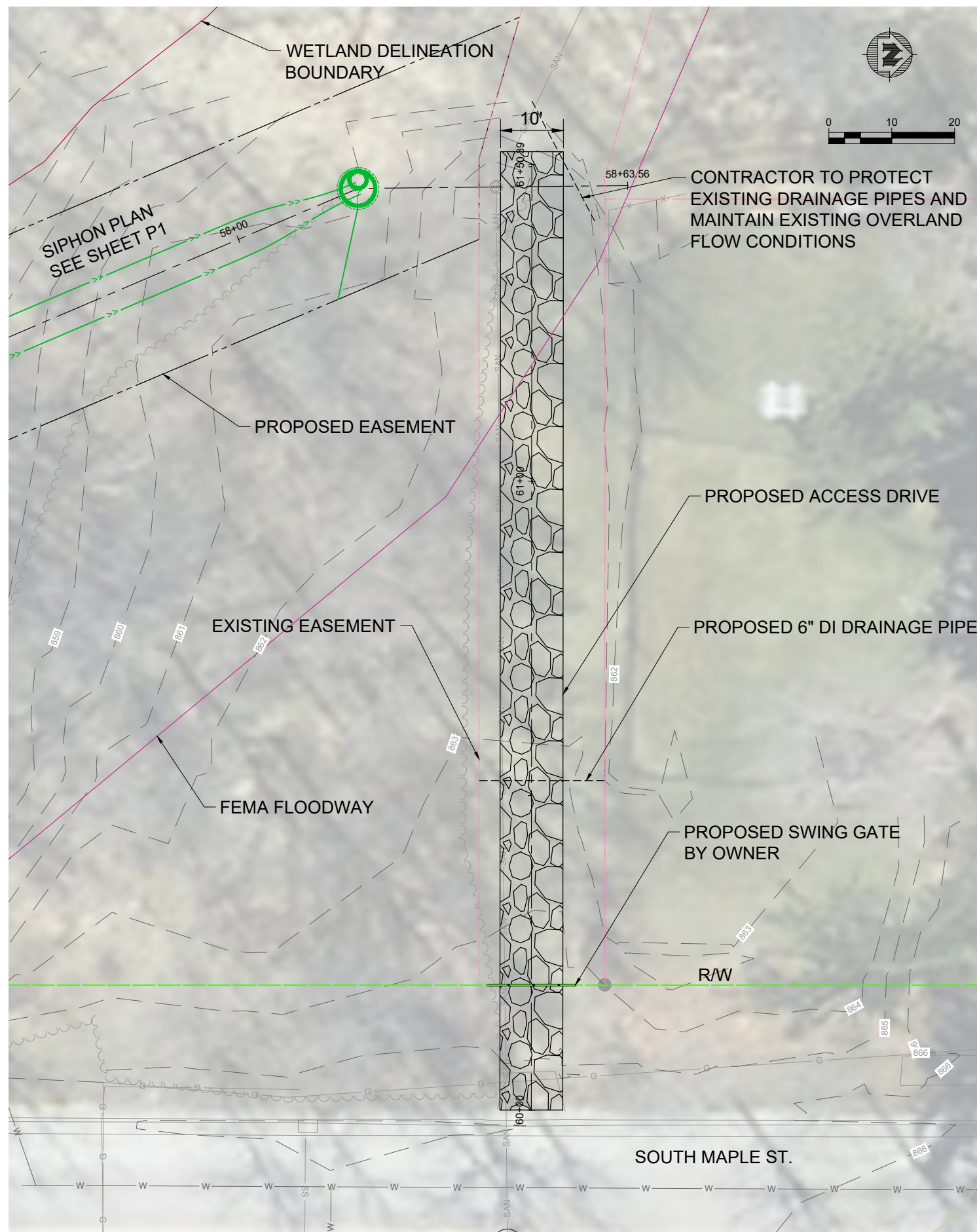

PROJECT DATE:	DRAWN BY:	NO.	DATE	REVISION	BY:
	DRK	-	-		-
	CMM	-	-		-
	AZ	-	-		-

PLOT DATE: 11/24/2025 10:37 AM, G:\00\00096\00096041\CADD\Construction Documents\00096041 Plan Sheets.dwg

MSA ENGINEERING | ARCHITECTURE | SURVEYING
 FUNDING | PLANNING | ENVIRONMENTAL
 1230 South Boulevard, Baraboo WI 53913
 (608) 356-2771 www.msa-ps.com
 © MSA Professional Services, Inc.

SOUTH MAPLE STREET SEWER RELOCATION
 VILLAGE OF NORTH FREEDOM
 SAUK COUNTY, WISCONSIN

PLAN - NORTH SIDE OF RIVER

PROJECT NO.
00096041
 SHEET
P2

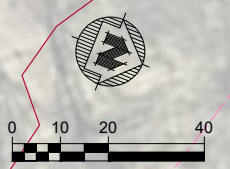

PROJECT DATE:	NO.	DATE	REVISION	BY
	1			
	2			
	3			



ENGINEERING | ARCHITECTURE | SURVEYING
 FUNDING | PLANNING | ENVIRONMENTAL
 1230 South Boulevard, Baraboo WI 53913
 (608) 356-2771 www.msa-ps.com
 © MSA Professional Services, Inc.

SOUTH MAPLE STREET SEWER RELOCATION
 VILLAGE OF NORTH FREEDOM
 SAUK COUNTY, WISCONSIN

PLAN - EROSION CONTROL

PROJECT NO.
00096041
 SHEET
P3