

CEMETERY BELLEVILLE MICHIGAN

HIQHWAY

EXIT DRIVE SEE WP

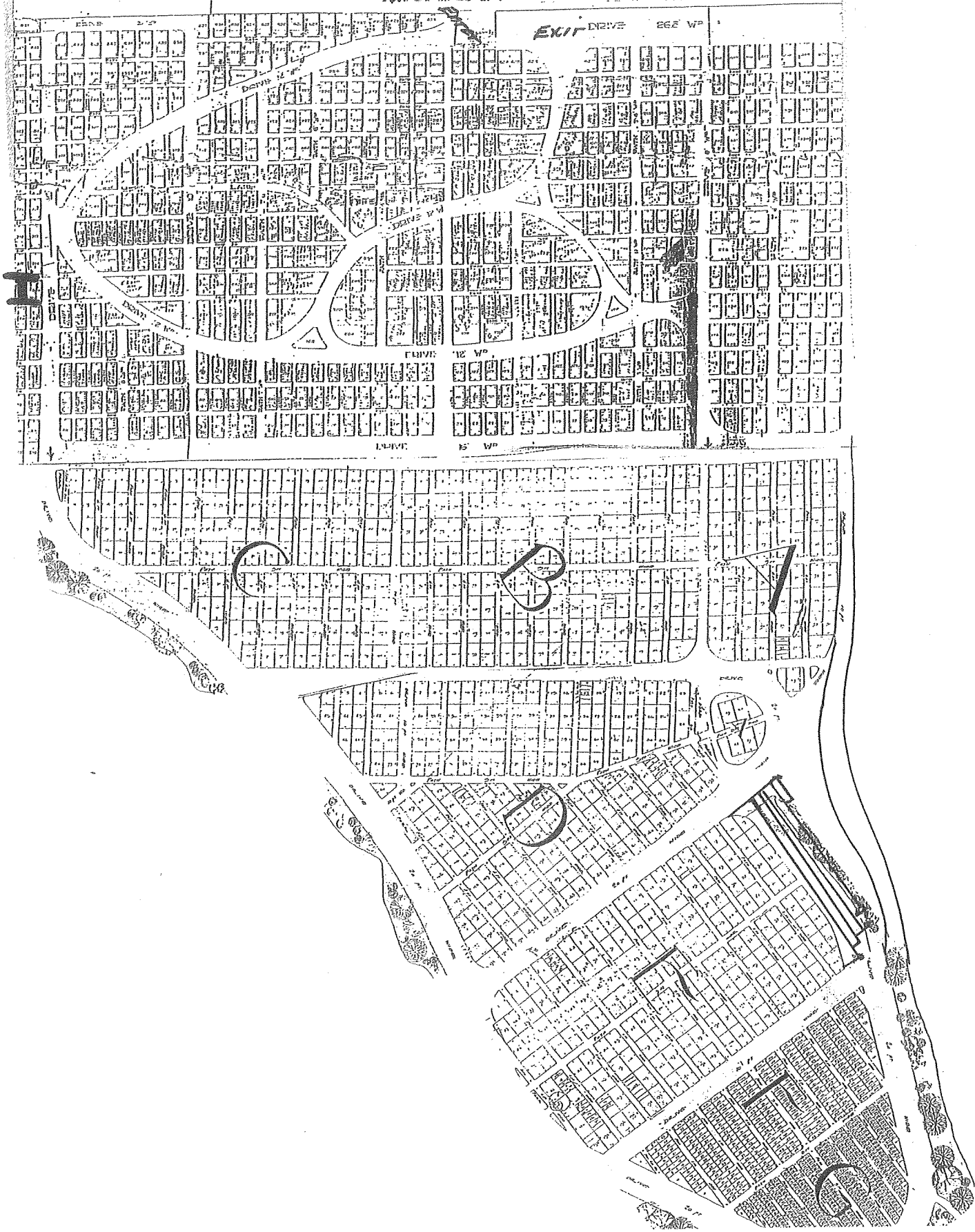

Section Map

46785 DENTON RD

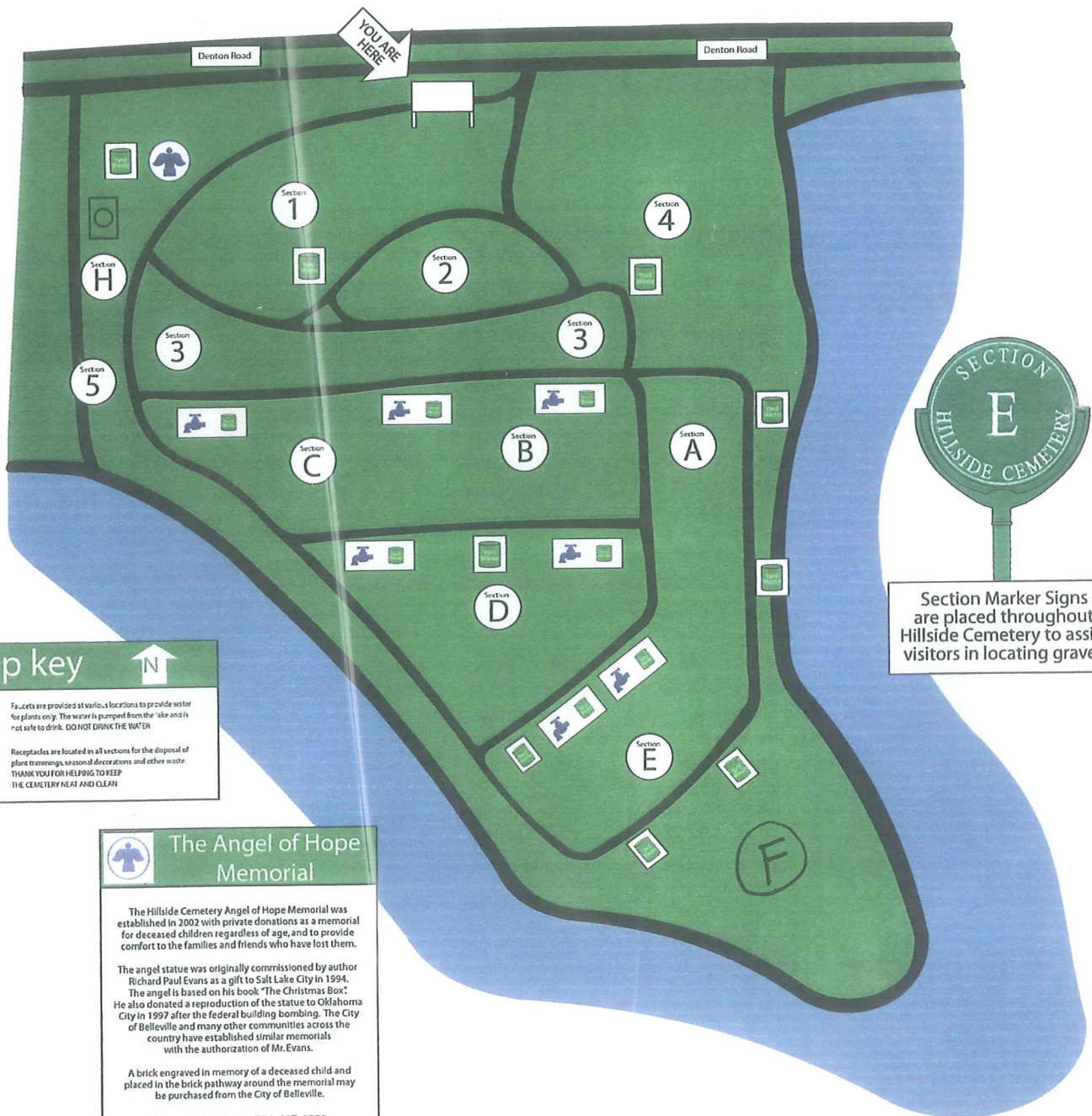

Section Marker Signs are placed throughout Hillside Cemetery to assist visitors in locating graves

Map key

- Faucets are provided at various locations to provide water for plants only. The water is pumped from the 'lake' and is not safe to drink. **DO NOT DRINK THE WATER!**
- Receptacles are located in all sections for the disposal of plant trimmings, seasonal decorations and other waste. **THANK YOU FOR HELPING TO KEEP THE CEMETERY NEAT AND CLEAN!**

The Angel of Hope Memorial

The Hillside Cemetery Angel of Hope Memorial was established in 2002 with private donations as a memorial for deceased children regardless of age, and to provide comfort to the families and friends who have lost them.

The angel statue was originally commissioned by author Richard Paul Evans as a gift to Salt Lake City in 1994. The angel is based on his book "The Christmas Box". He also donated a reproduction of the statue to Oklahoma City in 1997 after the federal building bombing. The City of Belleville and many other communities across the country have established similar memorials with the authorization of Mr. Evans.

A brick engraved in memory of a deceased child and placed in the brick pathway around the memorial may be purchased from the City of Belleville.

Contact the City at 734-697-9323 for an order form or additional information.