

A Win for Memorial Park!

Barneveld Secures Federal Land and Water Conservation Fund (LWCF) Grant of \$636,190.25

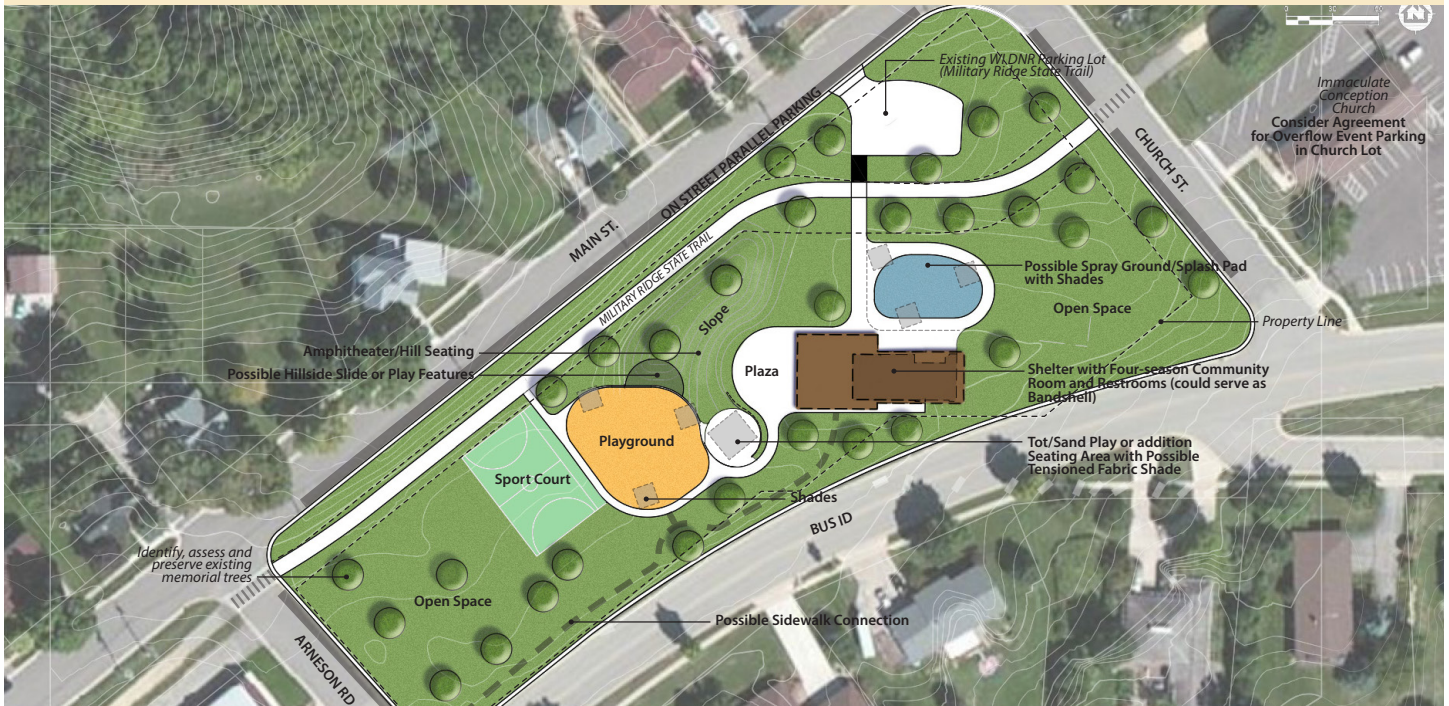

Memorial Park was created as a tribute to the lives lost during the 1984 F5 tornado and serves as visible appreciation for the kindness and assistance that came from near and far. With minimal and outdated play equipment and amenities, there's opportunity ahead to transform this Barneveld asset into a community centerpiece!

The awarded grant dollars will provide key funds to redevelop this local park with

- an inclusive playground
- multi-use sport court
- Tot Lot play area
- plaza and shelter with 4-season room
- a splash pad
- an open lawn

But there is still more to do – and we need your help!

The Village is raising money to create this destination park.

Interested in learning how you can get involved or want to make a donation?

Contact Michelle Walker
Barneveld-Brigham Municipal Building
403 E. County Hwy ID
Barneveld, Wisconsin 54507
Telephone: (608) 924-6861
Email: barneveld@mhtc.net, barneveld2@mhtc.net

