

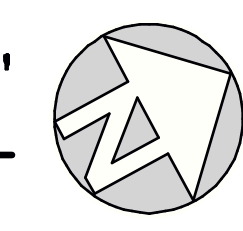

PRELIMINARY
NOT FOR CONSTRUCTION

Floor Plan

1/4"=1'-0"



LANDSCAPE NOTES:

- CONTRACTOR SHALL REPORT TO DESIGN PROFESSIONAL ALL CONDITIONS WHICH IMPAIR AND/OR PREVENT THE PROPER EXECUTION OF THIS WORK, PRIOR TO BEGINNING WORK.
- NO MATERIAL SUBSTITUTIONS SHALL BE MADE WITHOUT THE DESIGN PROFESSIONAL'S PRIOR WRITTEN APPROVAL. ALTERNATE MATERIALS OF SIMILAR SIZE AND CHARACTER MAY BE CONSIDERED IF SPECIFIED PLANT MATERIALS CAN NOT BE OBTAINED.
- COORDINATE ALL WORK WITH ALL OTHER SITE RELATED DEVELOPMENT DRAWINGS.
- COORDINATE WORK SCHEDULE AND OBSERVATIONS WITH DESIGN PROFESSIONAL PRIOR TO CONSTRUCTION START-UP.
- ALL PLANT MATERIAL SHALL BE INSTALLED AS PER DETAILS.
- ALL PLANT MATERIAL SHALL CONFORM TO THE AMERICAN NURSERYMAN STANDARDS FOR TYPE AND SIZE SHOWN. PLANTS WILL BE REJECTED IF NOT IN A SOUND AND HEALTHY CONDITION.
- IN THE EVENT OF A PLANT COUNT DISCREPANCY, PLANT SYMBOLS SHALL OVERRIDE SCHEDULE QUANTITIES AND CALL OUT SYMBOL NUMBERS.
- ALL PLANTING BEDS SHALL BE COVERED WITH A MINIMUM OF 3" DEPTH OF LARGE (2" MINUS) BARK MULCH. SUBMIT SAMPLE FOR APPROVAL.
- ALL PLANT MATERIAL SHALL BE GUARANTEED FOR A PERIOD OF ONE YEAR BEGINNING AT THE DATE OF ACCEPTANCE BY THE OWNER. REPLACE ALL PLANT MATERIAL FOUND DEAD OR NOT IN A HEALTHY CONDITION IMMEDIATELY WITH THE SAME SIZE AND SPECIES AT NO COST TO THE OWNER.
- FINISH GRADES SHALL PROVIDE A SMOOTH TRANSITION WITH ADJACENT SURFACES AND ENSURE POSITIVE DRAINAGE IN ACCORDANCE WITH THE SITE GRADING PLAN.
- AMEND EXISTING APPROVED TOPSOIL AT A RATIO OF THREE CUBIC YARDS OF APPROVED COMPOST PER 1000 SQUARE FEET. ROTO-TILL ORGANIC MATTER A MINIMUM OF 6 INCHES INTO TOPSOIL.
- FERTILIZE ALL TREES AND SHRUBS WITH 'AGRIFORM' PLANTING TABLETS, QUANTITY PER MANUFACTURER'S RECOMMENDATIONS.
- ALL PLANTING BEDS SHALL HAVE A MINIMUM 18" DEPTH OF TOPSOIL. LAWN AREAS SHALL HAVE A MINIMUM 12" DEPTH OF TOPSOIL. SPREAD, COMPACT, AND FINE GRADE TOPSOIL TO A SMOOTH AND UNIFORM GRADE 3" BELOW ADJACENT SURFACES OF PLANTER BED AREAS, 1-1/2" BELOW ADJACENT SURFACES OF TURF SEED AREAS, AND 1" BELOW ADJACENT SURFACES OF TURF SEED AREAS.
- REUSE EXISTING TOPSOIL STOCKPILED ON THE SITE. SUPPLEMENT WITH IMPORTED TOPSOIL WHEN QUANTITIES ARE INSUFFICIENT. VERIFY SUITABILITY AND CONDITION OF TOPSOIL AS A GROWING MEDIUM. PERFORM SOIL TEST/ ANALYSIS AND PROVIDE ADDITIONAL AMENDMENT AS DETERMINED BY SOIL TESTS. TOPSOIL SHALL BE A LOOSE, FRIABLE, SANDY LOAM, CLEAN AND FREE OF TOXIC MATERIALS, NOXIOUS WEEDS, WEED SEEDS, ROCKS, GRASS OR OTHER FOREIGN MATERIAL AND A HAVE A PH OF 5.5 TO 7.0. IF ON-SITE TOPSOIL DOES NOT MEET THESE MINIMUM STANDARDS, CONTRACTOR IS RESPONSIBLE TO EITHER:
A) PROVIDE APPROVED IMPORTED TOPSOIL, OR
B) IMPROVE ON-SITE TOPSOIL WITH METHODS APPROVED BY THE DESIGN PROFESSIONAL.
- IF IMPORTED TOPSOIL FROM OFF-SITE SOURCES IS REQUIRED, ENSURE IT IS FERTILE, FRIABLE, NATURAL LOAM, SURFACE SOIL, REASONABLY FREE OF SUBSOIL, CLAY LUMPS, BRUSH, LITTER, AND FREE OF ROOTS, STUMPS, STONES LARGER THAN 2 INCHES IN ANY DIMENSION, AND OTHER EXTRANEOUS OR TOXIC MATTER HARMFUL TO PLANT GROWTH.
A) OBTAIN TOPSOIL FROM LOCAL SOURCES OR FROM AREAS HAVING SIMILAR SOIL CHARACTERISTICS TO THOSE FOUND ON THE PROJECT SITE. OBTAIN TOPSOIL ONLY FROM NATURALLY, WELL-DRAINED SITES WHERE TOPSOIL OCCURS AT A DEPTH OF NOT LESS THAN 4 INCHES.
B) REPRESENTATIVE SAMPLES SHALL BE TESTED FOR ACIDITY, FERTILITY, TOXICITY, AND GENERAL TEXTURE BY A RECOGNIZED COMMERCIAL OR GOVERNMENT AGENCY AND COPIES OF THE TESTING AGENCY'S FINDINGS AND RECOMMENDATIONS SHALL BE FURNISHED TO THE OWNER'S REPRESENTATIVE BY THE CONTRACTOR. NO TOPSOIL SHALL BE DELIVERED IN A FROZEN OR FROZEN CONDITION. ACIDITY/ALKALINITY RANGE - PH 5.5 TO 7.0.
- IMMEDIATELY CLEAN UP ANY TOPSOIL OR OTHER DEBRIS ON THE SITE CREATED FROM LANDSCAPE OPERATIONS AND DISPOSE OF PROPERLY OFF SITE.
- TREES SHALL NOT BE PLANTED WITHIN THE 10'-0" CLEAR ZONE OF ALL A.C.H.D. STORM DRAIN PIPE, STRUCTURES, OR FACILITIES. TREES SHALL NOT BE PLANTED WITHIN 5'-0" OF AN A.C.H.D. SIDEWALK.
- ANY PERMANENT TREES OR PLANTS THAT WILL EXTEND ROOTS DEEPER THAN 18" SHALL BE PROHIBITED OVER ACHD UNDERGROUND SEEPAGE BEDS, INFILTRATION FACILITIES OR PIPING SYSTEMS.
- SEEPAGE BEDS AND OTHER STORM DRAINAGE FACILITIES MUST BE PROTECTED FROM ANY AND ALL CONTAMINATION DURING THE CONSTRUCTION AND INSTALLATION OF THE LANDSCAPE IRRIGATION SYSTEM.
- IN THE EVENT OF A DISCREPANCY, NOTIFY THE DESIGN PROFESSIONAL IMMEDIATELY.

LANDSCAPE AREA

PREPARATION NOTES:

- LIMIT TURF SUBGRADE PREPARATION TO AREAS TO BE PLANTED. NEWLY GRADED SUBGRADES: LOOSEN SUBGRADE TO A MINIMUM DEPTH OF 4 INCHES. REMOVE STONES LARGER THAN 1 INCH IN ANY DIMENSION AND STICKS, ROOTS, RUBBISH, AND OTHER EXTRANEOUS MATTER AND LEGALLY DISPOSE OF THEM OFF OWNER'S PROPERTY.
A. SPREAD PLANTING SOIL TO A DEPTH OF 12 INCHES IN TURF AREAS AND 18 INCHES AT SHRUB BED AREAS BUT NOT LESS THAN REQUIRED TO MEET FINISH GRADES AFTER LIGHT ROLLING AND NATURAL SETTLEMENT. DO NOT SPREAD IF PLANTING SOIL OR SUBGRADE IS FROZEN, MUDDY, OR EXCESSIVELY WET.
- SPREAD PLANTING SOIL OVER LOOSENED SUBGRADE.
- REDUCE ELEVATION OF PLANTING SOIL TO ALLOW FOR SOIL THICKNESS OF SOD OR SEED.
- UNCHANGED SUBGRADES: IF TURF IS TO BE PLANTED IN AREAS UNALTERED OR UNDISTURBED BY EXCAVATING, GRADING, OR SURFACE-SOIL STRIPPING OPERATIONS, PREPARE SURFACE SOIL AS FOLLOWS:
A. REMOVE EXISTING GRASS, VEGETATION, AND TURF. DO NOT MIX INTO SURFACE SOIL.
B. LOOSEN SURFACE SOIL TO A DEPTH OF AT LEAST 6 INCHES. PROVIDE WEED ABATEMENT PROCEDURE. APPLY SOIL AMENDMENTS AND FERTILIZERS ACCORDING TO PLANTING SOIL MIX PROPORTIONS AND MIX THOROUGHLY INTO TOP 6 INCHES OF SOIL. TILL SOIL TO A HOMOGENEOUS MIXTURE OF FINE TEXTURE.
C. APPLY SOIL AMENDMENTS DIRECTLY TO SURFACE SOIL BEFORE LOOSENING.
D. REMOVE STONES LARGER THAN 1 INCH IN ANY DIMENSION AND STICKS, ROOTS, TRASH, AND OTHER EXTRANEOUS MATTER.
E. LEGALLY DISPOSE OF WASTE MATERIAL, INCLUDING GRASS, VEGETATION, AND TURF, OFF OWNER'S PROPERTY.
- FINISH GRADING: GRADE PLANTING AREAS TO A SMOOTH, UNIFORM SURFACE PLANE WITH LOOSE, UNIFORM FINE TEXTURE. GRADE TO WITHIN PLUS OR MINUS 1/2 INCH OF FINISH ELEVATION. ROLL AND RAKE, REMOVE RIDGES, AND FILL DEPRESSIONS TO MEET FINISH GRADES. LIMIT FINISH GRADING TO AREAS THAT CAN BE PLANTED IN THE IMMEDIATE FUTURE. MOISTEN PREPARED AREA BEFORE PLANTING IF SOIL IS DRY. WATER THOROUGHLY AND ALLOW SURFACE TO DRY BEFORE PLANTING. DO NOT CREATE MUDDY SOIL.
- BEFORE PLANTING, OBTAIN DESIGN PROFESSIONAL'S ACCEPTANCE OF FINISH GRADING; RESTORE PLANTING AREAS IF ERODED OR OTHERWISE DISTURBED AFTER FINISH GRADING.
- DO NOT SOIL IMMEDIATELY FOLLOWING RAIN, OR WHEN GROUND IS TOO DRY. TEMPERATURE SHALL BE BETWEEN 55 F AND 95 F FOR A 24 HOUR PERIOD. WIND SHALL BE LESS THAN 5 MPH.

WEED ABATEMENT NOTES:

- ALL AREAS TO BE PLANTED OR HYDROSEEDING SHALL HAVE WEED ABATEMENT OPERATIONS PERFORMED ON THEM PRIOR TO PLANTING OR HYDROSEEDING.
- CONTRACTOR SHALL SPRAY ALL EXPOSED WEEDS WITH GRUND-UPA (CONTACT HERBICIDE) OR APPROVED EQUAL.
- DO NOT WATER FOR AT LEAST SEVEN (7) DAYS. REMOVE EXPOSED WEEDS FROM THE SITE.
- CONTRACTOR SHALL OPERATE THE AUTOMATIC IRRIGATION SYSTEM FOR A PERIOD OF FOURTEEN (14) DAYS. AT CONCLUSION OF THIS WATERING PERIOD, DISCONTINUE WATERING FOR THREE TO FIVE (3-5) DAYS.
- APPLY SECOND APPLICATION OF GRUND-UPA TO ALL EXPOSED WEEDS. APPLY IN STRICT CONFORMANCE WITH MANUFACTURER'S SPECIFICATIONS AND INSTRUCTIONS. DO NOT WATER FOR AT LEAST SEVEN (7) DAYS. REMOVE WEEDS FROM THE SITE.
- IF ANY EVIDENCE OF WEED GERMINATION EXISTS AFTER TWO (2) APPLICATIONS, PLANTING SHALL BE DIRECTED TO PERFORM A THIRD APPLICATION.
- AT THE TIME OF PLANTING AND HYDROSEEDING, ALL PLANTING AREAS SHALL BE WEED FREE.

TURF AREA PREPARATION

NOTES:

- LIMIT TURF SUBGRADE PREPARATION TO AREAS TO BE PLANTED.
- NEWLY GRADED SUBGRADES: LOOSEN SUBGRADE TO A MINIMUM DEPTH OF 4 INCHES. REMOVE STONES LARGER THAN 1 INCH IN ANY DIMENSION AND STICKS, ROOTS, RUBBISH, AND OTHER EXTRANEOUS MATTER AND LEGALLY DISPOSE OF THEM OFF OWNER'S PROPERTY.
- SPREAD PLANTING SOIL OVER LOOSENED SUBGRADE.
- REDUCE ELEVATION OF PLANTING SOIL TO ALLOW FOR SOIL THICKNESS OF SOD.
- UNCHANGED SUBGRADES: IF TURF IS TO BE PLANTED IN AREAS UNALTERED OR UNDISTURBED BY EXCAVATING, GRADING, OR SURFACE-SOIL STRIPPING OPERATIONS, PREPARE SURFACE SOIL AS FOLLOWS:
A. REMOVE EXISTING GRASS, VEGETATION, AND TURF. DO NOT MIX INTO SURFACE SOIL.
B. LOOSEN SURFACE SOIL TO A DEPTH OF AT LEAST 6 INCHES. APPLY SOIL AMENDMENTS AND FERTILIZERS ACCORDING TO PLANTING SOIL MIX PROPORTIONS AND MIX THOROUGHLY INTO TOP 6 INCHES OF SOIL. TILL SOIL TO A HOMOGENEOUS MIXTURE OF FINE TEXTURE.
C. APPLY SOIL AMENDMENTS DIRECTLY TO SURFACE SOIL BEFORE LOOSENING.
D. REMOVE STONES LARGER THAN 1 INCH IN ANY DIMENSION AND STICKS, ROOTS, TRASH, AND OTHER EXTRANEOUS MATTER.
E. LEGALLY DISPOSE OF WASTE MATERIAL, INCLUDING GRASS, VEGETATION, AND TURF, OFF OWNER'S PROPERTY.
- FINISH GRADING: GRADE PLANTING AREAS TO A SMOOTH, UNIFORM SURFACE PLANE WITH LOOSE, UNIFORM FINE TEXTURE. GRADE TO WITHIN PLUS OR MINUS 1/2 INCH OF FINISH ELEVATION. ROLL AND RAKE, REMOVE RIDGES, AND FILL DEPRESSIONS TO MEET FINISH GRADES. LIMIT FINISH GRADING TO AREAS THAT CAN BE PLANTED IN THE IMMEDIATE FUTURE. MOISTEN PREPARED AREA BEFORE PLANTING IF SOIL IS DRY. WATER THOROUGHLY AND ALLOW SURFACE TO DRY BEFORE PLANTING. DO NOT CREATE MUDDY SOIL.
- BEFORE PLANTING, OBTAIN DESIGN PROFESSIONAL'S ACCEPTANCE OF FINISH GRADING; RESTORE PLANTING AREAS IF ERODED OR OTHERWISE DISTURBED AFTER FINISH GRADING.

TOPSOIL NOTES

- TOPSOIL REQUIREMENTS: ASTM D 5260, PH RANGE OF 5.5 TO 7.0, FOUR PERCENT ORGANIC MATERIAL MINIMUM, FREE OF STONES 1/2 INCH OR LARGER IN ANY DIMENSION, AND OTHER EXTRANEOUS MATERIALS HARMFUL TO PLANT GROWTH.
- TOPSOIL SOURCE: STRIP EXISTING TOPSOIL FROM ALL AREAS OF THE SITE TO BE DISTURBED. TOPSOIL SHALL BE FERTILE, FRIABLE, NATURAL LOAM, SURFACE SOIL, REASONABLY FREE OF SUBSOIL, CLAY LUMPS, BRUSH, WEEDS AND OTHER LITTER, AND FREE OF ROOTS, STUMPS, STONES LARGER THAN 2 INCHES IN ANY DIMENSION, AND OTHER EXTRANEOUS OR TOXIC MATTER HARMFUL TO PLANT GROWTH. TOPSOIL SHALL BE SCREENED TO ACHIEVE THIS REQUIREMENT.
- REPRESENTATIVE SAMPLES SHALL BE TESTED FOR ACIDITY, FERTILITY AND GENERAL TEXTURE BY A RECOGNIZED COMMERCIAL OR GOVERNMENT AGENCY AND COPIES OF THE TESTING AGENCY'S FINDINGS AND RECOMMENDATIONS SHALL BE FURNISHED TO THE ARCHITECT'S REPRESENTATIVE BY THE CONTRACTOR. ALL TOPSOIL SHALL BE AMENDED TO ACHIEVE SPECIFIED PH AND ORGANIC REQUIREMENTS. RE-TEST TOPSOIL PRIOR TO FINAL COMPLETION TO ENSURE REQUIREMENTS HAVE BEEN MET. NO TOPSOIL SHALL BE PLACED WHILE IN A FROZEN OR MUDDY CONDITION.
- PLACE TOPSOIL IN AREAS WHERE REQUIRED TO OBTAIN THICKNESS AS SCHEDULED. PLACE TOPSOIL DURING DRY WEATHER. PROVIDE ADDITIONAL IMPORTED TOPSOIL REQUIRED TO BRING SURFACE TO PROPOSED FINISH GRADE, AS REQUIRED.
- COMPACTED TOPSOIL THICKNESS AT THE FOLLOWING AREAS:
A. LAWN AREAS: 12 INCHES MINIMUM OR AS NECESSARY TO ACHIEVE EVEN GRADES WITH SURROUNDING LAWN AREAS.
B. PLANTER BEDS: 18 INCHES MINIMUM
- FINE GRADE TOPSOIL TO SMOOTH, EVEN SURFACE WITH LOOSE, UNIFORM FINE TEXTURE. REMOVE RIDGES AND FILL DEPRESSIONS, AS REQUIRED TO MEET FINISH GRADES. FINISH GRADE OF TOPSOIL SHALL BE 2" BELOW FINISH GRADE OF PAVEMENTS AREAS FOR SOD AND 1" FOR SEED.
- TOPSOIL STOCKPILE LOCATIONS TO BE COVERED COORDINATE WITH EROSION AND SEDIMENT CONTROL PLAN.
- ALL GRAVEL, SUBBASE, AND OTHER IMPORTED FILL MATERIALS OTHER THAN TOPSOIL SHALL ONLY BE STOCKPILED IN PROPOSED IMPERVIOUS AREAS. NO GRAVEL OR ROCK MATERIALS SHALL BE STOCKPILED OR TEMPORARILY PLACED IN PROPOSED LANDSCAPE AREAS TO PREVENT LANDSCAPE AREAS FROM BEING CONTAMINATED WITH ROCK MATERIALS. CONTRACTOR SHALL SUBMIT A DETAILED STOCKPILE PLAN TO DESIGN PROFESSIONAL AND OWNER FOR APPROVAL PRIOR TO ANY EARTHWORK OPERATIONS.

LANDSCAPE

REQUIREMENTS

PARKING LOT		
Requirements: 1 TREE / 5 PARKING SPACES	REQUIRED 5 TREES	PROVIDED 5 TREES
Requirements: 1 TREE / 15 LF OR AS APPROPRIATE TO SPECIES	REQUIRED 1 TREES OR AS APPROPRIATE TO SPECIES	PROVIDED 4 TREES (1 TREE/25 LF)
W CARLTON BAY DR - 114 LF		
Requirements: 1 CLASS II OR III TREE / STREET FRONTAGE PLUS ONE CLASS I TREE/ 50 LF	REQUIRED 3 TREES	PROVIDED 3 TREES
W STATE ST - 114 LF		
Requirements: 1 CLASS II OR III TREE / STREET FRONTAGE PLUS ONE CLASS I TREE/ 50 LF	REQUIRED 3 TREES	PROVIDED 3 TREES
GENERAL		
Requirements: MIN. 5% OF SITE AREA SHALL BE LANDSCAPED	REQUIRED 5% OR 1/15 SF	PROVIDED 14% OR 3,444 SF
Requirements: MIN. 1 TREE/1000 SF OF LANDSCAPED AREA	REQUIRED 5 TREES	PROVIDED 6 TREES
MIN. 1 SHRUB/ 150 SF OF LANDSCAPED AREA	REQUIRED 31 SHRUBS	PROVIDED 48 SHRUBS

LANDSCAPE LEGEND

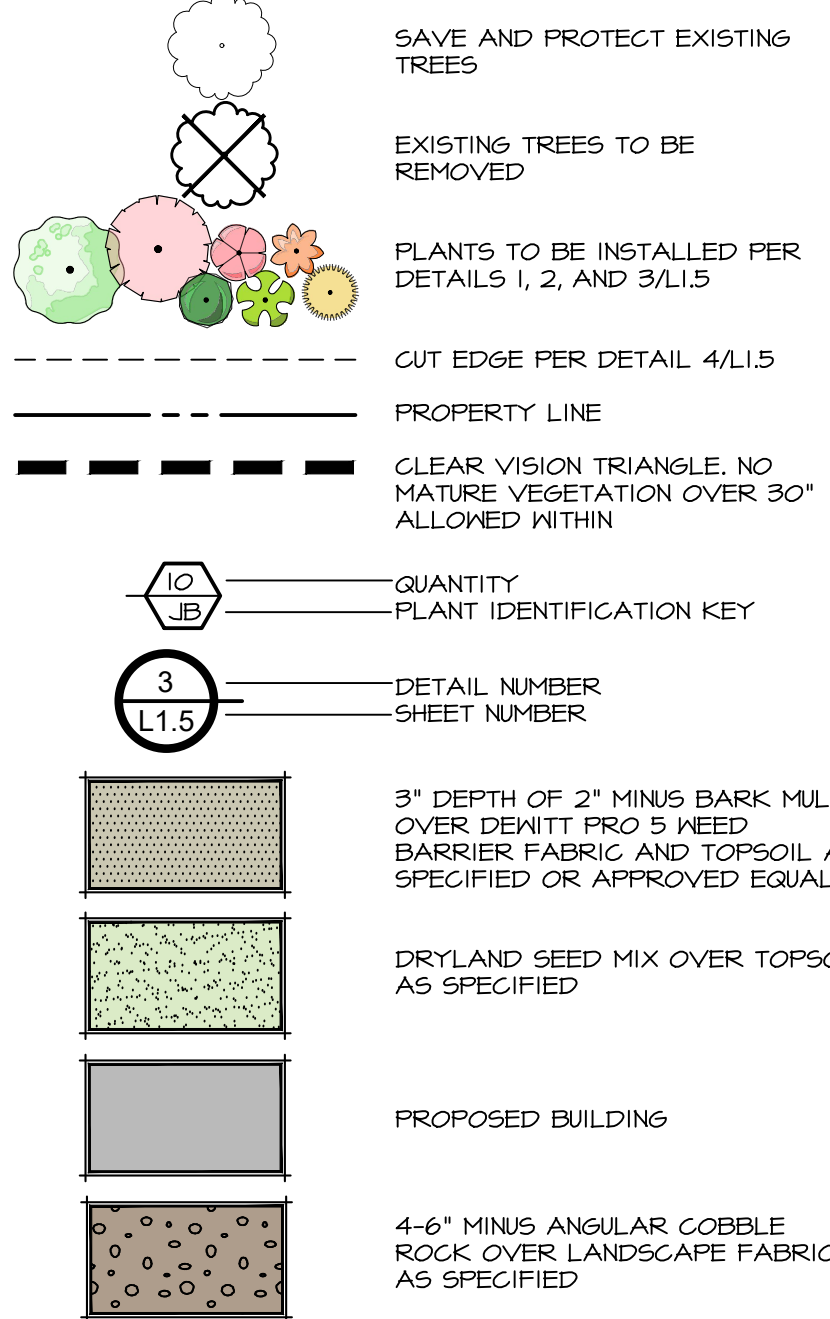

CALLOUT LEGEND

- CLEAR VISION TRIANGLE, NO MATURE VEGETATION OVER 30' ALLOWED WITHIN
- STORM WATER RETENTION AREA. SEE CIVIL PLANS FOR ADDITIONAL INFORMATION AND REQUIREMENTS
- SITE SIGN. SEE CIVIL PLANS FOR ADDITIONAL INFORMATION AND REQUIREMENTS
- TRASH ENCLOSURE. SEE CIVIL PLANS FOR ADDITIONAL INFORMATION AND REQUIREMENTS
- EXISTING TREE TO BE REMOVED

PLANT SCHEDULE

SYMBOL	CODE	QTY	BOTANICAL NAME	COMMON NAME	SIZE	REMARKS
DECIDUOUS SHADE TREES						
	AG	2	Acer griseum	Paperbark Maple	2" Cal. B&B	30' x 20' W CLASS II
	AT	1	Acer truncatum x platanoides 'Warrenred'	Pacific Sunset Maple	2" Cal. B&B	30' x 25' W CLASS II
	CC	3	Corylus colurna	Turkish Filbert	2" Cal. B&B	50' x 30' W CLASS II
	QU	4	Quercus macrocarpa 'JFS-KNB'	Urban Pinnacle Oak	2" Cal. B&B	55' x 25' W CLASS II
SHRUBS, PERENNIALS, & ORNAMENTAL GRASSES						
	BG	24	Bouteloua gracilis 'Blonde Ambition'	Blonde Ambition Blue Grama	1 gal.	3' x 3' W
	CF	14	Cornus stolonifera 'Farrow'	Arctic Fire Red Twig Dogwood	2 gal.	4' x 4' W
	HP	14	Hemerocallis x 'Primal Scream'	Primal Scream Daylily	1 gal.	2' x 2' W
	MA	14	Mahonia aquifolium 'Compacta'	Compact Oregon Grape	2 gal.	3' x 4' W
	NF	15	Nepeta x faassenii 'Walker's Low'	Walker's Low Catmint	2 gal.	2' x 3' W
	PO	20	Physocarpus opulifolius 'Jetam'	First Editions Amber Jubilee Ninebark	2 gal.	5' x 4' W
	PF	16	Potentilla fruticosa 'Red Ace'	Red Ace Bush Cinquefoil	2 gal.	3' x 4' W
	YF	10	Yucca filamentosa 'Color Guard'	Color Guard Adam's Needle	2 gal.	4' x 4' W

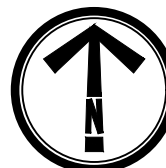

LANDSCAPE PLAN

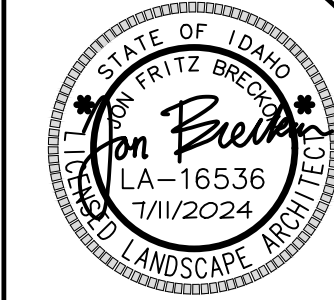
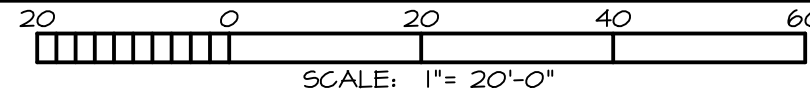

Civil Engineering
Landscape Architecture
Site Planning & Surveying
Graphic Communication
Construction Management
Land Planning

www.breckonlandscape.com
Fax: 208-378-8528
Phone: 208-378-9183
888 North Glendale Street
Garden City, Idaho 83744



Copyright © 2024
All rights reserved. Reproduction or use in any form or by any means without written permission of Breckon Land Design, Inc. is unlawful and subject to criminal prosecution.

FOOTHILLS FUNCTIONAL MEDICINE
10178 W CARLTON BAY DR
GARDEN CITY, IDAHO
LANDSCAPE PLAN



REVISIONS

No.	Date	Description

PROJECT NO.:
24052
DRAWN BY:
EB
CHECKED BY:
JB
DATE:
7/11/2024

SHEET NUMBER
L1.1

1. SYSTEM DESIGN BASED ON THE ASSUMPTION OF THE AVAILABILITY OF 19.6 G.P.M. WITH TO P.S.I. AT THE SOURCE AND 45 P.S.I. AT THE HEADS.
2. ALL LATERAL LINES THAT ARE NOT LABELED SHALL BE 3/4" DIAMETER.
3. CONTRACTOR TO VERIFY LATERAL LINES UTILITIES PRIOR TO INITIATION OF ANY EXCAVATION OR CONSTRUCTION OPERATIONS TO AVOID DAMAGE TO EXISTING UTILITIES SHALL BE CONTRACTOR'S RESPONSIBILITY.
4. COORDINATE ALL IRRIGATION INSTALLATION OPERATIONS WITH CIVIL, MECHANICAL, ELECTRICAL, AND PLUMBING CONTRACTORS.
5. CONTRACTOR SHALL COORDINATE INSTALLATION OF IRRIGATION CONDUIT AND SLEEVES UNDER HARD SURFACES WITH RESPECTIVE CONTRACTORS.
6. ALL SLEEVES SHALL BE INSTALLED AS PART OF IRRIGATION CONTRACT.
7. ALL SLEEVES SHALL BE EXTENDED A MINIMUM OF 18" BEYOND THE IRRIGATION PLAN FIELD VERIFY LOCATION. ALL ENDS OF SLEEVES SHALL BE TAPED OR CAPPED AND MARKED WITH A 2" X 4" PAINTED STAKE EXTENDING TO 24" ABOVE GRADE. STAKES SHALL NOT BE REMOVED UNTIL THE IRRIGATION SYSTEM IS COMPLETE.
8. ALL SLEEVES SHALL BE EXTENDED A MINIMUM OF 18" BEYOND THE IRRIGATION PLAN FIELD VERIFY LOCATION. ALL ENDS OF SLEEVES SHALL BE TAPED OR CAPPED AND MARKED WITH A 2" X 4" PAINTED STAKE EXTENDING TO 24" ABOVE GRADE. STAKES SHALL NOT BE REMOVED UNTIL THE IRRIGATION SYSTEM IS COMPLETE.
9. CONTRACTOR SHALL OBTAIN AND PAY FOR ALL PERMITS AND FEES REQUIRED FOR THE WORK.
10. IRRIGATION CONTROLLER(S) ARE TO BE LOCATED AS SHOWN ON THE PLAN. CONTROLLERS SHALL BE WIRED TO POWER SUPPLY BY A LICENSED ELECTRICIAN PER LOCAL CODES. IRRIGATION CONTRACTOR TO PROVIDE ALL REQUIRED CONNECTIONS TO THE IRRIGATION CONTROLLER WIRE INSIDE THE BUILDING THROUGH APPROPRIATE SIZED CONDUIT.
11. ALL HEADS ARE TO BE 4" POP-UP IN LAWN AREAS. IRRIGATED AREAS CONTAINING VEGETATION WHICH POTENTIALLY MAY IMPEDE PERFORMANCE OF A 4" POP-UP SPRINKLER SHALL BE 12" OR 16" POP-UP SPRINKLER.
12. ALL ELECTRICAL WORK TO MEET OR EXCEED N.E.C., STATE CODES, LOCAL CODES AND MANUFACTURER'S RECOMMENDATIONS.
13. CONTRACTOR SHALL REMOVE AND DISPOSE OF ALL ROCK AND DEBRIS BROUGHT TO THE SURFACE DURING CONSTRUCTION OPERATIONS.
14. CONTRACTOR SHALL REFER TO SPECIFICATIONS AND DETAIL DRAWINGS FOR ADDITIONAL REQUIREMENTS.
15. ALL 24 VOLT PIPING WIRE SHALL BE #14 AWG SOLID COPPER. ALL ABOVE GROUND AND 120 VOLT AND 24 VOLT WIRE SHALL BE IN PVC CONDUIT. ALL 24 VOLT CONDUIT SHALL BE LOCATED IN A 3/4" CONDUIT.
16. INSTALLATION SHALL COMPLY WITH ALL NATIONAL, STATE, AND LOCAL LAWS AND ORDINANCES.
17. IRRIGATION CONTRACTOR SHALL PROVIDE A COMPLETE AS-BUILT DRAWING IN PDF FORMAT UPON COMPLETION OF INSTALLATION AND PRIOR TO FINAL PAYMENT.
18. THE ENTIRE SYSTEM SHALL BE GUARANTEED TO BE COMPLETE AND PERFECT IN EVERY DETAIL FOR A PERIOD OF ONE YEAR FROM THE DATE OF ITS ACCEPTANCE, REPAIR OR REPLACEMENT OF ANY DEFECTS OCCURRING WITHIN THAT ONE YEAR SHALL BE FREE OF EXPENSE TO THE OWNER.
19. THE CONTRACTOR SHALL BE RESPONSIBLE TO PROVIDE THE SYSTEM WITH WINTERIZATION AND SPRING START UP OF THE SYSTEM DURING THE GUARANTEE PERIOD (1 YEAR).
20. ALL MATERIALS SHALL BE NEW AND WITHOUT FLAWS OR DEFECTS OF THE QUALITY AND PERFORMANCE SPECIFIED, AND SHALL MEET THE REQUIREMENTS OF THE ENTIRE SYSTEM. THE CONTRACTOR SHALL NOT BE RESPONSIBLE FOR ANY DAMAGE PERMITTED WITHOUT PRIOR WRITTEN PERMISSION OF THE OWNER OR DESIGN PROFESSIONAL.
21. IRRIGATION CONTRACTOR SHALL MAKE NECESSARY MINOR FIELD ADJUSTMENTS TO SPRINKLER HEADS, SPRINKLERS, PIPE, AND OTHER IRRIGATION EQUIPMENT LOCATIONS TO FIT THE AS-BUILT SITE. ADJUST HEAD AND PIPE LOCATIONS AS REQUIRED TO AVOID DAMAGING EXISTING TREE ROOTS. ADJUSTMENTS SHALL ENSURE HEAD TO HEAD COVERAGE AND NOT OVER SPRAY THE BUILDING OR DRIVEWAY.
22. IRRIGATION PIPING LAYOUT IS SCHEMATIC. WHERE LINES ARE SHOWN BELOW PAVEMENT ADJACENT TO LANDSCAPE AREAS, THEY SHALL BE LOCATED IN THE LANDSCAPE AREA ADJACENT TO THE PAVEMENT.
23. THE LAYOUT OF THE IRRIGATION SYSTEM SHALL BE SHOWN IN THE PLAN. BASE PLAN AND LOCATION OF EXISTING EQUIPMENT ARE SCHEMATIC IN NATURE. FIELD VERIFY ALL BASE AND EXISTING IRRIGATION ELEMENTS AND CONDITIONS PRIOR TO CONSTRUCTION AND PROVIDE NECESSARY ADJUSTMENTS.
24. CONDUIT COULD BE USED TO PROVIDE A PRESSURE RATING OF 150 PSI. PRESSURE REGULATING MODULE AS SPECIFIED TO ADJUST ZONE OPERATING PRESSURES TO AN AVERAGE OF 30 P.S.I. IN SPRAY ZONES AND 45 P.S.I. IN ROTOR ZONES.
25. ALL MAIN LINE FITTINGS SHALL BE SCHEDULE 40 SOLVED METAL TYPE UNLESS OTHERWISE SPECIFIED.
26. IN THE EVENT OF A DISCREPANCY, IMMEDIATELY NOTIFY THE DESIGN PROFESSIONAL.
27. CONTRACTOR SHALL BE RESPONSIBLE TO PROVIDE CERTIFICATE OF COMPLETION AND RECORD DRAWING, LANDSCAPE AND IRRIGATION MAINTENANCE SCHEDULES, IRRIGATION AUDIT, IRRIGATION SURVEY, AND IRRIGATION WATER USE ANALYSIS.

1. ALL PLANTER BEDS SHALL BE IRRIGATED WITH AN INLINE EMITTER DRIP LINE IRRIGATION SYSTEM. HUNTER® HDL OR APPROVED EQUAL. ALL TREES IN THE NOTED AREA ARE TO BE IRRIGATED AS PER DETAIL 10/L2.5. THE CONTRACTOR IS RESPONSIBLE TO INSTALL THE DRIP SYSTEM AS PER MANUFACTURER'S RECOMMENDATIONS TO COVER THE FOLLOWING:
 - A. AN INLINE EMITTER DRIP LINE TUBING SHALL BE USED. THE EMITTER SPACING SHALL BE EIGHTEEN INCHES (18") AND THE EMITTER FLOWS ARE TO BE 6.0 GPH. LATERALS SHALL BE SPACED AT EIGHTEEN INCHES (18").
 - B. A MANUAL BACKFLUSH FILTER SHALL BE INSTALLED. SEE LEGEND FOR MODEL NUMBER. THE FILTER SHALL BE INSTALLED IN CONJUNCTION WITH AN ELECTRIC REMOTE CONTROL VALVE AS SPECIFIED (SIZE AS NOTED ON SCHEDULE). THE FILTER SHALL INCLUDE A 200 MESH STAINLESS STEEL SCREEN. SEE DETAIL 10/L2.5.
 - C. ALL ZONES SHALL BE INSTALLED WITH A MANUAL LINE FLUSHING VALVE. INSTALL WITH COLLAR. SEE DETAIL 13/L2.5.
 - D. ALL TUBING SHALL BE STAKED DOWN WITH TL56 SIX INCH (6") SOIL STAPLES EVERY 3'-0". SEE DETAIL 10/L2.5 ON EACH END OF EACH CROSS.
2. THE CONTRACTOR IS RESPONSIBLE TO SCHEDULE A MEETING WITH THE DESIGN PROFESSIONAL AND THE OWNER'S REPRESENTATIVE BEFORE PROCEEDING WITH ANY IRRIGATION INSTALLATION IN ORDER TO REVIEW WORK TO BE DONE. NO CHANGES IN MATERIALS OR METHODS OF CONSTRUCTION SHALL BE ALLOWED WITHOUT PRIOR APPROVAL OF THE DESIGN PROFESSIONAL.
3. ALL PVC LATERAL LINES FROM VALVES TO HEADERS ARE TO BE BURIED AT MINIMUM DEPTH OF TWELVE INCHES (12"). SIZE AS NECESSARY. (SEE PIPE SIZING TABLE IN THIS SPEC.)
4. AFTER INSTALLATION OF THE IRRIGATION SYSTEM THE CONTRACTOR IS RESPONSIBLE TO PROVIDE THE OWNER WITH AS-BUILT DRAWINGS AND INSTRUCTIONS FOR MAINTENANCE OF THE DRIP SYSTEM.
5. THE DRIP SYSTEM SHALL BE INSTALLED SUCH THAT EACH TREE RECEIVES ADEQUATE IRRIGATION SO THAT THE OPTIMUM AMOUNT OF WATER IS APPLIED TO ENSURE THE HEALTH OF ALL PLANT MATERIAL. BURY DRIP LINE AT 5" MIN. BELOW GRADE. SEE DETAIL 10/L2.5. LOCATE DRIP LINE TO OBTAIN COMPLETE COVERAGE OF PLANTER AREA. SEE DETAIL 10/L2.5 FOR ADDITIONAL SPECIFICATIONS AND DETAILS FOR ADDITIONAL INFORMATION AND REQUIREMENTS.

SYSTEM OPERATION:
(BASED ON HISTORICAL CLIMATE)

CONTROLLER SETUP:

A CYCLING TECHNIQUE WILL BE USED FOR APPLICATION OF WATER, EACH STATION RUN TIME WILL BE APPLIED WITH THREE (3) DIFFERENT START TIMES. THEREFORE STATION RUN TIMES REFLECT ONE THIRD (1/3) THE TOTAL APPLICATION. PEAK WATER APPLICATION WILL REQUIRE IRRIGATION EVERY NIGHT. SET CONTROLLERS FOR START TIME #1 AT 7:30P.M., START TIME #2 AT 12:00A.M., AND START TIME #3 AT 5:30A.M. EXTEND WATER WINDOW IF REQUIRED TO MEET PEAK WATER REQUIREMENTS.

INITIAL STATION RUN TIMES:

DRIP ZONES: SHRUBS - 10 MINUTE CYCLES. (8 CYCLES MINIMUM SPACED EVENLY
THROUGHOUT WATER WINDOW AS NOTED ABOVE)
SPRAY ZONES: TURF - 5 MINUTE CYCLES.
ROTOR ZONES: TURF - 15 MINUTE CYCLES.

SYSTEM BALANCING:

AS THE SYSTEM OPERATES, SOME ZONES WILL BE WET WHILE OTHERS ARE DRY. ADJUST ONLY THOSE STATIONS WHICH REQUIRE ADDITIONAL OR LESS WATER. FOR EXAMPLE, IF STATION TS1, A 15' TURF SPRAY ZONE IS ALWAYS DRY, CHANGE THE STATION TS1 RUN TIME FROM FIFTEEN (15) MINUTES TO SIXTEEN (16) MINUTES. CONTINUE MAKING ADJUSTMENTS UNTIL THE ZONE MOISTURE CONTENT IS ACCEPTABLE. USE NOZZLE CHANGES OR NOZZLE SCREW ADJUSTMENTS TO ADJUST WET AND DRY AREAS WITHIN A ZONE.



FLOW AVAILABLE	
Point of Connection Size:	1"
Flow Available	14.62 GPM
PRESSURE AVAILABLE	
Static Pressure at POC:	70 PSI
Pressure Available:	70 PSI
DESIGN ANALYSIS	
Maximum Station Flow:	11.65 GPM
Flow Available at POC:	14.62 GPM
Residual Flow Available:	1.47 GPM
Design Pressure:	
Friction Loss:	3.54 PSI
Fittings Loss:	40 PSI
Elevation Loss:	0 PSI
Loss through Valve:	3 PSI
Pressure Req. at Critical Station:	47.83 PSI
Loss for Fittings:	0.14 PSI
Loss for Main Line:	1.36 PSI
Pressure POC to Valve Elevation:	0 PSI
Loss for Backflow:	4.08 PSI
Loss for Master Valve:	2 PSI
Critical Station Pressure at POC:	55.9 PSI
Pressure Available:	70 PSI
Residual Pressure Available:	14.1 PSI

SYMBOL	MANUFACTURER/MODEL/DESCRIPTION
	Hunter PPS-04-PR530-CV Adj. Series Turf Spray, 30 psi regulated 4in. Pop-Up. With factory installed Drain Check Valve. Co-molded niper seal with UV Resistant Material. See detail 1/L2.1
	Hunter RSP-04-12-3.0 Turf Rotor, 4in. Pop-Up. Adjustable to Full Circle. Short Radius Nozzle. See detail 4/L2.1
	Hunter ICZ-101-25-LF Drip Control Zone Kit. In. ICV Globe Valve with In. HY100 Filter system. Pressure Regulation: 25 psi. Flow Range: 5 GPM - 15 GPM. 150 mesh stainless steel screen. See detail 8/L2.5
	Hunter ECO-ID ECO-ID: 1/2in. FPT connection with 12 psi-to-70 psi operating pressure. Specify with Hunter 5J swing joint. See detail 1/L2.5
	Area to Receive Dripline Hunter HDL-06-18-CV HDL-06-18-CV: Hunter Dripline w/ 0.6 GPM emitters at 18" O.C. Check valve, dark brown tubing with gray striping. Dripline laterals spaced at 18" apart, with emitters offset for triangular pattern. Install with Hunter PLD barbed or PLD-LOC fittings. See details 9, 10, 11, 12, and 13/L2.5
	Hunter ICV-6-F5 In. 1-/2in, 2in, and 3in. Plastic Electric Remote Control Valves, Globe Configuration, with NPT Threaded Inlet/Outlet, for Commercial/Municipal use. With Filter Sentry. See detail 2/L2.5
	Hunter HQ-5LRC Quick coupler valve, yellow locking rubber cover, red brass and stainless steel, with In. NPT inlet, 1-piece body. See detail 4/L2.5
	Isolation Valve. See detail 5/L2.5
	Honeywell F765 Water Filter 1" and MV876B Automatic Backwash Motor, In-Line Steel Filter with Brushwash Cleaning Assembly. See detail 14/L2.5
	Hunter ICV-6-F5 1" In. 1-/2in, 2in, and 3in. Plastic Electric Master Valve, Globe Configuration, with NPT Threaded Inlet/Outlet, for Commercial/Municipal use. With Filter Sentry. See detail 2/L2.5
	Hunter I2C-1600-M 16 Station Modular Controller. With one ICM-800 Module. Commercial Use. Metal Cabinet. See detail 3/L2.1
	Hunter I65 Wireless Solar, rain freeze sensor and outdoor Interface, connects to Hunter PCC, Pro-C, and i-Core Controllers, install as noted. Includes 10 year lithium battery and rubber module cover, and gutter mount bracket. See detail 2/L2.1
	Hunter HC-100-FLOW In. Flow meter for use with Hydrowise enabled controller to monitor flow and provide system alerts. Also functions as stand alone flow totalizer/sub meter on any residential or commercial irrigation system. See detail 3/L2.5
	Cap at the mainline or lateral line for future use. Ensure water tight fitting
	Irrigation Lateral Line: PVC Schedule 40 1" lateral transition pipe sizes 1" and above are indicated on the plan, with all others being 3/4". See details 6 and 7/L2.5
	Schedule 40 PVC for electrical control wires, size as indicated on plans. Coordinate with Electrical.
	Irrigation Mainline: PVC Schedule 40. See details 6 and 7/L2.5
	Pipe Sleeve: PVC Schedule 40. See detail 6/L2.5

NUMBER	MODEL	SIZE	TYPE	GPM
1	Hunter ICV-G-F5	1"	Turf Rotor	10.8
2	Hunter ICV-G-F5	1"	Turf Rotor	8.1
3	Hunter ICV-G-F5	1"	Turf Rotor	10.8
4	Hunter ICV-G-F5	1"	Turf Rotor	8.1
5	Hunter IZ-10I-25-LF	1"	Area for Driveline	5.25
6	Hunter IZ-10I-25-LF	1"	Area for Driveline	2.08
7	Hunter ICV-G-F5	1"	Turf Spray	9.92
8	Hunter ICV-G-F5	1"	Turf Spray	8.34
9	Hunter IZ-10I-25-LF	1"	Area for Driveline	6.44

-AREA FIVE

-AREA SIX

-AREA NINE

- ① CONNECT NEW 1" MAINLINE TO 4" PRESSURE IRRIGATION SERVICE IN THE APPROXIMATE LOCATION. (FIELD VERIFY). SEE CIVIL PLANS FOR ADDITIONAL INFORMATION.
- ② 2" WIRE SLEEVE. ROUTE TO CONTROLLER LOCATION PER LOCAL CODES AS REQUIRED.
- ③ INDOOR WALL MOUNT IRRIGATION CONTROLLER IN THE APPROXIMATE LOCATION AS REQUIRED. CONNECT 120 VOLT AS REQUIRED. ALL ABOVE GRADE WIRES SHALL BE LOCATED IN APPROPRIATELY SIZED CONDUIT (2" MINIMUM). IRRIGATION CONTRACTOR SHALL BE RESPONSIBLE TO COORDINATE WITH CERTIFIED ELECTRICAL CONTRACTOR FOR ALL ELECTRICAL CONNECTIONS. IRRIGATION CONTRACTOR SHALL ENSURE ALL CONTROLLER OPTIONS AND ZONES ARE FULLY OPERATIONAL AFTER TRENCHING HAS FINISHED. CONTROLLER LOCATION TO BE OWNER APPROVED. REVISE LOCATION AS REQUIRED FOR OWNER APPROVAL.
- ④ EXTEND EXTRA WIRES TO THIS POINT, COIL APPROPRIATELY 24" LENGTH OF EXTRA WIRES IN SEPARATE VALVE BOX AT THIS LOCATION.

