

DSRFY2023-0007 - Design Review

City of Garden City – City Council

November 13, 2023



Modified Conditions:

1. Include lockable gate at boundary between Bardenay and Stagecoach on the vacated Osage lots.
2. Add a boundary fence along the shared property line
3. Include in a future sign permit package, signs indicated where overflow parking is available on the Riverside property.
4. Nonexclusive easement for parking approximately 14,000 SF in size immediately north of subject parcel.

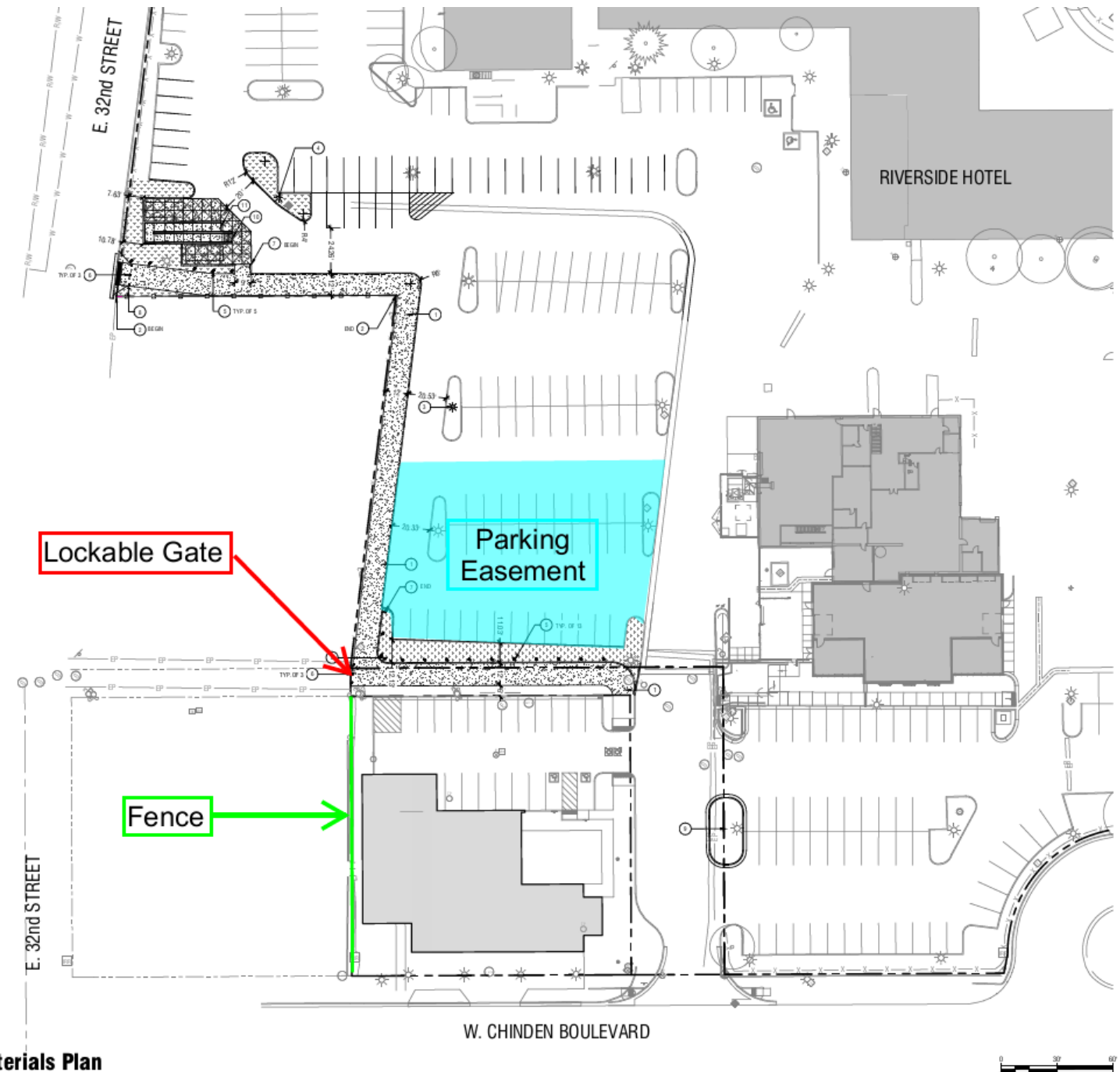

Design Review Limitation

- **Limitations Of Design Review Authority:** Except for development on substandard lots of record, the design review consultant(s) ***is prohibited from*** requiring reductions in height, density or floor area ratio, or other general bulk regulations.