

View Property Card and Tax Map information is now available on Assessors' page:

Click [HERE](#)

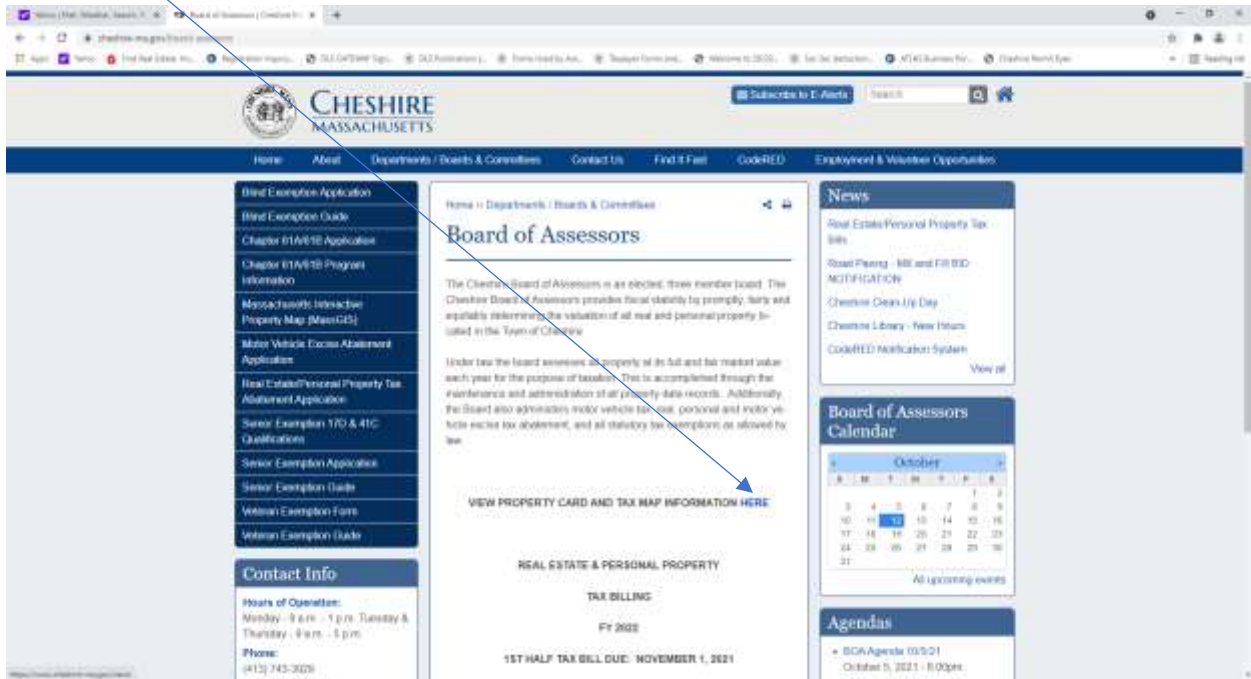

You will see this screen...Click here to search

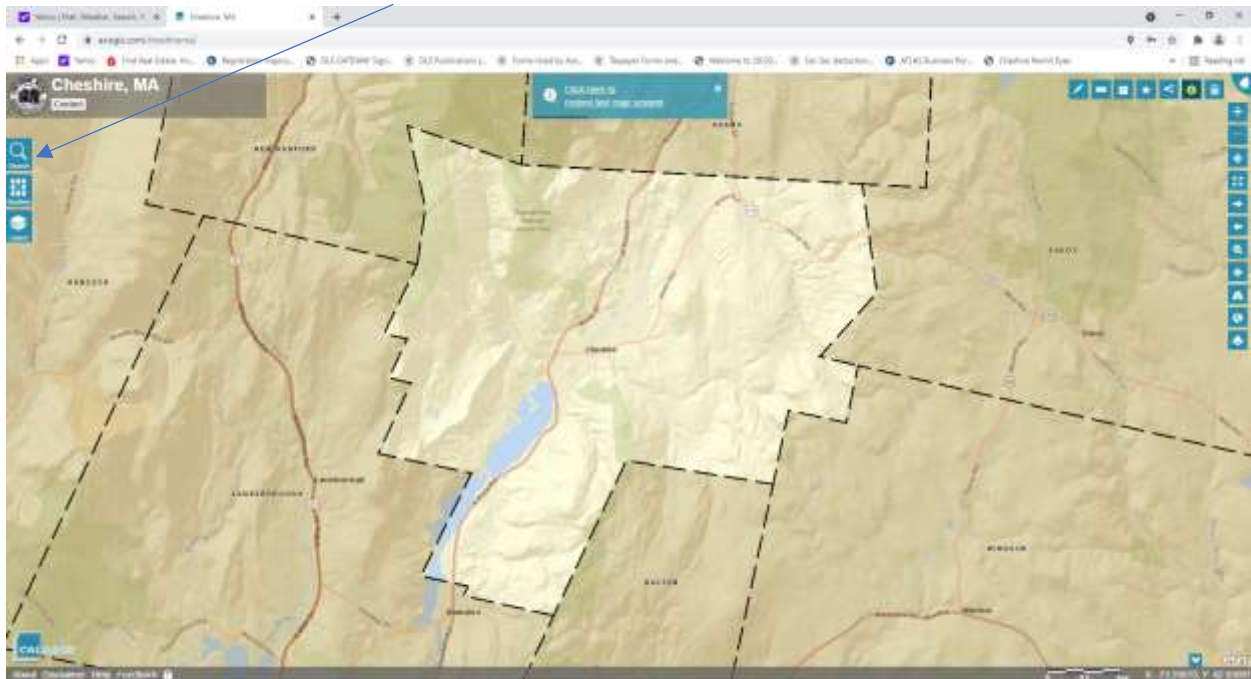

You can search by name, location or parcel ID...start typing here and results will show (see next)

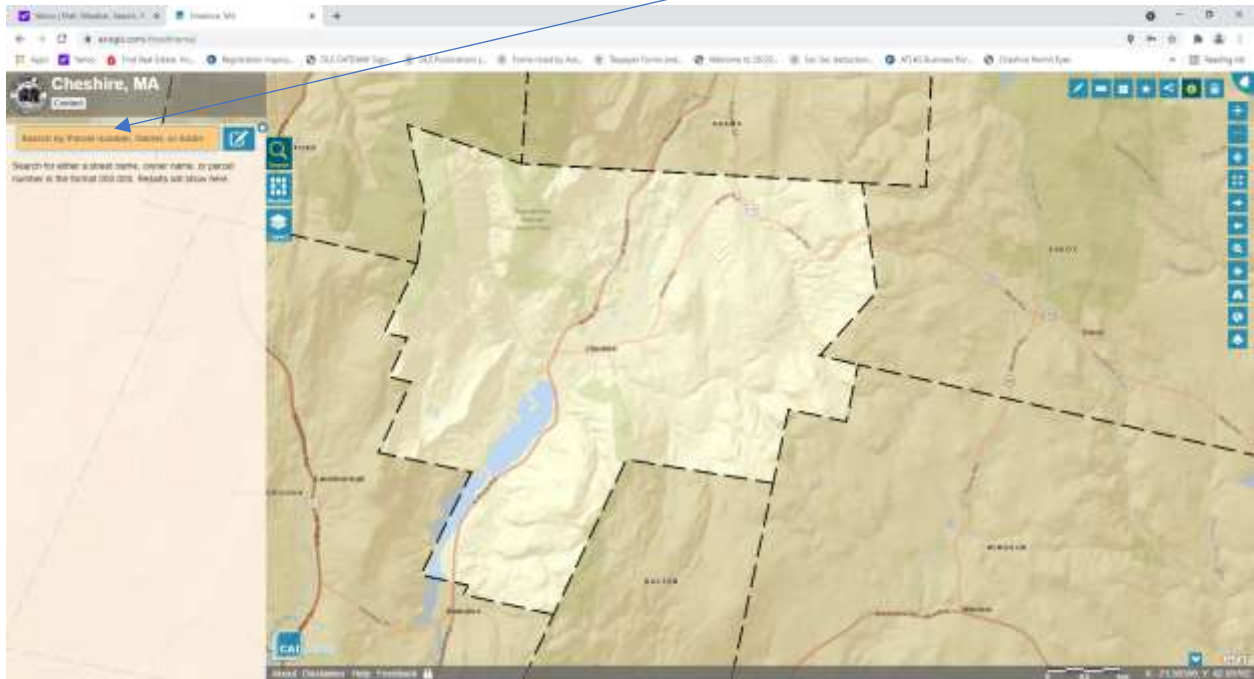

Results

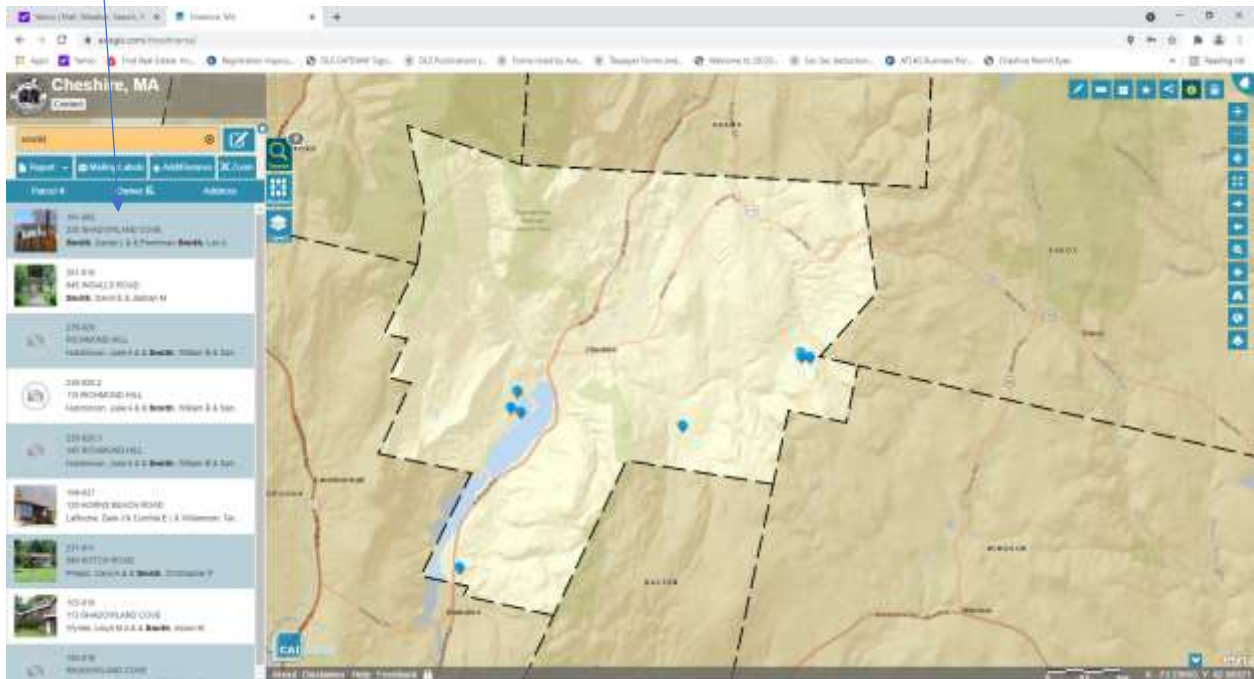

Click on your choice

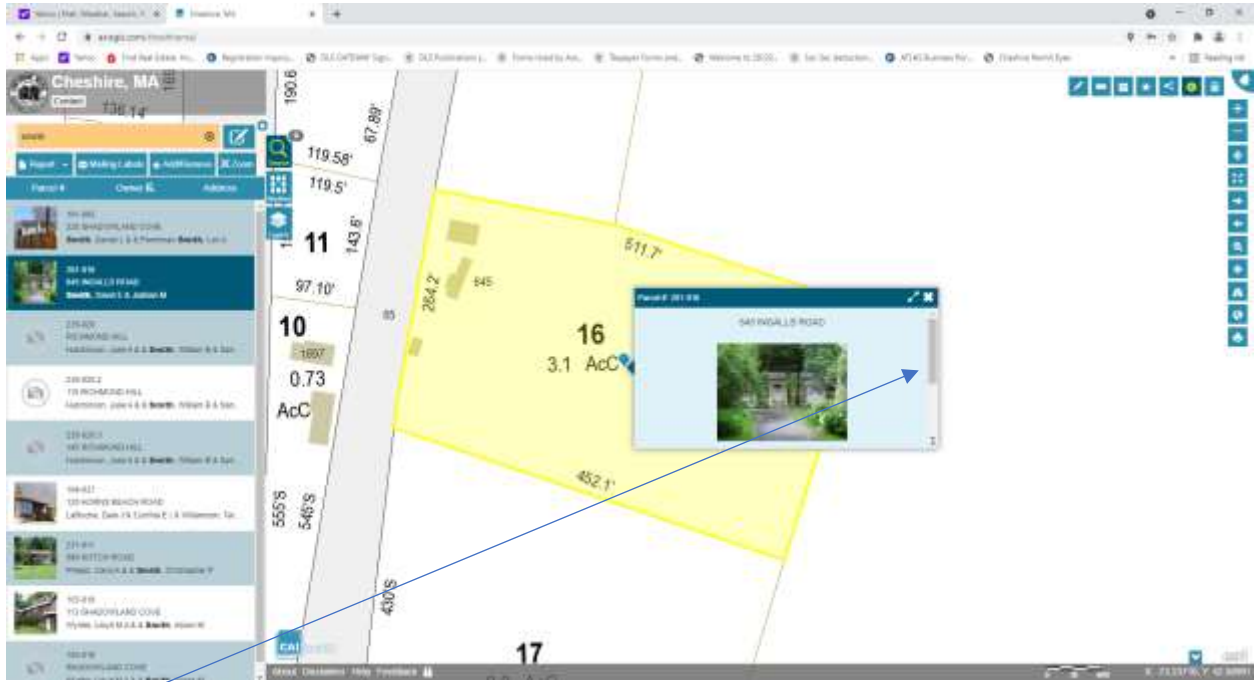

Scroll here to choose CAI Property Card

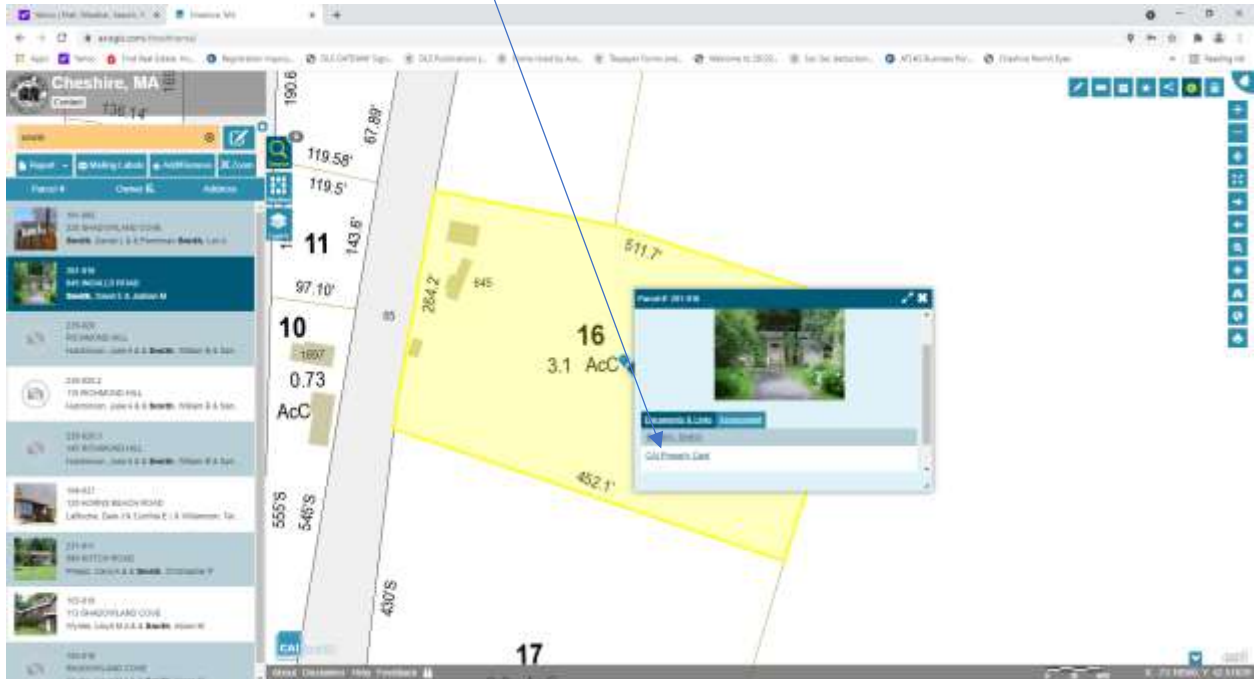

This is what the CAI Property Card looks like, which can be downloaded or printed

CAI Property Card
Town of Cheshire, MA

GENERAL PROPERTY INFORMATION	BUILDING EXTERIOR
LOCATION: 345 IRVING ROAD	BUILDING STYLE: SINGLE FRI
ACRES: 3.1	RENTAL UNITS: 0
PARCEL ID: 001478	YEAR BUILT: 1980
LAND USE CODE: 033	FRAME: WOOD
CONDO COMPLEX:	EXTERIOR WALL COVER: WOOD
OWNER: Smith, David E & Jeanne M	ROOF STYLE: GABLE
CO-OWNER:	ROOF COVER: ASPHALT Sh
MAILING ADDRESS: 345 Irving Road	
Cheshire, MA 01525	
ZONING: AH	
PATRIOT ACCOUNT #: 0113	
SALE INFORMATION	BUILDING INTERIOR
SALE DATE: 8/22/2023	INTERIOR WALL: PLASTER
ROOM & PAGE: 31/20-0449	FLOOR COVER: CARPET
SALE PRICE: \$51,000	HEAT TYPE: FPC2/1HW
SALE DESCRIPTION:	FUEL TYPE: OIL
SELLER:	PERCENT AC: 0
PRINCIPAL BUILDING AREAS	# OF ROOMS: 3
3RD FLOOR BUILDING AREA: 0/0	# OF BEDROOMS: 1
2ND FLOOR BUILDING AREA: 373	# OF FULL BATHS: 1
BASEMENT AREA: 0	# OF HALF BATHS: 1
# OF PRINCIPAL BUILDINGS: 1	# OF ADDITIONAL FEATURES: 0
ASSESSED VALUES	# OF STITCHES: 1
LAND: 171,000	# OF FIREPLACES: 0
TAXED: 17,000	# OF WOOD STOVE PLACES: 1
BUILDING: 30,000	
TOTAL: 188,000	
SKETCH	PHOTO

You can also print the map

Cheshire, MA

Parcel 16: 3.1 AcC

Dimensions: 119.5', 119.5', 143.8', 97.10', 511.7', 288.0', 452.1', 430'S, 546'S, 555'S, 67.80'

Map interface showing navigation and printing controls.

You can choose the layout (portrait or landscape) to suit the size of the lot, you can also zoom in or out to fit on page or look at surrounding properties, by using the roller on your mouse

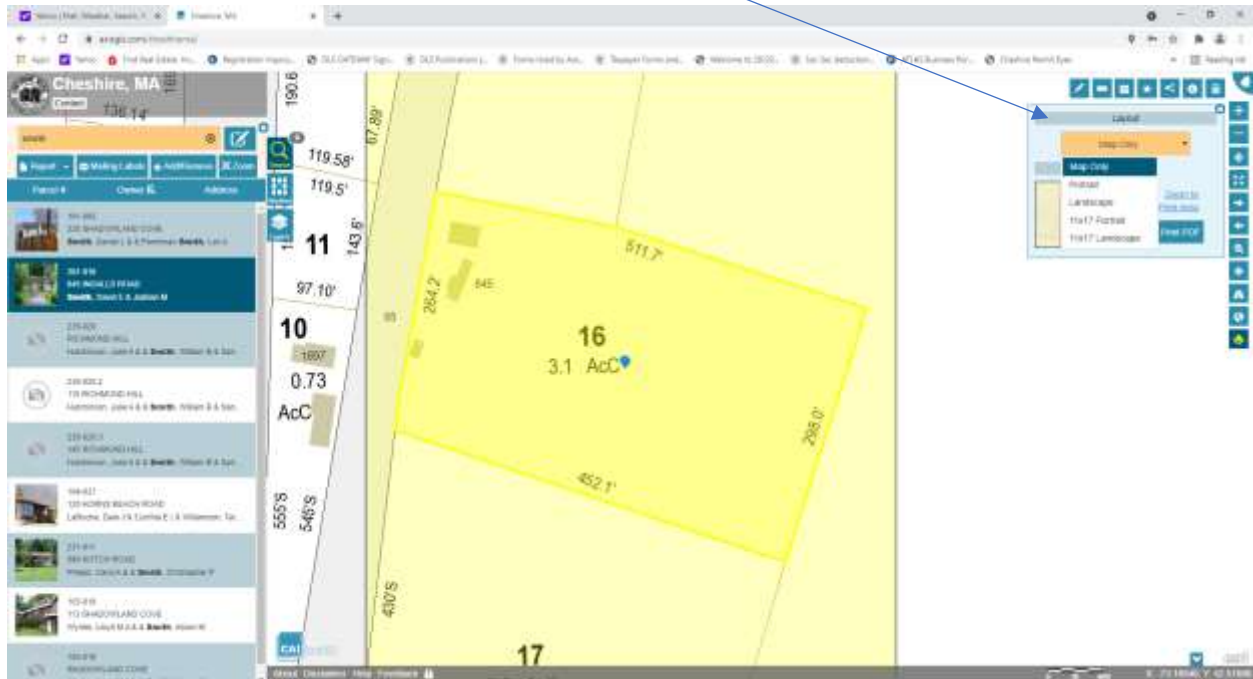

Please contact the Assessors' office with questions that are not answered in these instructions.

413-743-3929