



MATCH THE ITEMS!

ONE OF THE WAYS WE CAN HONOUR THE EARTH IS BY RECYCLING. RECYCLING IS TO SORT OUT THE TRASH THAT WE'VE CREATED. YOU CAN FIND THESE SIMILAR RECYCLING BINS IN PUBLIC PLACES! LET'S DO OUR PART TO HONOUR THE EARTH. MATCH THE TRASH TO THE CORRECT BIN.

YOU WILL NEED:

- 5 RECYCLING BINS LABELS
- CUTOUT OF ITEMS
- BLU TACK
- WHITEBOARD/WALL
- 5 BINS

STEPS:

1. HAVE CHILDREN COLOUR THE 5 RECYCLING BINS AND CUTOUTS OF ITEMS.
2. USING BLU TACK, LINE UP 5 RECYCLING BINS IN A ROW ON A WHITEBOARD/WALL.
3. EXPLAIN BRIEFLY TO THE CHILDREN ABOUT RECYCLING.
4. DISTRIBUTE A FEW ITEM CUTOUTS TO THE CHILDREN TO SORT THEM INTO THE RIGHT BINS.

ADDITIONAL: PRINT PICTURES OF REPURPOSED MATERIAL (NEW BOTTLES, ECO-PAPER, NEW PLASTIC ITEM) AND FERTILIZER (FROM FOOD WASTE). ASK THE CHILDREN WHICH RECYCLED WASTE PRODUCES THE GIVEN PICTURE.



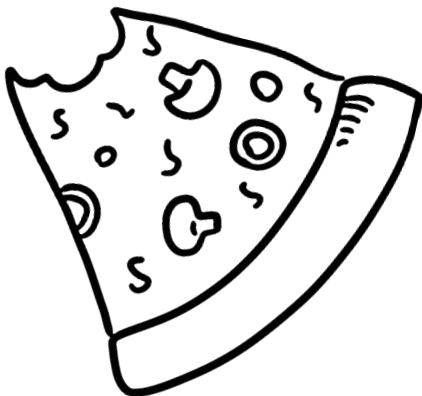
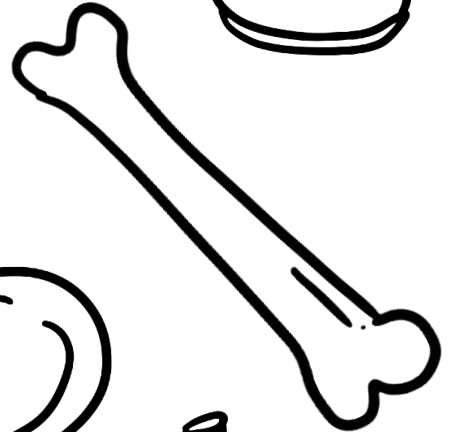
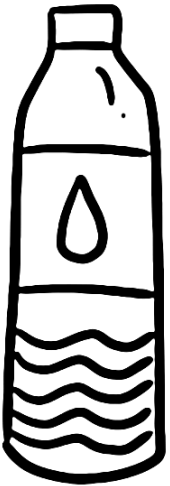
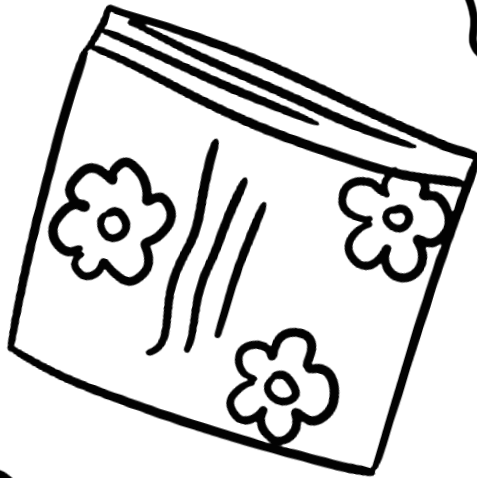
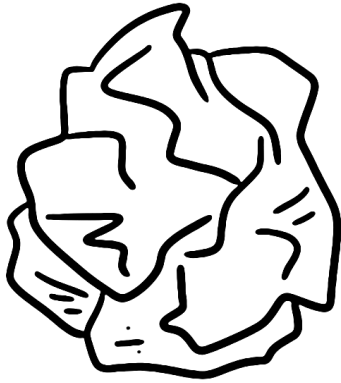
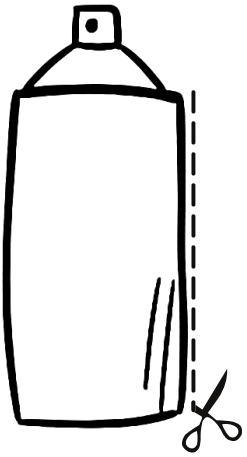

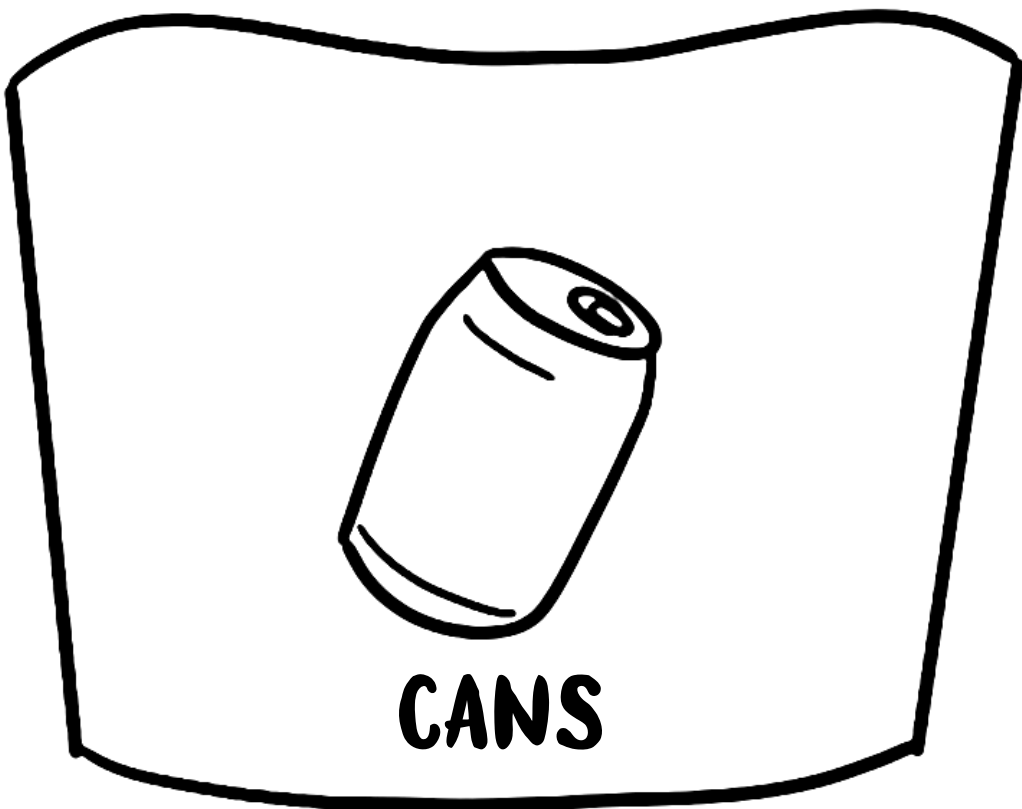

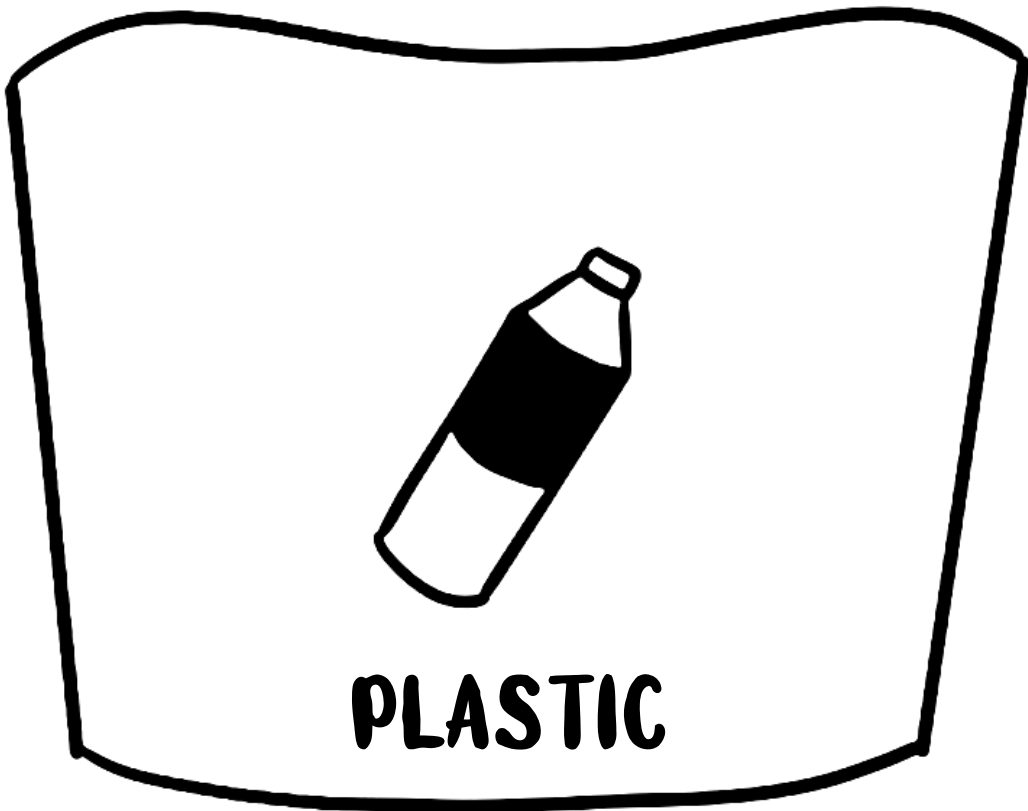

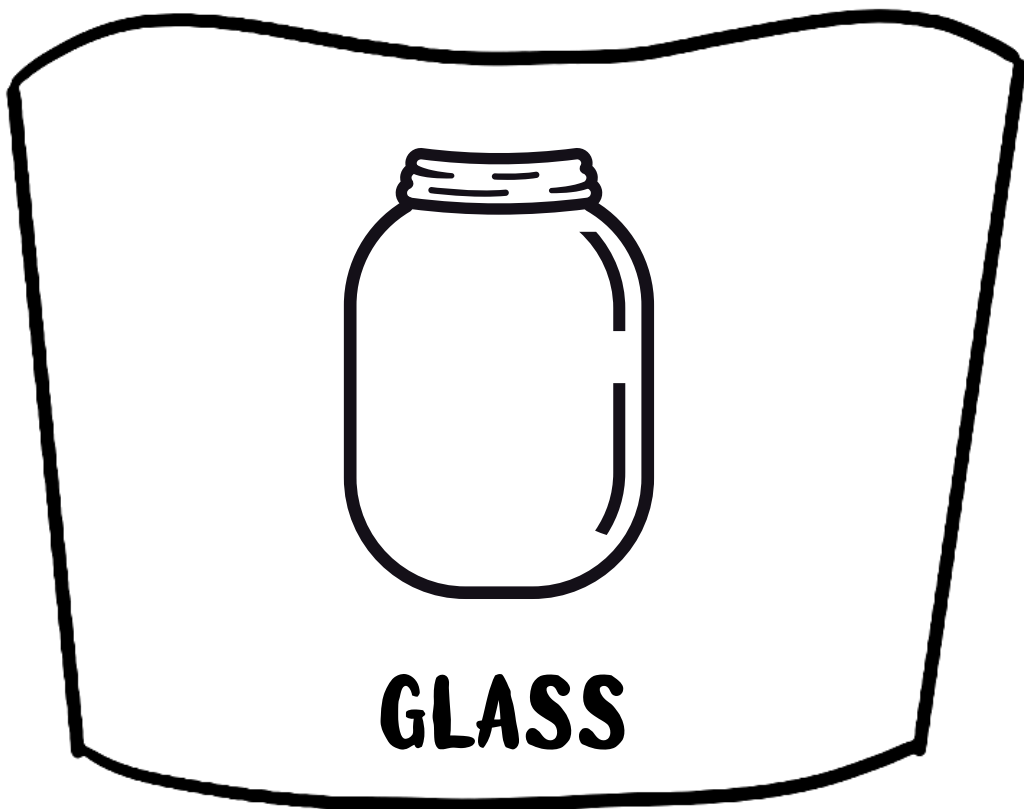

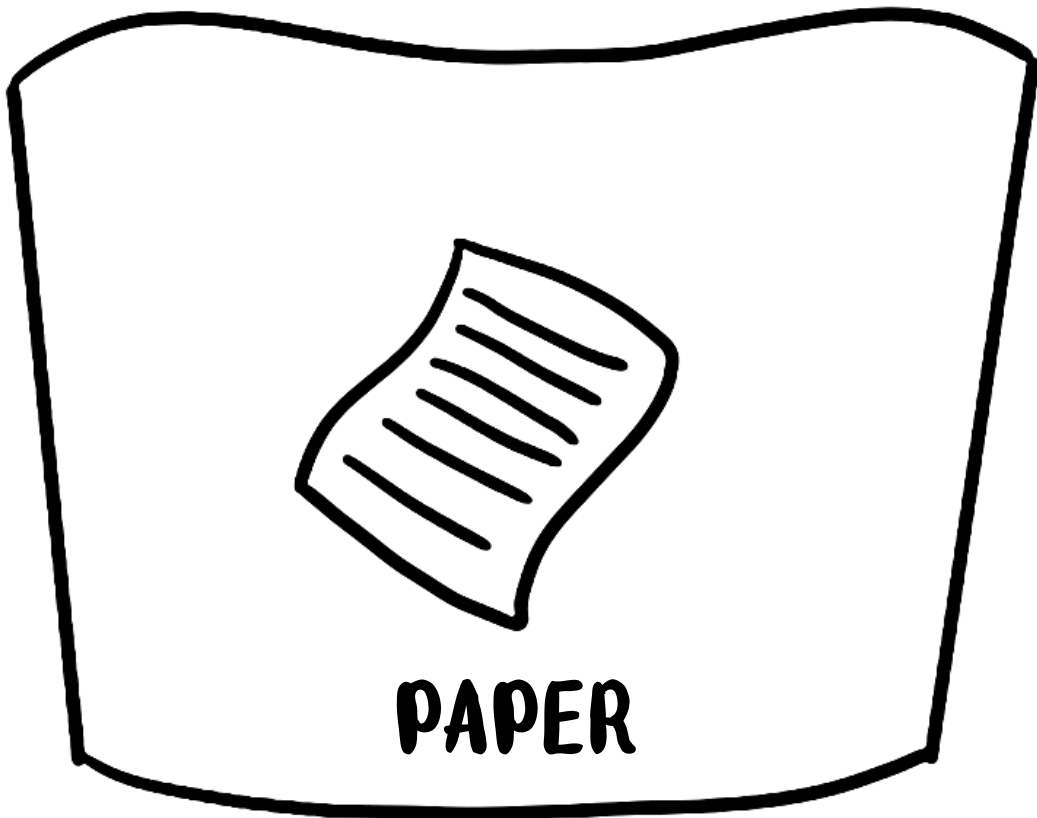

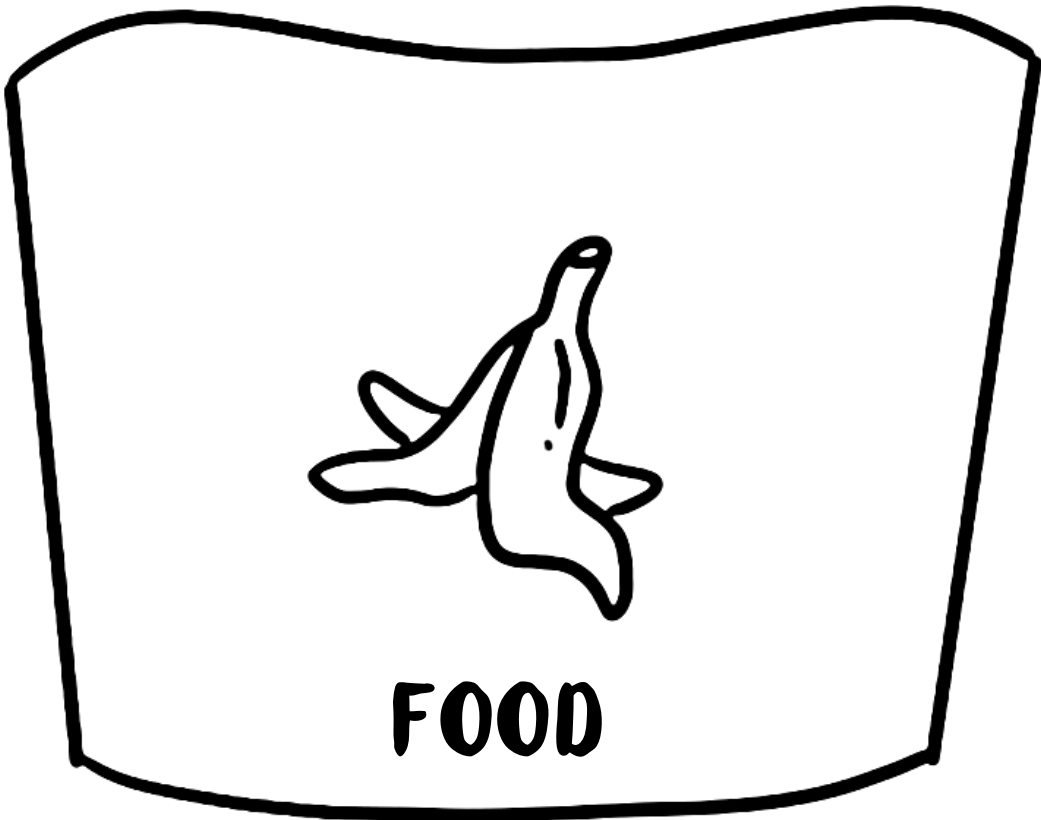



A TREE FOR LIFE!

HONOUR THE EARTH BY PLANTING TREES FOR THE ENVIRONMENT. TREES CAN ABSORB THE CARBON DIOXIDE CAUSED BY POLLUTION AND PRODUCE OXYGEN. OXYGEN IS IMPORTANT BECAUSE WE NEED IT TO LIVE.

YOU WILL NEED:

- RECYCLED CEREAL BOX
- RECYCLED PAPER TOWEL TUBE
- GREEN PAPER
- PAINT AND PAINT BRUSH
- TISSUE PAPER
- GLUE
- SCISSORS
- NEWSPAPER TO PROTECT YOUR WORK AREA

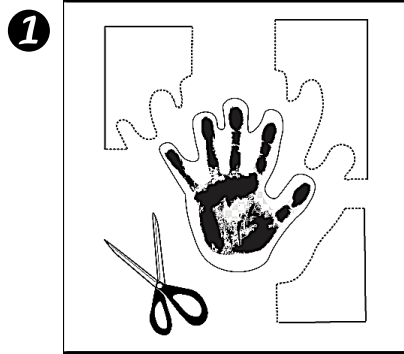

LAY NEWSPAPERS ON THE TABLE TO PROTECT YOUR WORK AREA.

PAINT CHILD'S HANDS WITH BROWN PAINT AND MAKE FOUR HANDPRINTS ON GREEN CONSTRUCTION PAPER. THEIR HANDPRINTS WILL BE THE TREE BRANCHES!

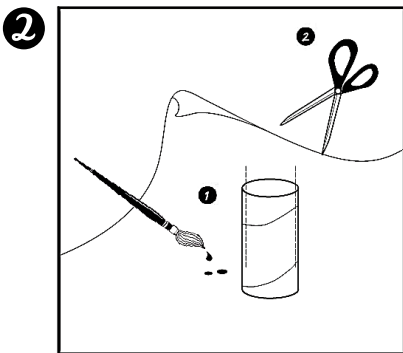

PAINT A PAPER TOWEL TUBE BROWN. ALLOW ALL PAINT TO DRY. (ALTERNATELY, WRAP BROWN PAPER AROUND THE TUBE).

GLUE HANDPRINTS TO RECYCLED CEREAL BOX AND CUT THE HANDPRINTS OUT INDIVIDUALLY.

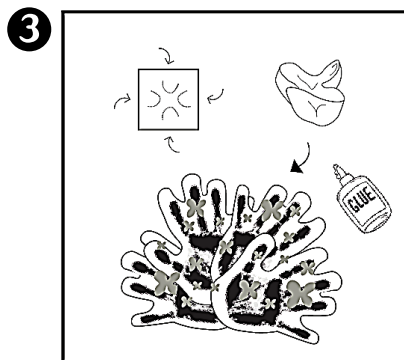

OVERLAP AND PASTE THE HANDPRINTS TO FORM A TREE SHAPE WHICH WILL BE THE TREE TOP.

CUT TWO SLITS (ABOUT 1" DEEP) ACROSS THE CENTER OF ONE EDGE OF THE PAPER TOWEL TUBE.

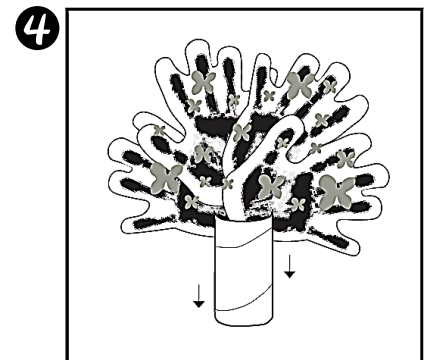

CUT 1" SQUARES OF TISSUE PAPER AND CRINKLE THE SQUARES, THEN, GLUE THEM ONTO THE HANDPRINTS AS BLOSSOMS ON THE TREE.

PUT THE TREE TOP INTO THE SLITS' EDGE OF THE PAPER TOWEL ROLL.