

CEDAR PARK TOWN CENTER

4601 183A Toll Road | Cedar Park, TX 78613

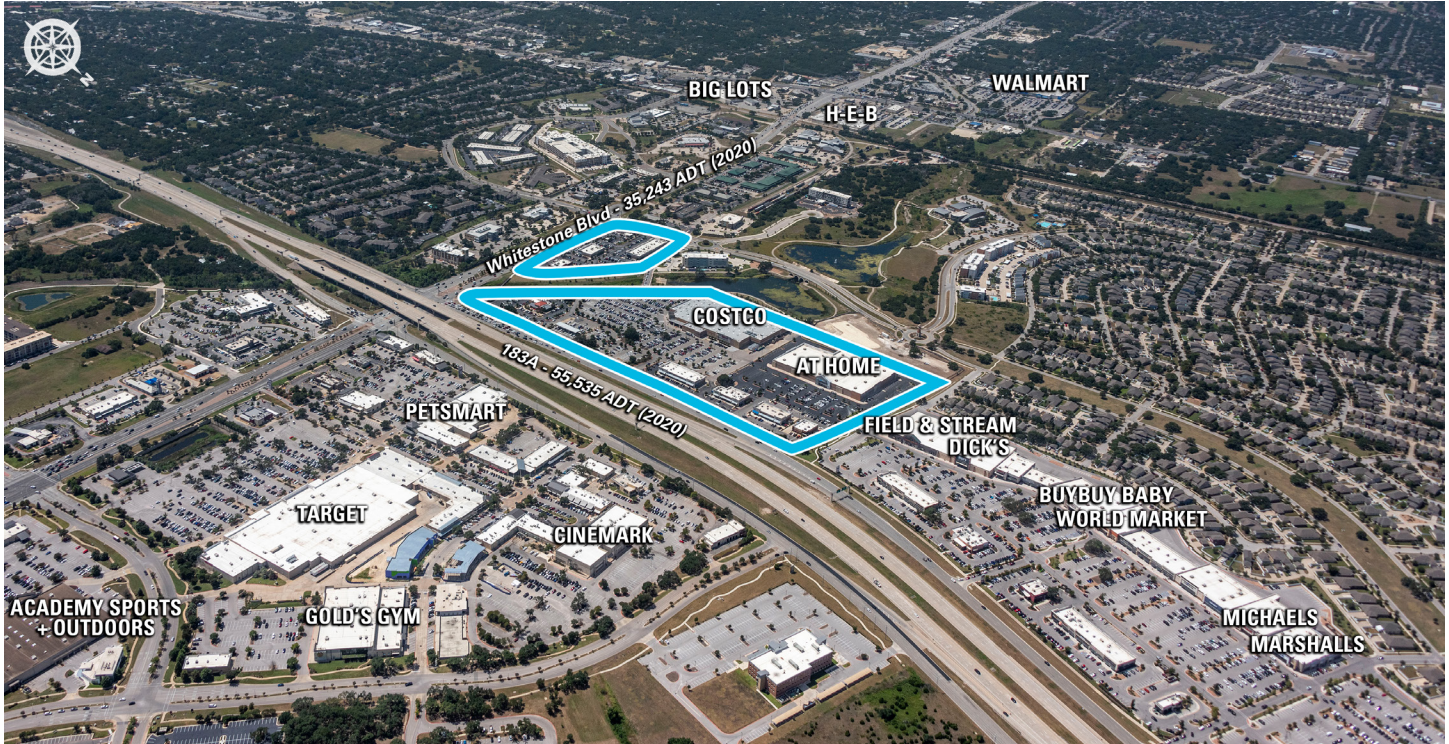

Cedar Park Town Center

MSA: Austin, TX | GLA: 179,288

High-traffic community shopping center with excellent visibility from the 183A Toll Road running through the northwest Austin suburb of Cedar Park. The center is supported by a fast-growing affluent customer base. Cedar Park Town Center is also situated along the community's primary shopping corridor and is anchored by Costco.

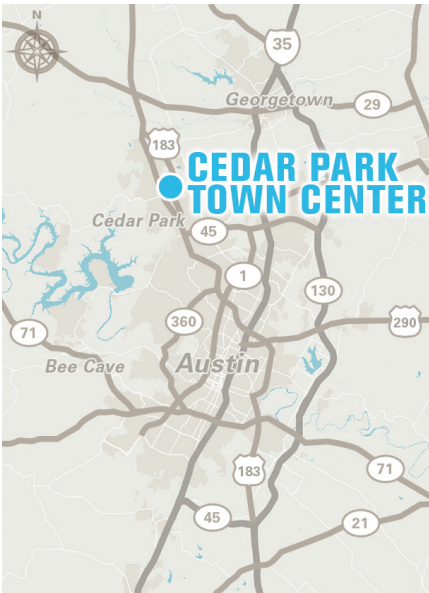

3 MILE DEMOGRAPHICS



POPULATION

87,511



% POP. GROWTH
(ANNUAL)

2.39%



AVG. HH INCOME

\$108,664



MED. HH INCOME

\$94,139



HOUSEHOLDS

30,567



BACH. DEGREE+

43.32%

**2020 Demographic Source (PopStats)*

LEASING CONTACT - Karly Kilroy - kkilroy@kiterealty.com - 214.451.2551



317-577-5600 kiterealty.com

KRG
LISTED
NYSE

CEDAR PARK TOWN CENTER

4601 183A Toll Road | Cedar Park, TX 78613

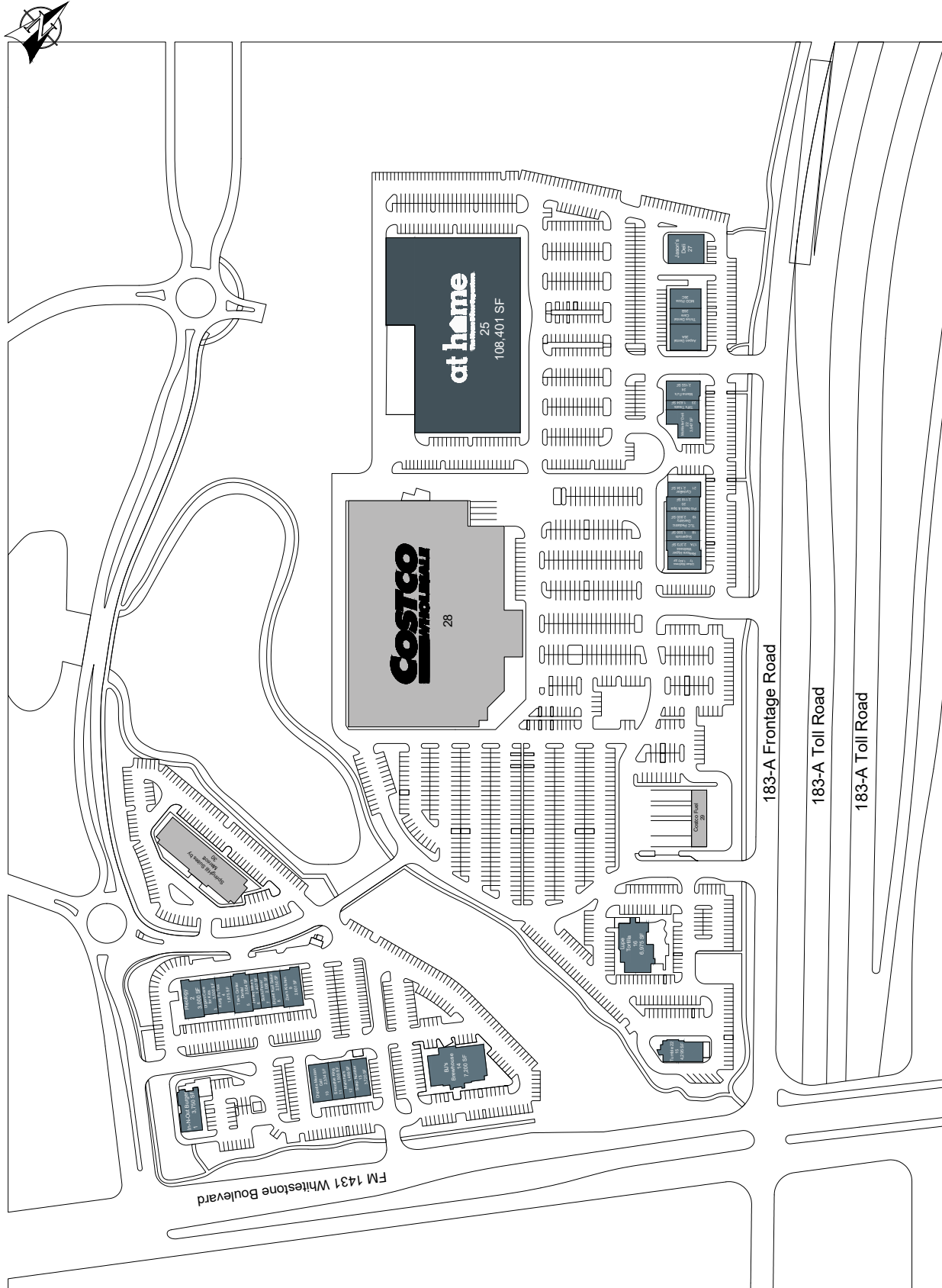

317-577-5600 kiterealty.com

KRG
LISTED
NYSE