

# CENTRE POINT COMMONS

4014-4016 14th Street West & 1520 - 1608 Cortez Road West | Bradenton, FL 34205

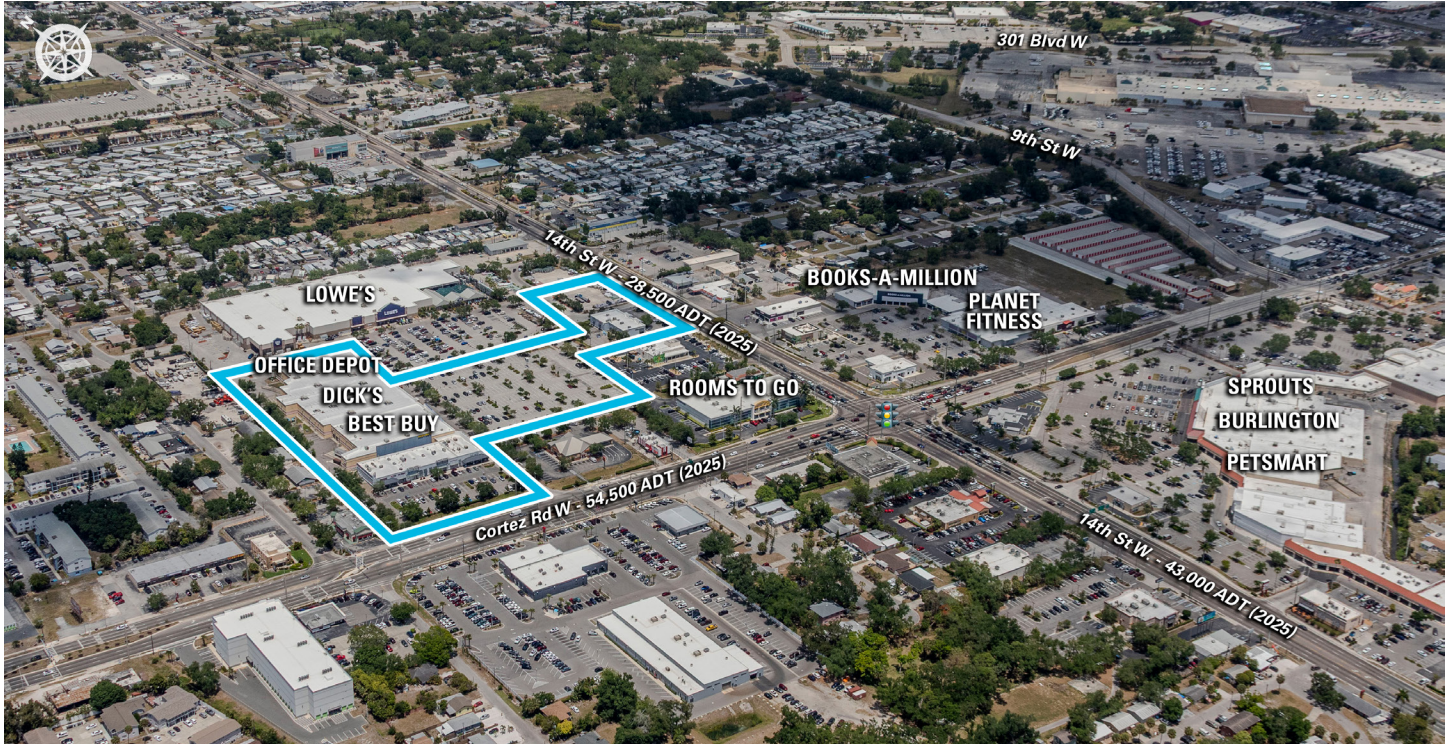

## Centre Point Commons

MSA: Sarasota, FL | GLA: 119,366

Established community shopping center supported by high population density. The center has excellent visibility along both Cortez Rd. and 14th Street, which have excellent traffic counts. Centre Point Commons is anchored by Lowe's, Office Depot, Best Buy, and Dick's Sporting Goods.

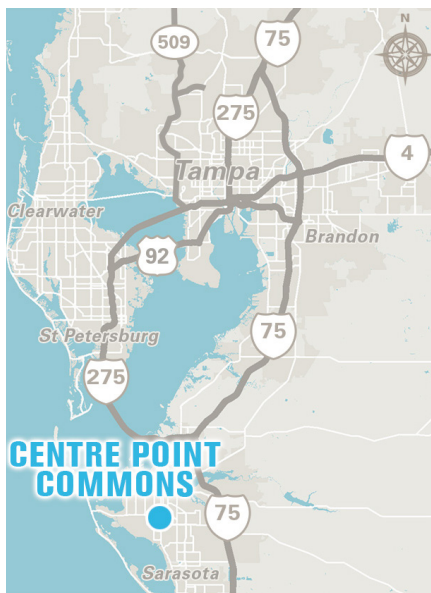

### 3 MILE DEMOGRAPHICS



POPULATION  
**120,373**



DAYTIME POP.  
**43,507**



AVG. HH INCOME  
**\$82,439**



MED. HH INCOME  
**\$60,437**



HOUSEHOLDS  
**50,375**



BACH. DEGREE+  
**19.4%**

*\*2025 Demographic Source (PopStats)*

**LEASING CONTACT** - Brian Hector - [bhector@kiterealty.com](mailto:bhector@kiterealty.com) - 407.563.0110



317-577-5600 [kiterealty.com](http://kiterealty.com)

KRG  
LISTED  
NYSE

# CENTRE POINT COMMONS

4014-4016 14th Street West & 1520 - 1608 Cortez Road West | Bradenton, FL 34205

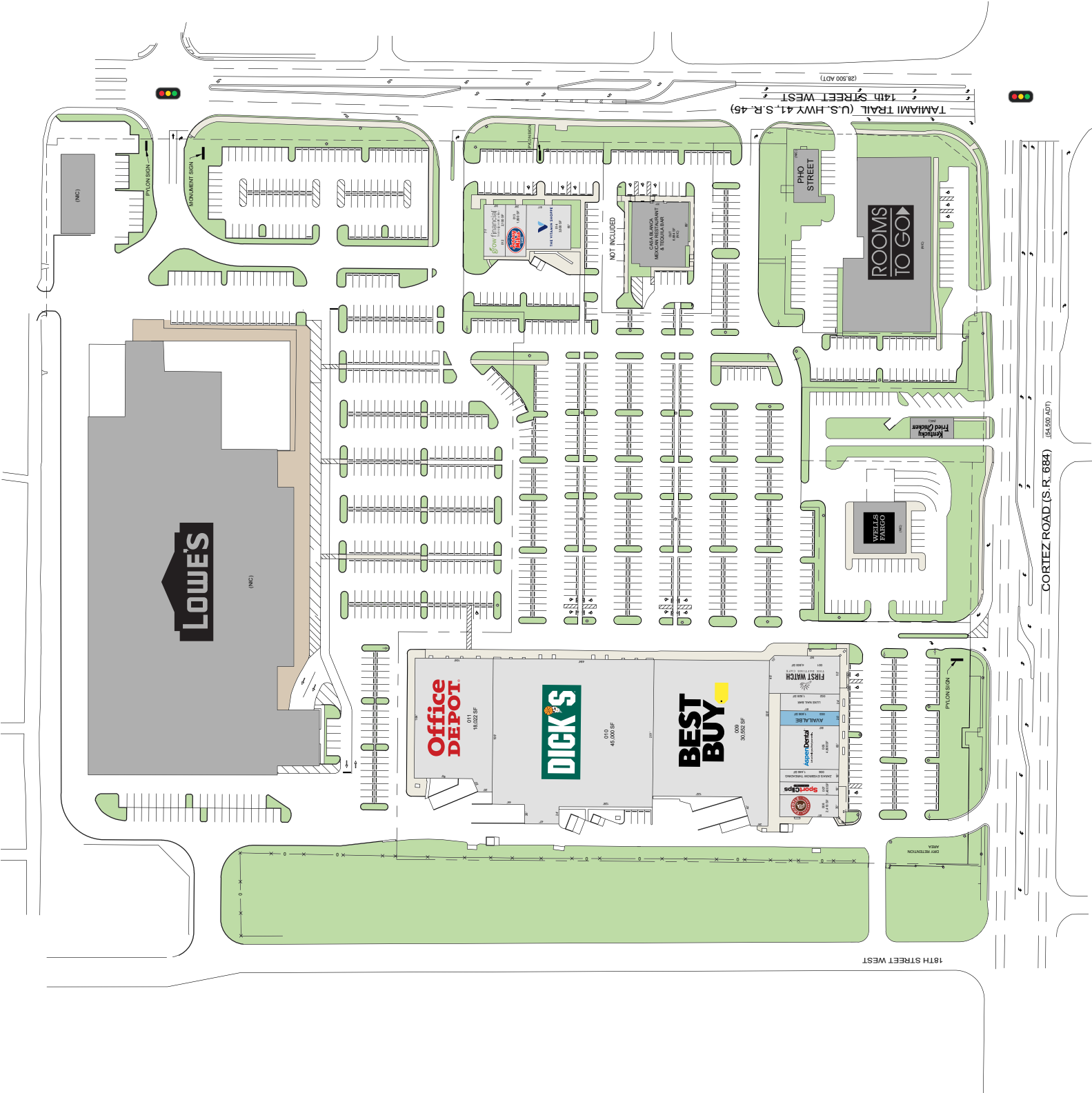

317-577-5600 [kiterealty.com](http://kiterealty.com)

KRG  
LISTED  
NYSE