

# CIRCLE EAST

1 E. Joppa Road | Towson, MD 21286



## Circle East

MSA: Baltimore, MD | GLA: 240,000

Transformative multi-phase mixed-use development in heart of downtown Towson, MD. The project features popular sit-down restaurants, fast-casual eateries, boutiques, and entertainment venues. Circle East also features the 371-unit luxury apartment development, Avalon Towson. Circle East is anchored by Urban Outfitters, Ethan Allen, and Shake Shack.

### 3 MILE DEMOGRAPHICS



POPULATION

**115,404**



% POP. GROWTH  
(ANNUAL)

**0.34%**



AVG. HH INCOME

**\$106,184**



MED. HH INCOME

**\$77,110**



HOUSEHOLDS

**46,442**



BACH. DEGREE+

**51.52%**

*\*2020 Demographic Source (PopStats)*

**LEASING CONTACT** - Greg Goldberg - [ggoldberg@kiterealty.com](mailto:ggoldberg@kiterealty.com) - 410.246.5599



317-577-5600 [kiterealty.com](http://kiterealty.com)

**KRG**  
LISTED  
NYSE

# CIRCLE EAST

1 E. Joppa Road | Towson, MD 21286

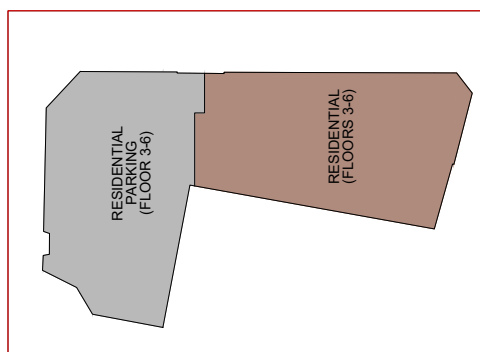
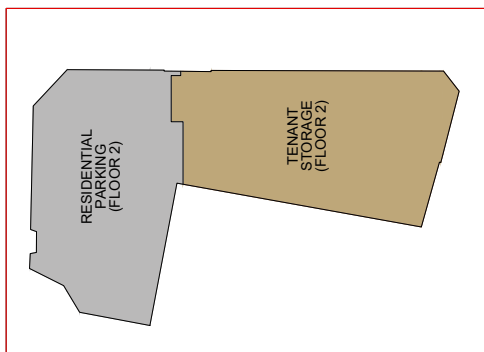

317-577-5600 kiterealty.com

KRG  
LISTED  
NYSE