

CIRCLE EAST

1 E. Joppa Road | Towson, MD 21286



Circle East

MSA: Baltimore, MD | GLA: 220,769

Transformative multi-phase mixed-use development in heart of downtown Towson, MD. The project features popular sit-down restaurants, fast-casual eateries, boutiques, and entertainment venues. Circle East also features the 371-unit luxury apartment development, Avalon Towson. Circle East is anchored by Urban Outfitters, Ethan Allen, and Shake Shack.



3 MILE DEMOGRAPHICS



POPULATION

116,439



% POP. GROWTH
(ANNUAL)

0.16%



AVG. HH INCOME

\$131,757



MED. HH INCOME

\$92,527



HOUSEHOLDS

46,062



BACH. DEGREE+

54.55%

**2024 Demographic Source (PopStats)*

LEASING CONTACT - Greg Goldberg - ggoldberg@kiterealty.com - 410.246.5599



317-577-5600 kiterealty.com

KRG
LISTED
NYSE

CIRCLE EAST

1 E. Joppa Road | Towson, MD 21286

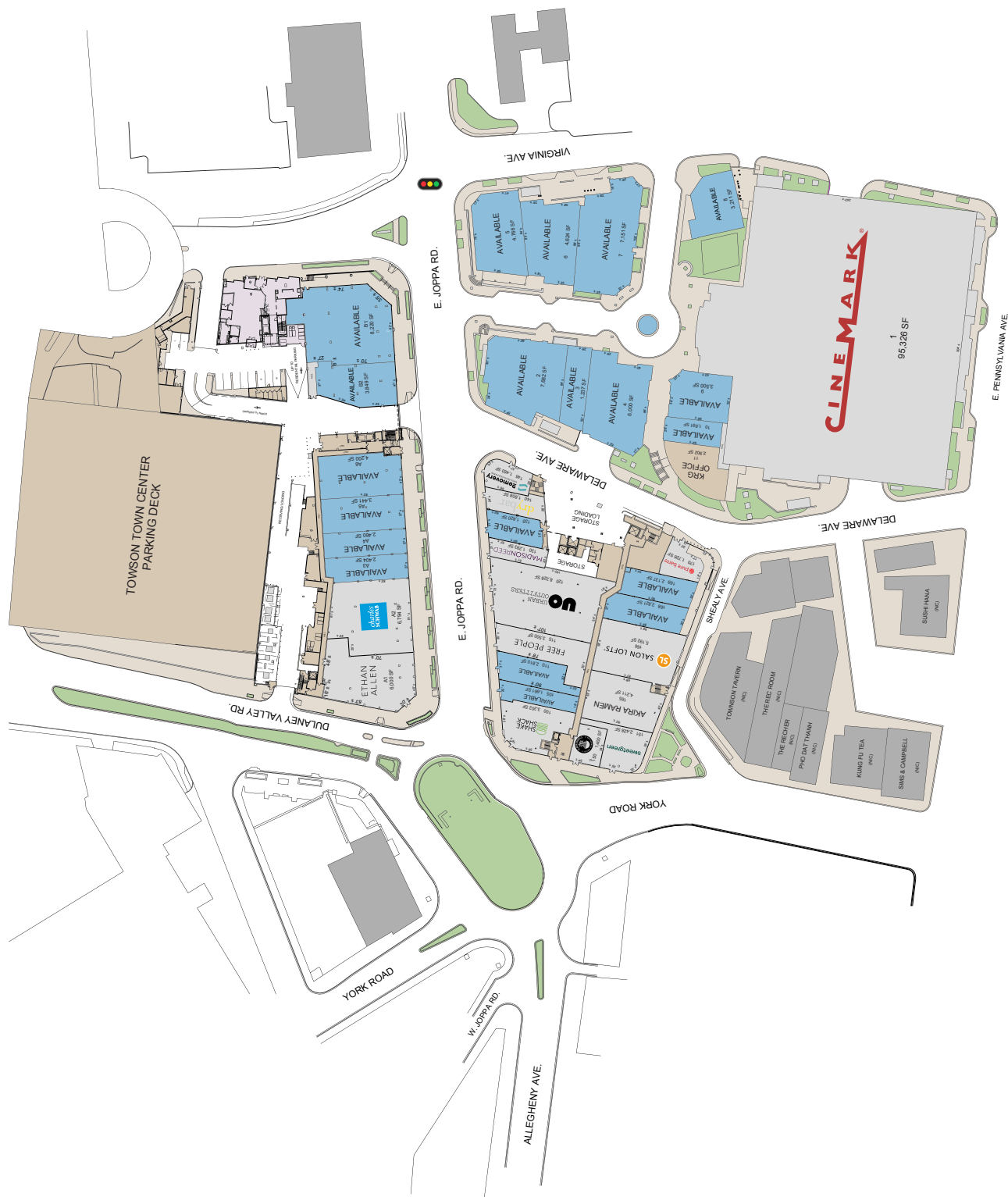

GROUND LEVEL RETAIL



317-577-5600 kiterealty.com

KRG
LISTED
NYSE

CIRCLE EAST

1 E. Joppa Road | Towson, MD 21286

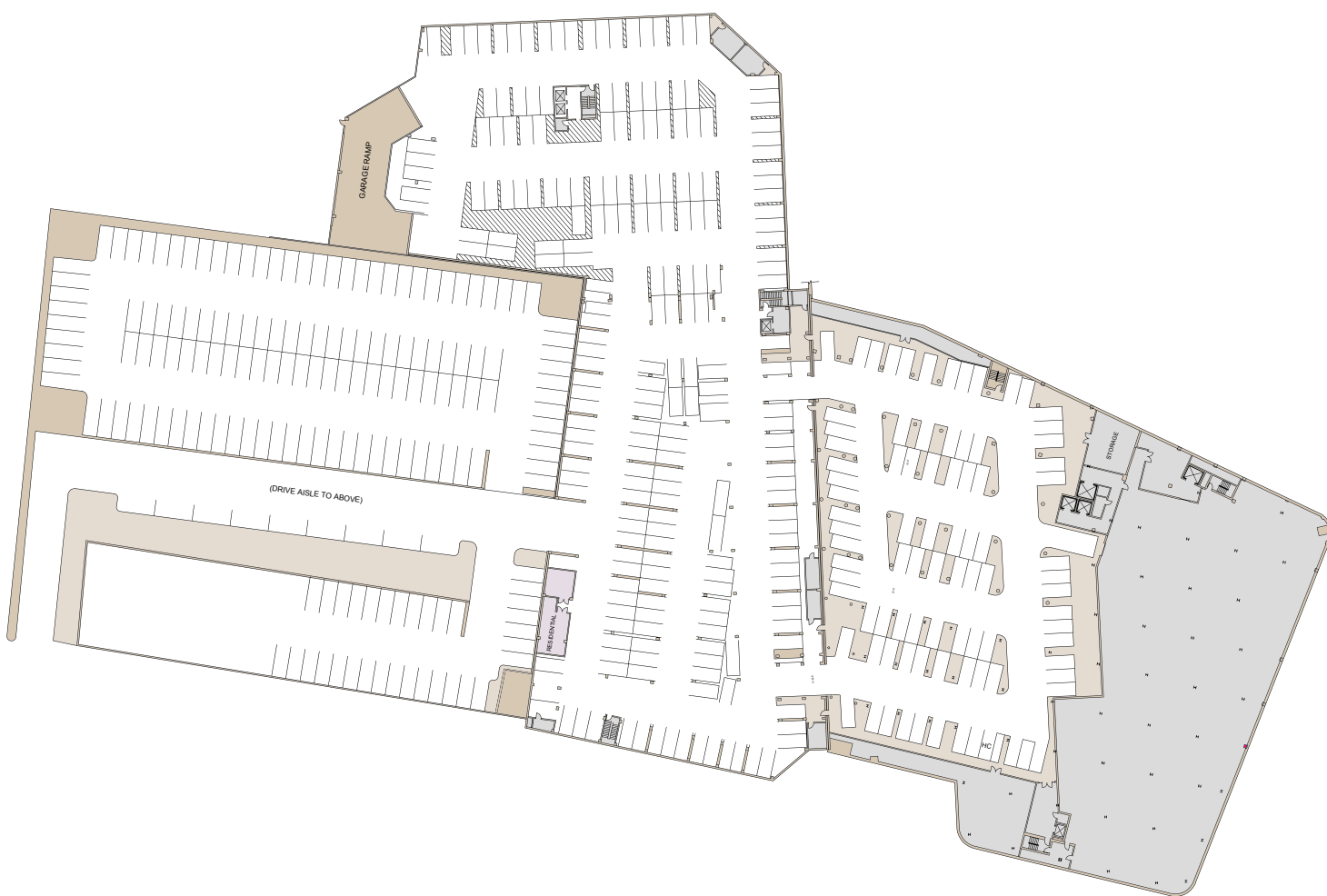

LOWER LEVEL RETAIL PARKING



317-577-5600 kiterealty.com

KRG
LISTED
NYSE