

CIRCLE EAST

1 E. Joppa Road | Towson, MD 21286



Circle East

MSA: Baltimore, MD | GLA: 220,769

Transformative multi-phase mixed-use development in heart of downtown Towson, MD. The project features popular sit-down restaurants, fast-casual eateries, boutiques, and entertainment venues. Circle East also features the 371-unit luxury apartment development, Avalon Towson. Circle East is anchored by Urban Outfitters, Ethan Allen, and Shake Shack.

3 MILE DEMOGRAPHICS



POPULATION
116,873



% POP. GROWTH
(ANNUAL)
0.2%



AVG. HH INCOME
\$140,218



MED. HH INCOME
\$97,331



HOUSEHOLDS
46,253



BACH. DEGREE+
55.7%

**2025 Demographic Source (PopStats)*

LEASING CONTACT - Greg Goldberg - ggoldberg@kiterealty.com - 410.246.5599



317-577-5600 kiterealty.com

KRG
LISTED
NYSE

CIRCLE EAST

1 E. Joppa Road | Towson, MD 21286



GROUND LEVEL RETAIL

CIRCLE EAST

1 E. Joppa Road | Towson, MD 21286

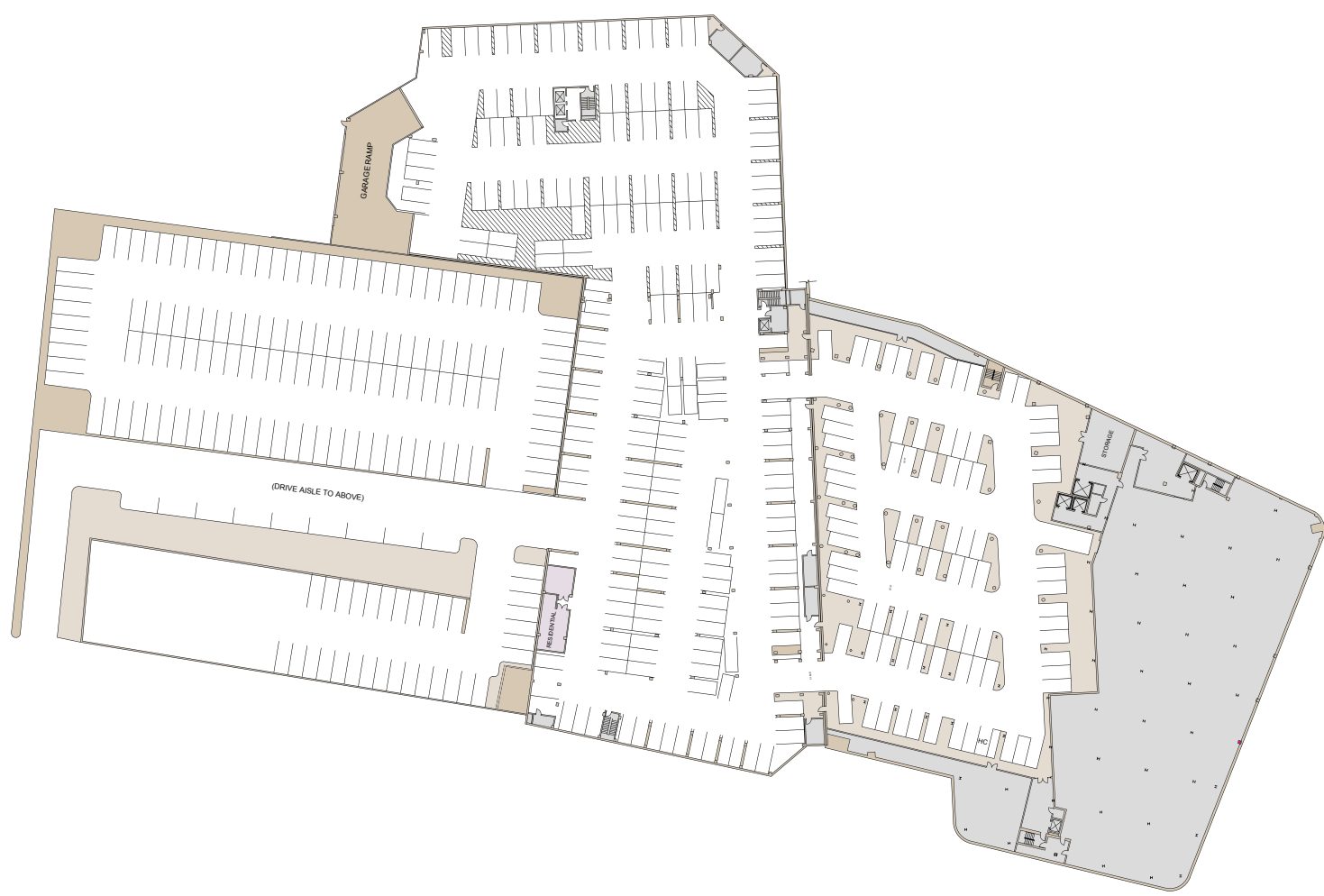

LOWER LEVEL RETAIL PARKING