

# KILLINGLY COMMONS

581 Hartford Pike | Dayville, CT 06241

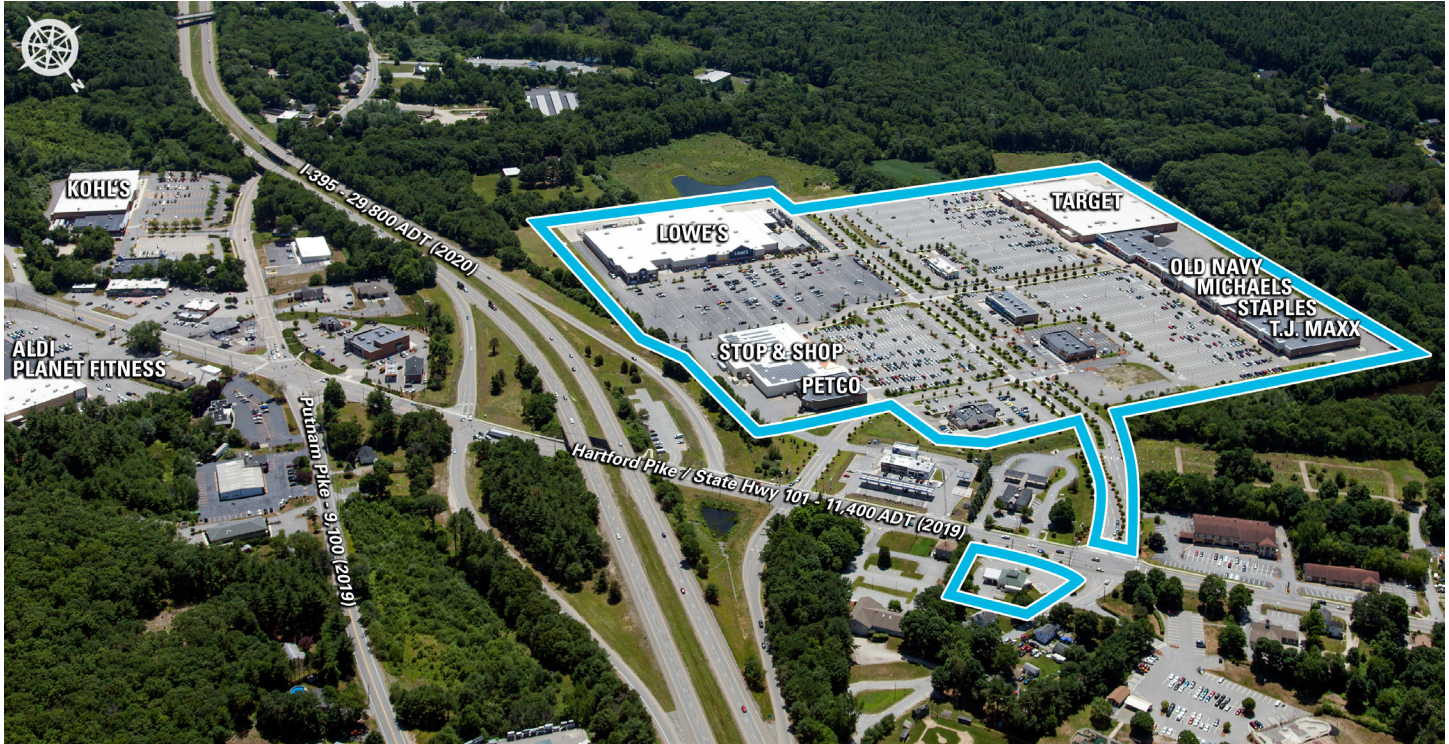

## Killingly Commons

MSA: Willimantic, CT | GLA: 205,619

Dominant regional shopping center featuring a comprehensive collection of national retailers. The center is situated along Interstate 395, northeast Connecticut's main north/south artery. Killingly Commons is anchored by Lowe's, Target, Michaels, Petco, Old Navy, Staples, Stop & Shop Supermarket, and T.J. Maxx.

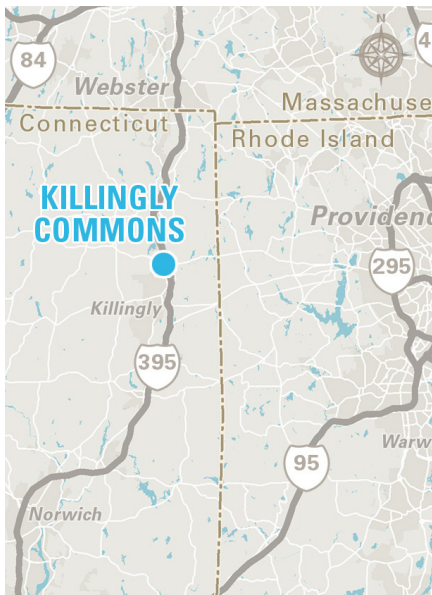

### 3 MILE DEMOGRAPHICS



POPULATION  
**14,779**



% POP. GROWTH  
(ANNUAL)  
**0.31%**



AVG. HH INCOME  
**\$80,446**



MED. HH INCOME  
**\$65,375**



HOUSEHOLDS  
**6,106**



BACH. DEGREE+  
**21.00%**

*\*2023 Demographic Source (PopStats)*

**LEASING CONTACT** - Tricia Mangum - [tmangum@kiterealty.com](mailto:tmangum@kiterealty.com) - 571.534.5043



317-577-5600 [kiterealty.com](http://kiterealty.com)

KRG  
LISTED  
NYSE

# KILLINGLY COMMONS

581 Hartford Pike | Dayville, CT 06241



317-577-5600 [kiterealty.com](http://kiterealty.com)

KRG  
LISTED  
NYSE