

EDDY STREET COMMONS AT NOTRE DAME

GLA: 87,987 SF

1234 Eddy Street, Suite 115
South Bend, IN 46637

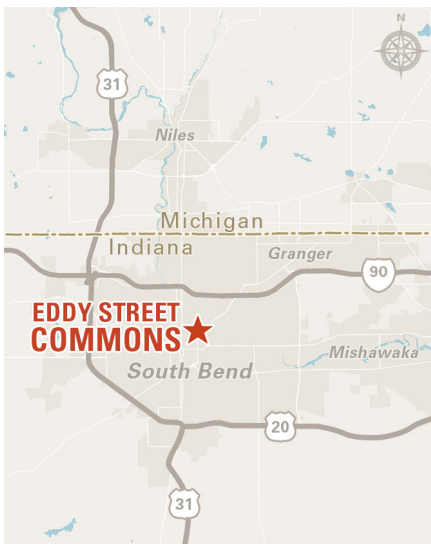

- Eddy Street Commons at Notre Dame is a mixed-use development adjacent to the University of Notre Dame in South Bend, Indiana. The project contains 90,000 SF of retail space, 82,000 SF of office space, and 470+ residential units including apartments.
- The University of Notre Dame has an enrollment of 12,393, while Holy Cross College and St. Mary's College have a combined enrollment of 2,110. Eddy Street Commons has roughly 14,500 students within walking distance (1-2 miles).
- The current stadium capacity is 80,795 and every game is a sell-out. There are 7 home games each season - 565,565 people per season. All within walking distance.

	3 Mile	5 Mile	7 Mile
2020 Estimated Population	93,039	178,893	229,081
2025 Projected Population	93,439	179,862	230,584
2020 Estimated Households	35,281	70,291	89,466
Average Household Income	\$56,880	\$61,822	\$68,126

LEASING CONTACT

Blake Beaver
bbeaver@kiterealty.com
317.713.5640

EDDY STREET COMMONS AT NOTRE DAME

GLA: 87,987 SF

1234 Eddy Street, Suite 115
South Bend, IN 46637



PHASE I
RETAIL/OFFICE &
RESIDENTIAL
RESIDENTIAL UNITS
252 RESIDENTIAL UNITS

PHASE II
RETAIL/RESIDENTIAL
RESIDENTIAL UNITS
452 RESIDENTIAL UNITS
7 TOWN HOMES

PHASE III
RETAIL/RESIDENTIAL
28 TOWN HOMES

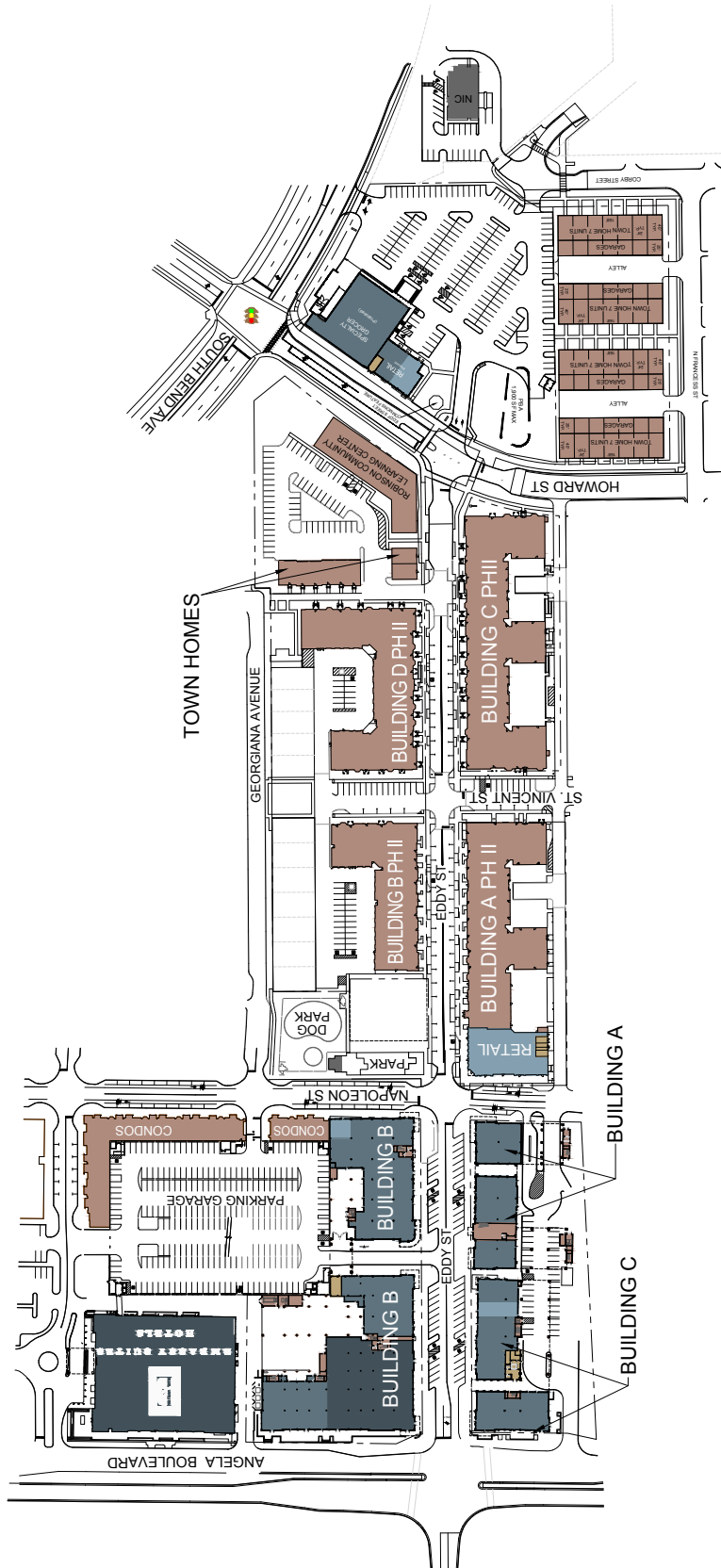

OVER ALL SITE PLAN PHASE I, II, & III
Scale: None

SHEET 1 OF 3

EDDY STREET COMMONS AT NOTRE DAME

GLA: 87,987 SF

1234 Eddy Street, Suite 115
South Bend, IN 46637

SHEET 2 OF 3

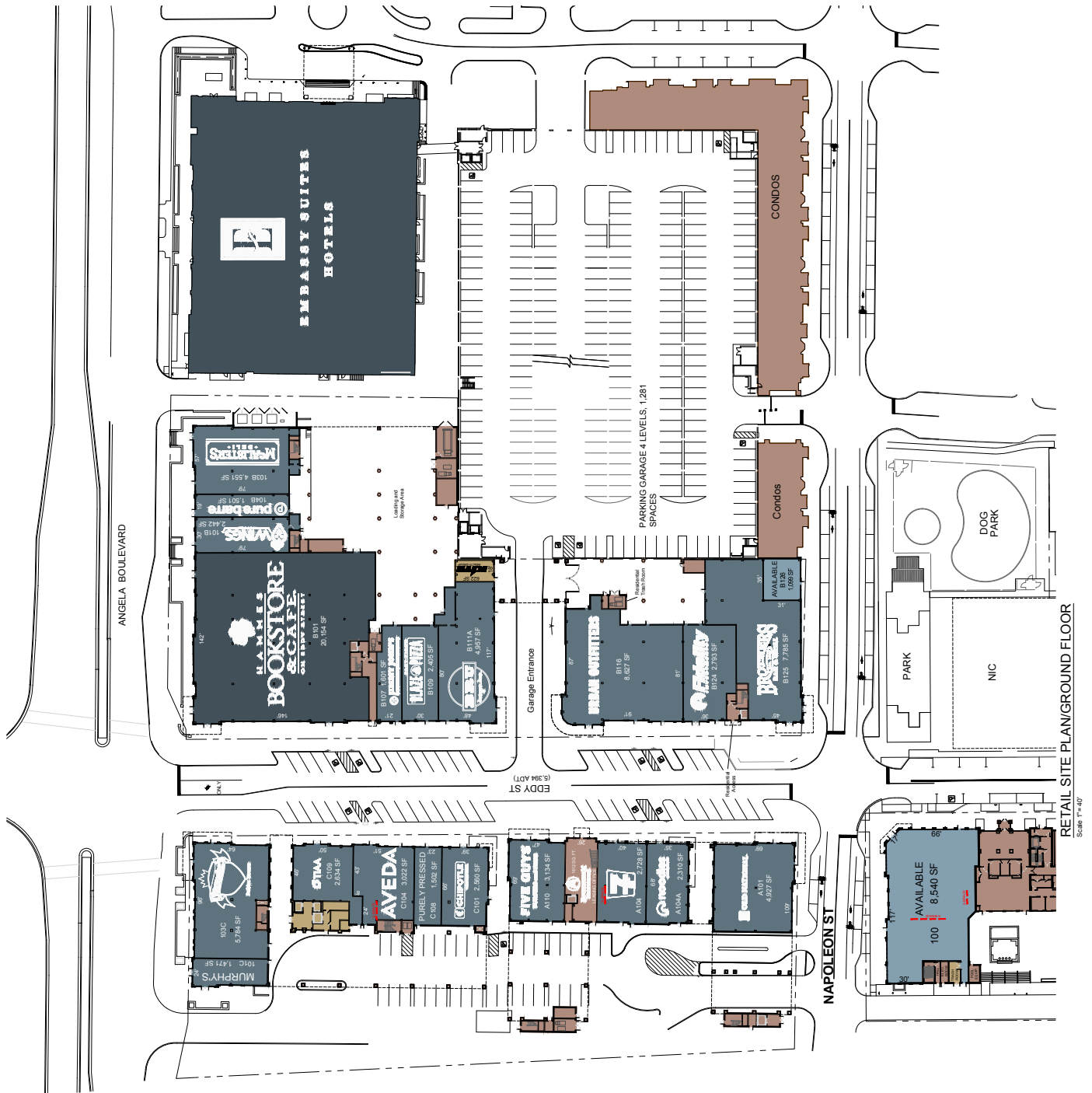

RETAIL SITE PLAN/GROUND FLOOR
SCALE 1" = 40'

EDDY STREET COMMONS AT NOTRE DAME

GLA: 87,987 SF

1234 Eddy Street, Suite 115
South Bend, IN 46637

SHEET 3 OF 3



RETAIL SITE PLAN PHASE III
Scale 1"=40'