

# ESTERO TOWN COMMONS

10011 Estero Town Commons Drive | Estero, FL 33928



## Estero Town Commons

MSA: Fort Myers, FL | GLA: 25,708

Market-dominant home improvement anchored center in the affluent beach community of Estero, FL. The center is supported by strong demographics and is visible from Interstate 75. Estero is between Fort Myers and Naples, two of the fastest growing cities in the country. Estero Town Commons is anchored by Lowe's.

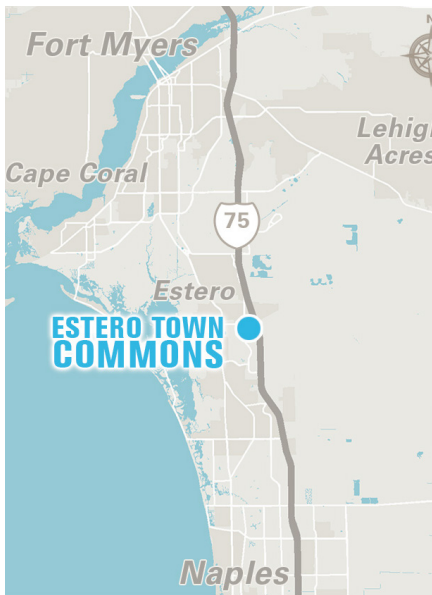

### 3 MILE DEMOGRAPHICS



POPULATION  
**46,803**



% POP. GROWTH  
(ANNUAL)  
**1.2%**



AVG. HH INCOME  
**\$142,262**



MED. HH INCOME  
**\$107,749**



HOUSEHOLDS  
**20,517**



BACH. DEGREE+  
**44.7%**

*\*2025 Demographic Source (PopStats)*

**LEASING CONTACT** - Ryan Joyce - rjoyce@kiterealty.com - 407.563.0101



317-577-5600 [kiterealty.com](http://kiterealty.com)

KRG  
LISTED  
NYSE

# ESTERO TOWN COMMONS

10011 Estero Town Commons Drive | Estero, FL 33928

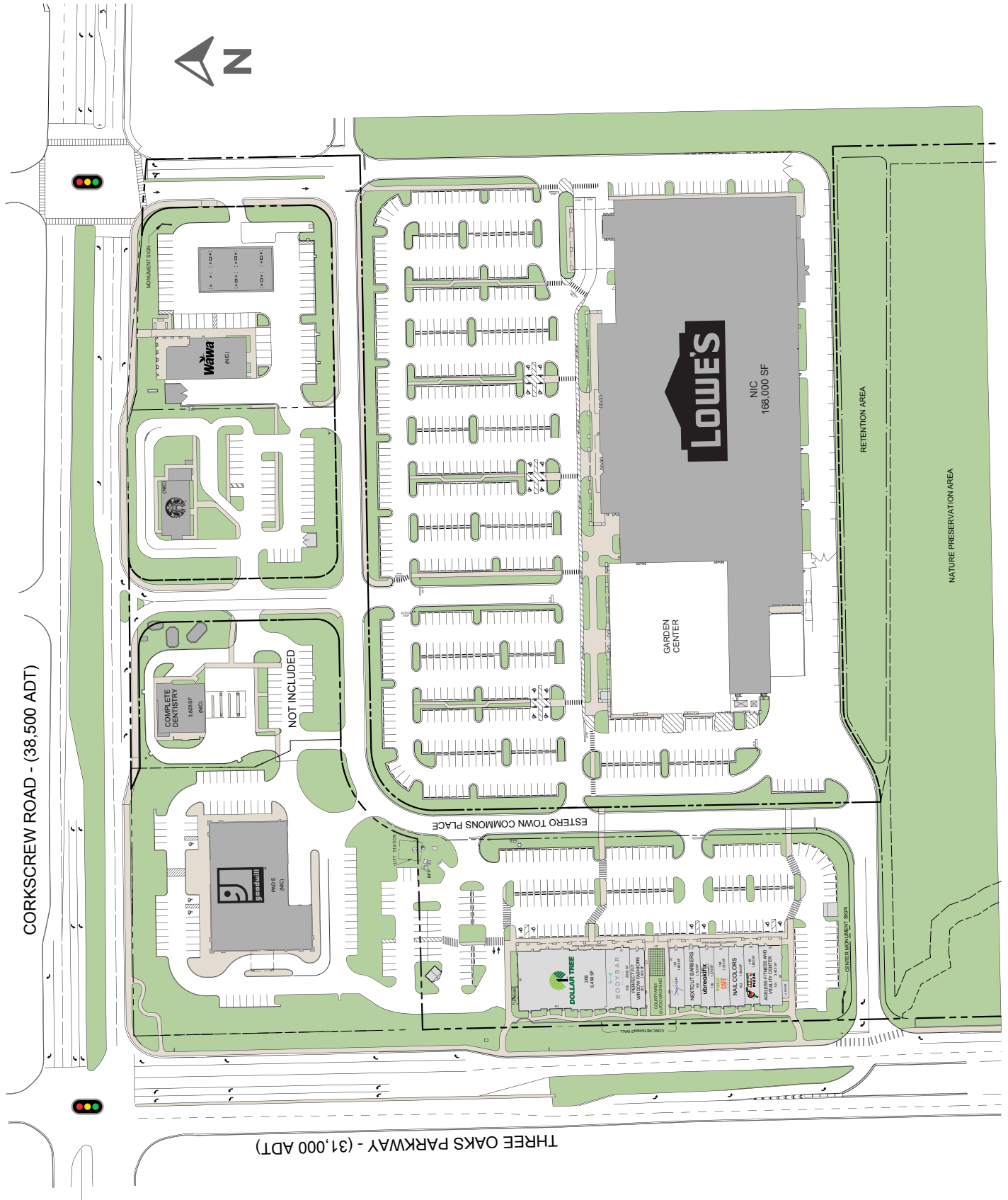

317-577-5600 [kiterealty.com](http://kiterealty.com)

KRG  
LISTED  
NYSE