

# FISHERS STATION

7400 Fishers Station Drive | Fishers, IN 46038



## Fishers Station

MSA: Fishers, IN | GLA: 52,395

High-visibility community shopping center at one of the busiest intersections in Fishers, IN. The center has high parking ratios and entrances on both 116th Street and Allisonville Road, thereby providing customers with an uncompromising level of accessibility. Fishers Station has an excellent selection of restaurants, discount retailers, and beauty-service providers.

### 3 MILE DEMOGRAPHICS

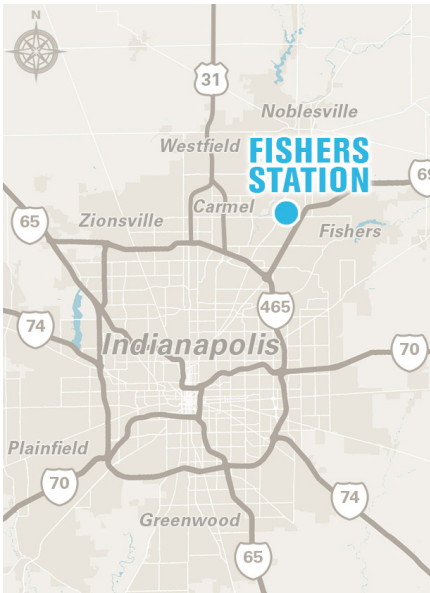

POPULATION  
**61,474**



MED. HOME VALUE  
**\$362,652**



AVG. HH INCOME  
**\$120,671**



MED. HH INCOME  
**\$95,368**



HOUSEHOLDS  
**24,785**



BACH. DEGREE+  
**63.55%**

*\*2023 Demographic Source (PopStats)*

**LEASING CONTACT** - Blake Beaver - [bbeaver@kiterealty.com](mailto:bbeaver@kiterealty.com) - 317.713.5640



317-577-5600 [kiterealty.com](http://kiterealty.com)

KRG  
LISTED  
NYSE

# FISHERS STATION

7400 Fishers Station Drive | Fishers, IN 46038

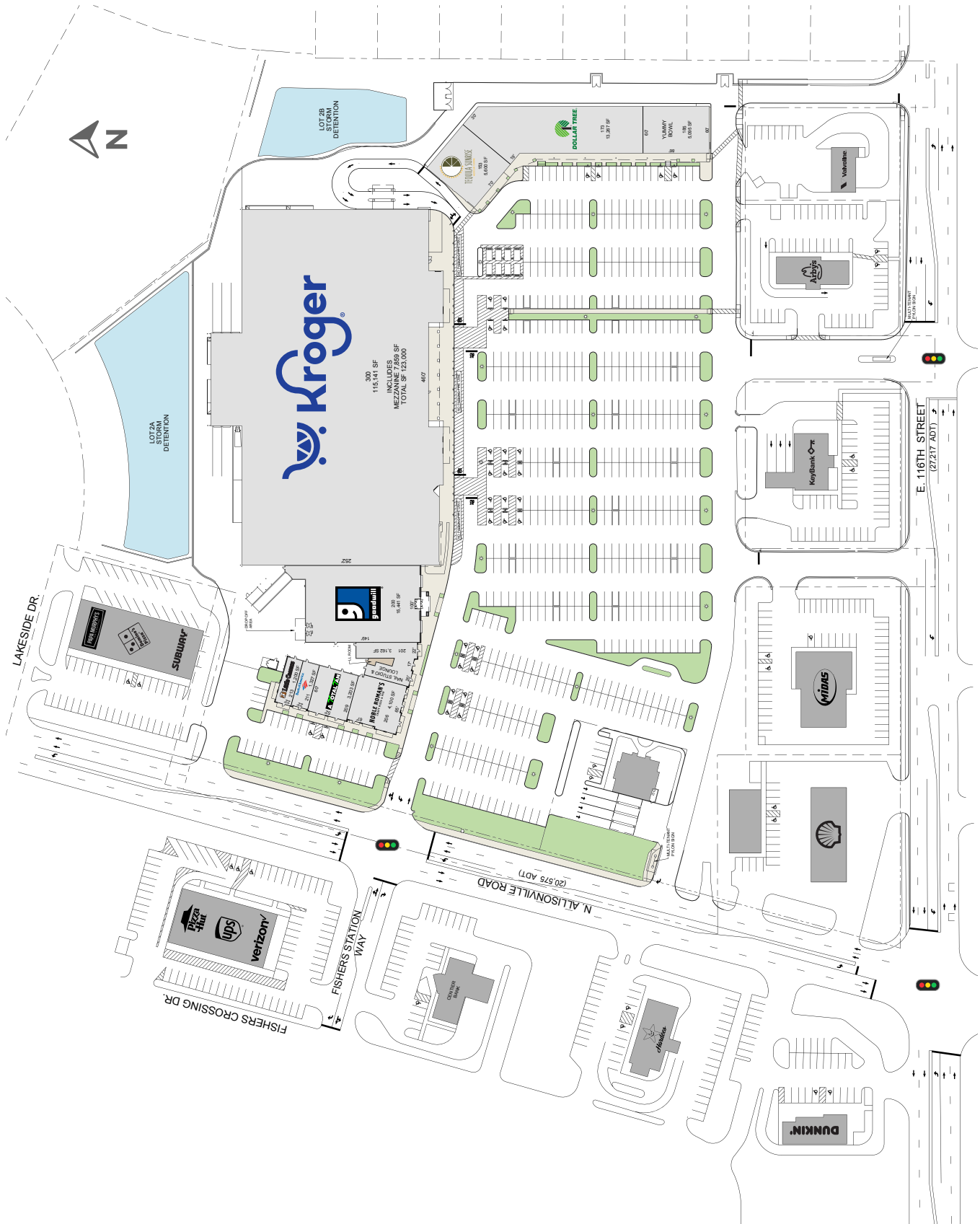

317-577-5600 [kiterealty.com](http://kiterealty.com)

KRG  
LISTED  
NYSE