

GREYHOUND COMMONS

14598 Lowes Way | Carmel, IN 46032



Greyhound Commons

MSA: Carmel, IN

High-performing home improvement anchored center located in Carmel, one of the most exclusive suburban communities in the Indianapolis metro area. Excellent visibility from US-31 and Keystone Avenue. Recently completed improvements to the center allow for two-way traffic on Lowe's Parkway. Greyhound Commons is anchored by Lowe's and BJ's Wholesale Club.

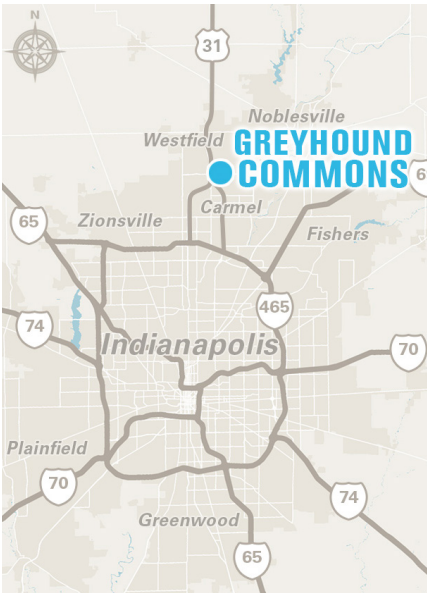

3 MILE DEMOGRAPHICS



POPULATION

76,498



% POP. GROWTH
(ANNUAL)

1.63%



AVG. HH INCOME

\$166,527



MED. HH INCOME

\$122,621



HOUSEHOLDS

29,386



BACH. DEGREE+

67.68%

**2024 Demographic Source (PopStats)*

LEASING CONTACT - Blake Beaver - bbeaver@kiterealty.com - 317.713.5640



317-577-5600 kiterealty.com

KRG
LISTED
NYSE

GREYHOUND COMMONS

14598 Lowes Way | Carmel, IN 46032

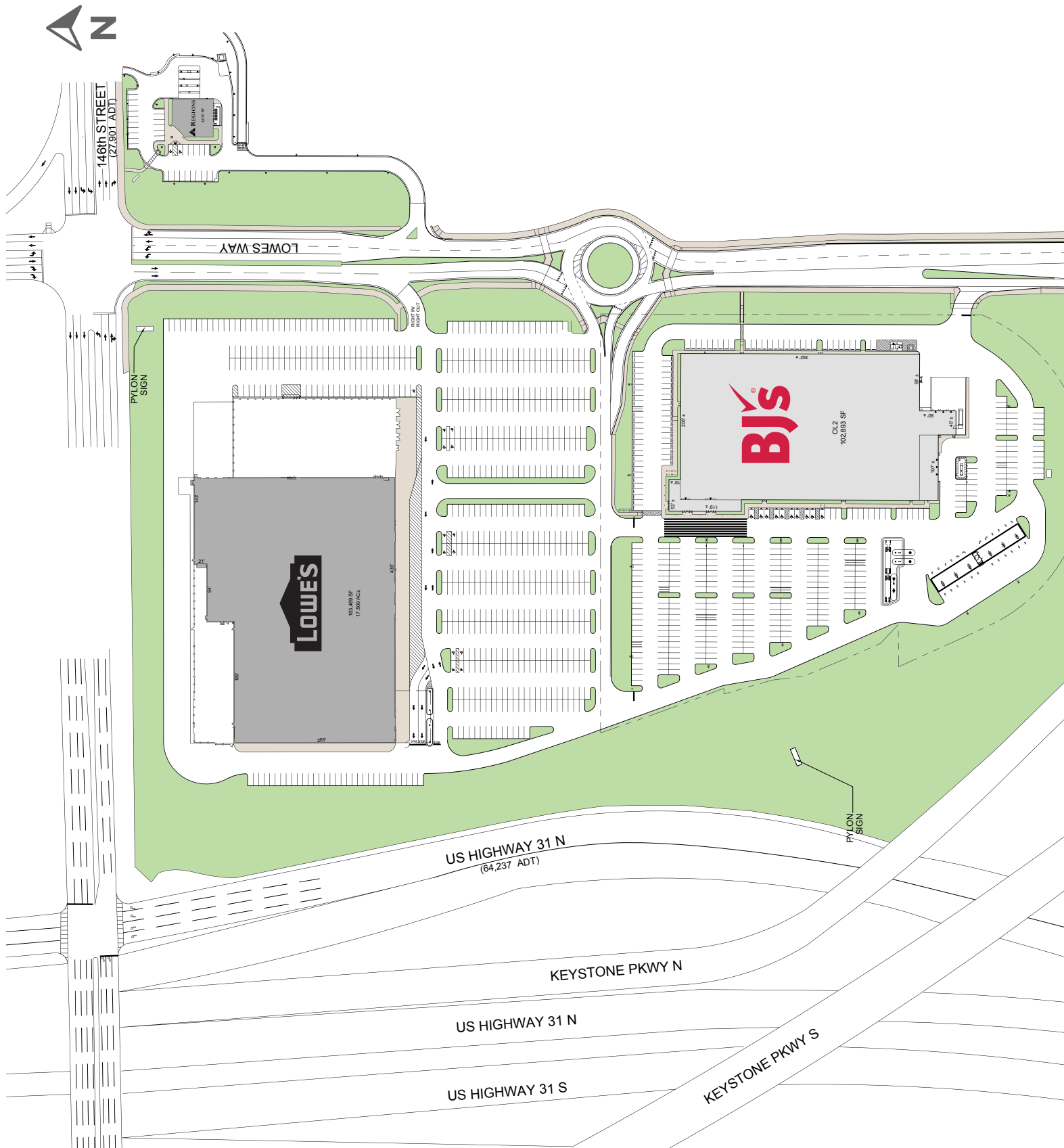

317-577-5600 kiterealty.com

KRG
LISTED
NYSE