

GURNEE TOWN CENTER

7105 Grand Avenue | Gurnee, IL 60031



Gurnee Town Center

MSA: Chicago, IL | GLA: 179,447

Regional shopping destination featuring a diverse selection of national retailers and restaurants. Located along Grand Ave., a high-traffic commercial artery connecting Gurnee's western suburbs to Interstate 94. Just minutes from Gurnee Mills and Six Flags Great America. Gurnee Town Center is anchored by Ross, DSW, and Binny's Beverage Depot.

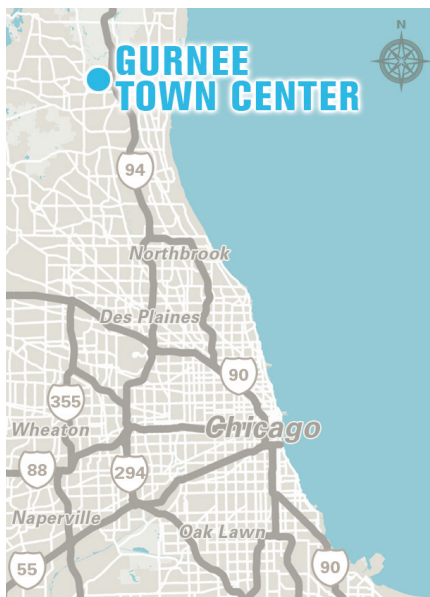

3 MILE DEMOGRAPHICS



POPULATION

41,648



% POP. GROWTH
(ANNUAL)

0.84%



AVG. HH INCOME

\$128,914



MED. HH INCOME

\$104,648



HOUSEHOLDS

14,875



BACH. DEGREE+

52.22%

**2020 Demographic Source (PopStats)*

LEASING CONTACT - Blake Beaver - bbeaver@kiterealty.com - 317.713.5640



317-577-5600 kiterealty.com



GURNEE TOWN CENTER

7105 Grand Avenue | Gurnee, IL 60031

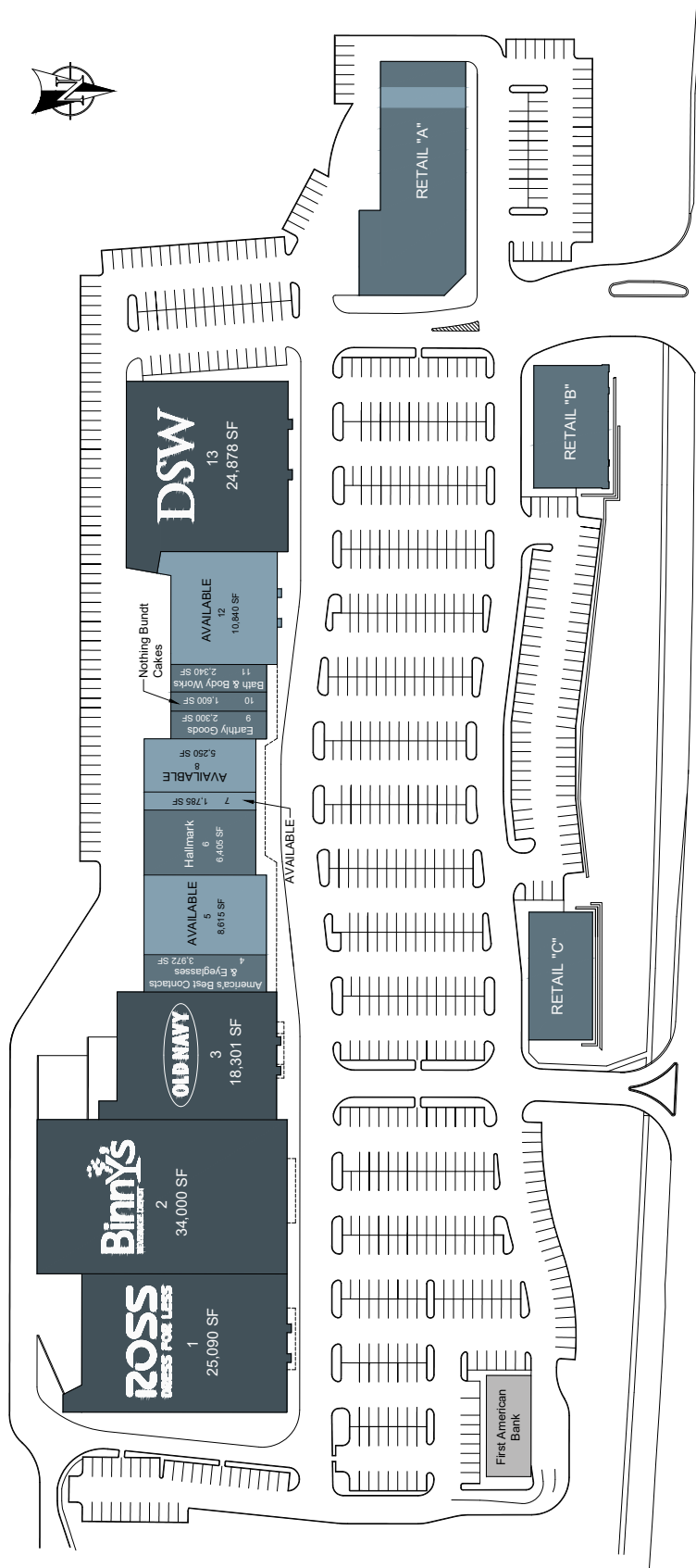

GRAND AVENUE (31,700 ADT)

OVERALL SITE PLAN
SCALE 1/8" = 1'-0"

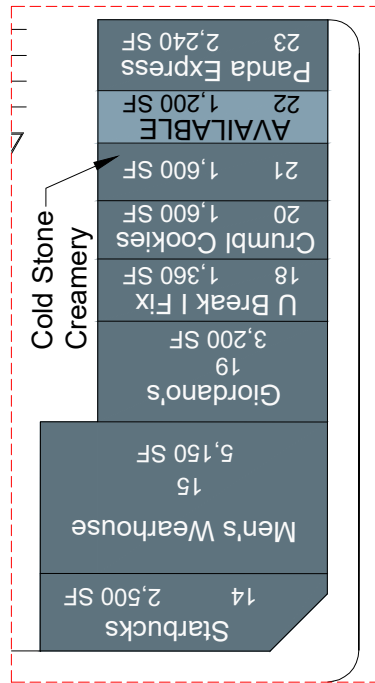

RETAIL "A"
SCALE 1/8" = 1'-0"

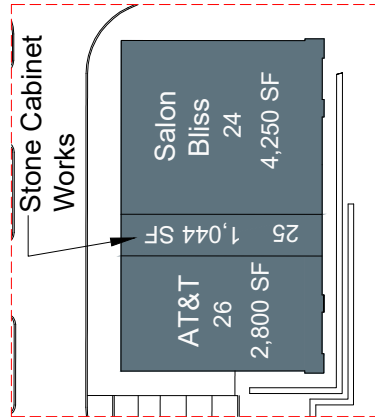

RETAIL "B"
SCALE 1/8" = 1'-0"

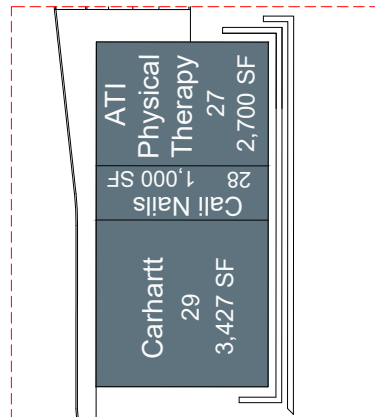

RETAIL "C"
SCALE 1/8" = 1'-0"



317-577-5600 kiterealty.com

