

LAKEWOOD TOWNE CENTER

5731 Main Street SW | Lakewood, WA 98499

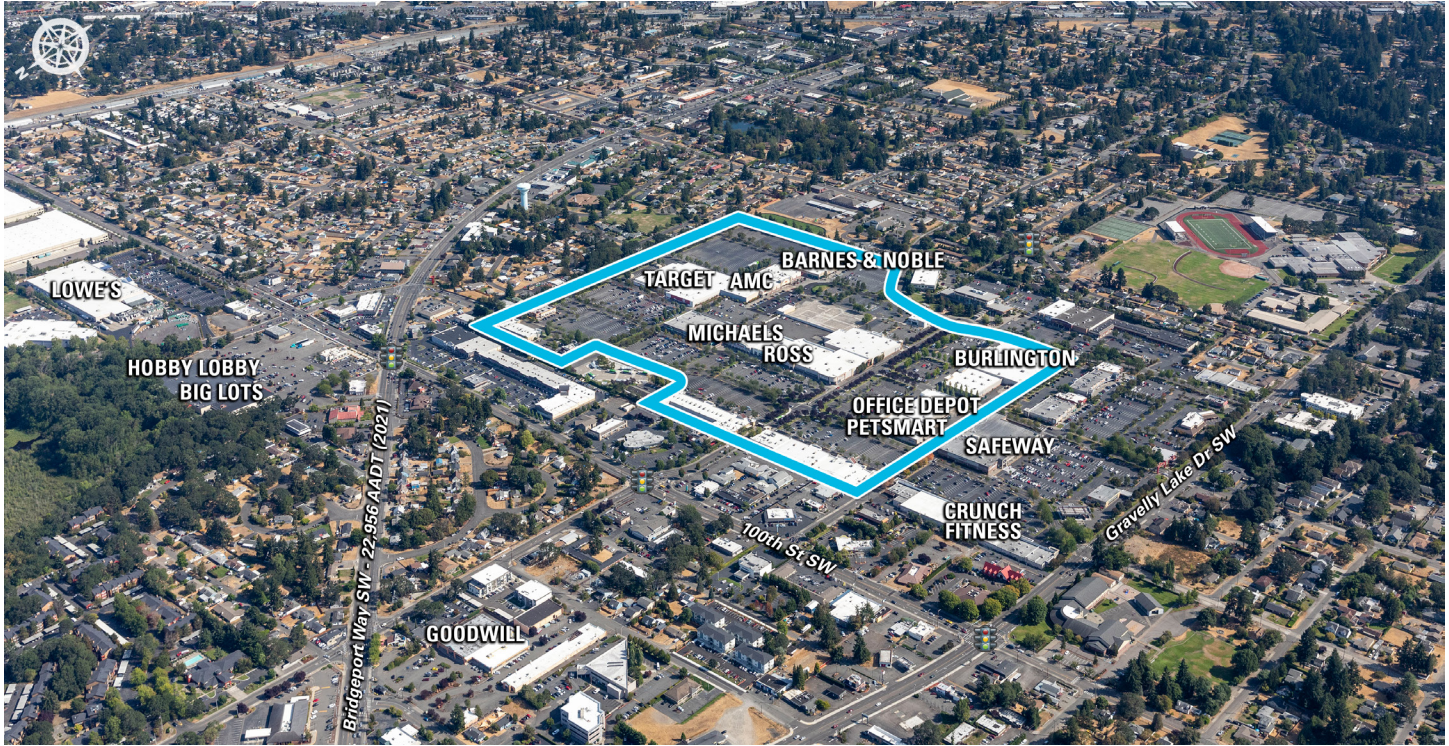

Lakewood Towne Center

MSA: Seattle, WA | GLA: 507,450

Dominant community center featuring an impressive collection of best-in-class big-box anchor tenants. Lakewood Towne Center is located 30 minutes north of Washington's capital, Olympia, and 50 minutes south of downtown Seattle. The center is just minutes from Joint Base Lewis-McChord the fourth largest military installation in the country employing 110k.



3 MILE DEMOGRAPHICS



POPULATION

93,791



MED. HOME VALUE

\$458,915



AVG. HH INCOME

\$75,415



MED. HH INCOME

\$59,570



HOUSEHOLDS

36,349



BACH. DEGREE+

22.40%

**2023 Demographic Source (PopStats)*

LEASING CONTACT - Katie Beason - kbeason@kiterealty.com - 253.319.5990



317-577-5600 kiterealty.com

KRG
LISTED
NYSE

