

LOWE'S PLAZA

6010-6090 West Craig Road
Las Vegas, NV 89130

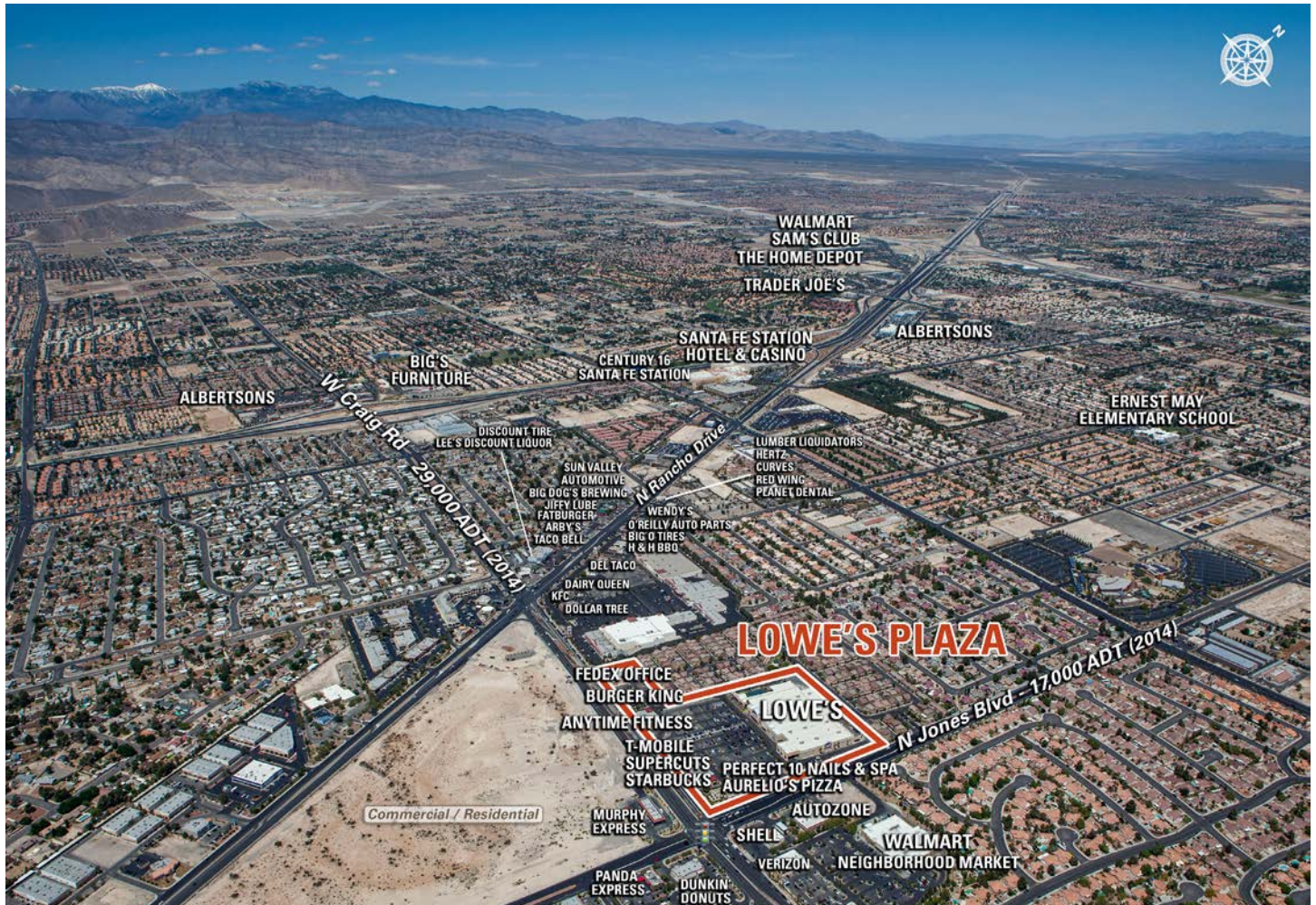

- Lowe's Plaza is located in the densely populated northwest side of Las Vegas, known as Centennial Hills. The center is 6.5 miles from downtown and 2.5 miles from the North Las Vegas Airport. The center is anchored by Lowe's, Starbucks, and Anytime Fitness.
- Centennial Hills is one of the fastest growing areas of Las Vegas. A new 9,000-home community is currently under construction just 4 miles northwest. Sky Canyon features homes priced from \$200k - \$600k.
- The city of Las Vegas has experienced a 73% increase in growth over the last 10 years bringing its current population to approximately 633,000. By the year 2020, the population is expected to increase to roughly 800,000 people.

	3 Mile	5 Mile	7 Mile
2017 Estimated Population	150,709	425,721	696,891
2022 Projected Population	156,029	445,051	733,486
2017 Estimated Households	54,231	149,634	244,626
Average Household Income	66,975	67,295	68,325

LEASING CONTACTS

Joshlyn Steele
jsteele@kiterealty.com
239.849.0861

Jeff Wright
jwright@kiterealty.com
317.713.5698

LOWE'S PLAZA

6010-6090 West Craig Road
Las Vegas, NV 89130

