

# MACARTHUR CROSSING

7640 MacArthur Boulevard | Irving, TX 75063



## MacArthur Crossing

MSA: Dallas/Fort Worth, TX | GLA: 165,649

Convenience-oriented neighborhood center in Irving, TX. The center is situated at the busy interchange between I-635 and George Bush Turnpike. Both interstates regularly see more than 100k vehicles per day. MacArthur Crossing is anchored by Total Wine & More, Sprouts, and features retailers across every category making it a one-stop-shop for local residents.

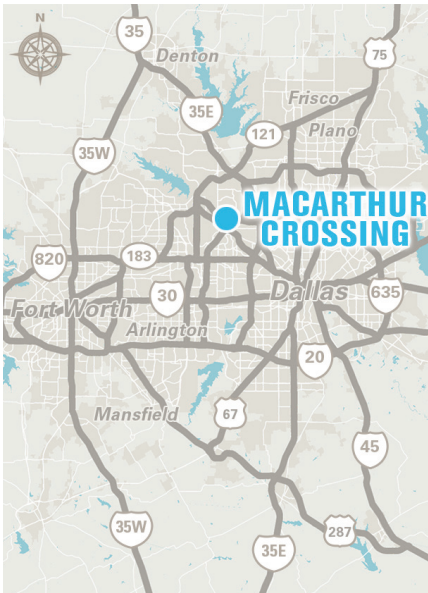

### 3 MILE DEMOGRAPHICS



POPULATION  
**80,002**



% POP. GROWTH  
(ANNUAL)  
**0.89%**



AVG. HH INCOME  
**\$142,578**



MED. HH INCOME  
**\$113,137**



HOUSEHOLDS  
**33,611**



BACH. DEGREE+  
**71.84%**

*\*2024 Demographic Source (PopStats)*

**LEASING CONTACT** - Tom Peck - [tpeck@kiterealty.com](mailto:tpeck@kiterealty.com) - 972.801.6022



317-577-5600 [kiterealty.com](http://kiterealty.com)

KRG  
LISTED  
NYSE



7640 MacArthur Boulevard | Irving, TX 75063

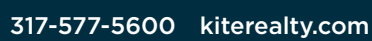
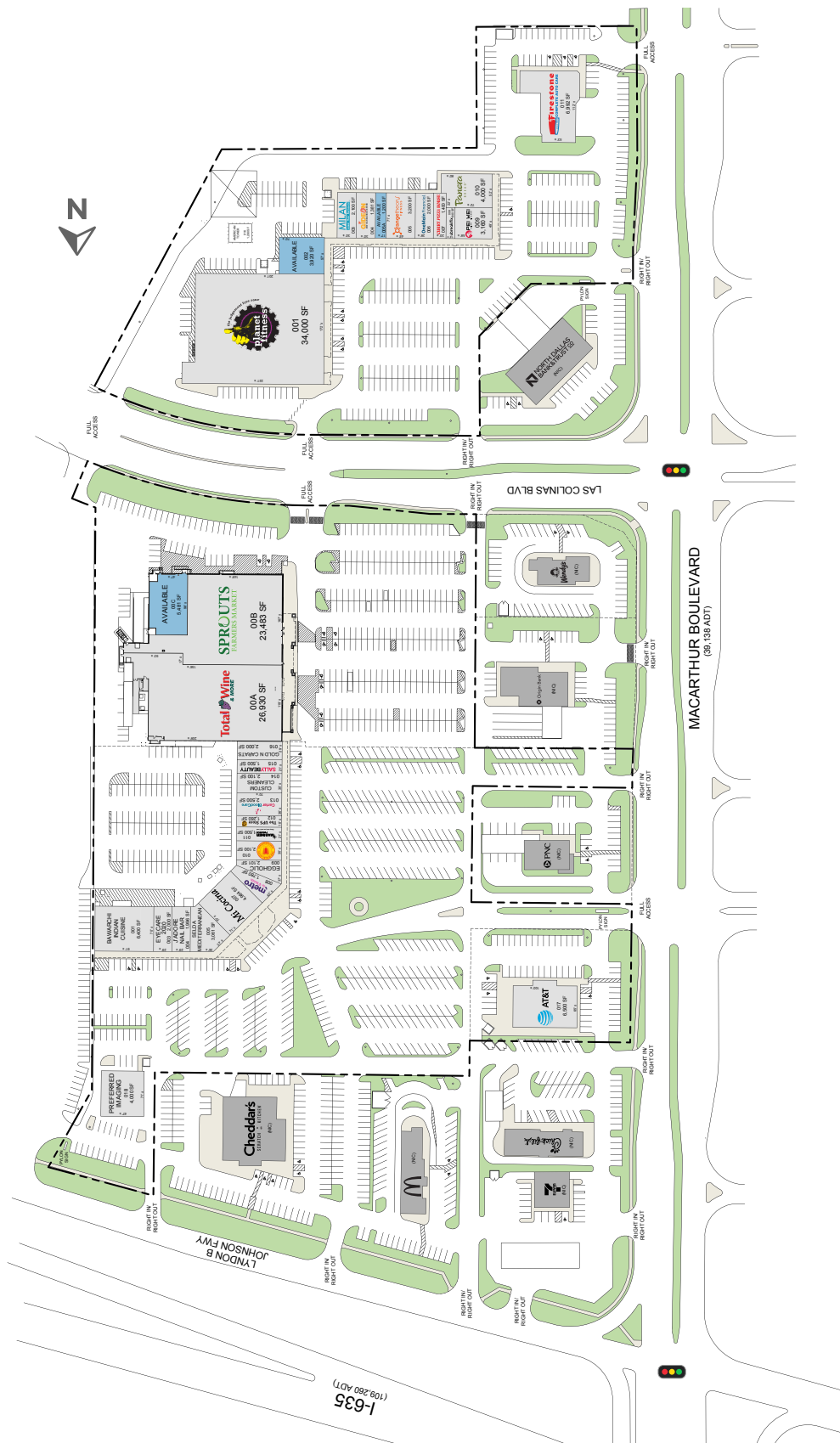

**KRG**  
**LISTED**  
**NYSE**