

MAIN STREET PROMENADE

55 S. Main Street | Naperville, IL 60540



Main Street Promenade

MSA: Chicago, IL | GLA: 181,759

Upscale mixed-use development in heart of ultra-affluent suburban community of Naperville, IL. Multi-phase project featuring exclusive retail brands, dining, office space, and future luxury residences. Main Street Promenade tenants include Lululemon, Anthropologie, Sur La Table, J.Jill, and Evereve.



3 MILE DEMOGRAPHICS



POPULATION

90,630



% POP. GROWTH
(ANNUAL)

0.21%



AVG. HH INCOME

\$137,939



MED. HH INCOME

\$107,701



HOUSEHOLDS

34,116



BACH. DEGREE+

64.23%

**2020 Demographic Source (PopStats)*

LEASING CONTACT - Greg Goldberg - ggoldberg@kiterealty.com - 410.246.5599



317-577-5600 kiterealty.com

KRG
LISTED
NYSE

MAIN STREET PROMENADE

55 S. Main Street | Naperville, IL 60540

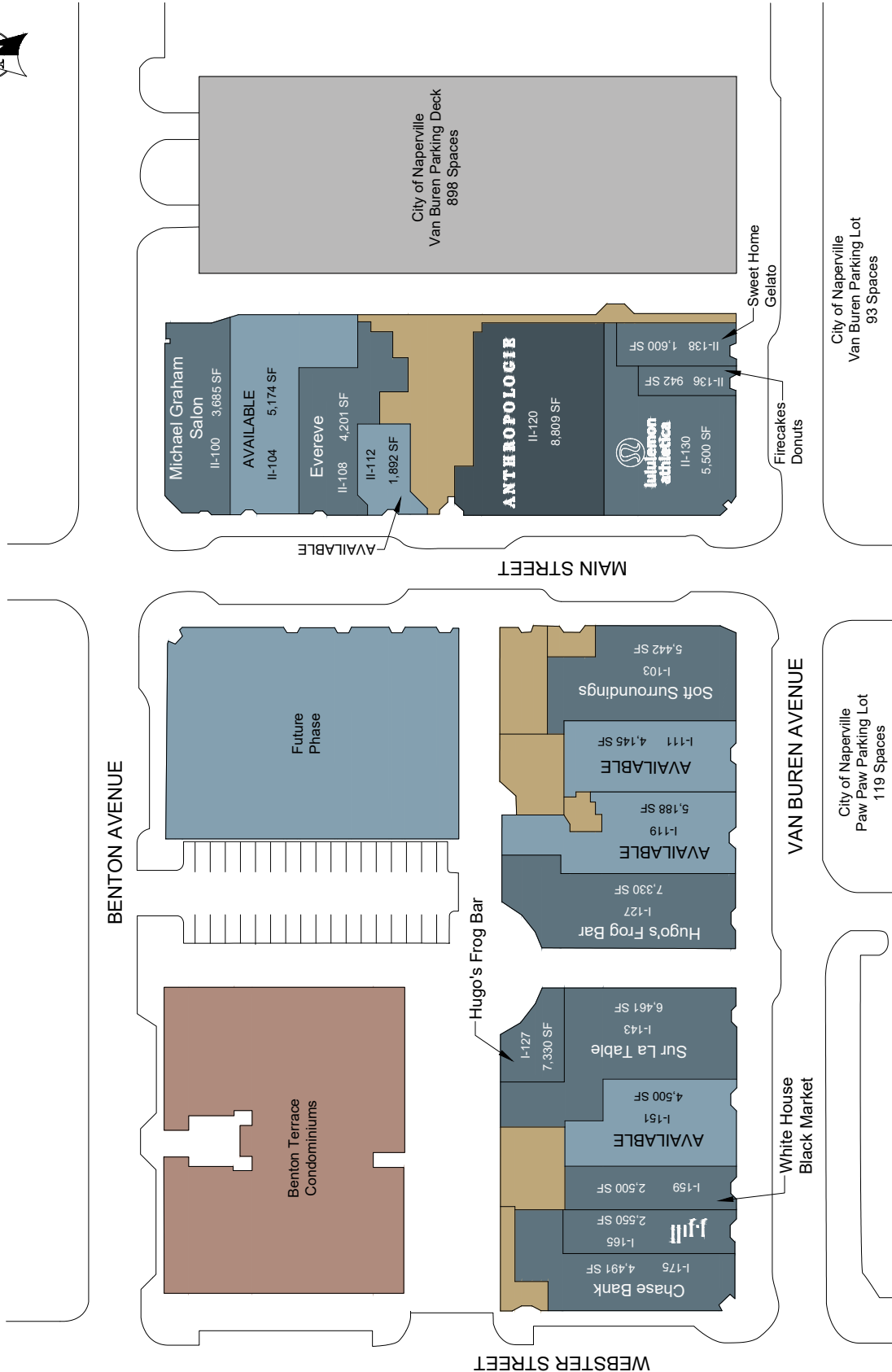

317-577-5600 kiterealty.com

