

# MIRAMAR SQUARE

12100 Miramar Parkway | Miramar, FL 33025



## Miramar Square

MSA: Miami, FL | GLA: 135,534

Specialty-grocer anchored community shopping destination situated in the high-density south Florida community of Miramar. There are several commercial and residential development projects underway in proximity to center. Miramar Square is anchored by Sprouts and Kohl's+Sephora.

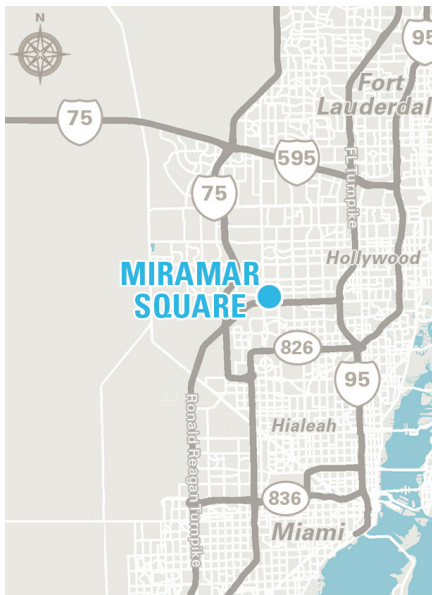

### 3 MILE DEMOGRAPHICS



POPULATION  
**180,393**



% POP. GROWTH  
(ANNUAL)  
**0.14%**



AVG. HH INCOME  
**\$73,875**



MED. HH INCOME  
**\$60,334**



HOUSEHOLDS  
**64,548**



BACH. DEGREE+  
**26.45%**

*\*2023 Demographic Source (PopStats)*

**LEASING CONTACT** - Brian Hector - [bhector@kiterealty.com](mailto:bhector@kiterealty.com) - 407.563.0110



317-577-5600 [kiterealty.com](http://kiterealty.com)



# MIRAMAR SQUARE

12100 Miramar Parkway | Miramar, FL 33025

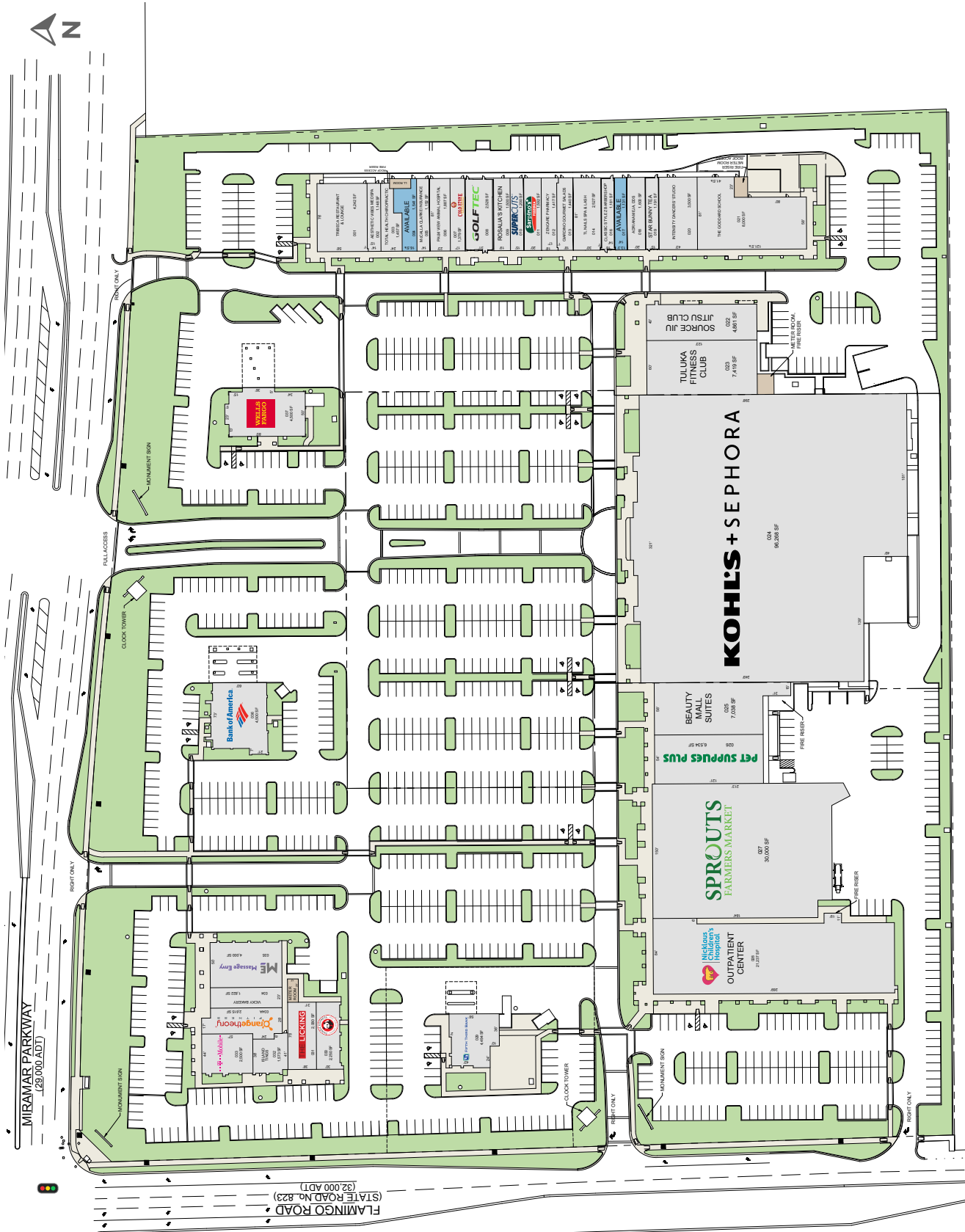

317-577-5600 [kiterealty.com](http://kiterealty.com)

