

NAPERVILLE MARKETPLACE

3101 - 3111 - 111th Street | Naperville, IL 60564



Naperville Marketplace

MSA: Chicago, IL | GLA: 83,759

Specialty-grocer anchored community center in one of Chicago's most affluent suburban areas. The center is supported by customers with strong demographics and is a popular destination for young highly-educated households looking to resettle outside Chicago. Naperville Marketplace is anchored by Caputo's Fresh Market, T.J. Maxx, and PetSmart.

3 MILE DEMOGRAPHICS

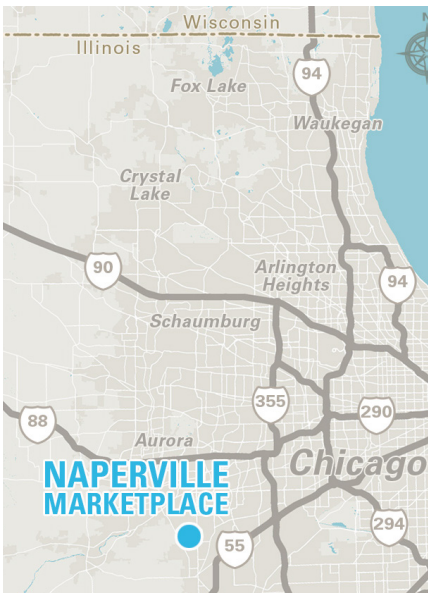

POPULATION

64,142



% POP. GROWTH
(ANNUAL)

2.25%



AVG. HH INCOME

\$164,782



MED. HH INCOME

\$139,194



HOUSEHOLDS

19,162



BACH. DEGREE+

65.82%

**2020 Demographic Source (PopStats)*

LEASING CONTACT - Connor Stader - cstader@kiterealty.com - 317.713.5672



317-577-5600 kiterealty.com

KRG
LISTED
NYSE

NAPERVILLE MARKETPLACE

3101 - 3111 - 111th Street | Naperville, IL 60564

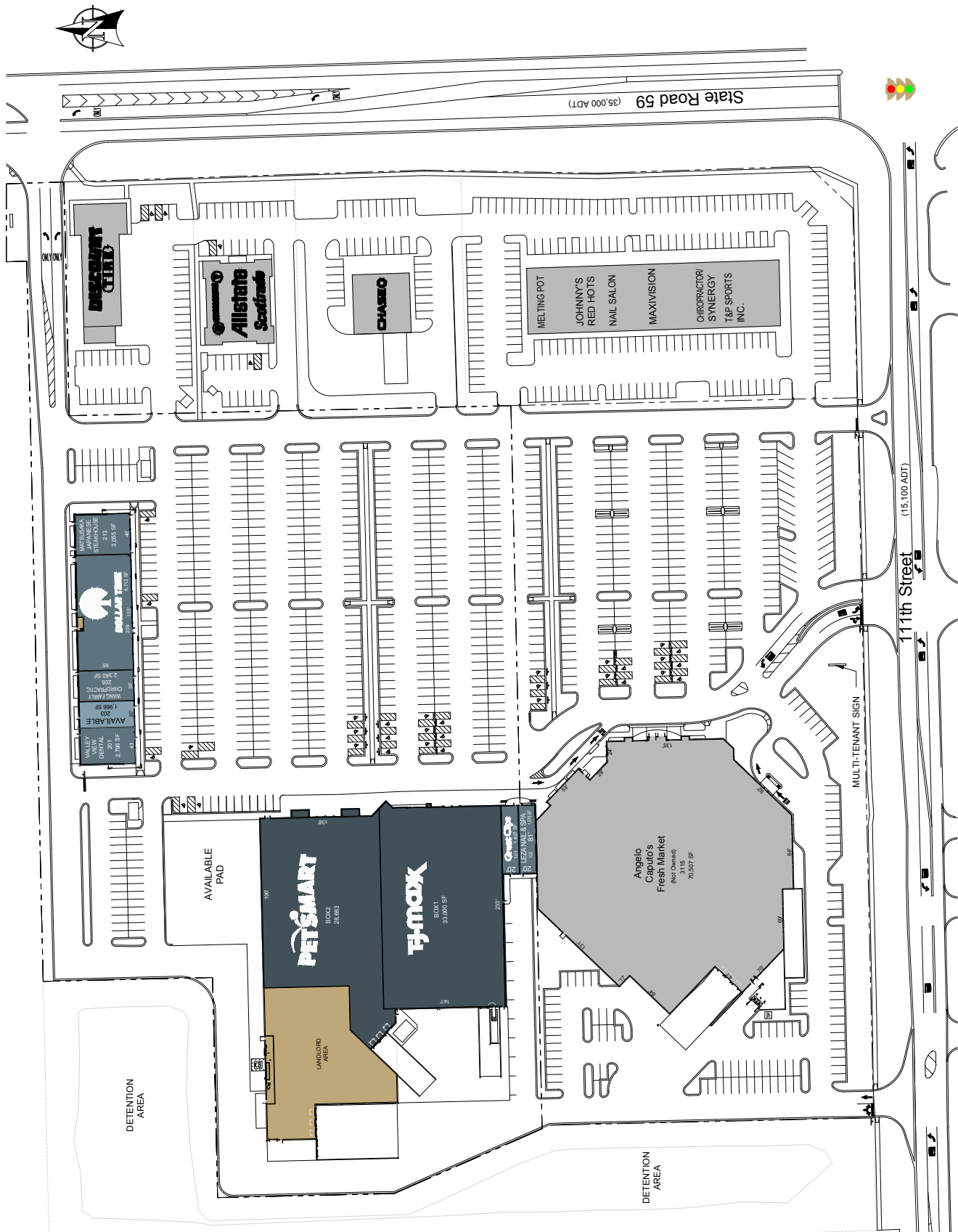

317-577-5600 kiterealty.com

KRG
LISTED
NYSE