

PERIMETER WOODS

10125-10275 Perimeter Parkway | Charlotte, NC 28216



Perimeter Woods

MSA: Charlotte, NC | GLA: 125,579

High-visibility shopping center located across the street from Northlake Mall in Charlotte, NC. Immediate access to both Interstate 485 and Interstate 77. Perimeter Woods is anchored by Best Buy, PetSmart, and Michaels.



3 MILE DEMOGRAPHICS



POPULATION

42,359



% POP. GROWTH
(ANNUAL)

1.36%



AVG. HH INCOME

\$79,522



MED. HH INCOME

\$62,956



HOUSEHOLDS

16,172



BACH. DEGREE+

41.04%

**2021 Demographic Source (PopStats)*

LEASING CONTACT - Blake Beaver - bbeaver@kiterealty.com - 317.713.5640



317-577-5600 kiterealty.com

KRG
LISTED
NYSE

PERIMETER WOODS

10125-10275 Perimeter Parkway | Charlotte, NC 28216

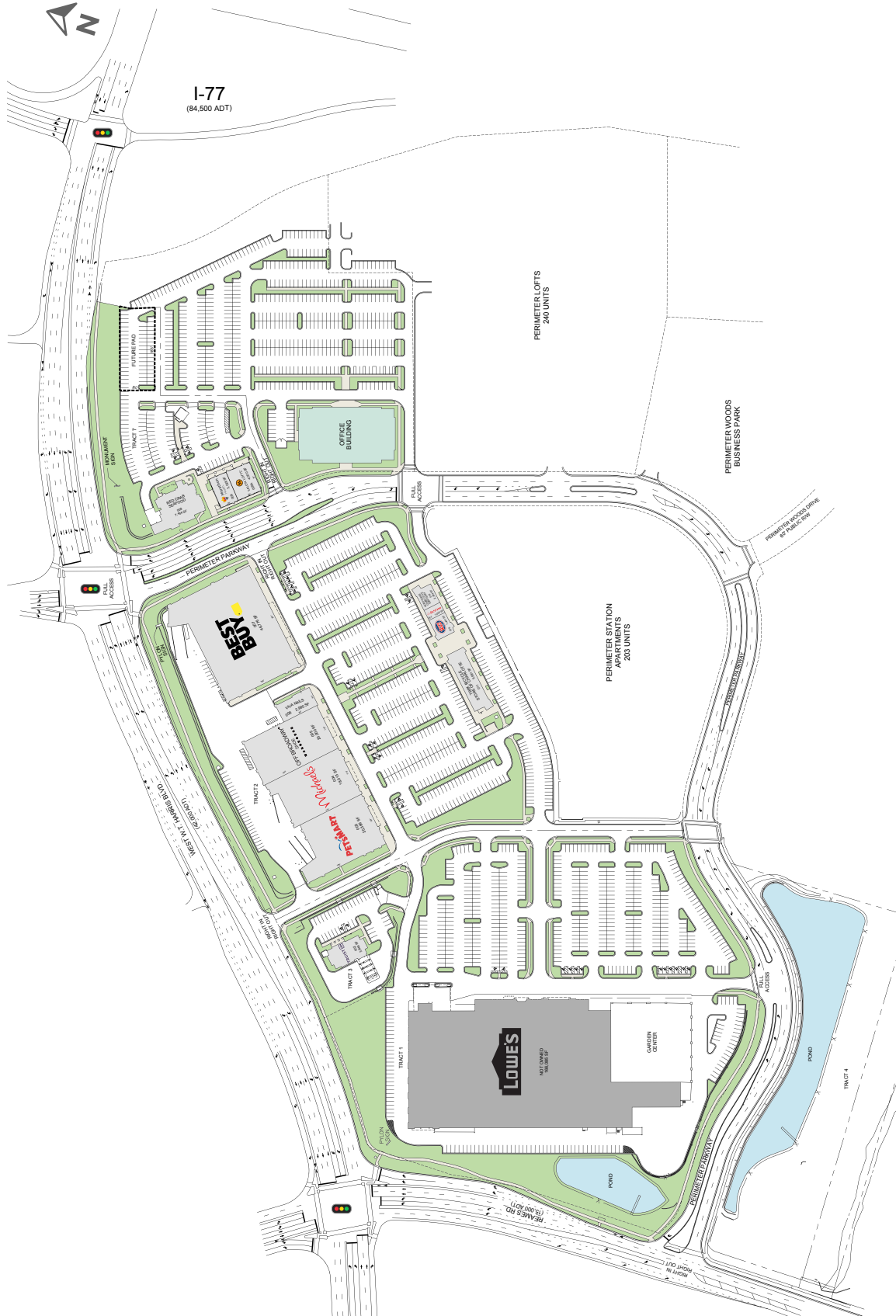

317-577-5600 kiterealty.com

KRG
LISTED
NYSE