

# PERIMETER WOODS

10125-10275 Perimeter Parkway | Charlotte, NC 28216

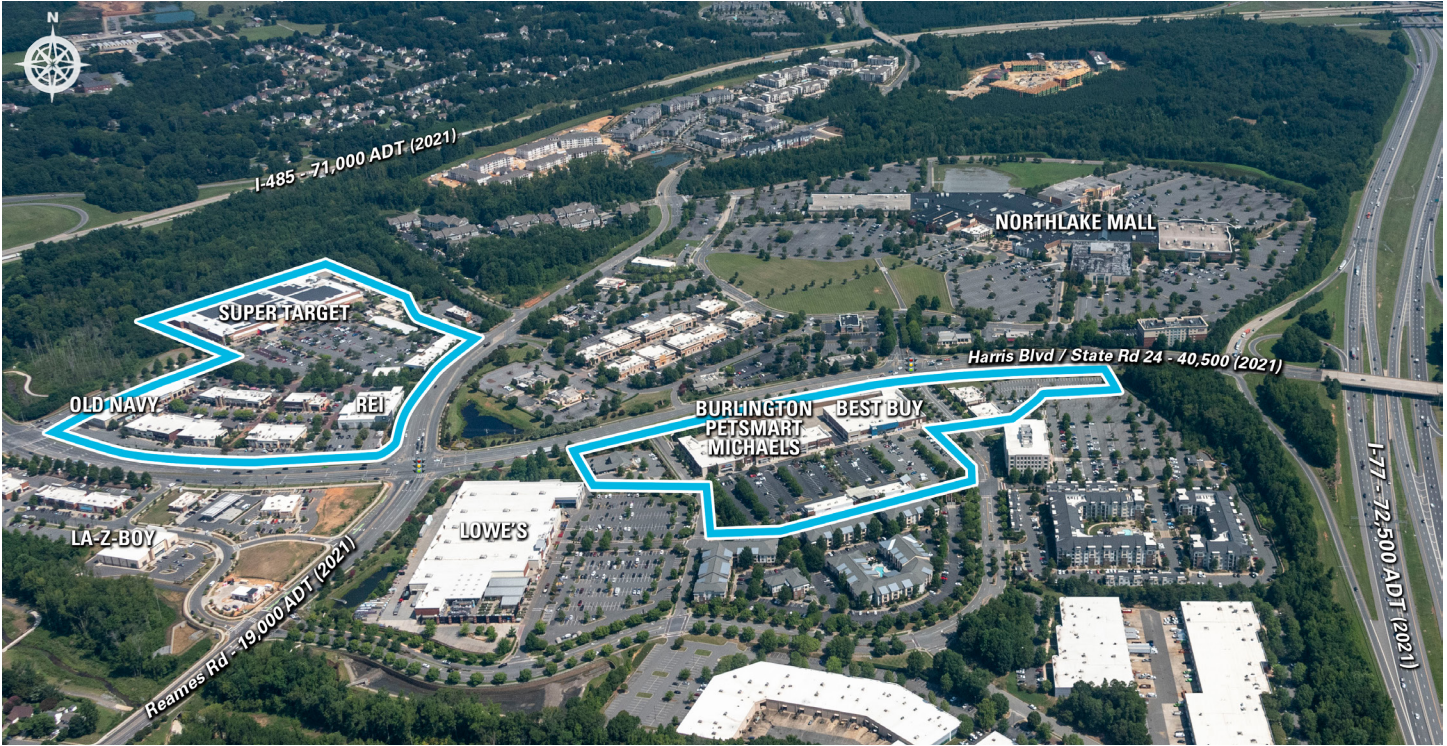

## Perimeter Woods

MSA: Charlotte, NC | GLA: 127,067

High-visibility shopping center located across the street from Northlake Mall in Charlotte, NC. Immediate access to both Interstate 485 and Interstate 77. Perimeter Woods is anchored by Best Buy, PetSmart, Burlington, and Michaels.



### 3 MILE DEMOGRAPHICS



POPULATION  
**47,511**



% POP. GROWTH  
(ANNUAL)  
**1.20%**



AVG. HH INCOME  
**\$93,029**



MED. HH INCOME  
**\$75,505**



HOUSEHOLDS  
**18,280**



BACH. DEGREE+  
**44.93%**

*\*2024 Demographic Source (PopStats)*

**LEASING CONTACT** - Blake Beaver - [bbeaver@kiterealty.com](mailto:bbeaver@kiterealty.com) - 317.713.5640



317-577-5600 [kiterealty.com](http://kiterealty.com)

KRG  
LISTED  
NYSE

# PERIMETER WOODS

10125-10275 Perimeter Parkway | Charlotte, NC 28216

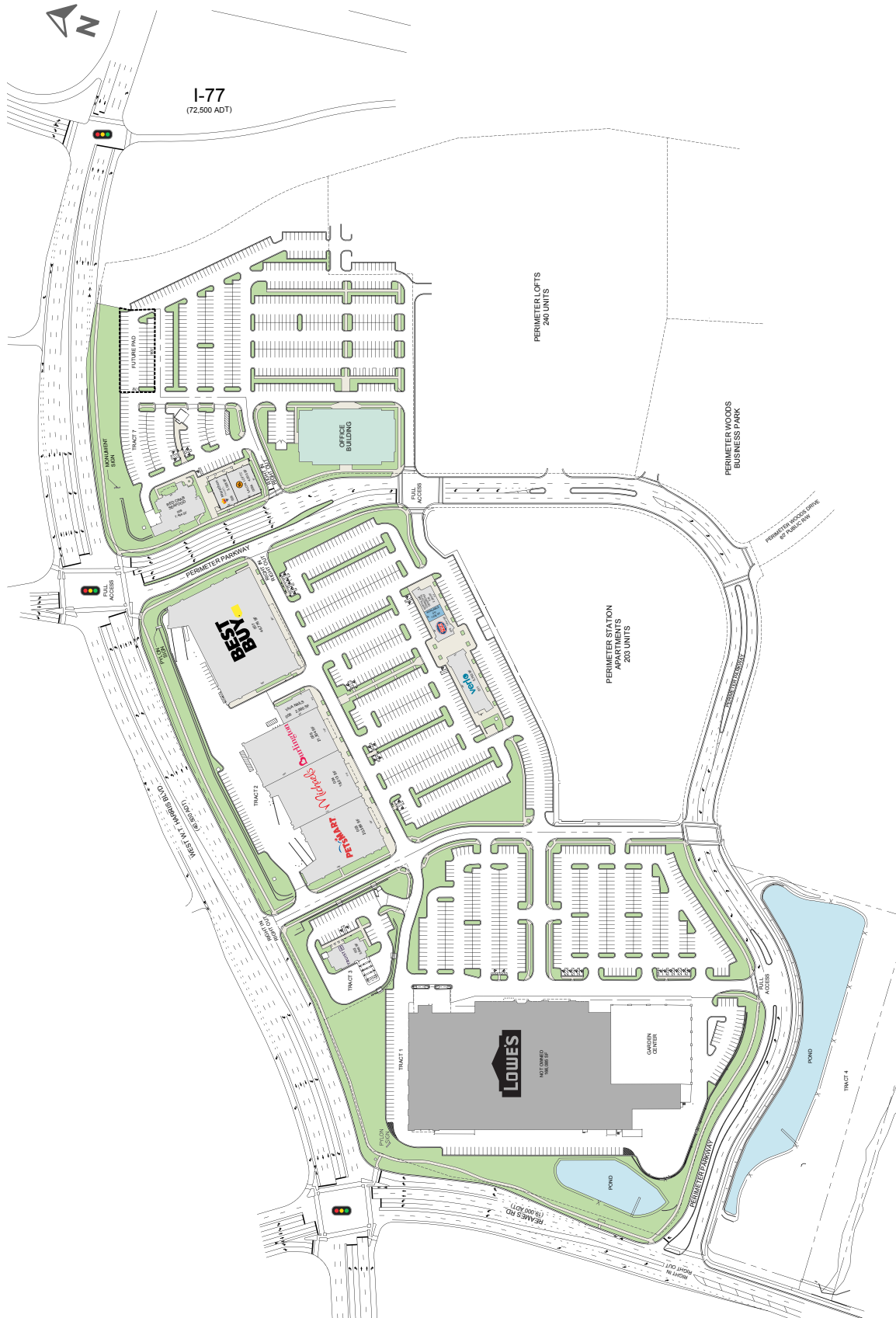

317-577-5600 [kiterealty.com](http://kiterealty.com)

KRG  
LISTED  
NYSE