

PERIMETER WOODS

10125-10275 Perimeter Parkway | Charlotte, NC 28216

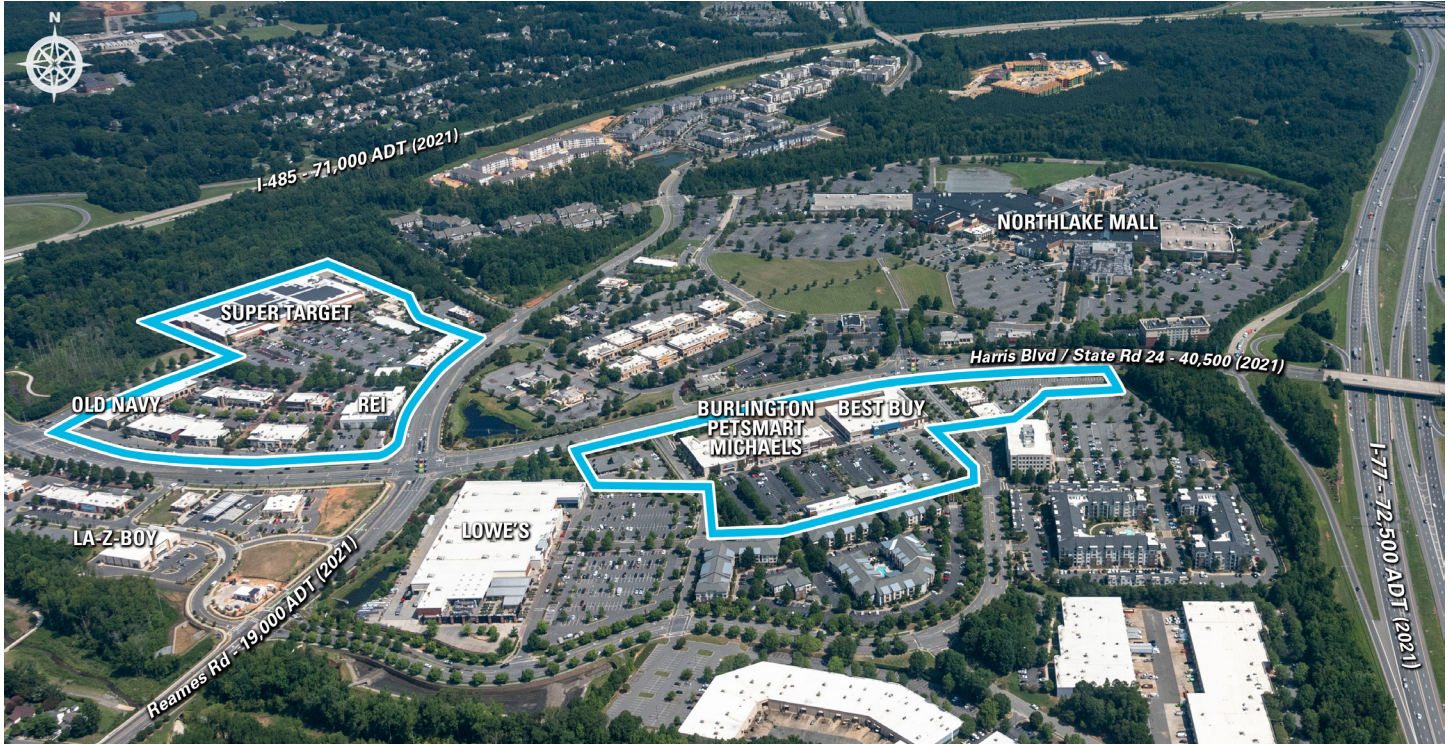

Perimeter Woods

MSA: Charlotte, NC | GLA: 127,067

High-visibility shopping center located across the street from Northlake Mall in Charlotte, NC. Immediate access to both Interstate 485 and Interstate 77. Perimeter Woods is anchored by Best Buy, PetSmart, Burlington, and Michaels.



3 MILE DEMOGRAPHICS



POPULATION

48,839



% POP. GROWTH
(ANNUAL)

1.0%



AVG. HH INCOME

\$101,311



MED. HH INCOME

\$83,071



HOUSEHOLDS

18,814



BACH. DEGREE+

45.6%

**2025 Demographic Source (PopStats)*

LEASING CONTACT - Blake Beaver - bbeaver@kiterealty.com - 317.713.5640



317-577-5600 kiterealty.com

KRG
LISTED
NYSE

PERIMETER WOODS

10125-10275 Perimeter Parkway | Charlotte, NC 28216

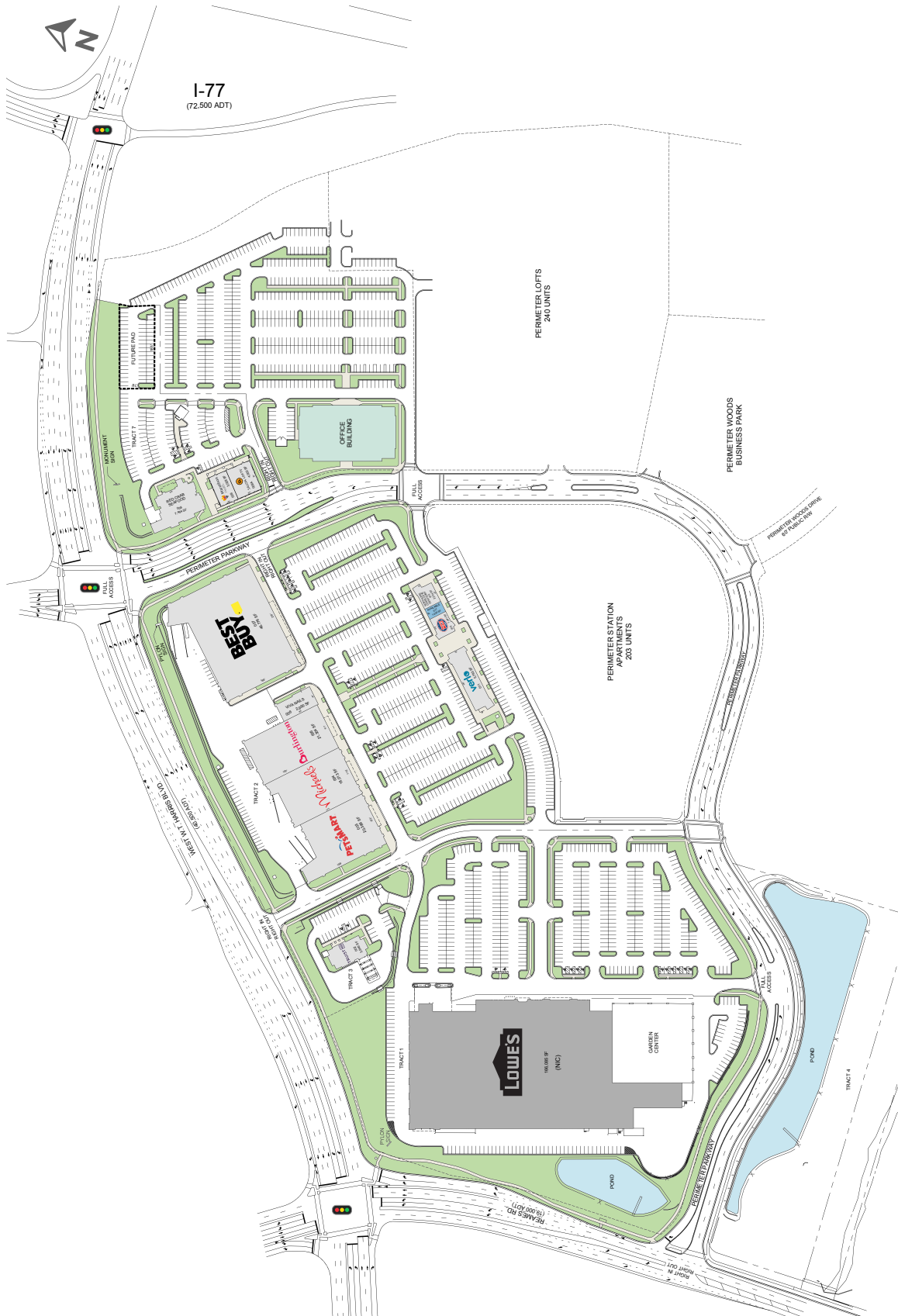

317-577-5600 kiterealty.com

KRG
LISTED
NYSE