

SHOPPES OF PROMINENCE POINT

120 Prominence Point Parkway | Canton, GA 30114



Shoppes of Prominence Point

MSA: Atlanta, GA | GLA: 85,612

Grocery anchored community shopping center in affluent Atlanta suburb of Canton, GA. Strong consumer demographics, accelerating population growth, and excellent interstate access will continue to drive customer traffic. Shoppes of Prominence Point is anchored by Publix.

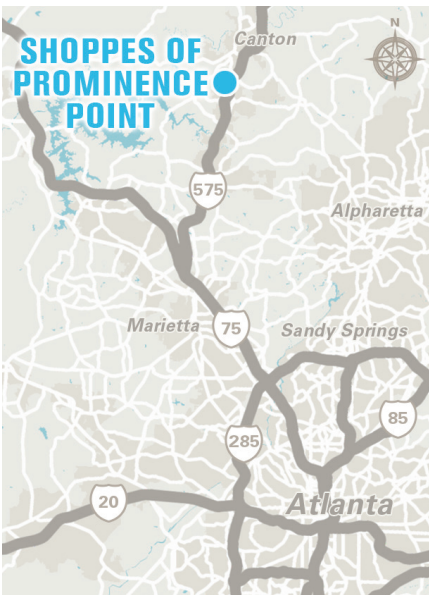

3 MILE DEMOGRAPHICS



POPULATION
45,632



% POP. GROWTH
(ANNUAL)
2.08%



AVG. HH INCOME
\$101,406



MED. HH INCOME
\$84,664



HOUSEHOLDS
15,781



BACH. DEGREE+
31.58%

**2023 Demographic Source (PopStats)*

LEASING CONTACT - Ryan Joyce - rjoyce@kiterealty.com - 407.563.0101



317-577-5600 kiterealty.com

KRG
LISTED
NYSE

SHOPPES OF PROMINENCE POINT

120 Prominence Point Parkway | Canton, GA 30114

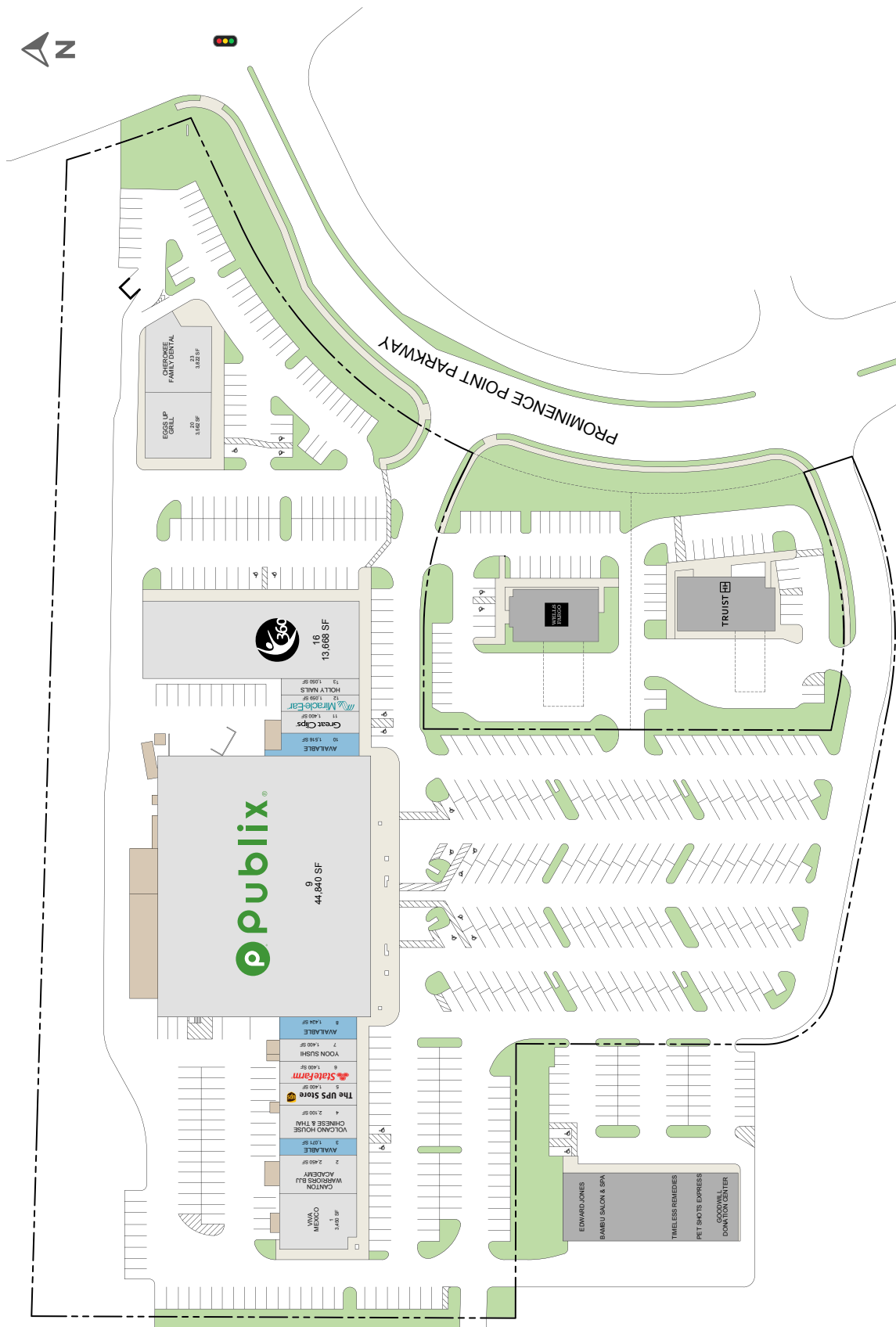

317-577-5600 kiterealty.com

KRG
LISTED
NYSE