

# STONEY CREEK COMMONS

10075 Town and Country Drive | Noblesville, IN 46060



## Stoney Creek Commons

MSA: Noblesville, IN | GLA: 84,226

Fitness-anchored community shopping center situated along US-37 in Noblesville, IN. The center has excellent visibility from roadway and is adjacent to high volume home improvement retailer, Lowe's. Stoney Creek is supported by customers with strong household demographics in this fast-growing suburban market.

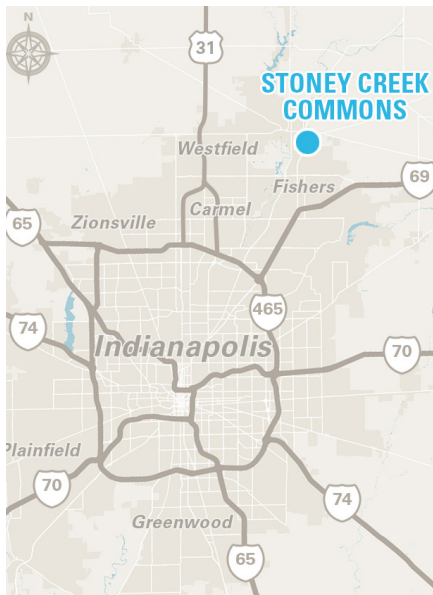

### 3 MILE DEMOGRAPHICS



POPULATION  
**49,615**



% POP. GROWTH  
(ANNUAL)  
**1.31%**



AVG. HH INCOME  
**\$103,859**



MED. HH INCOME  
**\$86,042**



HOUSEHOLDS  
**18,503**



BACH. DEGREE+  
**47.86%**

*\*2023 Demographic Source (PopStats)*

**LEASING CONTACT** - Blake Beaver - [bbeaver@kiterealty.com](mailto:bbeaver@kiterealty.com) - 317.713.5640



317-577-5600 [kiterealty.com](http://kiterealty.com)

KRG  
LISTED  
NYSE

# STONEY CREEK COMMONS

10075 Town and Country Drive | Noblesville, IN 46060

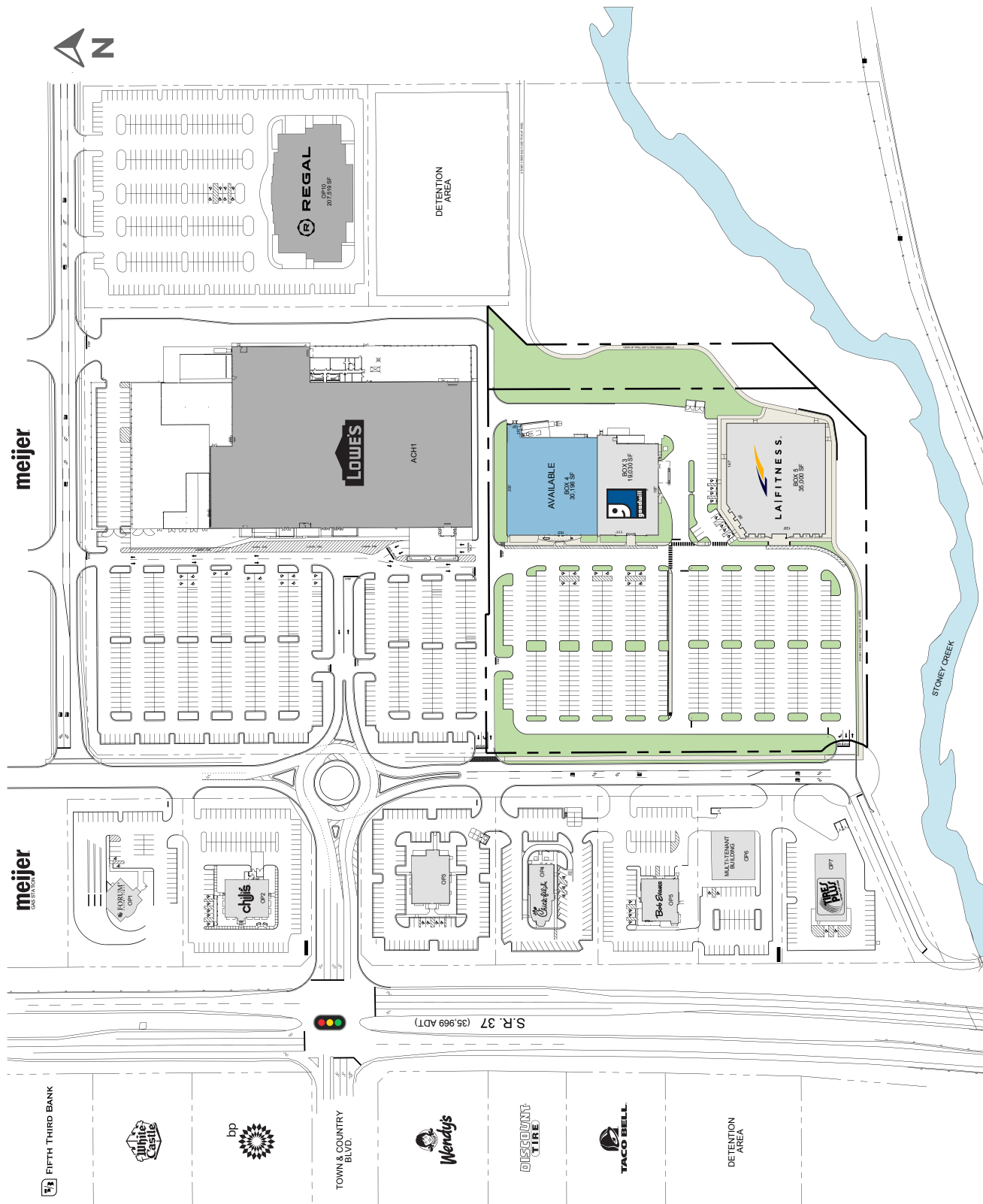

317-577-5600 [kiterealty.com](http://kiterealty.com)

KRG  
LISTED  
NYSE