

TRADERS POINT

6010 West 86th Street | Indianapolis, IN 46278



Traders Point

MSA: Indianapolis, IN | GLA: 257,572

Regional shopping center located on Indianapolis' northwest side. Interstate accessible with excellent visibility. The center is supported by strong customer demographics due to proximity to affluent suburb of Zionsville. Second largest industrial park in metro area located immediately south of center contributing to exceptional daytime worker population.

3 MILE DEMOGRAPHICS

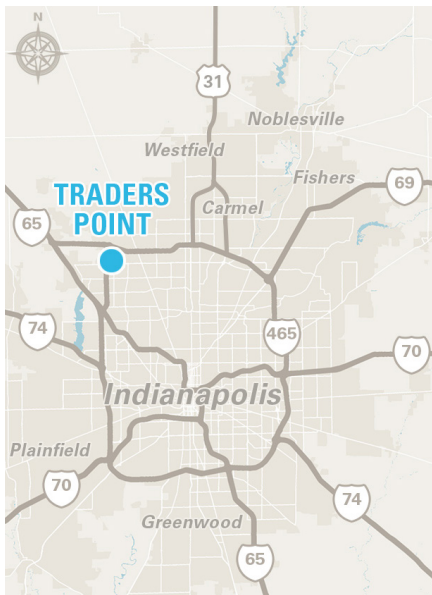

POPULATION
34,541



DAYTIME POP.
50,882



AVG. HH INCOME
\$149,958



MED. HH INCOME
\$103,682



HOUSEHOLDS
14,583



BACH. DEGREE+
57.6%

**2025 Demographic Source (PopStats)*

LEASING CONTACT - Blake Beaver - bbeaver@kiterealty.com - 317.713.5640



317-577-5600 kiterealty.com

KRG
LISTED
NYSE

TRADERS POINT

6010 West 86th Street | Indianapolis, IN 46278

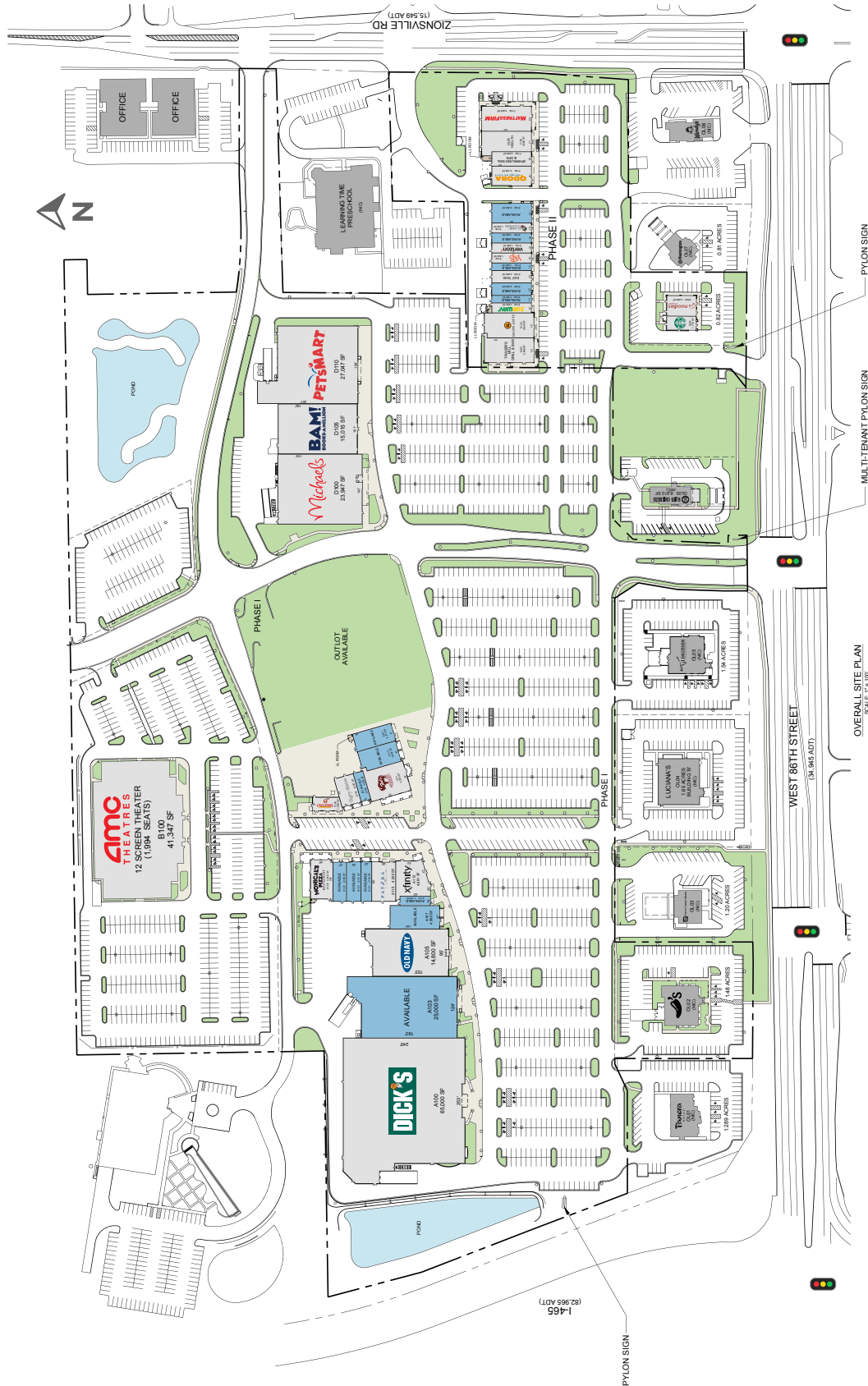

OVERALL SITE PLAN
SCALE: 1" = 10'



317-577-5600 kiterealty.com

