

WINCHESTER COMMONS

7948 Winchester Road | Memphis, TN 38125

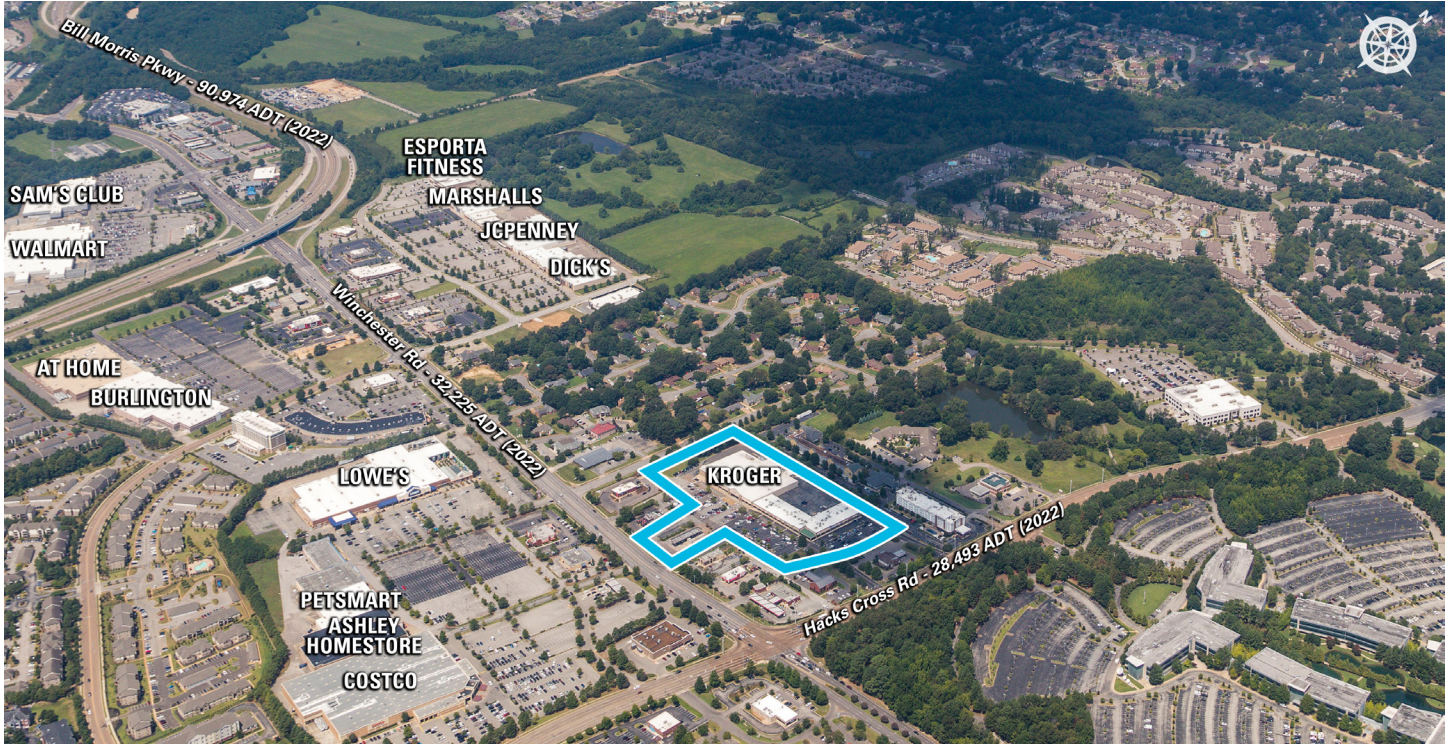

Winchester Commons

MSA: Memphis, TN | GLA: 93,077

Grocery-anchored neighborhood center in the heart of the high-traffic I-385 / Winchester Rd. submarket in Memphis, TN. The center is supported by an affluent local population. Winchester Commons is right across the street from FedEx Global Headquarters with 3,200 employees. Winchester Commons is anchored by Kroger.



3 MILE DEMOGRAPHICS



POPULATION
76,074



% POP. GROWTH
(ANNUAL)
0.67%



AVG. HH INCOME
\$100,300



MED. HH INCOME
\$73,390



HOUSEHOLDS
30,136



BACH. DEGREE+
43.41%

**2023 Demographic Source (PopStats)*

LEASING CONTACT - Blake Beaver - bbeaver@kiterealty.com - 317.713.5640



317-577-5600 kiterealty.com

KRG
LISTED
NYSE

WINCHESTER COMMONS

7948 Winchester Road | Memphis, TN 38125

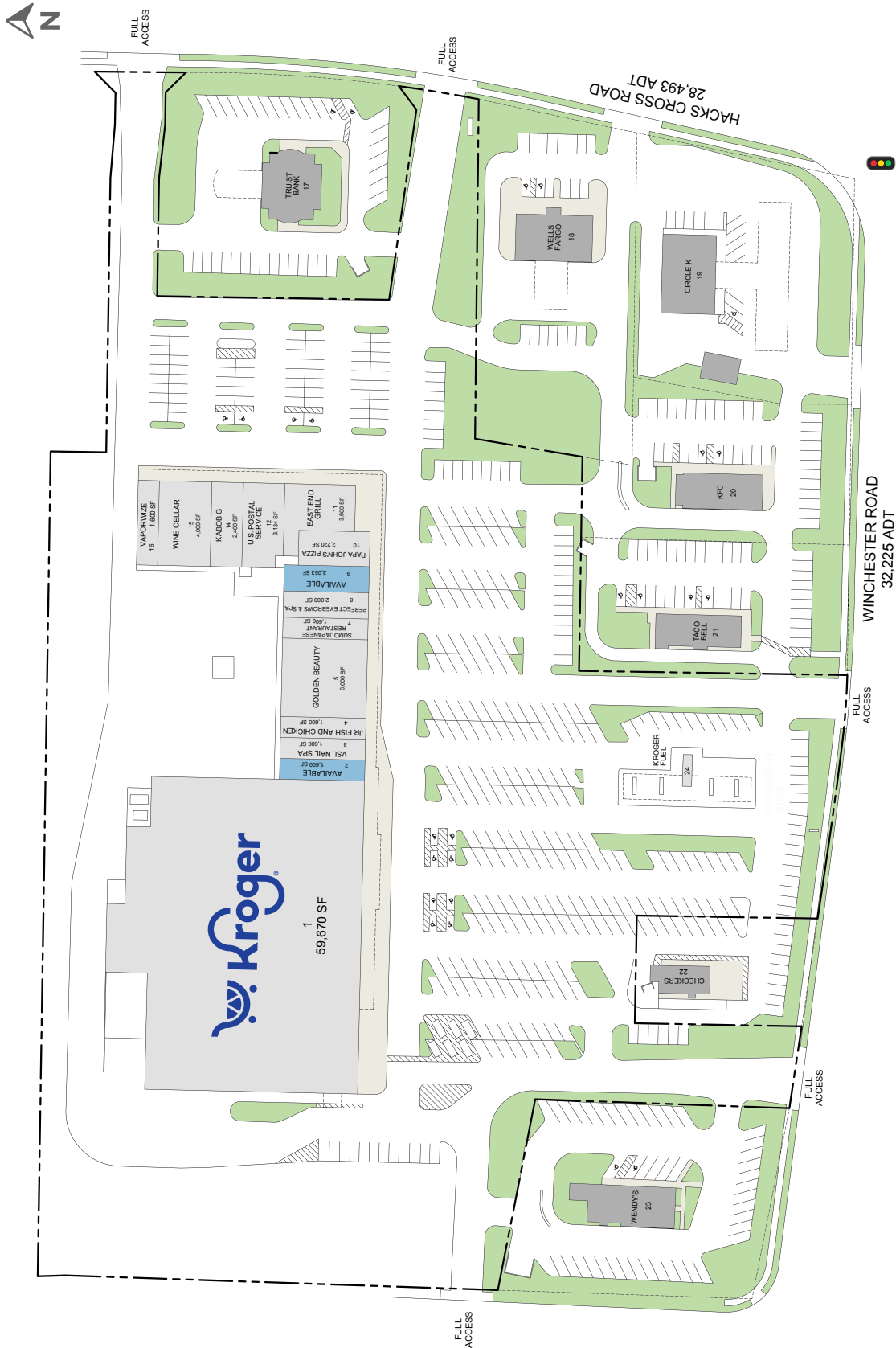

317-577-5600 kiterealty.com

KRG
LISTED
NYSE