

Tool Needed: Phillips Screw Driver  
Prep: Make sure the rack is flipped up.

**..kuat..<sup>®</sup>**  
(koo-at)

1. Remove the three screws with a Phillips screw driver.
2. Slide the cap out of the lower end.

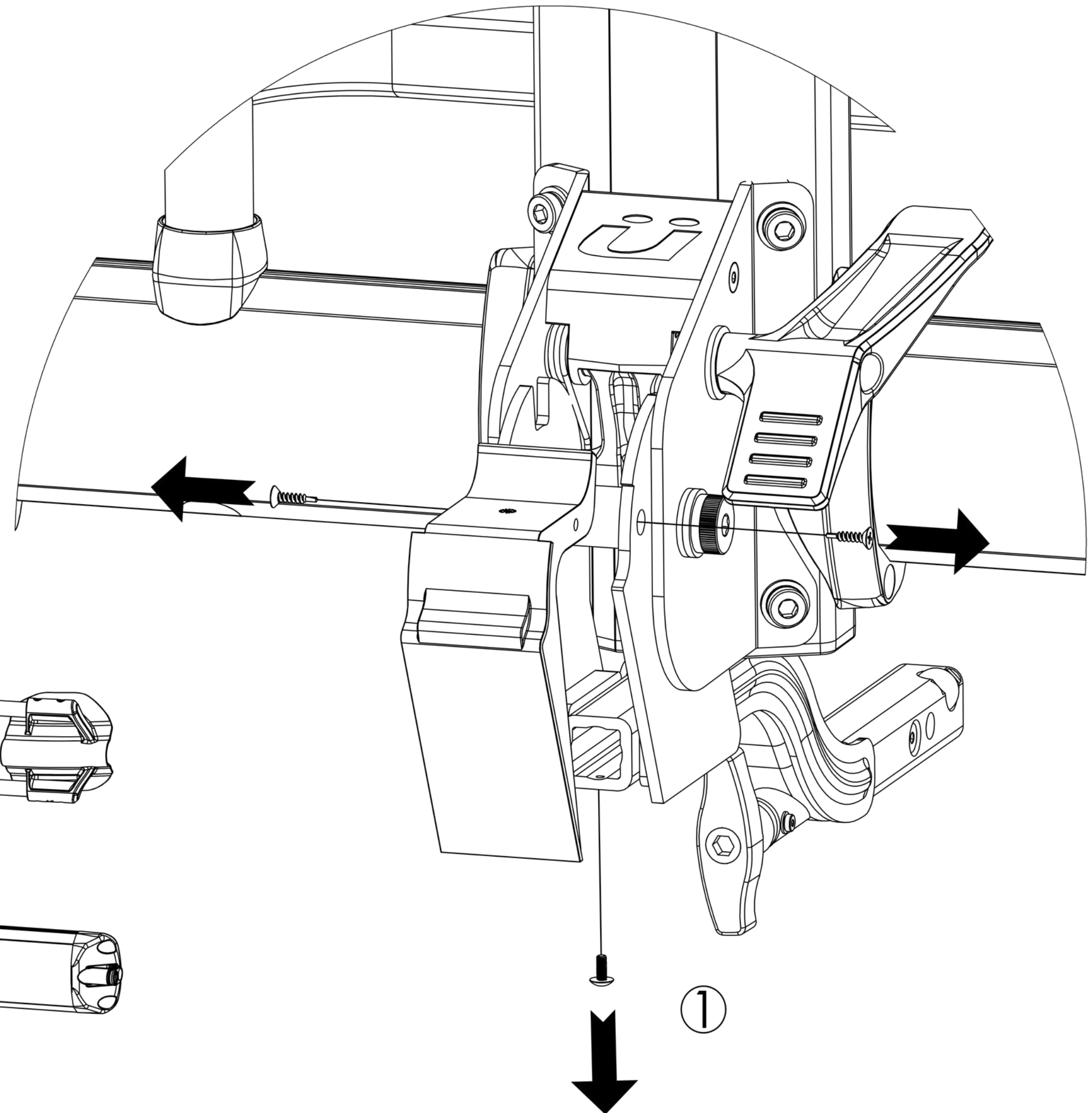

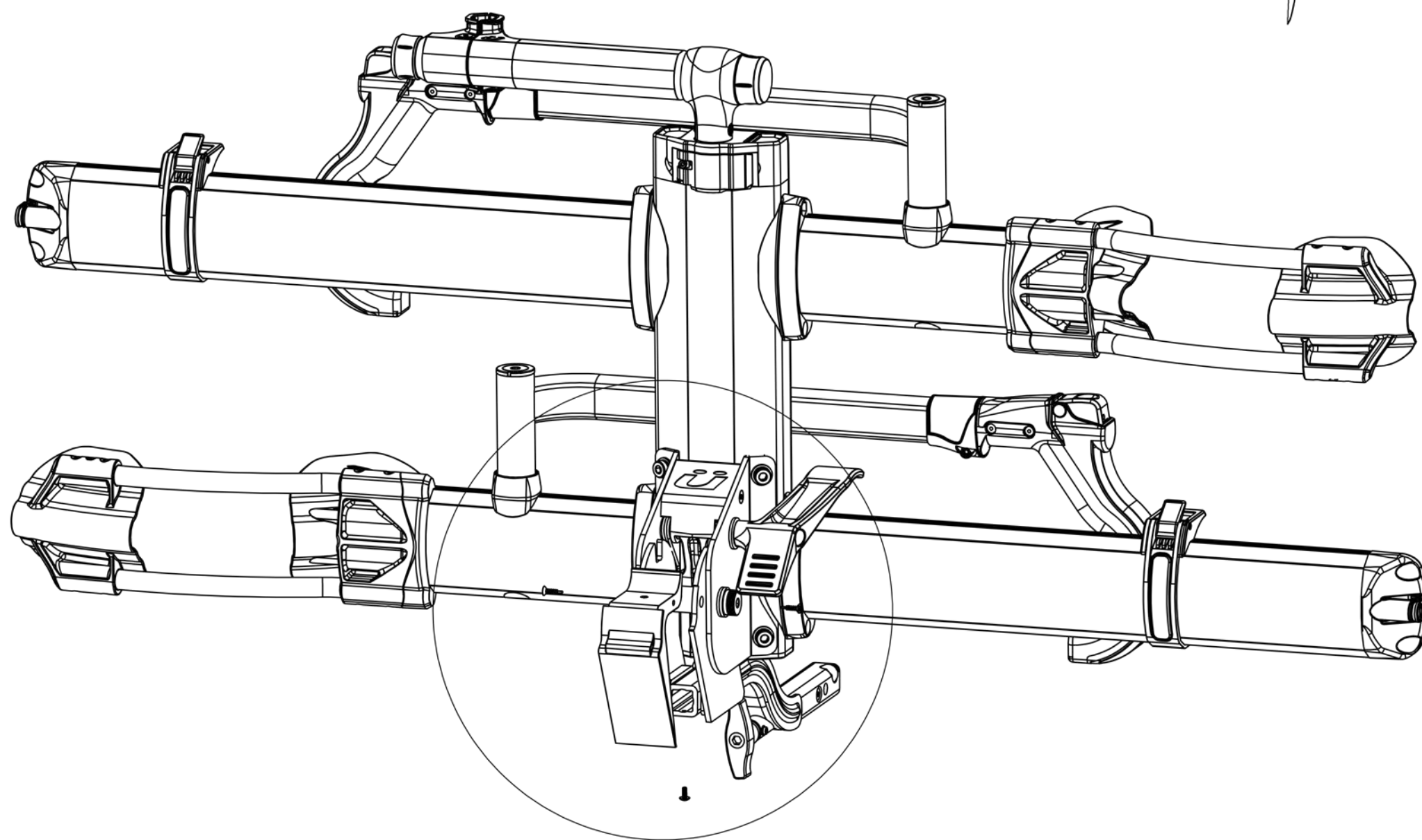

Tool Needed: Phillips Screw Driver  
Prep: Make sure the rack is flipped up.

**..kuat..<sup>®</sup>**  
(koo-at)

1. Remove the two screws with a Phillips screw driver.
2. Slide the cap out of the lower end.

