

Tools Needed:
6mm Hex Key

kuat[®]

- ① Open the tire arm. Using the 6mm Hex Key, remove the two M8 bolts connecting the tire arms to the tire arm bridge. The tire arm bridge can now be removed.

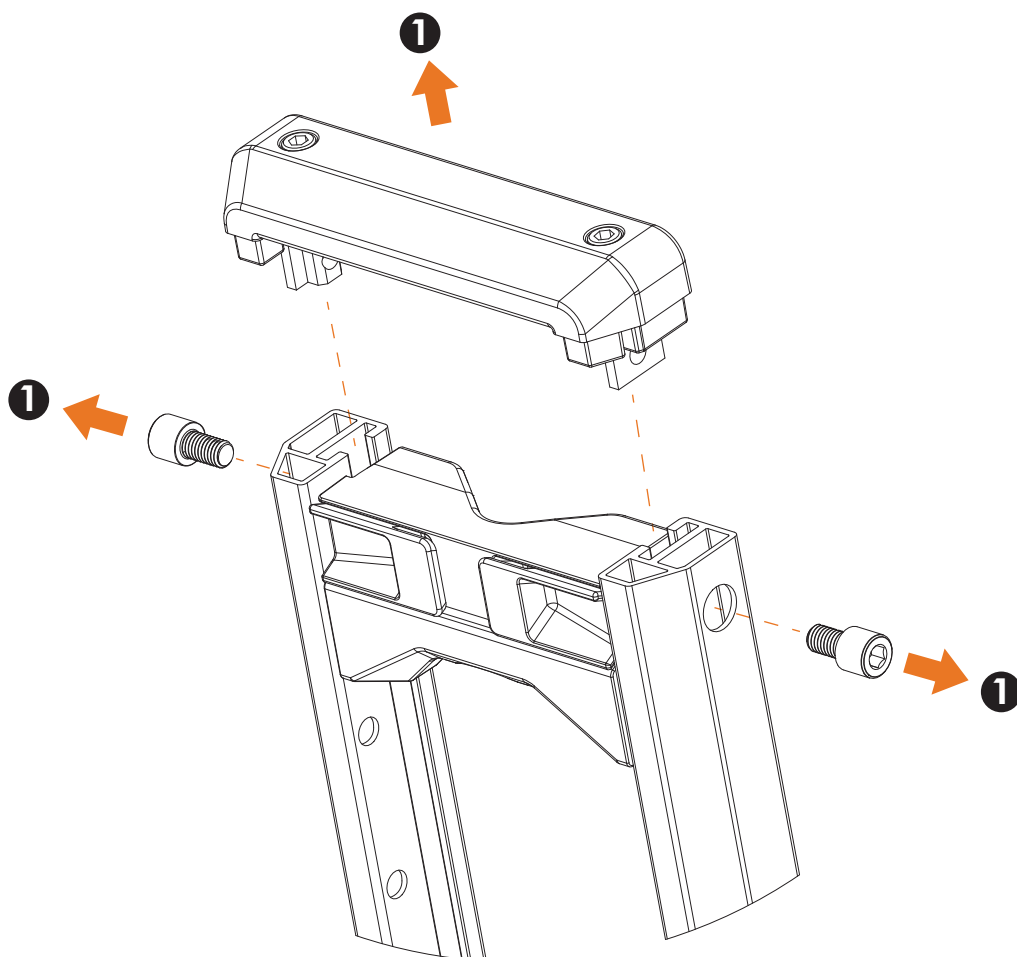

- ② Depress the Tire Chock Release Tabs and slide the old Tire Chock out of the tire arms. Take note of the orientation of the Tire Chock.

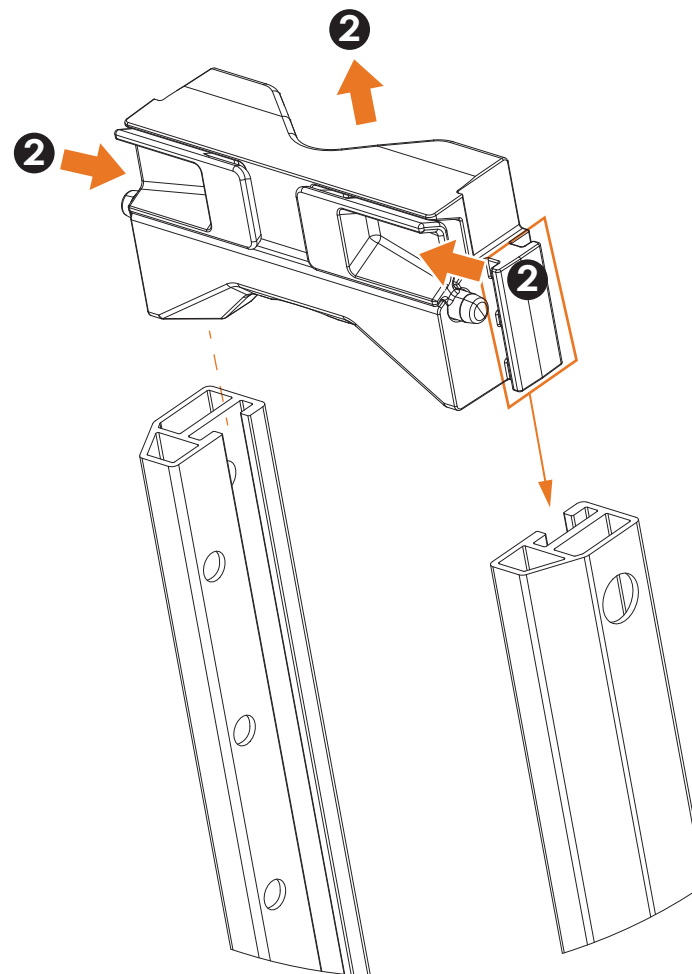

- ③ Install the new Tire Chock and reassemble the tire arm bridge by following steps 1 & 2 in reverse. Torque the two M6 screws to 12 Nm.